

This drawing should not be scaled. Dimensions to be verified on site.
 Any discrepancies should be referred to the Engineer prior to work being put in hand.

This drawing is the property of Waterman Infrastructure & Environment Limited, and the drawing is issued on the condition that it is not copied, reproduced, retained or disclosed to any unauthorised person, either wholly or in part without the consent in writing of Waterman Infrastructure & Environment Limited
 Pickfords Wharf, Clink Street, London SE1 9DG t 020 7928 7888 f 03333 444 501

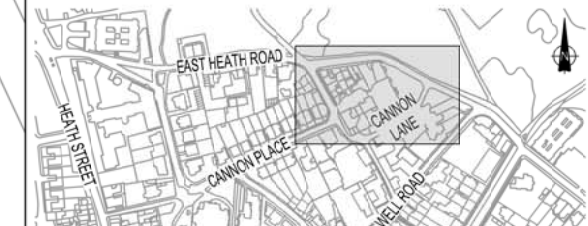
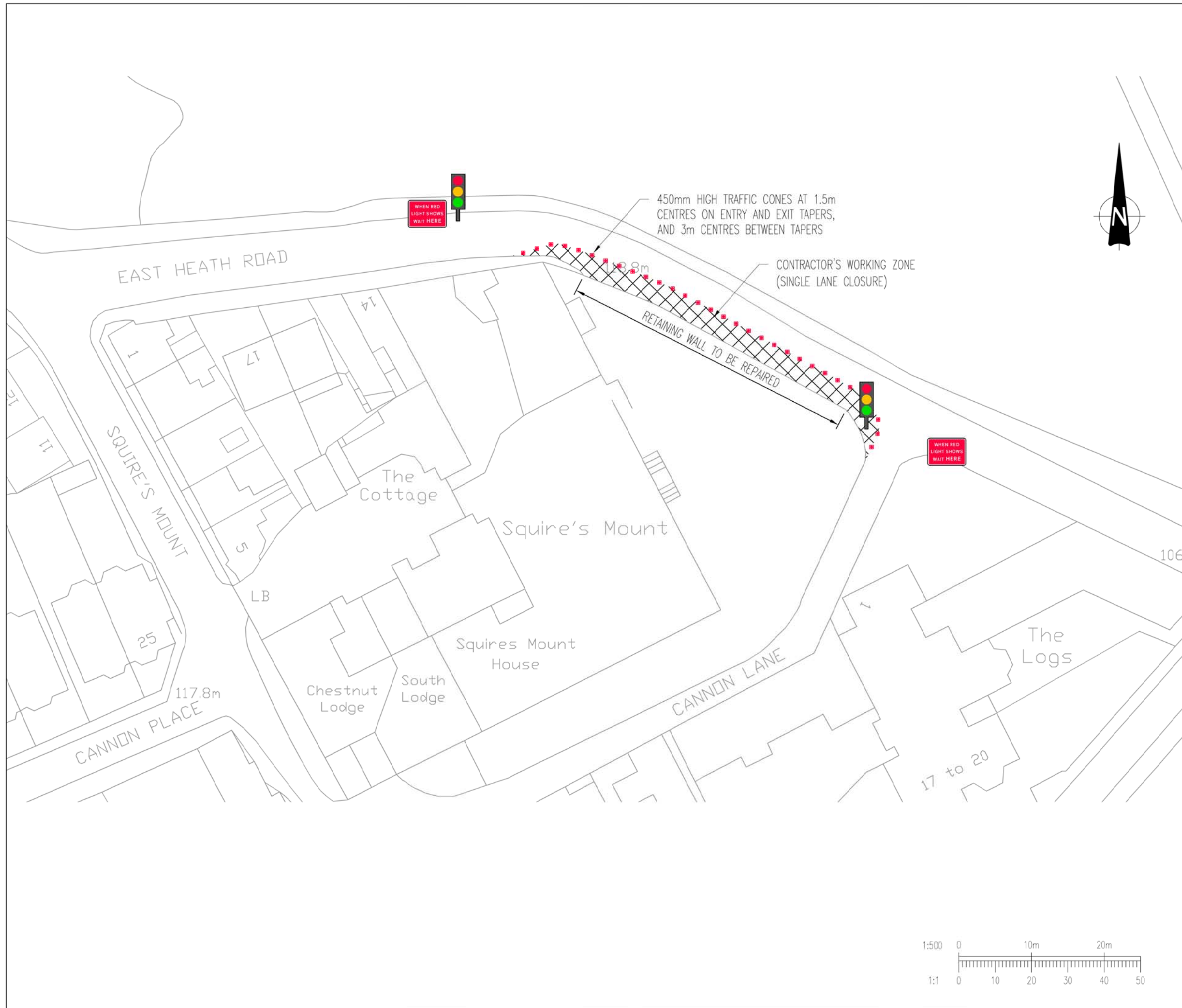

KEY PLAN
 NOT TO SCALE

Rev	Date	Description	By
A01	26.05.15	PRELIMINARY ISSUE	LS

Amendments

Project **SQUIRE'S MOUNT**

Title **INDICATIVE TRAFFIC MANAGEMENT FOR RETAINING WALL REPAIR**

Client **STEWART WATSON & Co. Ltd**



Pickfords Wharf Clink Street London SE1 9DG
 t 020 7928 7888
 mail@watermangroup.com www.watermangroup.com

Drawing Status **PRELIMINARY**

Designed by	MC	Checked by	MC	Project No	CIV17309
Drawn by	LS	Date	MAY 2015	Computer File No	
Scales @ A3 work to figured dimensions only				1:500, AS SHOWN	CIV17309CSA950001.dwg

Publisher	Zone	Category	Number	Revision
CIV	SA	95	0001	A01

