

GENERAL NOTES
 1. All work to be in accordance with the Building Regulations and the relevant parts of the Building Code of Practice.
 2. All work to be in accordance with the relevant parts of the Building Code of Practice.
 3. All work to be in accordance with the relevant parts of the Building Code of Practice.
 4. All work to be in accordance with the relevant parts of the Building Code of Practice.
 5. All work to be in accordance with the relevant parts of the Building Code of Practice.
 6. All work to be in accordance with the relevant parts of the Building Code of Practice.
 7. All work to be in accordance with the relevant parts of the Building Code of Practice.
 8. All work to be in accordance with the relevant parts of the Building Code of Practice.
 9. All work to be in accordance with the relevant parts of the Building Code of Practice.
 10. All work to be in accordance with the relevant parts of the Building Code of Practice.

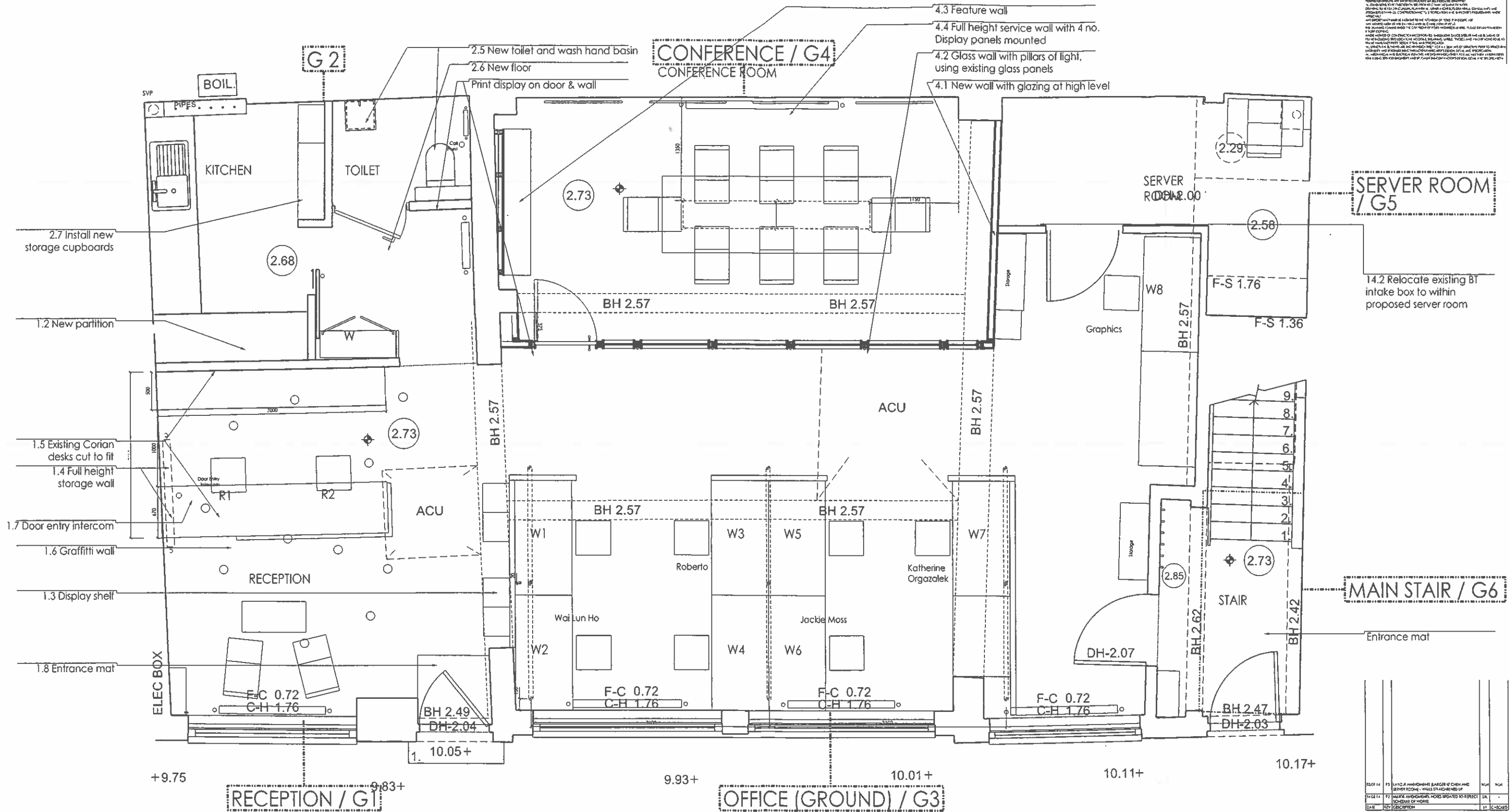

- W1 Workstation/future workstation
Allow for 6 no. power sockets and 3 no. data points each
- C1
- R1
- B1
- T1 Temporary workstation
Allow for 2 no. power sockets and 3 no. data points each



REV	NO	DESCRIPTION	DATE
01	1	ISSUED FOR PERMIT	10/10/11
02	2	ISSUED FOR CONSTRUCTION	11/01/12

13 - 15 CANFIELD PLACE
 LONDON NW6 3BT
 TEL 0207 372 8918
 WWW.PCKO.CO.UK

PCKO ARCHITECTS INTERIOR DESIGNERS
 MASTER PLANNERS URBAN DESIGNERS

CLIENT	PCKO
PROJECT	New Office 13 - 15 Canfield Place NW6 3BT
DESIGN INTENT	GENERAL ARRANGEMENT PROPOSED LAYOUT GROUND FLOOR PLAN
SCALE	1:50 @ A3
DATE	2011-07
DRAWN BY	WJH
CHECKED BY	WJH
DATE	2011-07
PROJECT NO	1425_PR_110
REVISION	P3