

GENERAL NOTES
 All drawings are based on survey information provided by others. Scott Brownrigg cannot be held responsible for the accuracy of this information, the legal boundary or site demise. This should be checked on site and against legal records.

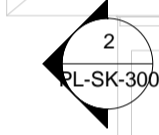

2 Existing Roof Plan
 1 : 100

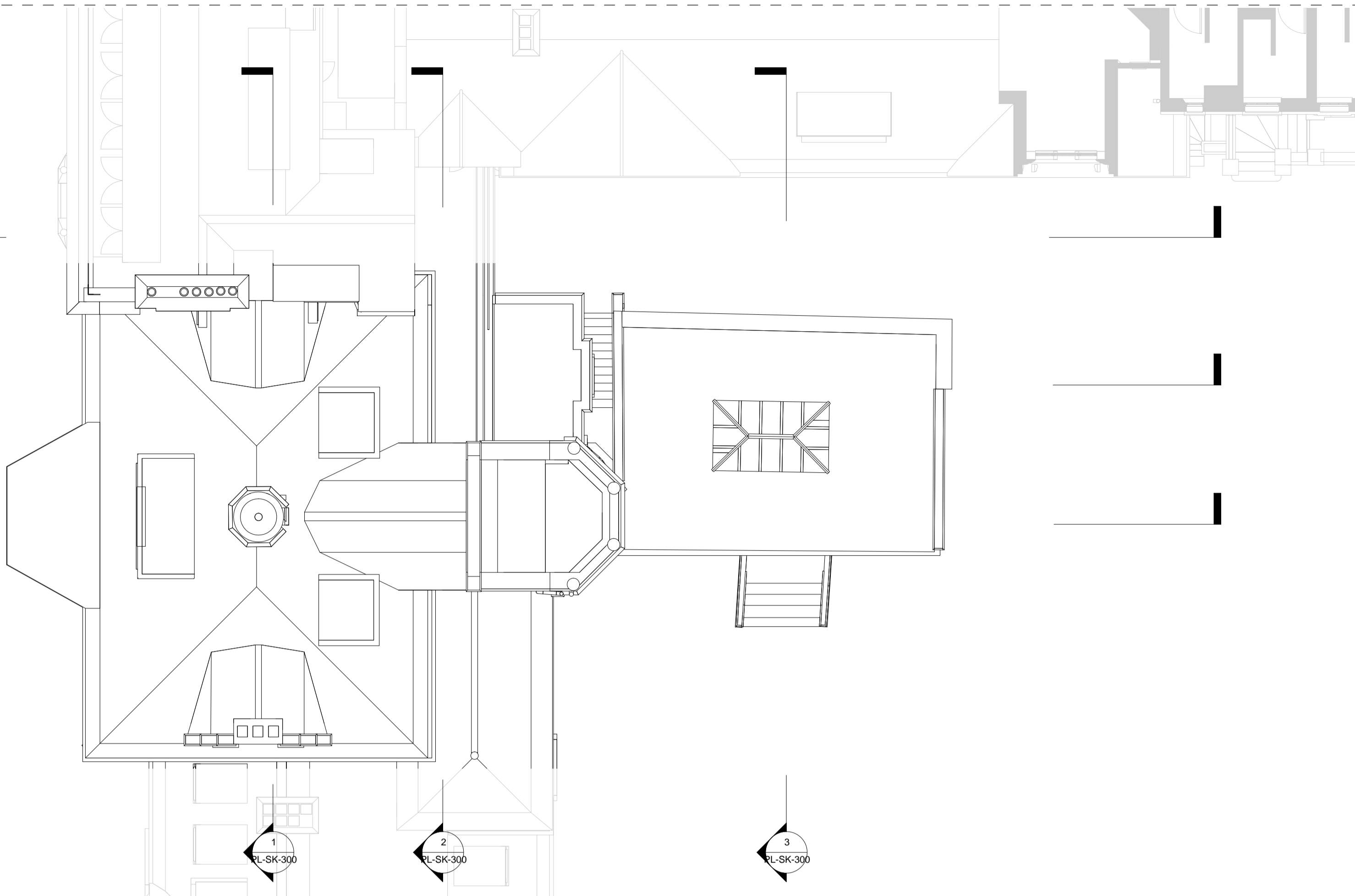
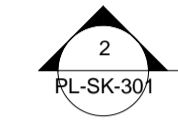
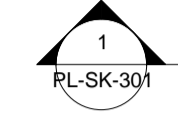
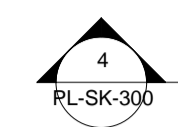
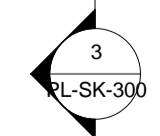
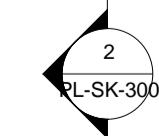
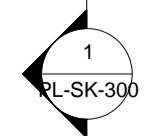
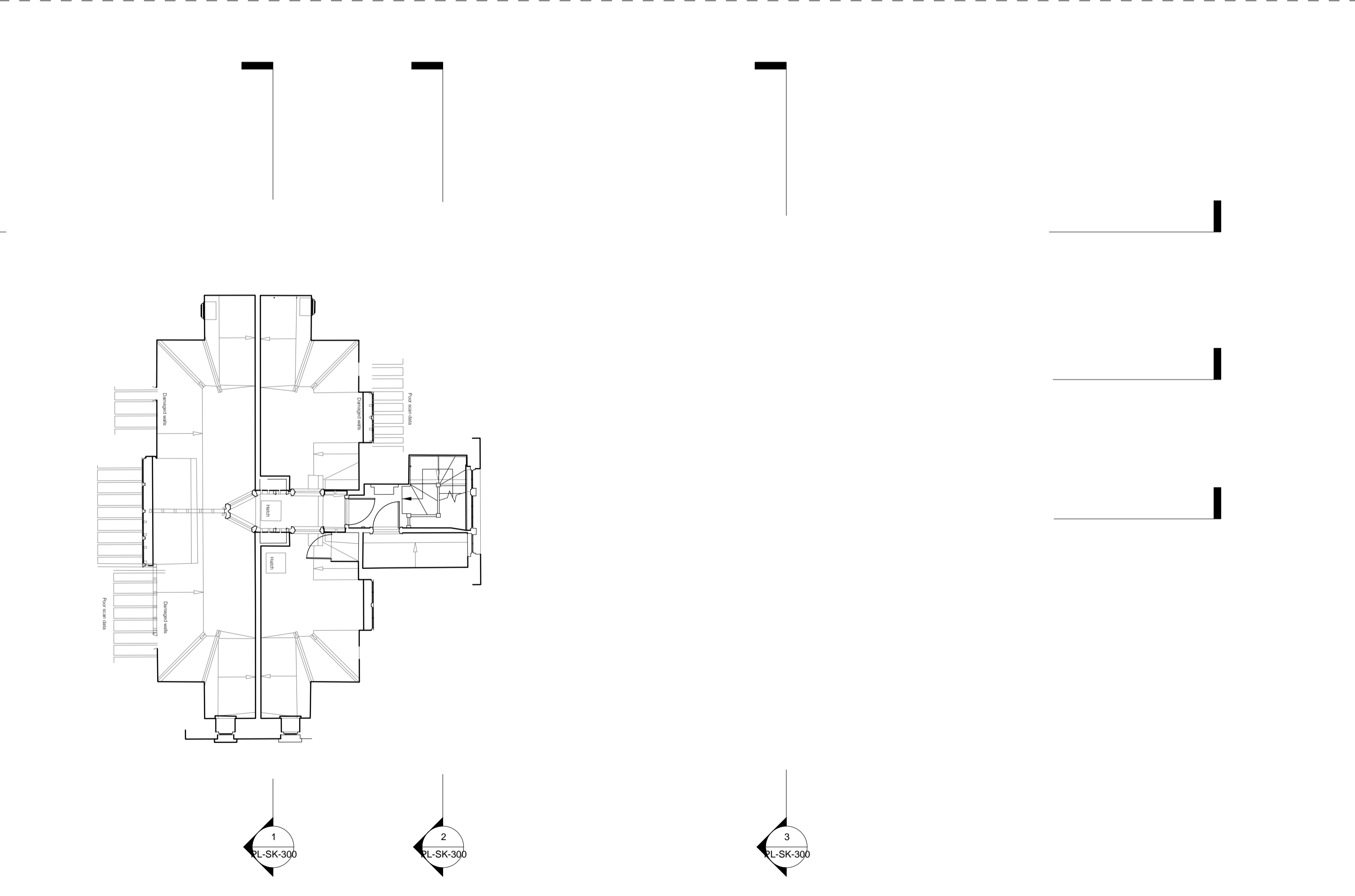
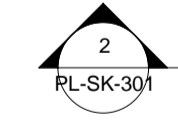
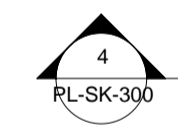

1 Existing Third Floor Plan Layout
 1 : 100

2	Issued for planning submission	DDV	2015-07-06	MJM
1	Issued for planning submission	DDV	2015-07-03	MJM
Revision	Description	Drawn	Date	Checked



St Catherine's Court
 46-48 Portsmouth Road
 Guildford GU2 4DU
 T +44 (0)1483 568686
 F +44 (0)1483 575830
 W scottbrownrigg.com

Client's Name
Mount Anvil

Job Title
Kidderpore Avenue

Drawing Title
**Skeel House
 Existing Third Floor Plan Layout
 and Roof Plan**

Scale
1 : 100 @A1

Job No
157780

Drawing No
PL-SK-EX-102

Status
FOR PLANNING

Rev
2