

LEGEND

Built Features Roads & Road Markings		Internal Survey Features	
Wall	+ 5.12	Hard Surface	DH 2.20 Door Height
Edge of Road	+ 5.12	Floor Level	F-C 0.00 Floor to Cill
Footpath	EAVER	Edges Height	CH 0.15 Cill to Road
Kerb (bottom)	+ 5.12	Parapet	FD Fire Door
Kerb (top)	+ 5.12	SOFF	Underside of Soffit
Crash Barrier	ARMCO	+ 5.12	Top of Wall Level
Railway	+ 5.12	STP	Step Level
Line of Fence	LD	LD	Land Drain
Concrete Base	CONSB	Tree	Tree Coniferous
Surface Change	+ 5.12	Tree	Tree Deciduous
20.00	Ceiling Level	Door	Door
20.00	Floor Level	Wardrobe Door	Wardrobe Door
2.70	Ceiling Height	Sliding Door	Sliding Door
2.70	False Ceiling Height	Sink / Bath	Sink / Bath
2.70	Ceiling Slope	Toilets	Toilets
Arrows point up unless on roofs		Showers	Showers
Arched Ceiling			
Roof Access			
Window			
Sash Window			
Rad			

Description of Features

A/C	Air Conditioner	Ft	Floodlight
AH	Arch Height	F-C	Floor to Cill Height
AL	Arch Level	h	height
ASH	Arch Spring Height	HR	Handrail
ASL	Arch Spring Level	IC	Inspection Cover
B	Bollard	L	Light
BGP	Break Glass Point	Max	Maximum
BH	Beam Height	Min	Minimum
BSL	Beam Soffit Level	CH	Overhead
C-H	Cill to Head Height	OSBM	Orange Survey Bench Mark
Conc	Concrete	Rad	Radiator
Cup	Cupboard	ROM	Recessed Door Mat
DH	Door Height	RSJ	Rolled Steel Joist
DP	Down Pipe	RWP	Rain Water Pipe
D/C	Drainage Channel	SBM	Site Bench Mark
ESG	Electrical Switchgear	SH	Spring Height
FA	Fire Alarm	SL	Slight
FE	Fire Extinguisher	V	Vent
FH	Fire Hydrant	VP	Vent Pipe
FHR	Fire Hose Reel	WH	Water Heater

Murphy Surveys Ltd. Disclaimer

The user or recipient of this survey data understands and acknowledges this data may be inaccurate or contain errors or omissions and the user or recipient assumes full responsibility for any risks or damages resulting from arising from, or in connection with any use of or reliance upon data displayed herein. Although significant care has been exercised to produce surveys that satisfy survey accuracy standards, these surveys are only as accurate as the source data from which they were compiled. Although all reasonable steps have been taken to locate all features visible at the time of the survey, there is no guarantee that all will be shown on the drawing, as some above ground features may have obstructed the survey. Wherever possible, areas unable to be surveyed will be labelled as "UTS".

The Company shall not be liable for any inaccuracy of the data provided beyond the specified scale or accuracy, or for any matters resulting from their use for purposes other than that stated in the Contract. No liability shall attach to the Surveyor in respect of any consequential loss or damages suffered by the Client.

The Client must promptly notify the Company of any errors in mapping of which it becomes aware. If misleading, inaccurate or otherwise inappropriate information is brought to the Company's attention or the Company itself identifies any such imprecision or error in a survey, it shall use its reasonable endeavours to fix or remove it and if necessary in certain instances, the Company being on notice of any such misleading, inaccurate or otherwise inappropriate information, it will re-conduct the survey and reproduce the data to within the specified scale or accuracy.

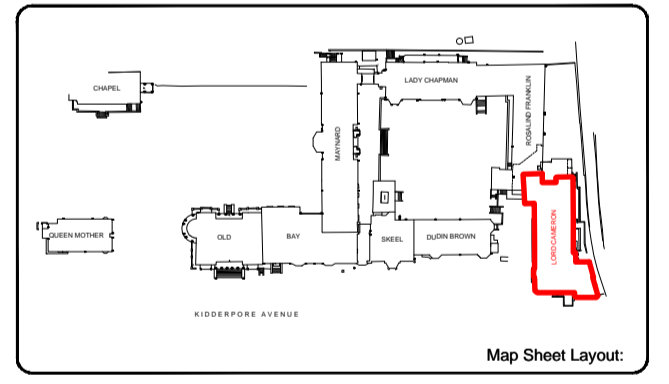
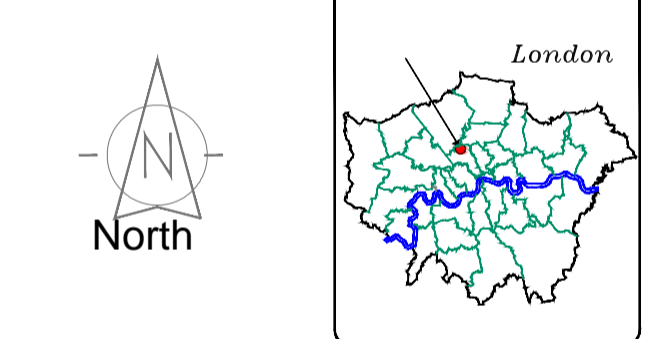
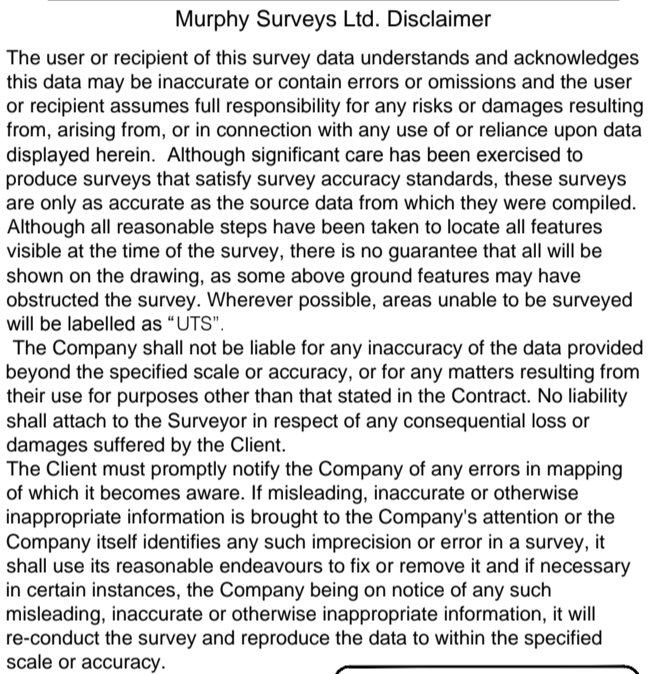

No.	Date	Description
A	18/09/2014	First Issue

murphy

SURVEYS

 GLOBAL CONSULTING SURVEYORS

Topographic surveys, Measured Building Surveys,
 Setting Out, As-Built Surveys, Hydrographic Surveys, Level Monitoring,
 Pipeline Surveys, Services Location, Ground Penetrating Radar,
 Laser Scanning, Aerial Photography

London Glasgow Belfast Cork Kildare

UK Head Office
 9 Devonshire Square
 London
 EC2M 4YF

Phone: (+44) 020 3178 6644
 Email: london@murphysurveys.co.uk

www.murphysurveys.co.uk

Client:	Mount Anvil
Project:	King's College London Lord Cameron Hall
Date:	18/09/2014
Scale:	1:50@A1
Description:	Floor Plan - Basement Floor
Drawing Number:	MSL9992-LCH-FPB-02

© Copyright 2014 MURPHY SURVEYS LTD

