

- NOTES:
- MINIMUM CLEAR STAIR WIDTH 900mm MEASURED 450mm ABOVE PITCH LINE
 - MINIMUM HEADROOM ABOVE PITCH LINE 2000mm
- NOTE: ARRANGEMENT OF STRUCTURAL SUPPORT OF STAIR BY BUILDING TIMBER FRAME TBC BY SPECIALIST STAIR AND TIMBER FRAME SUPPLIERS
- NOTE: FULL-HEIGHT POSTS MAY BE REQUIRED TO SUPPORT STAIR CORNER LANDINGS - REFER TO SPECIALIST SUPPLIER DETAILS
- NOTE: ACOUSTIC CONSULTANT TO CONFIRM SUFFICIENCY OF STAIR WALKING SURFACE TREATMENT WITH TIMBER STAIR CONSTRUCTION

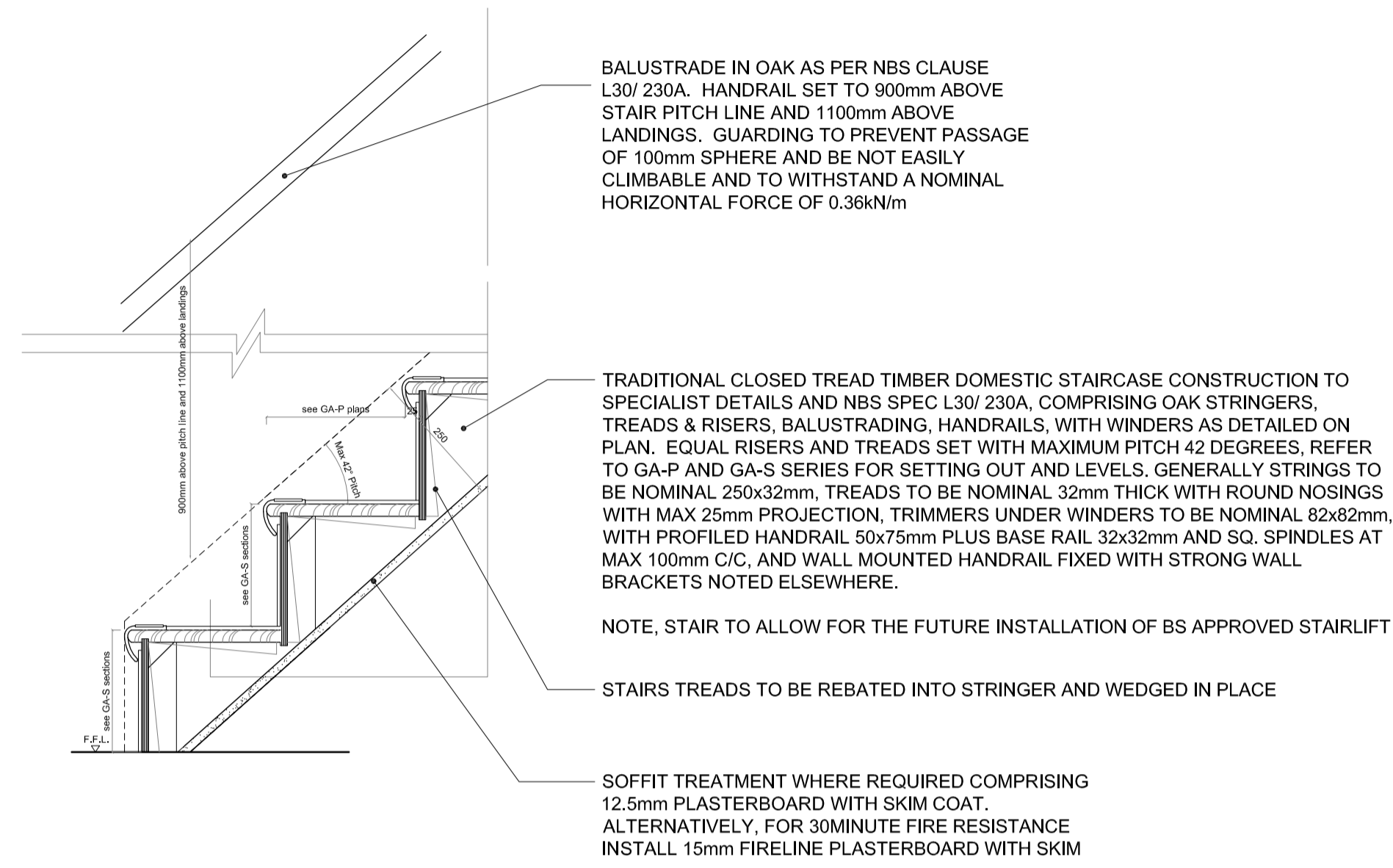

ACCREDITED DETAIL REFERENCE: N/A

DETAIL - D-J-505 - Block B1 - Stairs type 2 - Stairs treads and balustrade

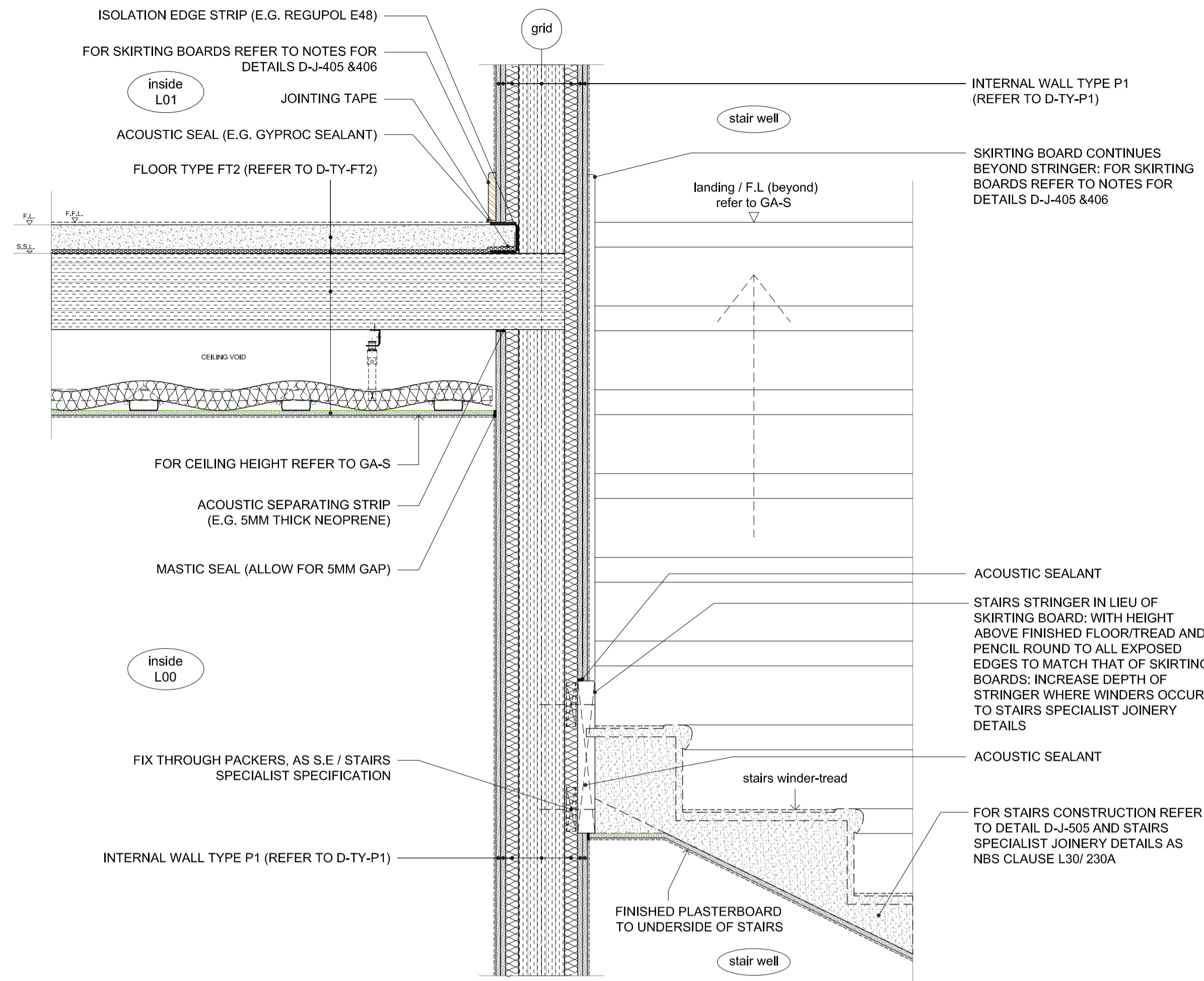

DETAIL - D-J-506 - Block B1 - Stairs type 2 - Stairs / Load bearing partition / Upper floor

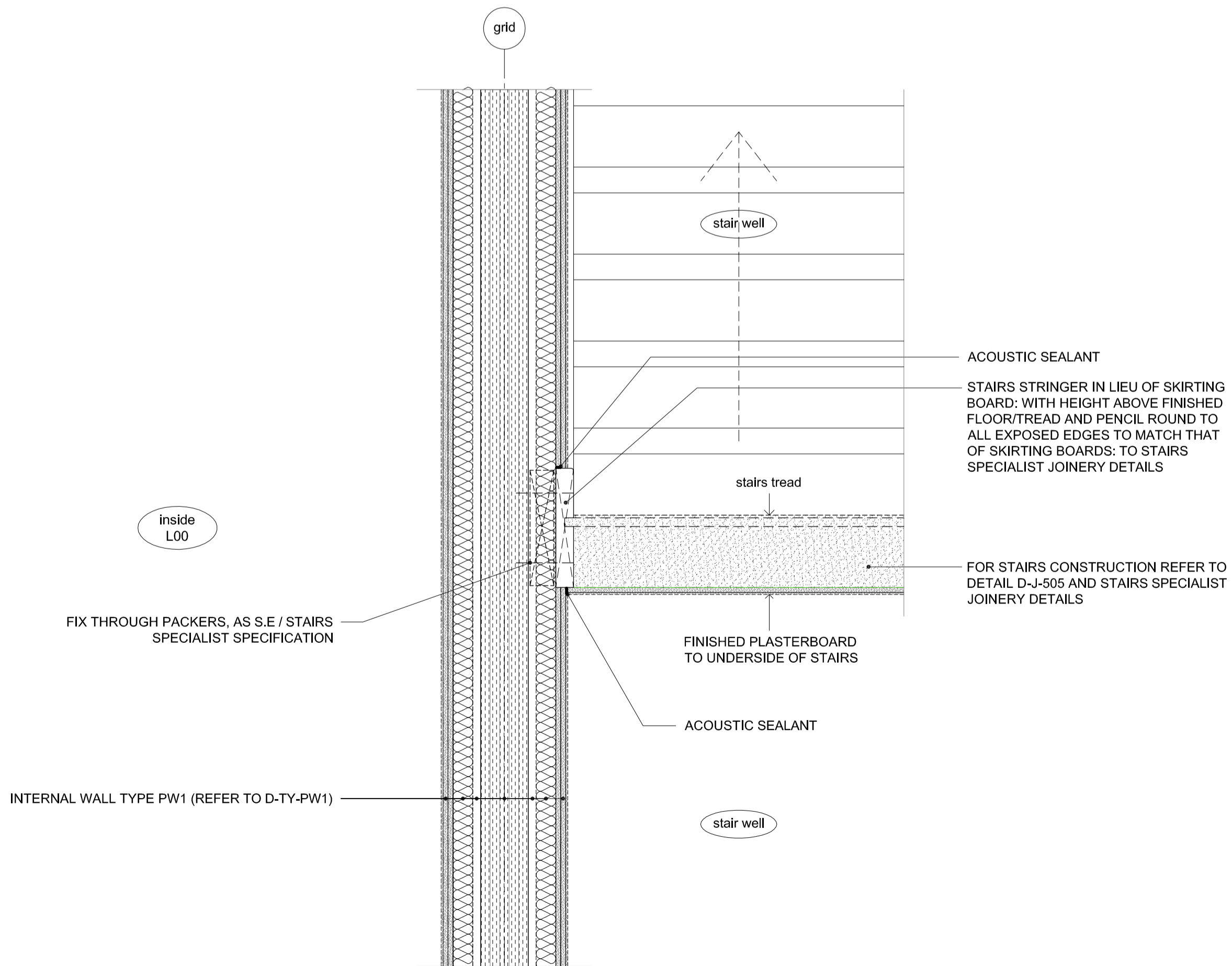

DETAIL - D-J-507 - Block B1 - Stairs type 2 - Stairs / Party Wall / Upper floor

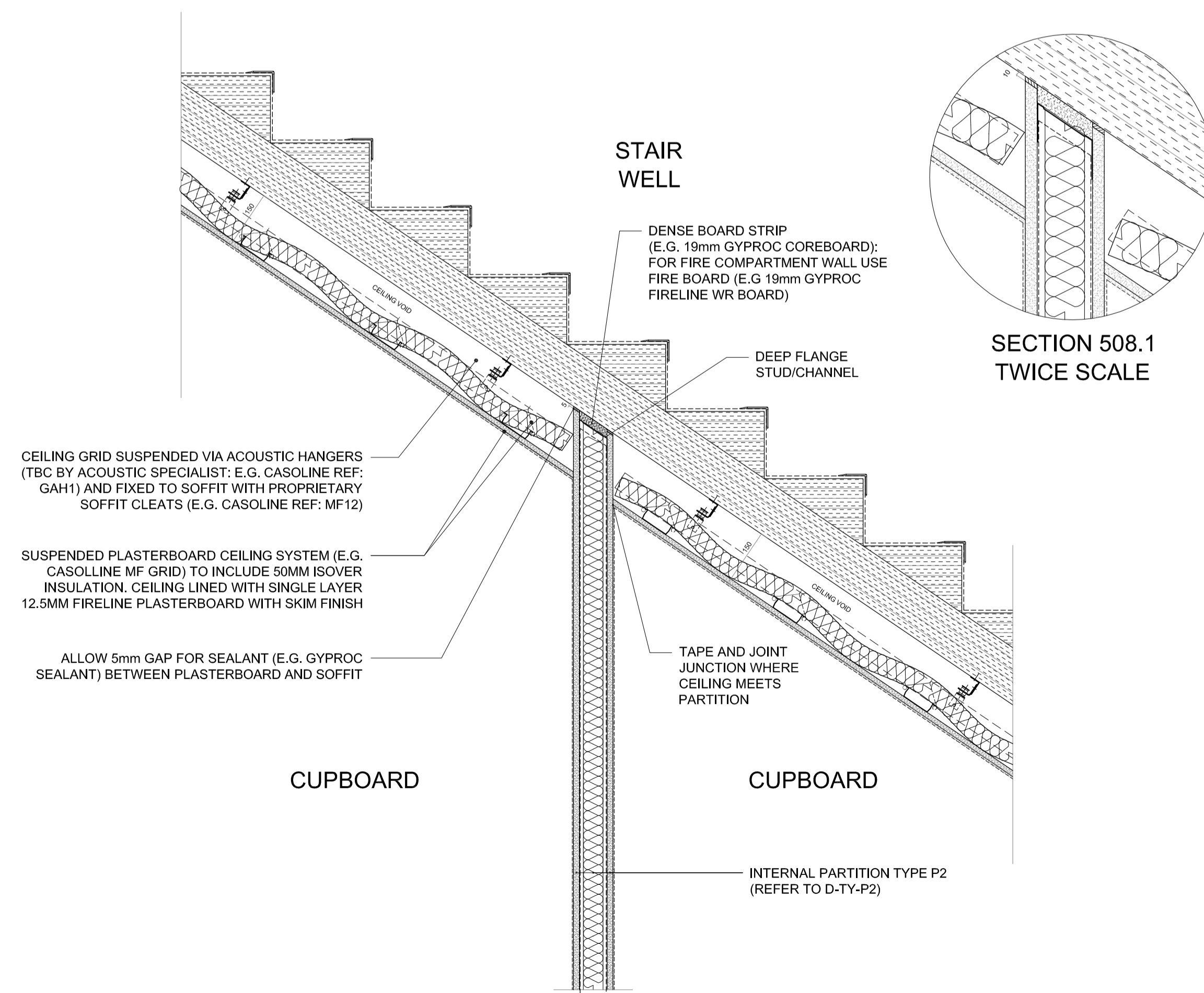

DETAIL - D-J-508 - Block B1 - Under stairs cupboard / Wall head

job: BACTON LOW RISE LONDON NW5	drawn: JPB	date: 08.14
drawing: TYPICAL JUNCTIONS - INTERNAL WALLS Details 505 to 508	scale: 1:10 @ A1 1:20 @ A3	job no: 1952
note: all dimensions to be checked on site at commencement of the work. If this drawing exceeds the quantities in the bill of materials to be informed before the work is commenced. For all applications for planning application purposes do not scale, use dimensions, this drawing is not to scale.	drawing no: D-J-505	rev. as below

rev.	date	description	issued by	checked by
C1	27.08.14	Issued for construction	JPB	GW
C2	08.12.14	Updates in response to KCA comments dated 14.11.14	JPB	GW
C3	23.02.15	Detail D-J-508 added in response to RCL query	JPB	JD