

D-J-421 - Block A - Ground floor / Wall type WT7 / Site boundary

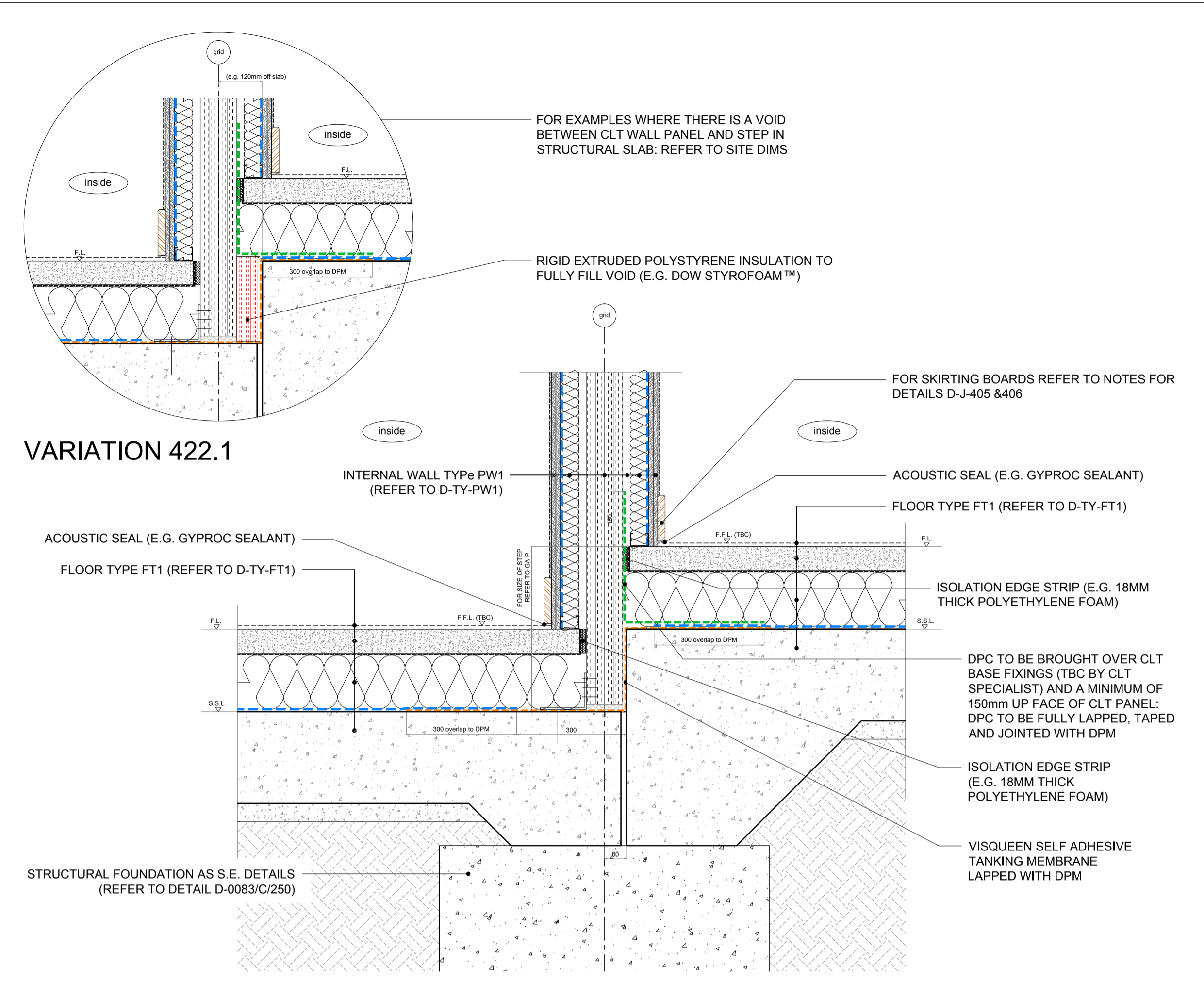

DETAIL - D-J-422 - Block B1 - Party wall - Step in ground floor slab

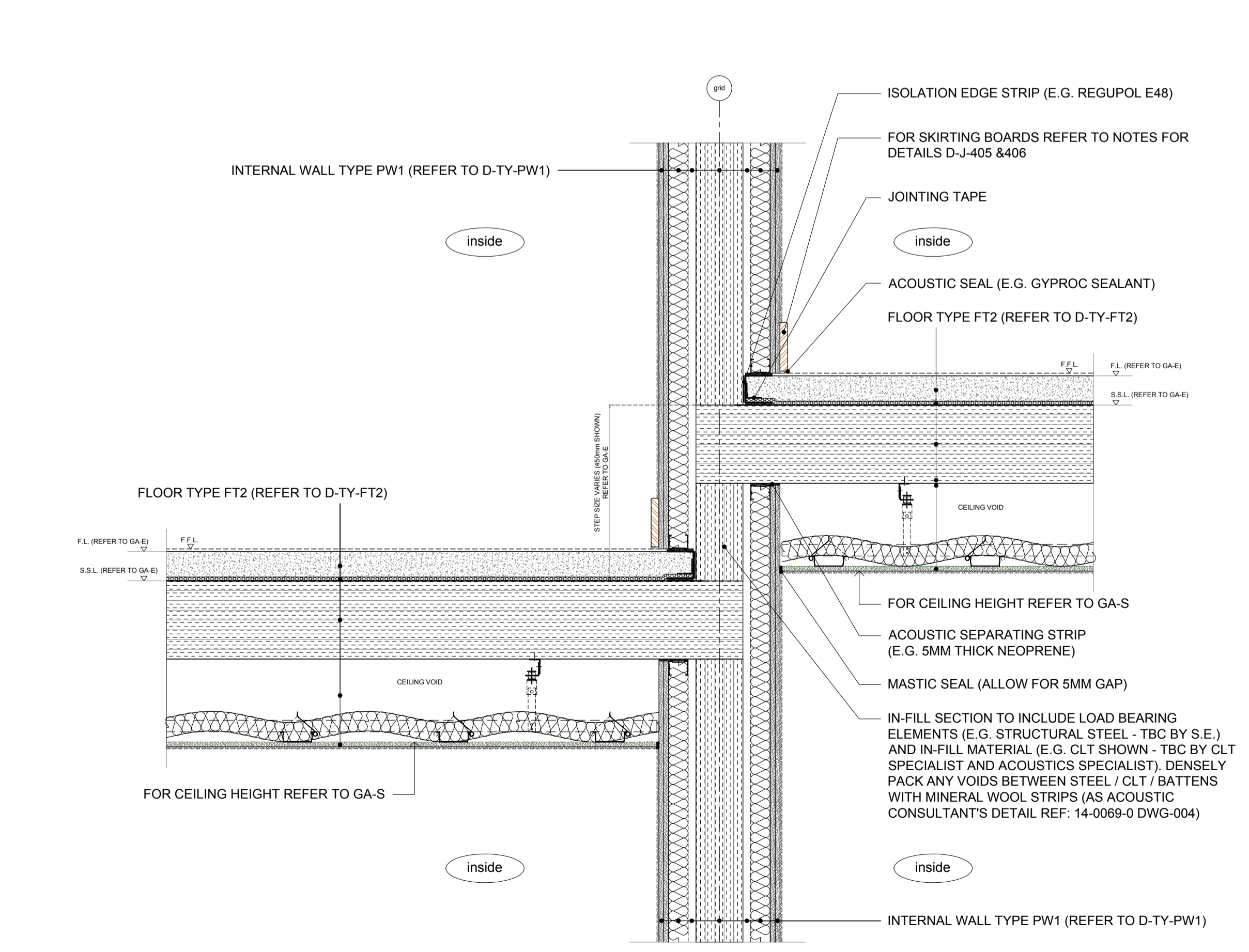

DETAIL - D-J-423 - Party wall - Step in ground floor slab - Section 1

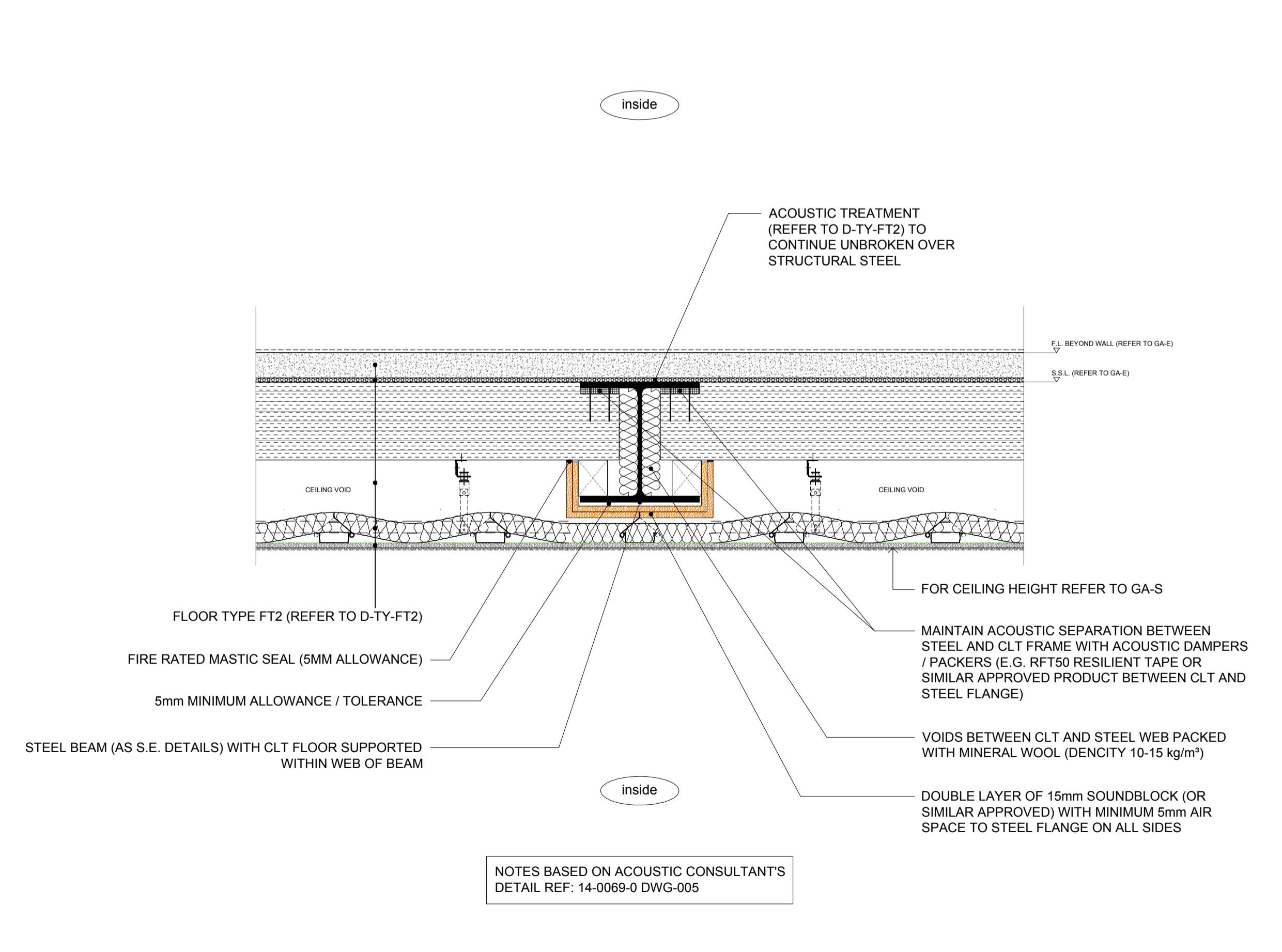

DETAIL - D-J-424 - Party wall - Step in ground floor slab - Section 2

**Rydon** **ALAN CAMP ARCHITECTS**

Alan Camp Architects LLP, 88 Union Street, London, SE1 0NW  
tel: 020 7593 1000. fax 020 7593 1001. mail@alancamp.com

job	BACTON LOW RISE LONDON NW5	drawn by	date	08.14
drawing	TYPICAL JUNCTIONS - INTERNAL WALLS Details 421 to 424	scale	job no.	1952
		1:10 @ A1 1:20 @ A3	drawing no.	D-J-421
			rev.	as below

note: all dimensions to be checked on site. In the event of any discrepancy between the drawings and the site conditions, the contractor shall be responsible for confirming the work. If this drawing exceeds the quantities in any bill of materials to be informed before the work is commenced. For all quantities to be confirmed before the work is commenced, this drawing shall be used for planning application purposes do not scale, use dimensions, this drawing is not to be used for construction.

rev.	date	description	issued by	checked by
C1	27.08.14	Issued for construction	JPB	GW
C2	20.10.14	Wall moved and footing updated for D-J-422 (as Urban and S.E designs)	JPB	GW
C3	08.12.14	Updates in response to KCA comments dated 14.11.14	JPB	GW