

AOV hatch and grab-rail: NTS

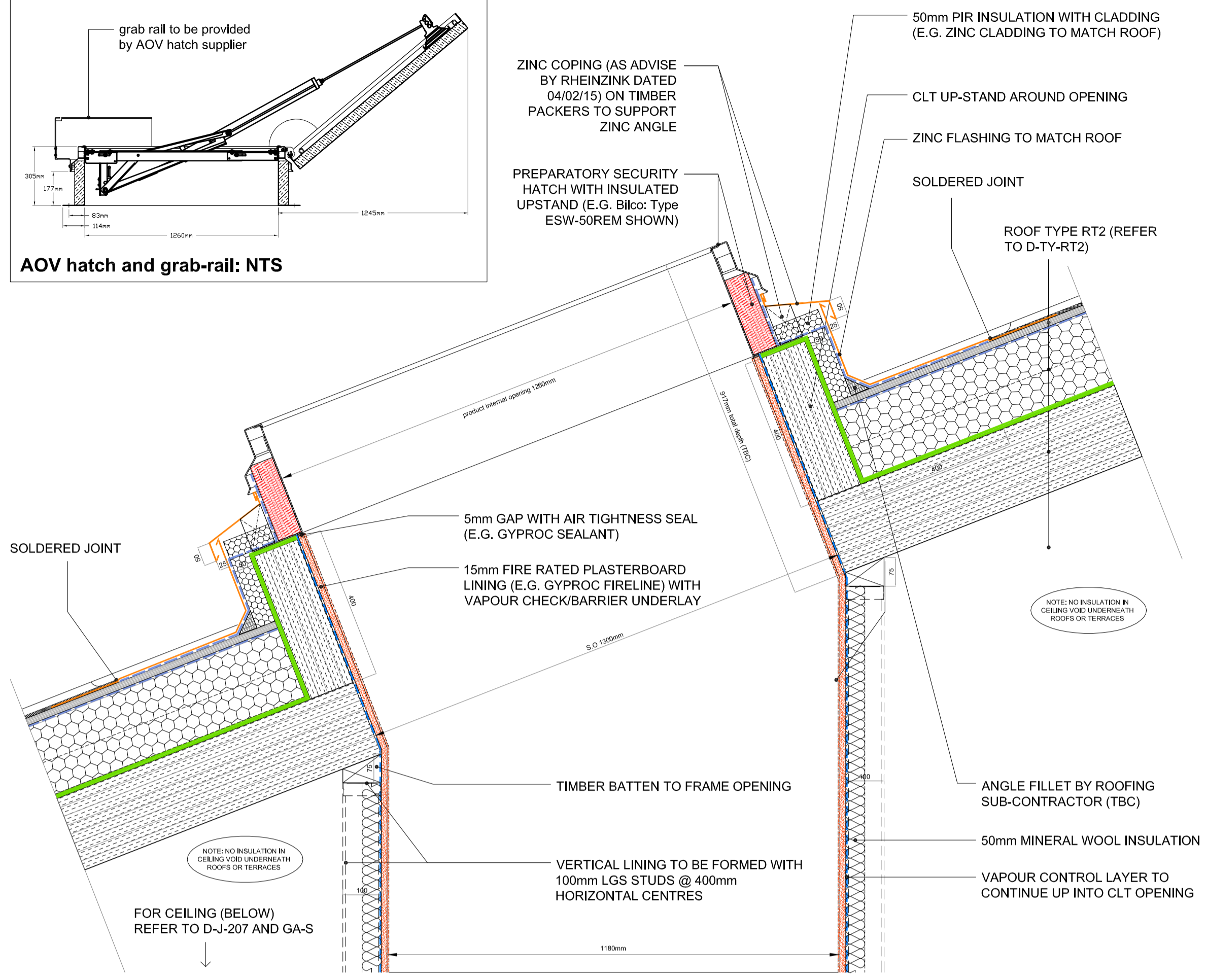

DETAIL - D-J-209 - Block A - AOV / Hatch through roof

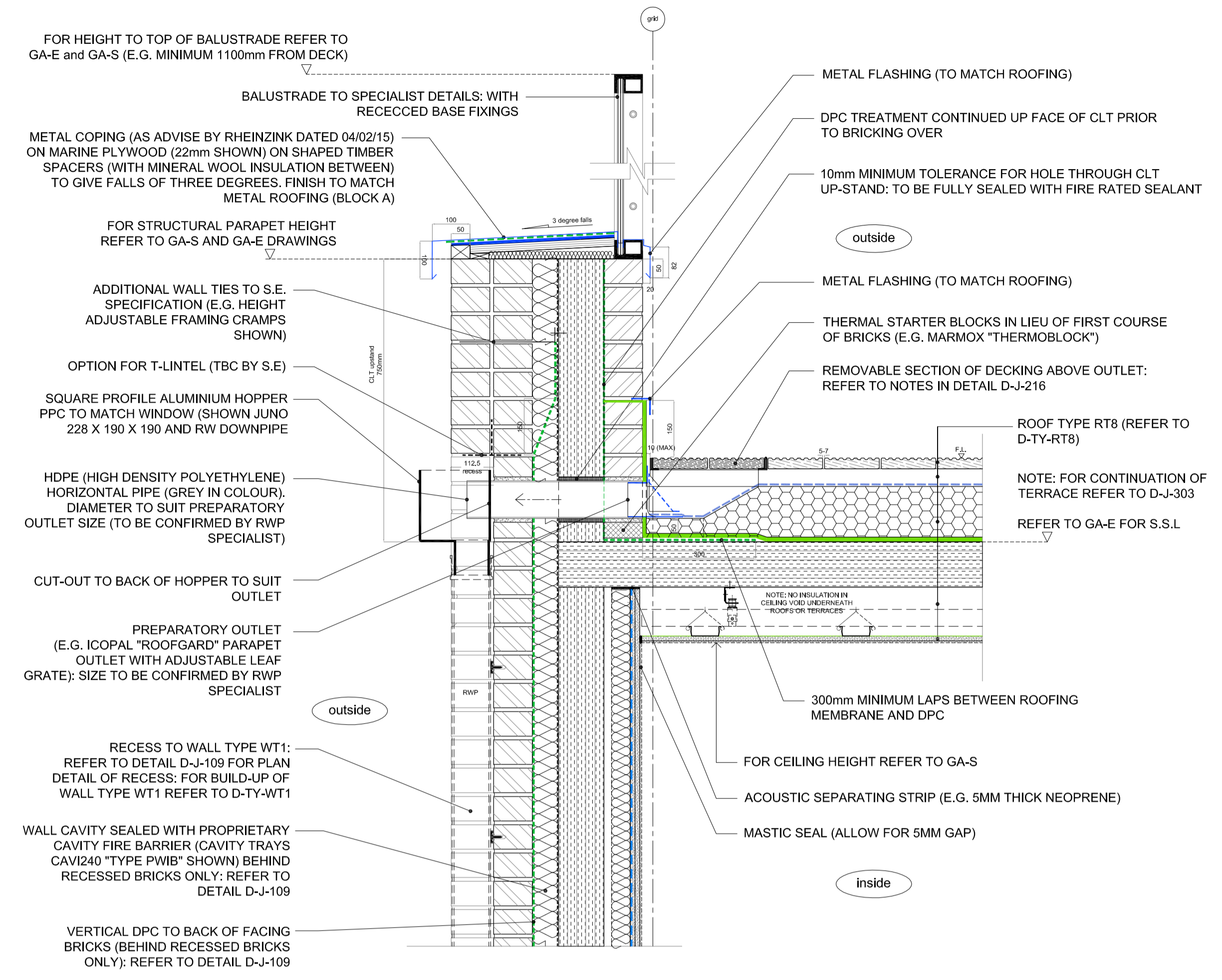

DETAIL - D-J-210 - Blocks B2 - Terrace balustrade and RW outlet

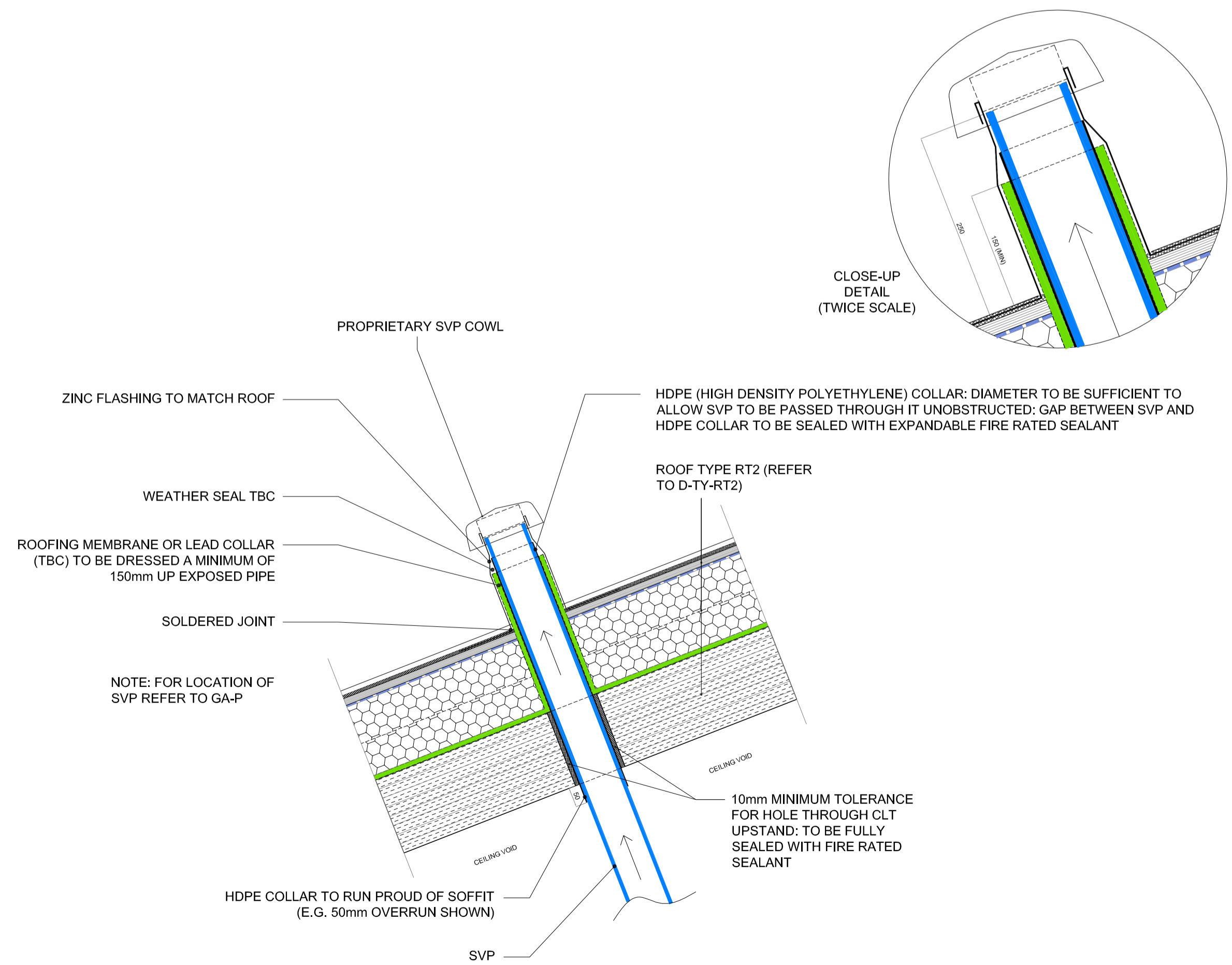

DETAIL - D-J-211 - Typical SVP through roof type RT2

NOT USED

**Rydon**  
ALAN CAMP ARCHITECTS

Alan Camp Architects LLP, 88 Union Street, London, SE1 0NW  
tel: 020 7593 1000, fax: 020 7593 1001, mail@alancamp.com

job: EACTON LOW RISE LONDON NWS	drawn: JPB	date: 08.14
drawing: TYPICAL JUNCTIONS - ROOFS & TERRACES Details 209 to 212	scale: 1:10 @ A1 1:20 @ A3	job no: 1952
note: all dimensions to be checked on site at commencement of the work. If this drawing exceeds the quantities in the bill of materials to be informed before the work is commenced. For all other than planning application purposes do not scale, use dimensions, this drawing is for reference only.	drawing no: D-J-209 to 212	rev. as below

rev.	date	description	issued by	checked by
C1	27.08.14	Issued for construction	JPB	GW
C2	08.12.14	Updates in response to KCA comments dated 14.11.14	JPB	GW
C3	16.01.15	Updates in response to KCA comments dated 07.01.15	JPB	GW
C4	17.02.15	Updates in response to Rheinzink comments dated 04.02.15	JPB	DWW
C5	02.03.15	Updates in response to Bauder comments dated 23.02.15	JPB	JD
C6	12.03.15	Updates in response to Bauder comments dated 10.03.15	JPB	JD
C7	13.03.15	Zinc details updated for final Rheinzink sign-off	JPB	JD
C8	23.03.15	Updates in response to KCA comments dated 10.03.15	JPB	JD

NOTE:  
METAL FLASHING / COPINGS TO MATCH METAL ROOFING MATERIAL & FINISH