

SITE LOCATION
(Scale 1:50000)

Ordnance Survey map extract based upon Landranger map series with the permission of the controller of Her Majesty's Stationery Office Licence No. 100035093 Crown copyright.

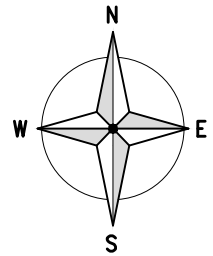

SITE PHOTOGRAPH



DETAILED SITE LOCATION
(Scale 1:1250)

Based upon Ordnance Survey map extract with the permission of the Controller of Her Majesty's Stationery Office. Crown copyright. Licence No. 100035093

ALL DIMENSIONS ARE IN mm UNLESS NOTED OTHERWISE

N.G.R | E: 529083 N: 184014

CONCESSION REQUIRED | NO

DIRECTIONS TO SITE:
LEAVE M11 AT JUNCTION 6, TAKE RIGHT HAND LANE AND JOIN M25, LEAVE THE M25 AT JUNCTION 25, AT ROUNDABOUT TAKE FIRST EXIT ONTO A10 SIGNPOSTED LONDON, ENFIELD, AT GREAT CAMBRIDGE ROUNDABOUT TAKE 2ND EXIT ONTO A10, AT TRAFFIC LIGHTS TURN LEFT ONTO A10, TURN LEFT AT MINI ROUNDABOUT, AT MINI ROUNDABOUT BEAR RIGHT ONTO A10, AT BRUCE GROVE TRAFFIC SIGNALS TURN RIGHT, AT TOTTENHAM HALE CONTINUE FORWARD ONTO A10 SIGNPOSTED CENTRAL LONDON, TURN RIGHT ONTO A503, CONTINUE FORWARD FOR 3 MILES, ARRIVE AT CAMDEN ROAD

NOTES:

REV	MODIFICATION	BY	CH	DATE
B	Antenna fixing detail added	GW	DT	29.05.15
A	Issued for Approval	MB	DT	20.10.14

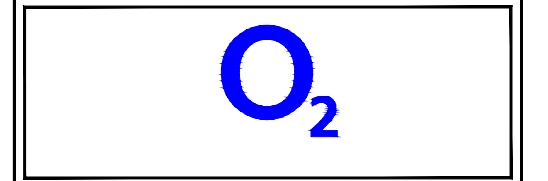

Cell Name	Opt.
GREENDOOR BAZAR	A
CTIL Reference	O2 CSR
149027	(TEF) 70792

Site Address / Contact Details

GREENDOOR BAZAR
58 CAMDEN ROAD
LONDON
NW1 9DR

Drawing Title: SITE LOCATION MAPS			
Purpose of issue: SURVEY DETAIL			
Drawing Number: 100			
Surveyed By: SW	Original Sheet Size: A3	Issue: B	
Drawn: MB	Date: 20.10.14	Checked: DT	Date: 20.10.14

ALL DIMENSIONS ARE IN mm UNLESS NOTED OTHERWISE

N.G.R | E: 529083 | N: 184014

CONCESSION REQUIRED | NO

NOTES:

THE SYSTEM IS DESIGNED TO MEET THE REQUIREMENTS SPECIFIED IN O2 RADIO DATASHEET: 1101: MICROCELL DESIGN, DEPLOYMENT AND DATA BUILD GUIDELINES

REV	MODIFICATION	BY	CH	DATE
B	Antenna fixing detail added	GW	DT	29.05.15
A	Issued for Approval	MB	DT	20.10.14

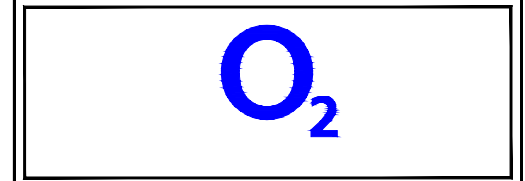

Cell Name | Opt.
GREENDOOR BAZAR | A

CTIL Reference | O2 CSR
149027 | (TEF) 70792

Site Address / Contact Details
GREENDOOR BAZAR
58 CAMDEN ROAD
LONDON
NW1 9DR

Drawing Title:
SITE PLAN

Purpose of issue:
SURVEY DETAIL

Drawing Number:
200

Surveyed By: SW	Original Sheet Size: A3	Issue: B
Drawn: MB	Date: 20.10.14	Checked: DT
	Date: 20.10.14	

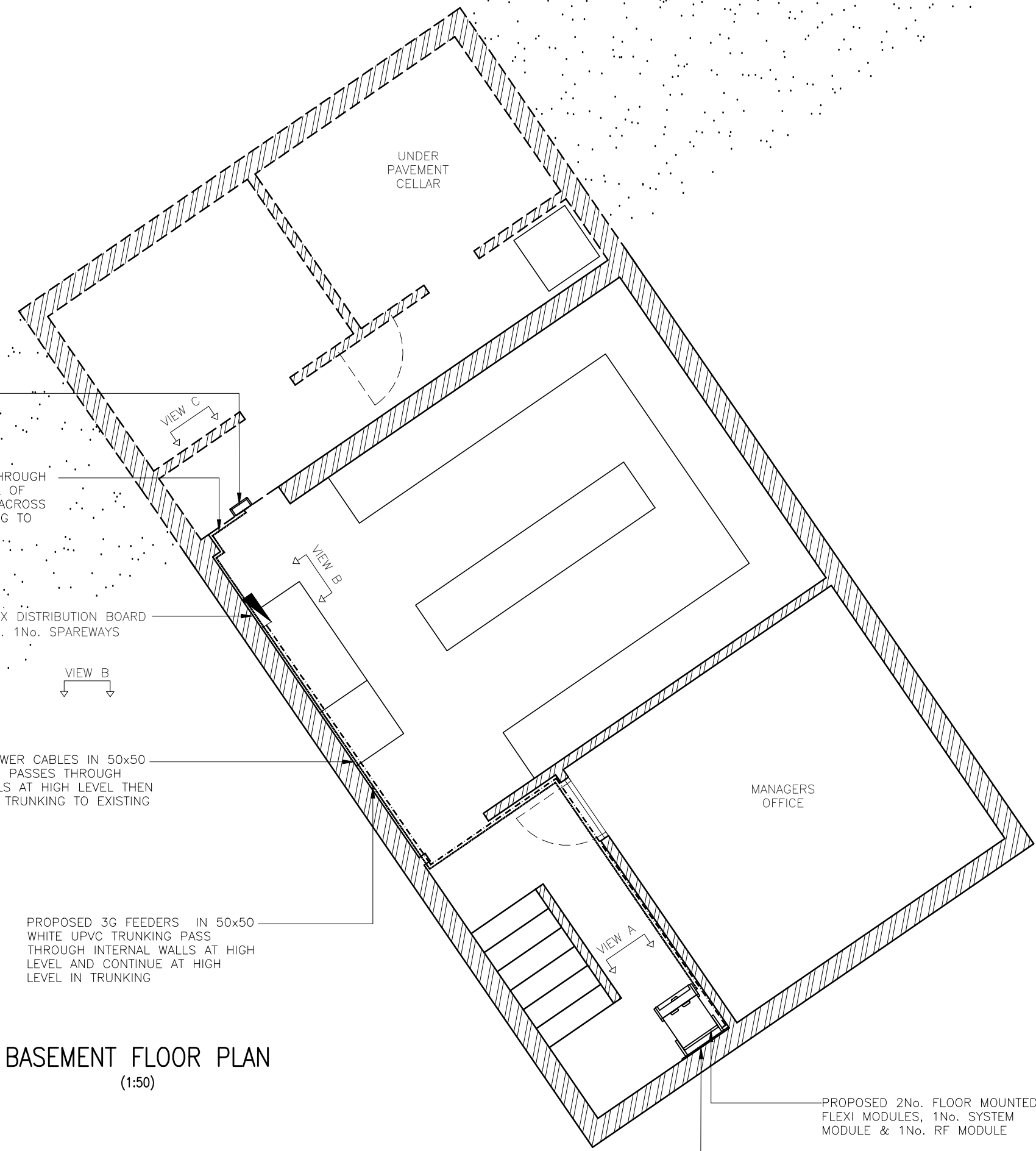

PROPOSED 3G BELLBOX ANTENNA A1 AT 6.0m A.G.L.

PROPOSED 3G FEEDERS EXIT THROUGH EXISTING OPENING TO EXTERNAL OF BUILDING. FEEDERS THEN RUN ACROSS THE WALL AND UP THE BUILDING TO PROPOSED ANTENNA LOCATION

EXISTING WYLEX DISTRIBUTION BOARD C/W 16A MCB. 1No. SPAREWAYS

PROPOSED POWER CABLES IN 50x50 PVC TRUNKING PASSES THROUGH INTERNAL WALLS AT HIGH LEVEL THEN CONTINUES IN TRUNKING TO EXISTING DIST. BOARD

PROPOSED 3G FEEDERS IN 50x50 WHITE UPVC TRUNKING PASS THROUGH INTERNAL WALLS AT HIGH LEVEL AND CONTINUE AT HIGH LEVEL IN TRUNKING

PROPOSED 2No. FLOOR MOUNTED 3G FLEXI MODULES, 1No. SYSTEM MODULE & 1No. RF MODULE

PROPOSED WALL MOUNTED COMMS BOARD C/W 6U ALIFABS BRACKET AND ELTEK MINIPACK PSU, 1No. DOUBLE SOCKET, 2No. FUSED SPUR

BASEMENT FLOOR PLAN
(1:50)

ALL DIMENSIONS ARE IN mm UNLESS NOTED OTHERWISE

N.G.R E: 529083 N: 184014

CONCESSION REQUIRED NO

NOTES:

PROPOSED POWER CABLE IN 50x50 WHITE UPVC TRUNKING

PROPOSED 3G IN 50x50mm WHITE PVC TRUNKING FEEDERS PASS THROUGH INTERNAL WALLS AT HIGH LEVEL TO PROPOSED ANTENNA LOCATION

PROPOSED COMMS WALL BOARD C/W ALIFABS 6U WALL BRACKET AND ELTEK MINIPACK PSU, 1No. DOUBLE SOCKET & 2No. FUSED SPURS

PROPOSED 2No. FLOOR MOUNTED 3G FLEXI MODULES. 1No. SYSTEM MODULE, 1No. RF MODULE

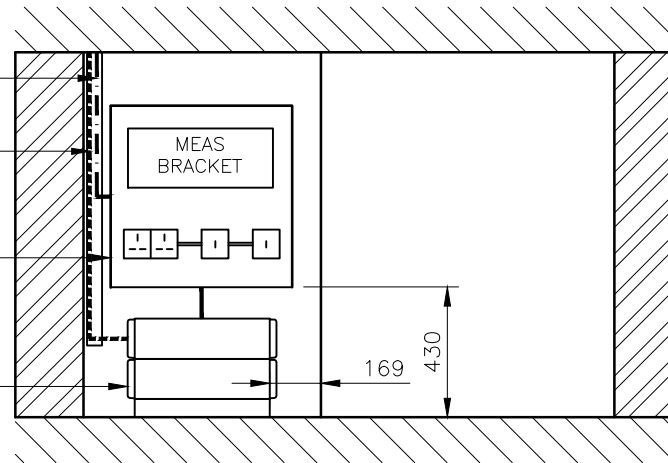

EQUIPMENT ELEVATION
(1:25)



PROPOSED 3G BELLBOX ANTENNA A1 LOCATION

ANTENNA HEIGHT (APPROX) +6.0m AGL

GL

REV	MODIFICATION	BY	CH	DATE
B	Antenna fixing detail added	GW	DT	29.05.15
A	Issued for Approval	MB	DT	20.10.14

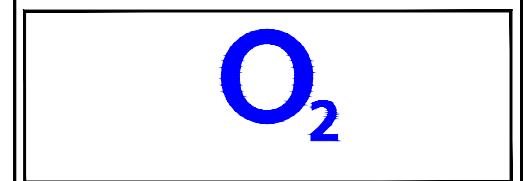

Cell Name	Opt.
GREENDOOR BAZAR	A

CTIL Reference	O2 CSR
149027	(TEF) 70792

Site Address / Contact Details	
GREENDOOR BAZAR 58 CAMDEN ROAD LONDON NW1 9DR	

Drawing Title: SITE ELEVATIONS

Purpose of issue: SURVEY DETAIL

Drawing Number: 300

Surveyed By: SW	Original Sheet Size: A3	Issue: B
Drawn: MB	Date: 20.10.14	Checked: DT
		Date: 20.10.14

PROPOSED ANTENNA LOCATION

The drawings comply with TEF Standard ICNIRP guidelines.
Designed in accordance with Cornerstone document: CORN/09/006

ALL DIMENSIONS ARE IN mm UNLESS NOTED OTHERWISE

N.G.R E: 529083 N: 184014

CONCESSION REQUIRED NO

NOTES:

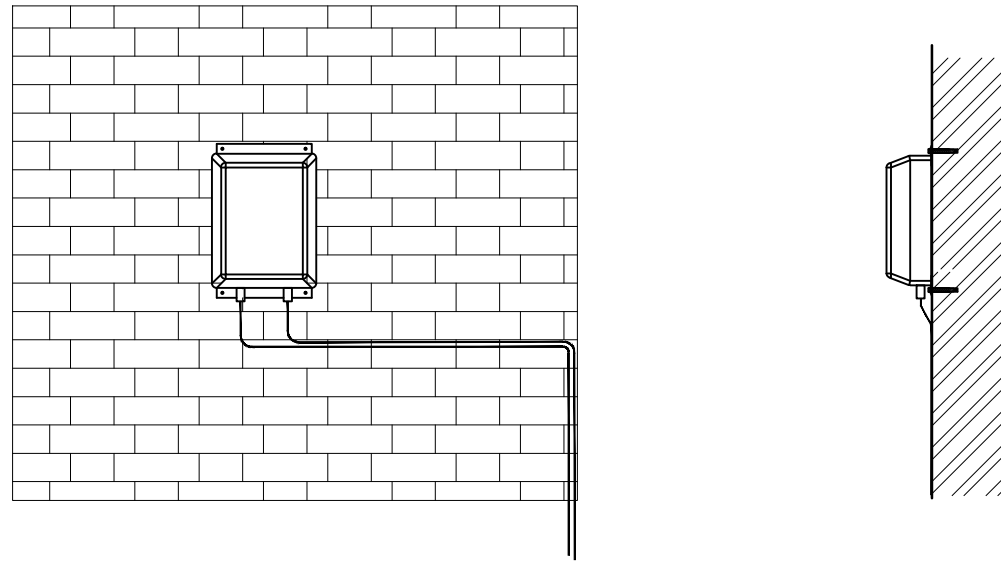

FIXING DETAIL
(1:20)



PROPOSED 3G BELLBOX
ANTENNA A1 LOCATION

ANTENNA HEIGHT
(APPROX) +6.0m AGL

GL

PROPOSED ANTENNA LOCATION

A	Issued for Approval	MB	DT	20.10.14
REV	MODIFICATION	BY	CH	DATE

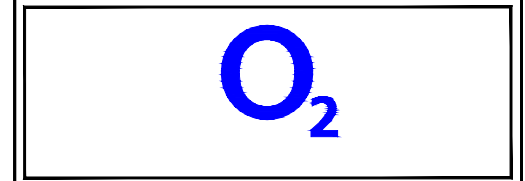

Cell Name		Opt.
GREENDOOR BAZAR		A
CTIL Reference	O2 CSR	
149027	(TEF) 70792	

Site Address / Contact Details

GREENDOOR BAZAR
58 CAMDEN ROAD
LONDON
NW1 9DR

Drawing Title: ANTENNA FIXING DETAIL				
Purpose of issue: SURVEY DETAIL				
Drawing Number: 301				
Surveyed By: SW		Original Sheet Size: A3		Issue:
Drawn: MB	Date: 20.10.14	Checked: DT	Date: 20.10.14	A

The drawings comply with TEF Standard ICNIRP guidelines.
Designed in accordance with Cornerstone document: CORN/09/006



VIEW A – PROPOSED 3G EQUIPMENT LOCATION

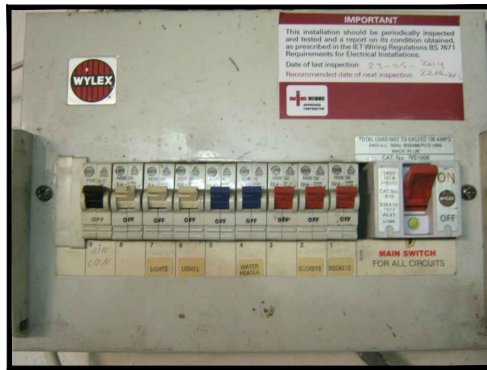

VIEW B – EXISTING DISTRIBUTION BOARD



VIEW C – PROPOSED 3G BELLBOX ANTENNA LOCATION (A1)



PANORAMIC PHOTO 1 (275°)



PANORAMIC PHOTO 2 (320°)



PANORAMIC PHOTO 3 (5°)



PANORAMIC PHOTO 4 (50°)



PANORAMIC PHOTO 5 (95°)

SITE PHOTOGRAPHS

ALL DIMENSIONS ARE IN mm UNLESS NOTED OTHERWISE

N.G.R. E: 529083 N: 184014

CONCESSION REQUIRED NO

NOTES:

REV	MODIFICATION	BY	CH	DATE
B	Antenna fixing detail added	GW	DT	29.05.15
A	Issued for Approval	MB	DT	20.10.14

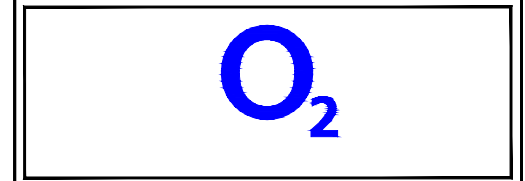

Cell Name	Opt.
GREENDOOR BAZAR	A

CTIL Reference	O2 CSR
149027	(TEF) 70792

Site Address / Contact Details
 GREENDOOR BAZAR
 58 CAMDEN ROAD
 LONDON
 NW1 9DR

Drawing Title: SITE PHOTOGRAPHS

Purpose of issue: SURVEY DETAIL

Drawing Number: 400

Surveyed By: SW	Original Sheet Size: A3	Issue: B
Drawn: MB	Date: 20.10.14	Checked: DT
		Date: 20.10.14

ALL DIMENSIONS ARE IN mm UNLESS NOTED OTHERWISE

N.G.R | E: 529083 | N: 184014

CONCESSION REQUIRED | NO

NOTES:

B	Antenna fixing detail added	GW	DT	29.05.15
A	Issued for Approval	MB	DT	20.10.14
REV	MODIFICATION	BY	CH	DATE



Cell Name	Opt.
GREENDOOR BAZAR	A

CTIL Reference	O2 CSR
149027	(TEF) 70792

Site Address / Contact Details
GREENDOOR BAZAR 58 CAMDEN ROAD LONDON NW1 9DR

Drawing Title: SYSTEM SCHEMATIC

Purpose of issue: SURVEY DETAIL

Drawing Number: 500

Surveyed By: SW	Original Sheet Size: A3	Issue: B
Drawn: MB	Date: 20.10.14	Checked: DT
		Date: 20.10.14

EXTERNAL

INTERNAL

PROPOSED
3G BELLBOX (7824-400)
ANTENNA A1
(INCLUDING OVERSHROUD)



PROPOSED 2.0m
ANTENNA TAILS



PROPOSED 2 x LDF4-50
FEEDER CABLES

(25.0m x 2)

PROPOSED 2No. 3G FLEXI
MODULES (1No. SYSTEM
MODULE, 1No. RF MODULE)

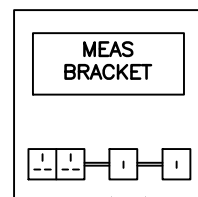
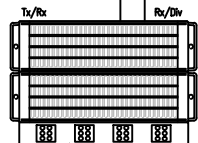

PROPOSED COMMS BOARD C/W
6U BRACKET, ELTEK MINIPACK
PSU, 1x DOUBLE SOCKET,
2xFUSED SPUR UNITS

COMMS LINK

POWER LINK

(15.0m)

PROPOSED FP200 POWER CABLE
(4.0mm²) C/W 16mm² CPC

EXISTING SP WYLEX DISTRIBUTION
BOARD C/W NEW 16AMP MCB

FIBRE

PROPOSED SELECTED
COMMS SUPPLIER

SYSTEM SCHEMATIC
(N.T.S.)

BILL OF MATERIALS				
TYPE	MANUFACTURER	MODEL	DESCRIPTION	QTY
ANTENNA	AMPHENOL	7824-400	1No. 3G BELLBOX ANTENNA PAINTED BROWN TO MATCH BRICKWORK	1
MCB	WYLEX	16A	NEW WYLEX 16A MCB	1
POWER CABLE	PIRELLI	FP200	3 CORE 4.0mm ²	15m
FEEDER CABLE	ANDREW	LDF4-50	50 ohms 1/2" COAXIAL CABLE- FOAM DIELECTRIC FLAME RETARD	50m
FEEDER CABLE	ANDREW	FSJ4-50	ANTENNA TAILS	4m
CONNECTORS	ANDREW	N-MALE	FOR CONNECTION TO ANTENNA TAILS	4
CONNECTORS	ANDREW	DIN MALE ANGLE	FOR CONNECTION TO FLEXI MODULES	2
POWER / COMMS BOARD	10mm PLYWOOD	600mm x 600mm	C/W DOUBLE SOCKET & 2 X FUSED SPUR UNITS	1
FEEDER CLEATS	ANDREW	-	DOUBLE CLEATS	0
MICROCELL (3G)	NOKIA	FLEXI MODULES FLOOR MOUNTED	1No. SYSTEM MODULE & 1No. RF MODULE	2
TRUNKING	TRUNKING	50mm x 50mm	WHITE PVC TRUNKING	20m
MEAS	ALIFABS	6U	6U WALL BRACKET	1
1U POWER SUPPLY	ELTEK	MINI PACK	1.6KW SYSTEM C/W DC DISTRIBUTION & CONTROLLER & 16AMP FUSE	1

ANTENNA AND FEEDER KEY						
No.	SECTOR	ANTENNA TYPE	LOCATION	APPROX HEIGHT	FEEDER LENGTH	FEEDER TYPE
A1	3G	AMPHENOL 7824-400	CAMDEN ROAD	6.0m	25m x 2	LDF4-50

EXISTING/ PROPOSED	ENCLOSURE	U SPACE AVAILABLE	EXISTING INCOMING FIBRE LOCATION	EXISTING TRANSMISSION EQUIPMENT LOCATION	PROPOSED TRANSMISSION EQUIPMENT LOCATION	COMMENTS
PROPOSED	WALL MOUNT	6U	FIBRE	-	WALL MOUNT WITH PROPOSED 3G FLEXI MODULES	-

BILL OF MATERIALS

ALL DIMENSIONS ARE IN mm UNLESS NOTED OTHERWISE

N.G.R | E: 529083 | N: 184014

CONCESSION REQUIRED | NO

NOTES:

B	Antenna fixing detail added	GW	DT	29.05.15
A	Issued for Approval	MB	DT	20.10.14
REV	MODIFICATION	BY	CH	DATE



Cell Name | Opt.
GREENDOOR BAZAR | A

CTIL Reference | O2 CSR
149027 | (TEF) 70792

Site Address / Contact Details
GREENDOOR BAZAR
58 CAMDEN ROAD
LONDON
NW1 9DR

Drawing Title:
BILL OF MATERIALS

Purpose of issue:
SURVEY DETAIL

Drawing Number:
600

Surveyed By: SW	Original Sheet Size: A3	Issue: B
Drawn: MB	Date: 20.10.14	Checked: DT
Date: 20.10.14	Date: 20.10.14	