

DO NOT SCALE OFF THIS DRAWING
ALL DIMENSIONS MUST BE CHECKED ON SITE
INFORM THE ARCHITECT OF ANY
DISCREPANCIES PRIOR TO CONSTRUCTION
PLOT SIZE: A1

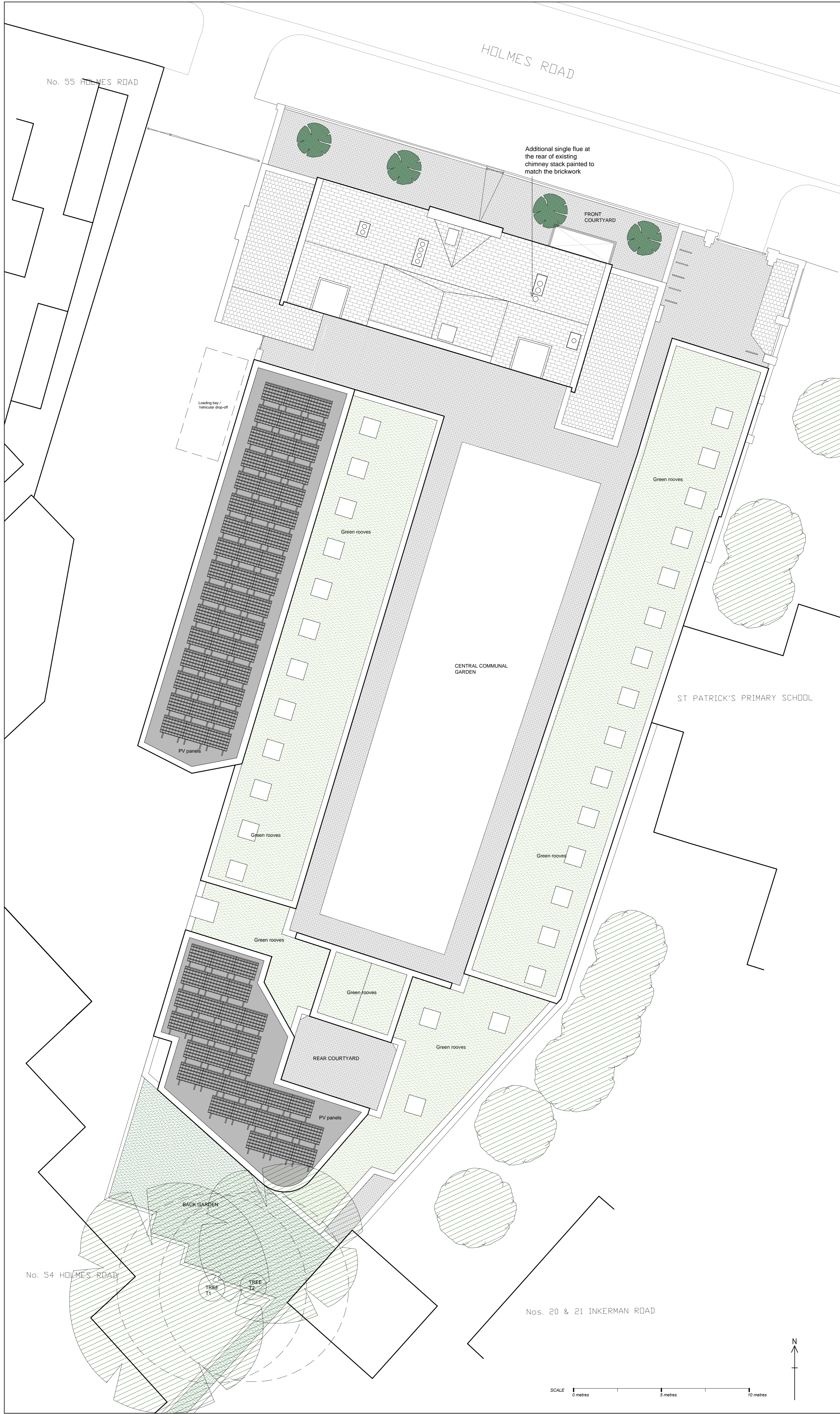

REVISIONS:
A 29.05.12 Draft Stage D
B 18.06.12 For Information
C 26.06.12 Final Client SignOff Record Set
D 20.07.12 FINAL DRAFT PLANNING SET
E 13.09.12 Revised to indicate PV panels
F 15.10.12 FINAL PLANNING SET
G 07.02.13 UPDATED FOR PLANNING
H 14.05.13 PV PANELS AMENDED
J 20.08.13 26 garden studio units reduced to 25
PV panels added
K 09.10.13 Rooflights amended
L 28.10.14 Existing building additional chimney added
M 09.07.15 Minor amendment to flue

PETER BARBER
ARCHITECTS

173 Kings Cross Road LONDON WC1X 9BZ
T:020 7833 4499 F:020 7833 4999
e:architecture@peterbarberarchitects.com

Job: 41 - 43 Holmes Road, NW5 3AN

CLIENT: London Borough of Camden

SCALE: 1/100 @ A1 DATE: 11.11
DRAWN: JP CHECKED: PB

TITLE: PROPOSED SITE PLAN
INCLUDING ROOF PLAN
ISSUED FOR PLANNING

DRAWING NO: 100_P_01P REV: M