

ALL DIMENSIONS ARE INDICATIVE.
CONTRACTORS TO VERIFY DIMENSIONS ON SITE.

General notes:
 1. Do not scale drawings. Dimensions govern.
 2. All dimensions are in millimeters unless noted otherwise.
 3. All dimensions shall be verified on site before proceeding with the work.
 4. Square Feet Architects shall be notified in writing of any discrepancies.

Party Wall Act 1996:
 Note: If the project progresses onto site without the involvement of Square Feet Architects the Client must seek advice prior to commencement of the planned works as detailed on the drawings to establish whether the works fall within the scope of the Act which required adjoining property owners to be served with a statutory notice.

C.D.M. Regulations 1994:
 These drawings have been produced for the purpose of applying for Planning and Building Regulations only. If the project progresses on to site without the involvement of Square Feet Architects, the client and contractor must ensure that they fulfil the duties in respect of the construction (Design and Management) Regulations 1994.
 If advice is required please do not hesitate to contact Square Feet Architects

PRIOR TO ANY WALLS BEING REMOVED A STRUCTURAL ENGINEER SHOULD BE CONSULTED

ELECTRICAL KEY

- ⌚ Double power socket
- ⌚ Samp power socket
- ☎ Telephone socket
- 📺 TV aerial socket
- ⌚ External socket
- ⌚ Shaver socket
- ⌚ Double power floor socket
- 📶 Data socket (cat5)

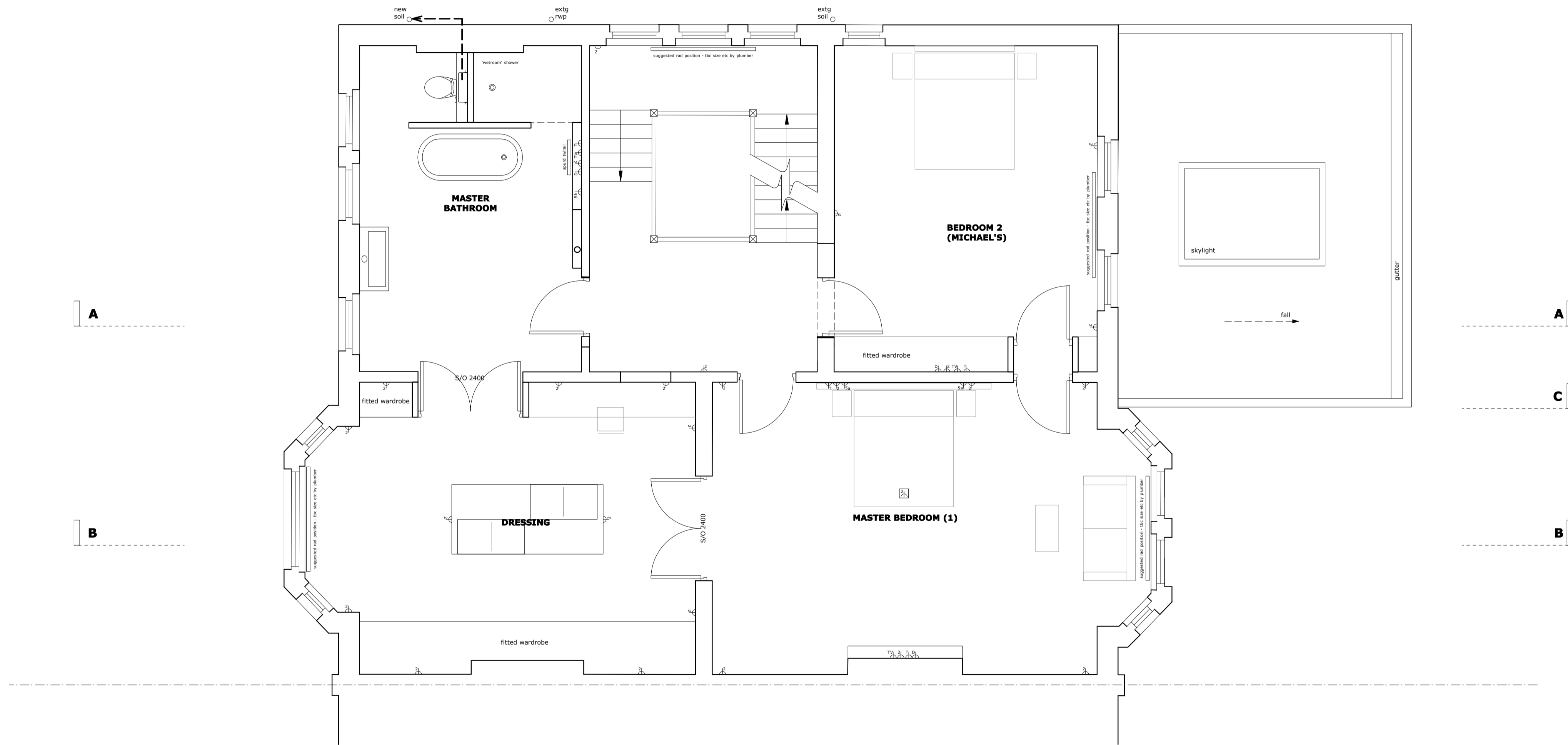
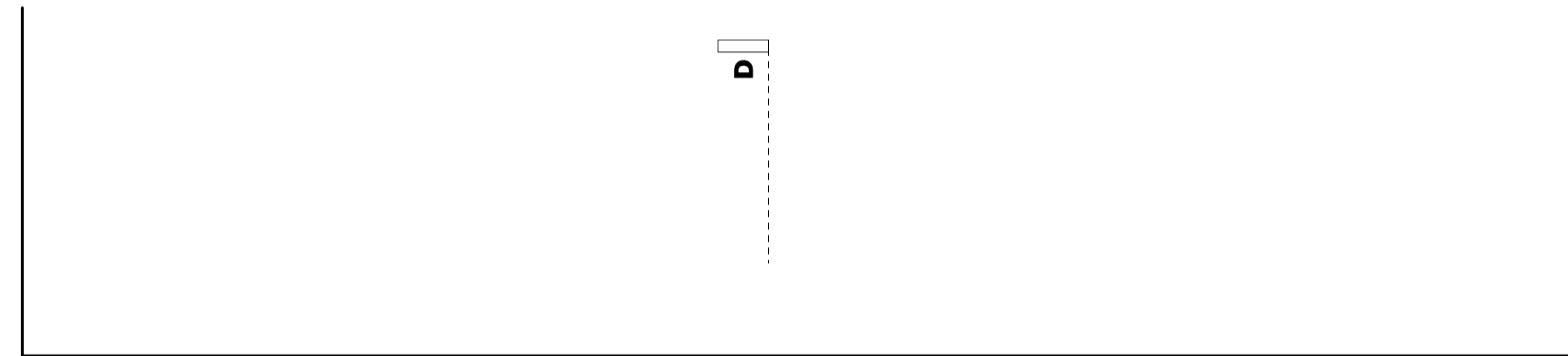

revision:
A - 22.10.09 - REFORMATTED
B - 02.11.09
C - 06.11.09
D - 25.11.09
E - 16.12.09
F - 18.01.10
G - 12.6.15 - As Built Drawings

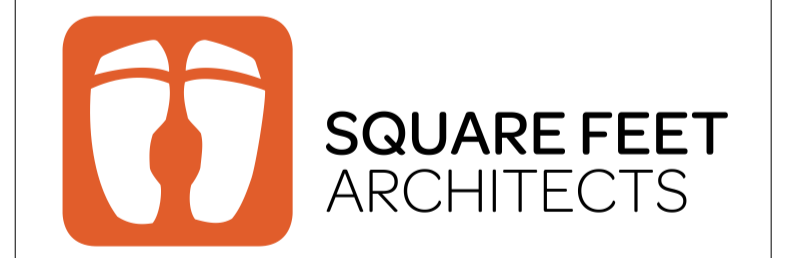

SQUARE FEET ARCHITECTS
 A : 10 Perrins Court, London NW3 1QS
 T : 0207 431 4500
 E : studio@squarefeetarchitects.co.uk
 W : www.squarefeetarchitects.co.uk

drawing title:
FIRST FLOOR PLAN - AS BUILT

client:
 MOUSKOS FAMILY

project:
15 Chesterford Gardens, NW3 7DD

date: Sept 2009	scale: 1:50 @ A1 1:100 @ A3
--------------------	-----------------------------------

drawing number: 0919-L-033	revision: G
--------------------------------------	-----------------------