

Dempsey, Matthew

From: nik novich <nnovich1@yahoo.co.uk>
Sent: 11 June 2015 16:41
To: Dempsey, Matthew
Subject: Re: 111A Sumatra rd NW6
Attachments: img 111 a 2 bed house.pdf

Follow Up Flag: Follow up
Flag Status: Flagged

Dear Matthew,

I know you have a floor plans but just in case I'll send you new floor plan and photo as well of the property. It might help.

Sumatra Road, London, NW6

APPROX. GROSS INTERNAL FLOOR AREA 883 SQ FT

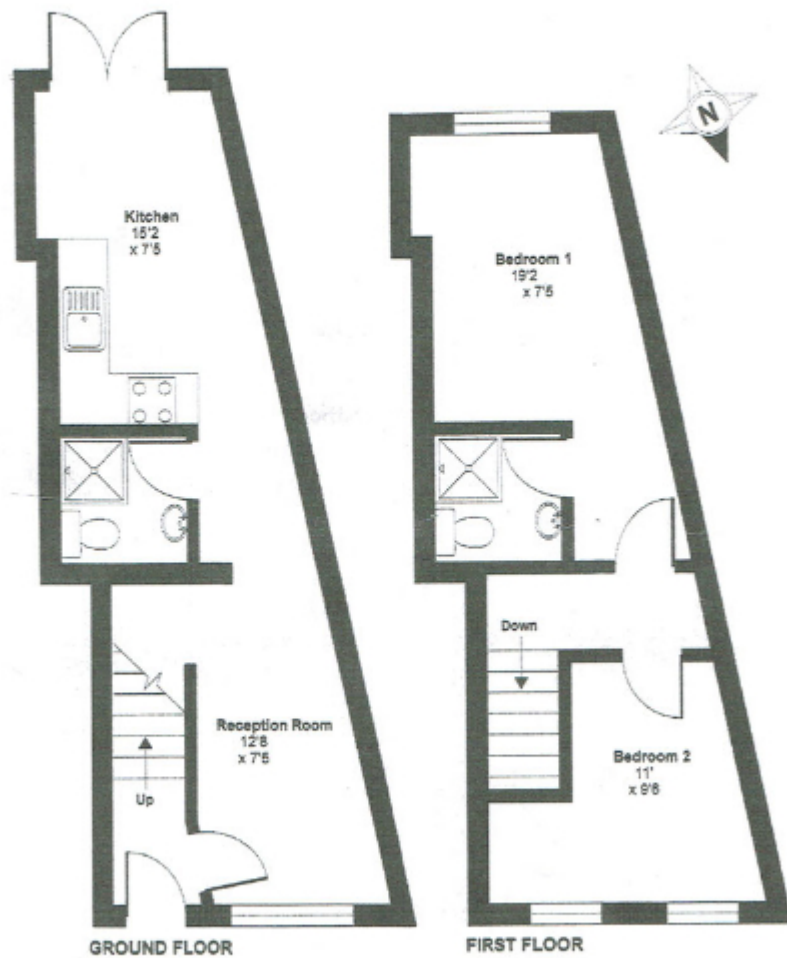

Kind regards

Nik

On Thursday, 11 June 2015, 14:44, "Dempsey, Matthew" <Matthew.Dempsey@Camden.gov.uk> wrote:

Dear Mr Novich,

Please accept my apologies – I do have floor plans for both ground and 1st floors – I will review your additional documents with my colleagues and get back to you asap.

Kind regards,
Matthew

From: nik novich [mailto:nnovich1@yahoo.co.uk]

Sent: 11 June 2015 09:07

To: Dempsey, Matthew; N. N.

Subject: 111A Sumatra rd NW6

Dear Mr Dempsey,

Thank you for your email. I'm back from holiday so I'll take over from agent David Ross. Please find enclosed Copy of Title Deeds, Gas, Electric, Council Tax bills Floor plans for property known as 111 A Sumatra rd NW6. Also I enclosed emails from two of your colleges from Camden Planning Department Mr Sam Watts and Mr Neil Luxton, who dealt with this property in the past.

If you need any more information do not hesitate to contact me.

Kind Regards

Nik Novich
mob; 07876171583

Dear Mr Ross,

Thank you for your additional information received 29/05/2015.

I have discussed this with a colleague and we will require further information in order to come to a decision on this.

Please provide floor plans for 111A Sumatra Road, for all floors.

Please provide documentation from the Land Registry to confirm ownership.

Please provide any other evidence pertaining to the use of this property you may have from the Council, such as Council tax records, or; any other utility bills addressed to the property.

Should you have any queries, please contact me.

This e-mail may contain information which is confidential, legally privileged and/or copyright protected. This e-mail is intended for the addressee only. If you receive this in error, please contact the sender and delete the material from your computer.