

BUBBLE INDICATES EXTENT OF PROPOSED CHANGES TO CONSENTED SCHEME

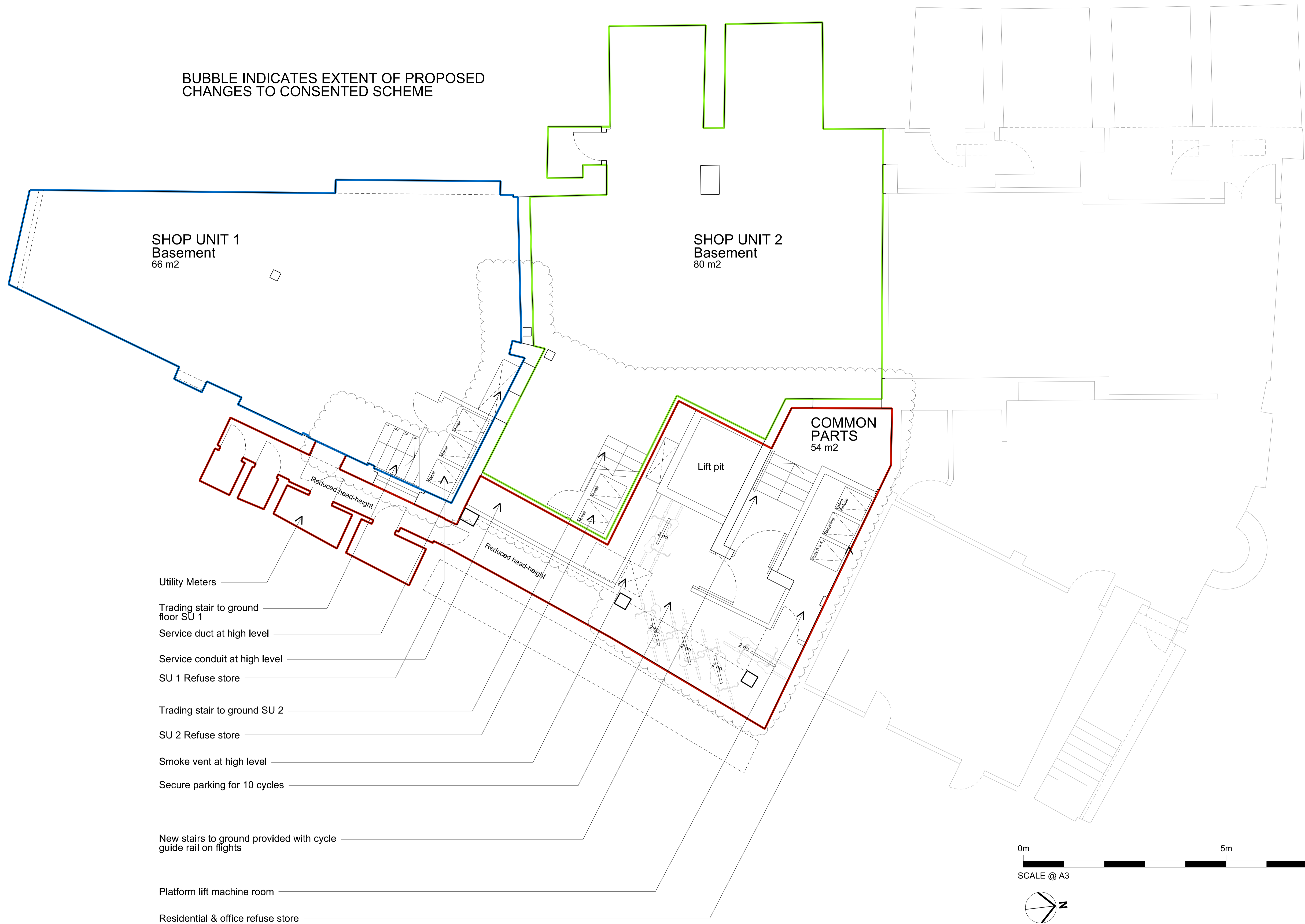

General Notes

- Do not scale from this drawing. Refer to stated dimensions.
- All dimensions to be verified on site by the contractor, before proceeding, and such dimensions to be his responsibility.
- Report all drawing errors, omissions and discrepancies to Morrow + Lorraine Ltd.
- All stated areas on this drawing are approximate and to be treated as strictly indicative.
- Any Ordnance Survey mapping data in this drawing is used under license. Its use is strictly for the preparation of information for this project. Where used Ordnance Survey copyright acknowledgement must be displayed. At project completion all Ordnance Survey data supplied must be deleted and all paper copies destroyed.

Rev	Date	Reason For Issue	Chk
P01	17/03/15	NMA APPLICATION	-
P02	15/06/15	REFUSE STORAGE AMENDED	-

Rev	Date	Reason For Issue	Chk



MORROW LORRAINE
 MORROW+LORRAINE ARCHITECTS
 27 MARGARET STREET LONDON W1W 8RY
 T +44 (0)20 7580 8813 F +44 (0)20 7637 3328
 INFO@MORROWLORRAINE.COM
 WWW.MORROWLORRAINE.COM
 MORROW+LORRAINE LTD REGISTERED IN ENGLAND NO.6802153

JOB TITLE		DRAWING TITLE	
ST MARTIN'S HOUSE 65-75 MONMOUTH STREET		GENERAL ARRANGEMENT BASEMENT FLOOR	
CLIENT		DRAWING STATUS	
SHAFTESBURY COVENT GARDEN LTD.		PLANNING	
drawn by	checked	scale	date
AM	-	1:50@A1; 1:100@A3	17/03/15
project	drawing number	revision	
1501	(00)_110	P02	