

**Alfred Court Proposed North West Elevation**  
Scale 1:200

NOTE: Elevation facing Sports Fields and Hampstead Cemetery

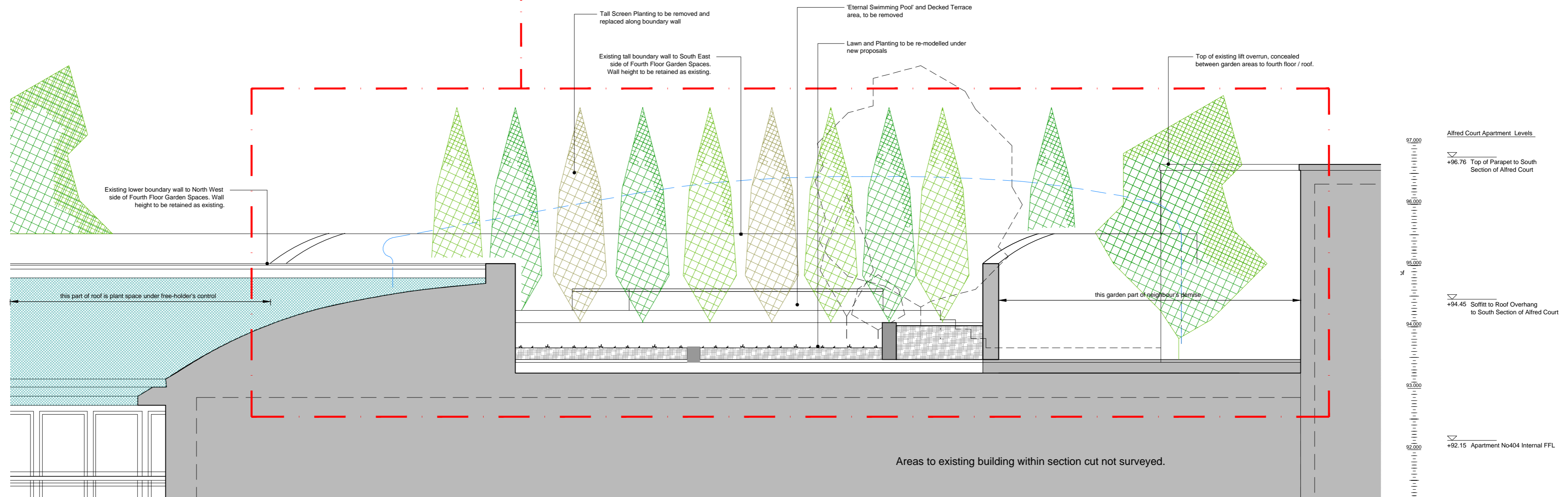

**Existing North West Part Elevation\_Cut Away to Garden Room Only**  
North West Elevation of Apartment 404 Garden  
Scale 1:50

Note: Refer to Section BB indicated on Plans

[A2] 1:050	rev.	date	details	[initials]	status	drawn	checked	approved
[A4] 1:100	--	2015.04.28	first issue			r	mf	df

**STUDIO IRIS**

Studio IRIS Ltd, 14 Elmworth Grove, London, SE21  
contact@studioiris.net

**ARCHITECTS**

www.studioiris.net

Apartment No.404, Alfred Court  
53 Fortune Green Road, London  
NW6 1DF

for and on behalf of our clients  
Mr Paredes

Existing Drawings  
Garden Room North West Elevation\_Section BB

APPROVALS

1409	A	0	300	--
------	---	---	-----	----

Scale bars are given for analysis and statutory approvals - only figured dimensions are to be used for construction.