

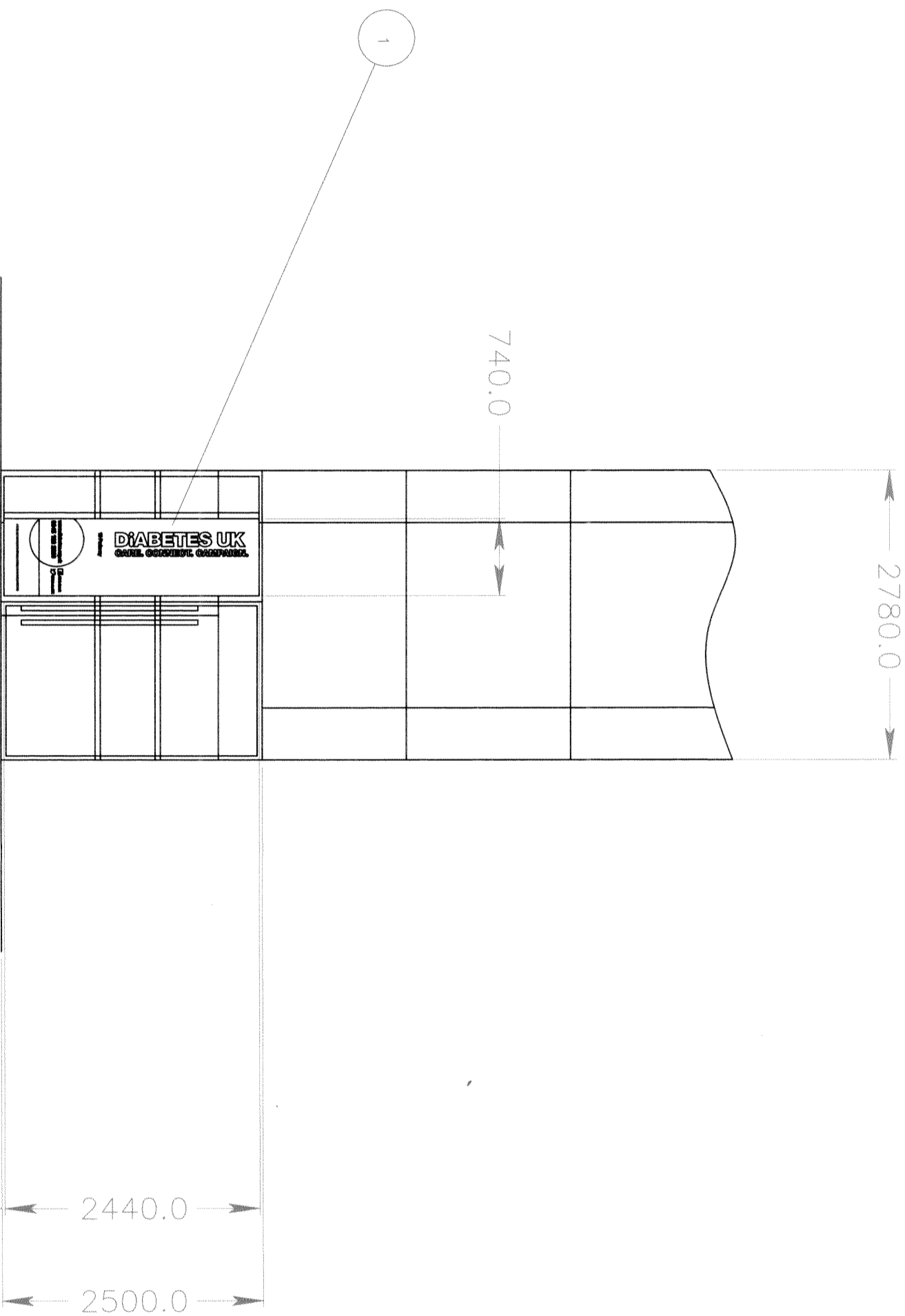

THIRD ANGLE PROJECTION
DIMENSIONS IN MILLIMETRES

ITEM 1. 740x2440x25 ALUMINIUM FASCIA, TRAY IN TRAY SIGN CONSTRUCTION TO BE FIXED TO EXISTING STEEL GATES THROUGH ALUMINIUM BACKTRAY. TRAY SIGN TO BE PPC WHITE WITH FACE APPLIED BLUE VINYL GRAPHICS AND CLEAR LAQUER PROTECTIVE FINISH.



FRONT ELEVATION

METRES

SCALE 1:50

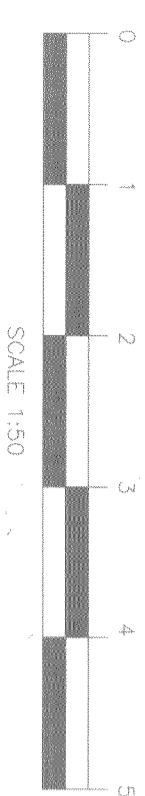

DRAWING APPROVAL		
STATUS A	BR	
THIS DRAWING HAS BEEN CHECKED AND CONFORMS TO DESIGN INTENT	DATE	
STATUS B	BR	
APPROVAL NOT REQUIRED	MJS	
STATUS C	DATE	29/05/15
UNCHECKED, NOT TO BE USED FOR MANUFACTURE		

No part of this drawing & the design contained herein may be reproduced without the written consent of Wood & Wood International Signs Ltd	
DRAWING NO.	REV
17433	A

DESIGN COPYRIGHT ©

Wood & Wood International Signs Ltd
Heron Road
Sowton Estate
Exeter EX2 7LX
Tel: 01392 444501
Fax: 01392 252358

ASSEMBLY / SITE	MACLEOD HOUSE, 10 PARKWAY, LONDON	
MATERIAL	SEE DRG	
SCALE	DRAWN BY	DATE
1 : 50 @ A3	M J S	29/05/2015

CLIENT	DIABETES UK
DETAIL	FRONT ELEVATION DETAILS