

1 Proposed double door elevation
2003 1:20 @_A3

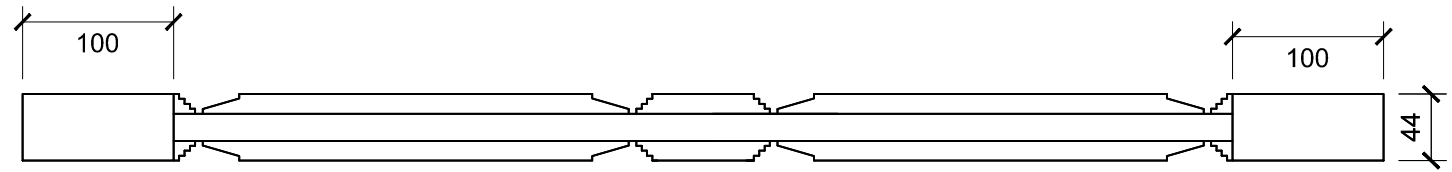

3 Proposed door leaf
2003 1:5 @_A3

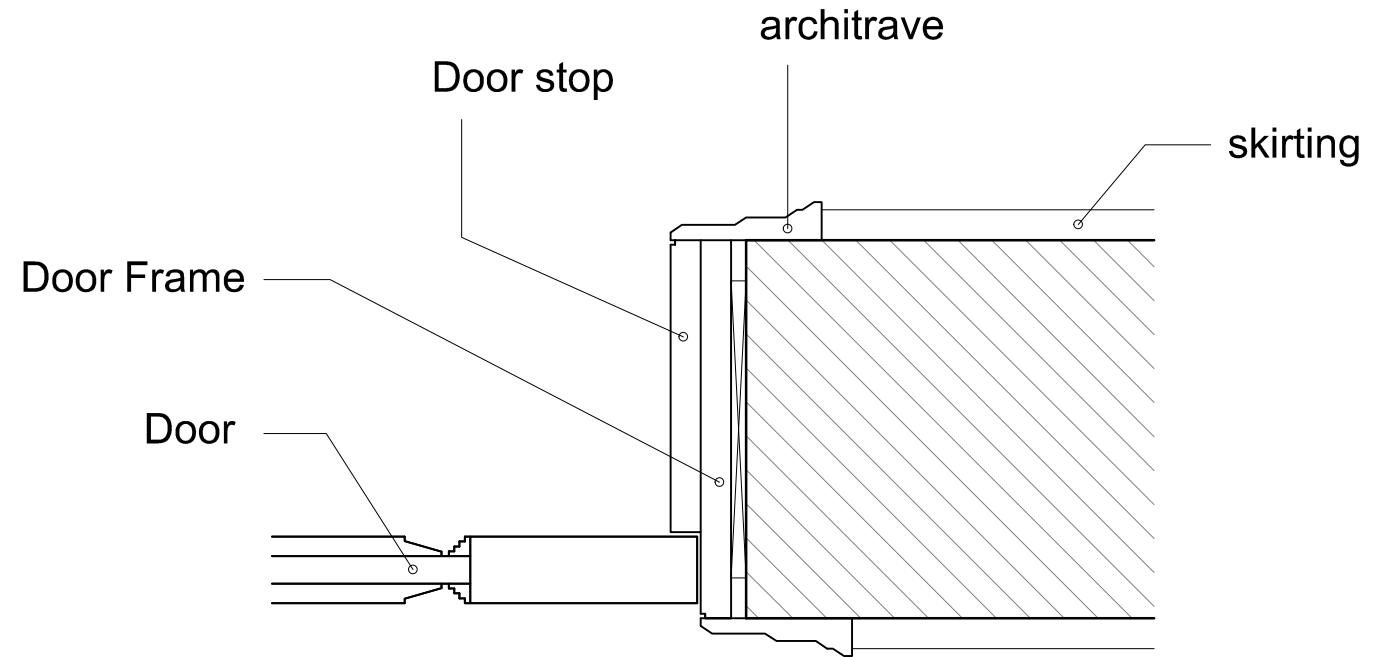

4 Proposed door detail
2003 1:5 @_A3

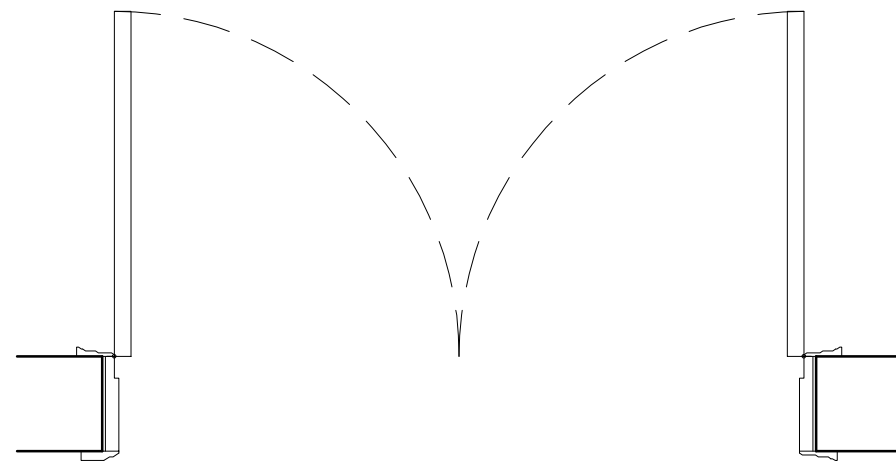

2 Proposed double door plan
2003 1:20 @_A3

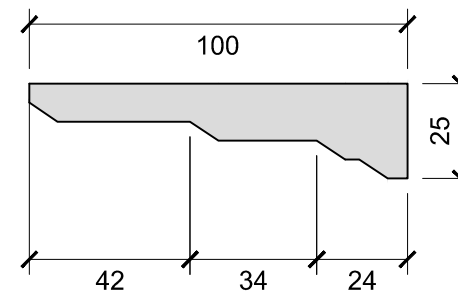

5 Proposed architrave detail
2003 1:5 @_A3

No. Notes

- Dimensions to be verified on site. Only figured dimensions to be used and any discrepancies in dimensions are to be reported to the contract administrator. No dimensions are to be scaled from printed drawings. Any areas indicated on this drawing are for guidance only. No responsibility is taken for their accuracy.
- There is a risk of injury or death in construction if the works are not properly planned and supervised. The contractor must not undertake any element of the work without first having carried out the necessary risk assessments and prepared detailed method statements.

No. Revision

A Number of panels on proposed double doors amended.

Date

08/06/2015

4MA © 2010
Insert note here as required

client: Kosovan Embassy
job: 8 John Street
WC1N 2EB
dwg: DOOR DETAILS
PROPOSED



39 Warple Way
London W3 0RX
+44(0)20 7021 0332: T
+44(0)20 7021 0122: F
info@4mgroupp.co.uk
www.4mgroupp.co.uk

dwg. type: PLANNING
dwg. status: APPROVAL
drawn by: RG approved by: PR date: 27/05/15
scale: 1:20 @ A3 size: A3

job number	drawing number	revision
000	2003	A