

PART PLAN @ 1:100 / A1

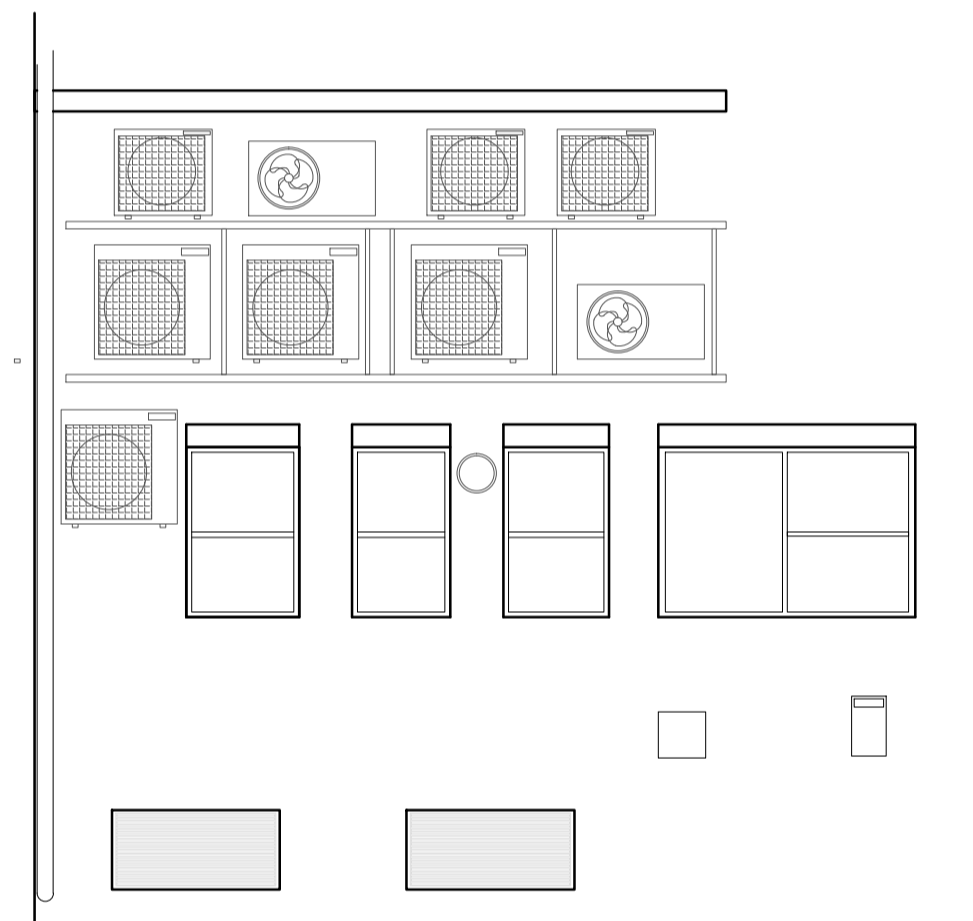

AS PROPOSED
SECTION B-B
@ 1:50 / A1



AS PROPOSED
SECTION A-A
@ 1:50 / A1

REV	DATE	REVISION	INITIALS
A	10.10.2010	NOTES1 NOTES2	TH

LLOYDS BANKING GROUP

ALL DIMENSIONS TO BE VERIFIED PRIOR TO COMMENCING WORK. DRAWING TO BE READ IN CONJUNCTION WITH PROJECT SPECIFICATIONS.
THIS DRAWING IS THE PROPERTY OF LLOYDS BANKING GROUP AND COPYRIGHT IS RESERVED BY THEM. THE DRAWING IS ISSUED ON CONDITION THAT IT IS NOT COPIED OR DISCLOSED BY OR TO ANY UNAUTHORISED PERSONS WITHOUT PRIOR CONSENT IN WRITING TO LLOYDS BANKING GROUP - GROUP PROPERTY. ALL MODIFIED DRAWINGS SHOULD BE RETURNED TO LLOYDS BANKING GROUP.

GROUP PROPERTY

BRISTOL - PO Box 112, Canons House, Canons Way, BRISTOL, BS99 7LB
EDINBURGH - Sighthill South, 12 Bankhead Crossway South, EDINBURGH, EH11 4EN
HALIFAX - Trinity Road, HALIFAX, West Yorkshire, HX1 2RG

PROJECT ADDRESS	SCALE
Lloyds TSB	A1 - 1:50
Tottenham Court Rd	A3 - 1:100
88 Tottenham Court Rd	DATE
LONDON W1P 0EQ	19.01.15
DRAWING DESCRIPTION	DRAWN BY
Rear Elevations	B3
Existing Plan	REVISION
DRAWING NUMBER	
50484500-AREX-EL-0011	