



Copyright: All rights reserved. This drawing must not be reproduced without permission.

Only the original drawing should be used. Contractors, subcontractors and suppliers must verify all dimensions on the before commencing any work or making any shop drawings.

All shop drawings to be submitted to the architect for comment prior to fabrication.

This drawing is to be read in conjunction with the Architect's specifications, list of quantities, schedule, structural, mechanical & electrical drawings and all discrepancies are to be reported to the architect.

Do not scale from this drawing. Dimensions are in millimetres unless otherwise stated.

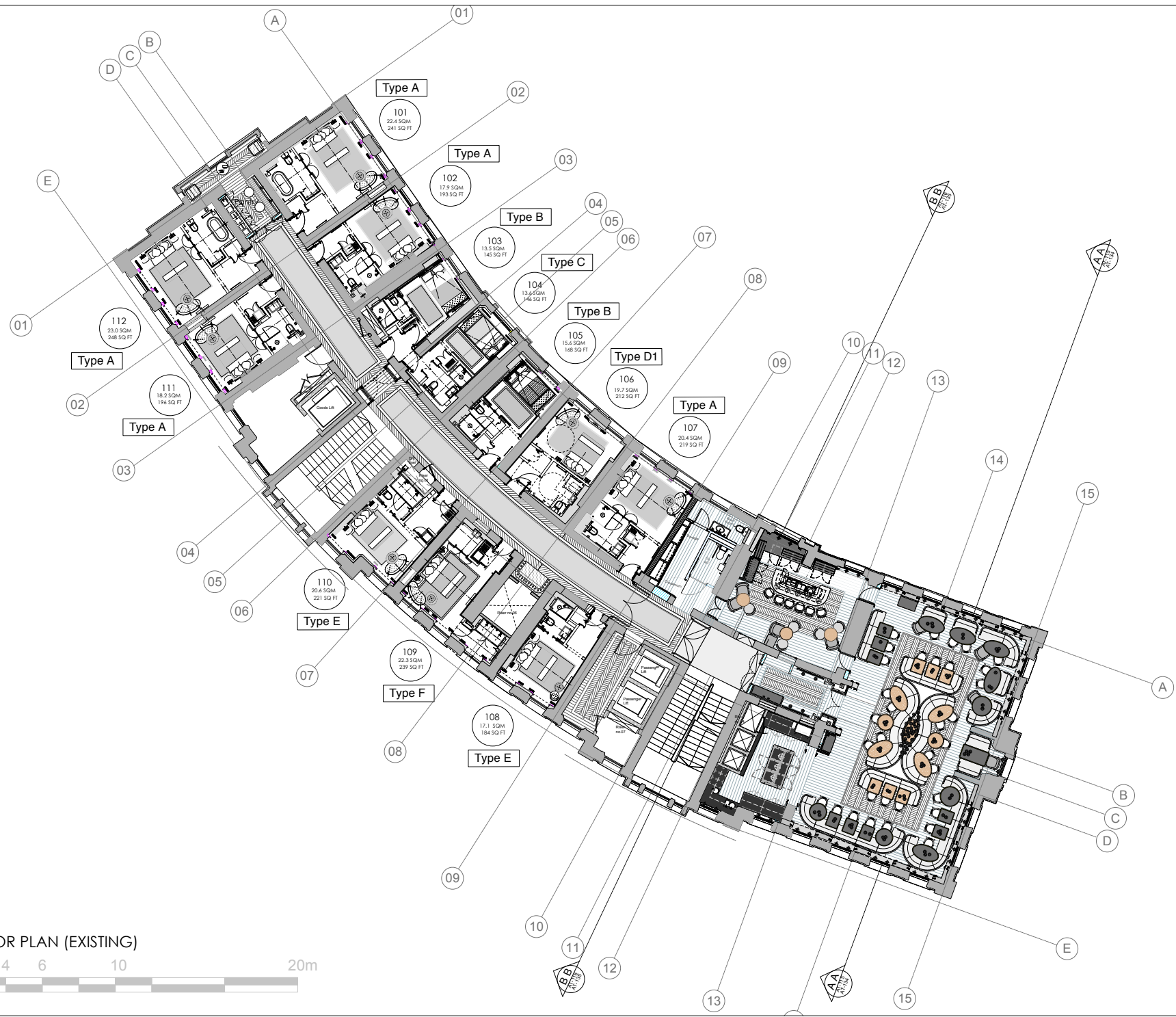

FIRST FLOOR PLAN (EXISTING)



PLANNING

Archer Humphries Architects
 Basement
 Central House
 142 Central Street
 London
 EC1V 3AB
 T : 020 7251 8555

project title	
Great Northern Hotel	
drawing title	scale
First Floor Plan (EXISTING)	1:200(A3) NOV 14
drawing number	drawing name
AAH/CHN/COC/011	ARCHITECTURE
revision	revision