

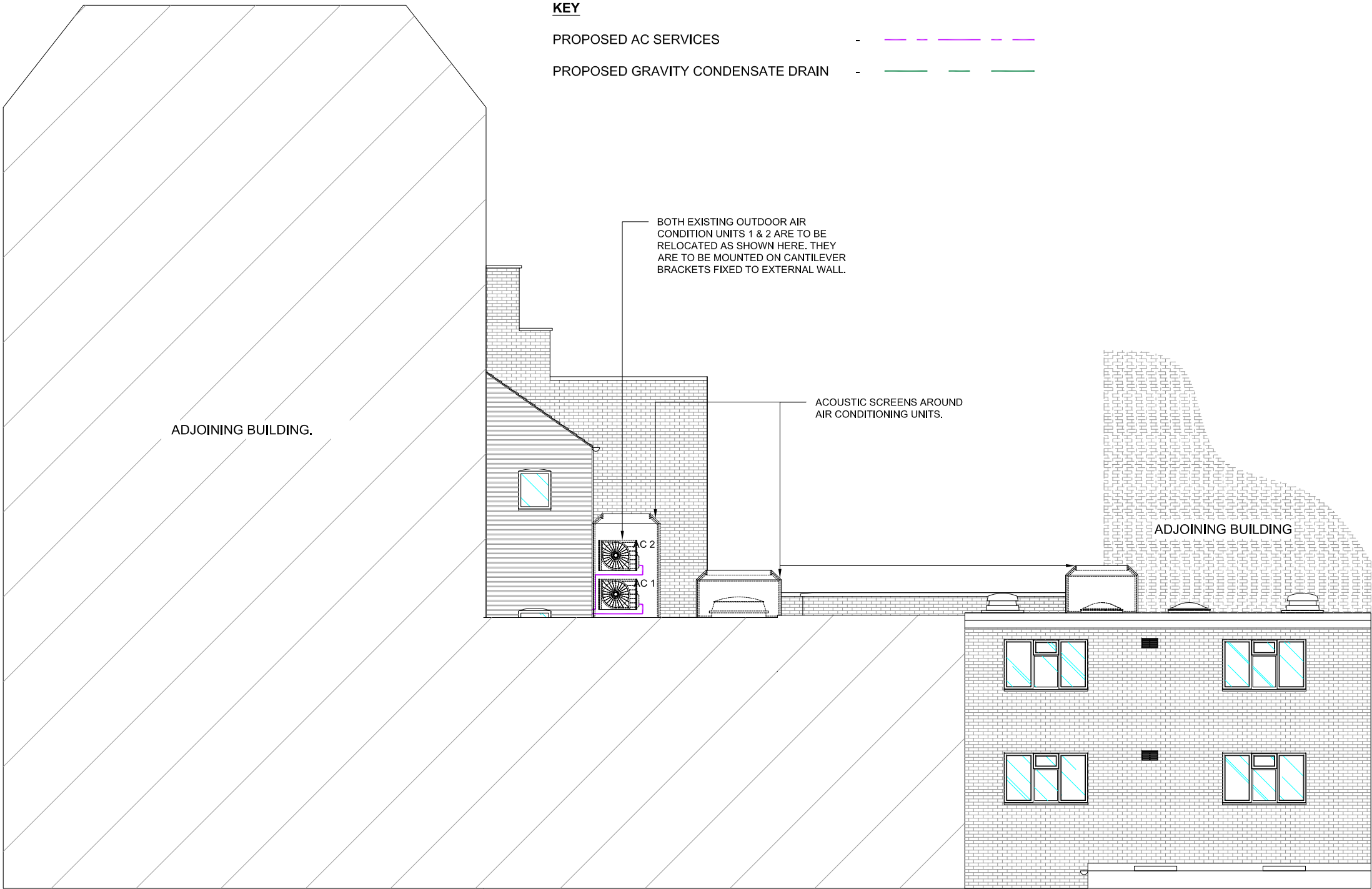

Note:  
This drawing has been drawn to scale for the purposes of obtaining local authority approval. Any measurements required for construction must not be scaled from this drawing.

All structural elements to be agreed with local authority Building Control prior to commencement of works.

Attention is drawn to the provisions of the party wall act, 1996. Legal boundaries should be determined by others.



PROPOSED  
SIDE ELEVATION

©

**Revive  
Renovations**

PLANNING  
TECHNICAL DRAWINGS  
PROJECT MANAGEMENT &  
INTERIOR DESIGN SERVICES

M: 07702322072  
T: 020 79782304  
E: [reviveplanning@live.co.uk](mailto:reviveplanning@live.co.uk)

client  
**London School of Barbering**  
186 Drury Lane, London, WC2B 5QD

project  
**PLANNING AND LISTED**  
APPLICATION  
Relocation of Air conditioning units

drawing title  
**PROPOSED  
ELEVATION**

date October 2014	scale 1:100@A3	dwn GFS
----------------------	-------------------	------------

drawing number <b>104</b>	sheet no. 4 of 7	rev
------------------------------	---------------------	-----