



Euphorbia amygdaloides 'Purpurea'
Erigeron karvinskianus
Achillea millefolium 'Lansdorferglut'
Hamamelis x intermedia 'Jelena'
Corylus avellana hedge

Existing concrete slab
 Treated timber raised planter
Rosa arvensis hedge
 Timber logs and animals

Orchard 'starter' rows, such as:
Ficus carica, *Malus sylvestris*, *Morus nigra*, *Amelanchier lamarckii*, *Prunus domestica*, *Pyrus communis*

New gate to improve garden access for Mackworth House residents

1100mm high existing railings

Small roundabout

2 no. CA-G parking permit spaces retained

1 no. blue badge parking space retained

1 no. P&D parking bay retained

Native hedging:
Rubus fruticosus 'Loch Ness'
Corylus avellana
Prunus spinosa

Existing London planes to be retained

Underplanting:
Galanthus nivalis
Narcissus 'Jenny'
Fritillaria meleagris

Rosa canina
 Rowan to be retained (Cherry and sycamore to be removed)

2 trees of tree group G3 removed

Cast in-situ concrete raised planter

MACKWORTH HOUSE

T18

T25

T24

VARDELL STREET

STANHOPE STREET

1100mm high railings to garden

Insect hotel

Sorbus hupehensis (x 5 no.)

Orchard trees to be planted by residents

Soleirolia soleirolii
 Planted in paving gaps

12 no. CA-G parking permit spaces retained

Tall grasses and perennials:
Molinia caerulea subsp. *caerulea* 'Variegata'
Calamagrostis brachytricha
Verbena bonariensis
Echinacea purpurea
Allium hollandicum 'Purple Sensation'

Screen and gate for residents only access to flats on upper levels and garden

Magnolia 'Sayonara'

Visitor cycle stands

3 no. P&D parking bays retained

KEY

- Existing tree retained
- Existing tree removed
- New fruit tree
- New special tree on corners
- Wildlife flowering/fruited hedgerow
- Evergreen hedges
- Tree trunks
- Grass
- Long grass
- Flowering meadow
- Underplanting
- Herbaceous borders
- Ornamental grasses + perennials
- Pebbles with mosses/low ground cover
- Communal growing spaces (concrete raised planters)
- Seating
- Staffordshire blue paving
- Granite setts 200x100mm
- Wood chip mulch
- Breedon gravel
- Concrete flags
- Reused granite kerbs 300mm wide
- Chasse-roue (reused bollard)
- In situ concrete
- Highway boundaries
- Stormwater alteration tank
- Water butt

Tx Refer to arboricultural tree survey schedules for detail on existing trees

East Architecture landscape urban design
 Unit 8
 49-59 Old Street
 London EC1V 9HX
 T 020 7490 3190
 E mail@east.uk.com
 www.east.uk.com

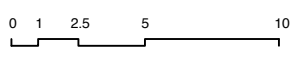

PROJECT
Regent's Park Estate

CLIENT
 LB Camden

DRAWING STATUS
 Planning

DATE
 May 2015

SCALE
 1:200

SIZE
 A2

REV
 -

DRAWING TITLE
 Proposed site plan
 Site 03 /
 Varndell Street Corner

DRAWING NR
 114 RPE S03 100

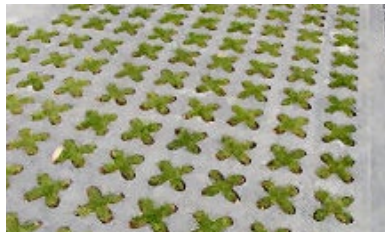

1. Grasscrete drive for accessible parking bay



2. Granite setts within concrete path surface



3. Trees: redbud



4. Breedon gravel



6. Existing willow tree provide distinct character to Hampstead road



8. Proposed tree: *Salix babylonica*



7. Living willow play structures

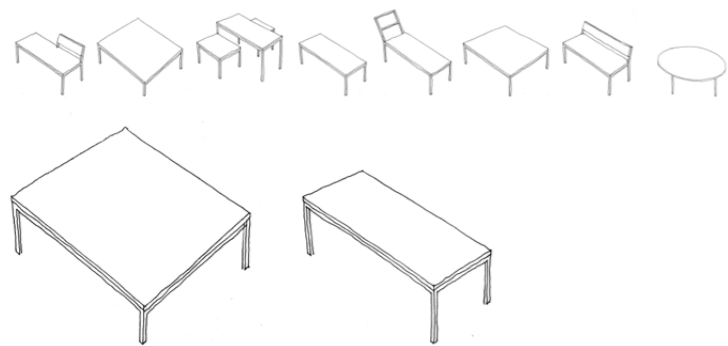

5. Family of benches: inclined table and straight bench (stainless steel + iroko)

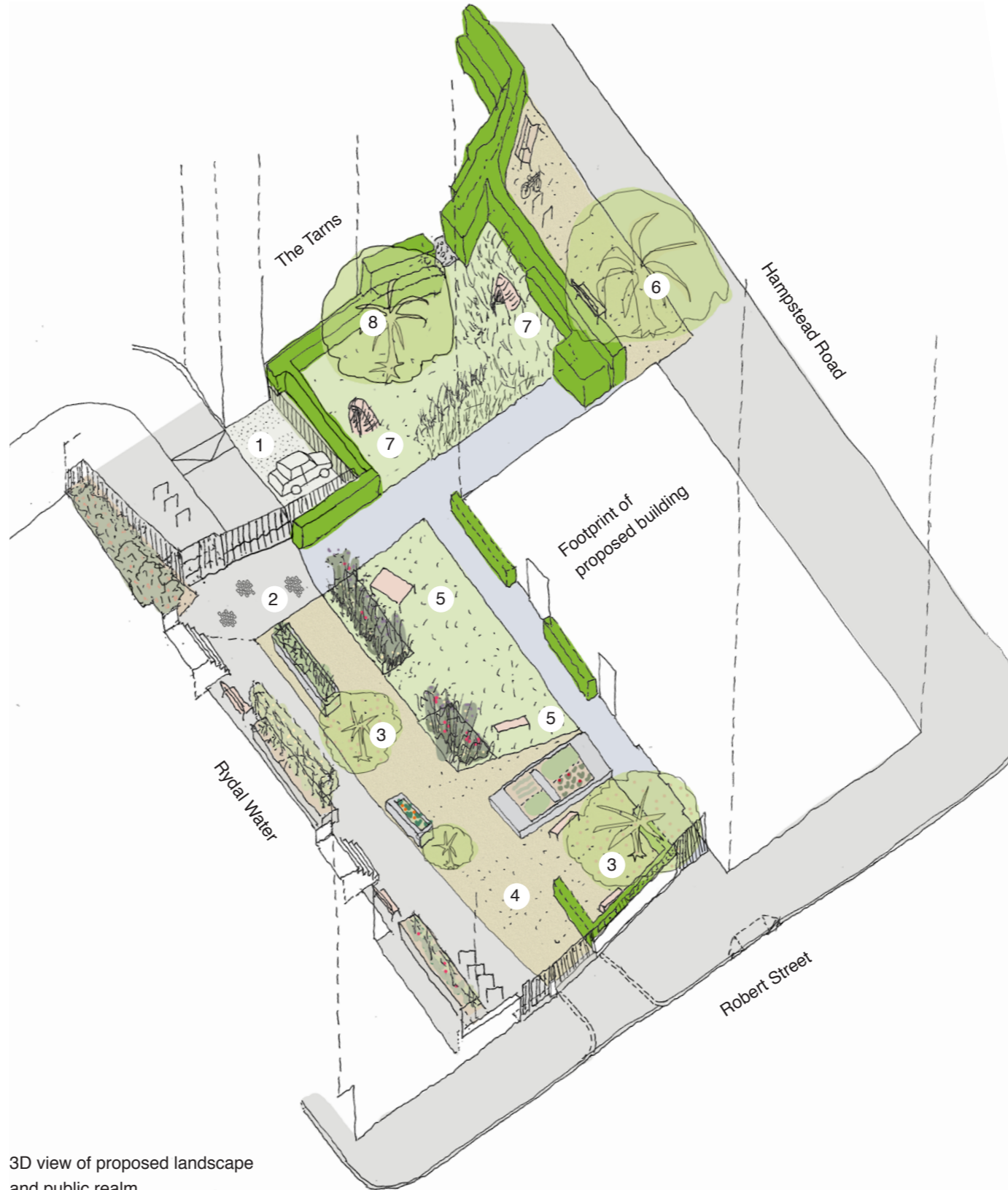

3D view of proposed landscape and public realm

East
Architecture landscape
urban design

Unit 8
49-59 Old Street
London EC1V 9HX
T 020 7490 3190
E mail@east.uk.com

www.east.uk.com

PROJECT
Regent's Park Estate

CLIENT
LB CAMDEN

DRAWING STATUS
Planning

DATE
May 2015

SCALE
varies

SIZE
A3

REV
-

DRAWING TITLE

DRAWING NR
114 RPE S2 101

3D views
& detail proposals
Plot 2 / Former One
Stop Shop



Tx
Refer to arboricultural
tree survey schedules
for detail on existing
trees

Locked access gate
for maintenance

Existing amenity grasland with
shrubs and planting beds

Existing footway

12 no. CA-G parking permit
spaces

Existing *Sorbus aria* trees

Existing street lighting

Boundary hedge and low
railings to the perimeter of
the site, with locked gates

Existing parking ticket machine

2 no. CA-G parking
permit spaces

1 no. blue badge
parking space

1 no. P&D
parking bay

3 no. P&D
parking bays

East
Architecture landscape
urban design

Unit 8
49-59 Old Street
London EC1V 9HX
T 020 7490 3190
E mail@east.uk.com

www.east.uk.com

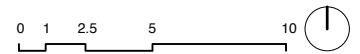

PROJECT
Regent's Park Estate

CLIENT
LB Camden

DRAWING STATUS
Planning

DATE
May 2015

SCALE
1:200

SIZE
A2

REV
-

DRAWING TITLE
Existing site plan
Site 03 /
Varndell Street Corner

DRAWING NR
114 RPE S03 001