



*Soleirolia soleirolii* planted in pebbles gaps

1100 high fence with gates

Existing ramp to deck

New brick wall to form edge to ramp parapet

*Euphorbia amygdaloides* 'Purpurea'  
*Erigeron karvinskianus*  
*Achillea millefolium* 'Lansdorferglut'  
*Hamamelis x intermedia* 'Jelena'

Separation allowed by communal planter  
 Artichokes and Sage

Communal planter with 'starter' vegetables such as spinach

New powder coated steel staircase to link deck to courtyard

Tree: apple

Communal planters

Timber communal raised planter with 'starter' vegetables such as *Alpine strawberries* and fennel

Cast-in concrete long bench to form solid edge to raised timber planter

Bird boxes

New secured by design external doors to existing residential block

1 no. blue badge parking space retained

2 no. P&D parking spaces

Tall grasses and perennials:  
*Molinia caerulea* subsp. *caerulea* 'Variegata'  
*Calamagrostis brachytricha*  
*Verbena bonariensis*  
*Echinacea purpurea*  
*Allium hollandicum* 'Purple Sensation'

Chasse-roue (reclaimed granite bollard)

2 no. CA-G parking permit space retained

6 no. CA-G parking permit spaces retained

3 no. CA-G parking permit spaces retained

Double hedge:  
 - Low hedging (300 - 450mm height):  
*Buxus sempervirens*  
 - Native hedging (600 - 1200mm height):  
*Rosa arvensis*  
*Corylus avellana*  
*Crataegus monogyna*

1100 high boundary fence with gate

Tree: quince

Tree: apple

Existing vehicular entrance to car park below deck

New powder coated steel fence to garden boundary

Tall grass + underplanting:  
*Galanthus nivalis*  
*Narcissus* 'Jenny'  
*Fritillaria meleagris*

Insect hotel

Raised planter  
*Hamamelis x intermedia* 'Barmstedt Gold'  
*Dicentra* 'Stuart Boothman'  
*Saxifraga fortunei*  
*Galanthus nivalis*

planters subject to structural engineer's assessment of existing slab

**KEY**

- Existing tree retained
- Existing tree removed
- New fruit tree
- Wildlife flowering/fruited hedgerow
- Evergreen hedges
- Climbers
- Grass
- Long grass
- Herbaceous borders
- Ornamental grasses + perennials
- Grasscrete
- Pebbles with mosses/low ground cover
- Communal growing spaces (concrete raised planters)
- Seating
- Staffordshire blue paving
- Wood chip mulch
- Breendon gravel
- Concrete flags
- Reused granite kerbs 300mm wide
- Chasse-roue (reused bollard)
- In situ concrete
- Highway boundaries
- Stormwater attenuation tank
- Water butt
- New light column

Tx  
 Refer to arboricultural tree survey schedules for detail on existing trees

East  
 Architecture landscape urban design  
 Unit 8  
 49-59 Old Street  
 London EC1V 9HX  
 T 020 7490 3190  
 E mail@east.uk.com  
 www.east.uk.com

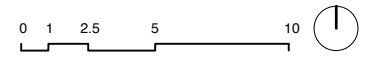

PROJECT  
**Regent's Park Estate**

CLIENT  
 LB Camden

DRAWING STATUS  
 Planning

DATE  
 May 2015

SCALE  
 1:200

SIZE  
 A2

REV  
 -

DRAWING TITLE  
 Proposed site plan  
 Site 05 / Dick Collins  
 Hall

DRAWING NR  
 114 RPE S05 100

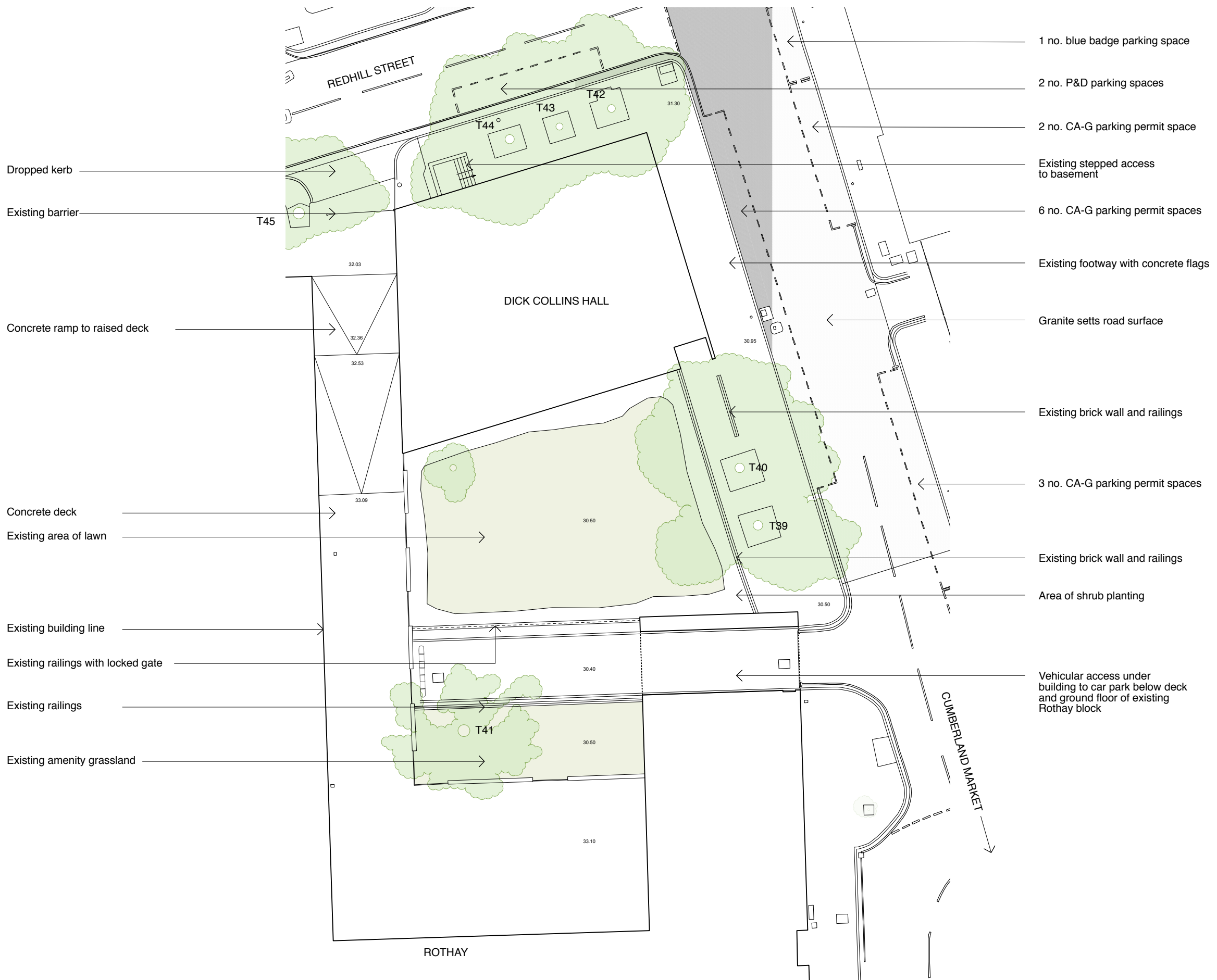

Tx  
Refer to arboricultural  
tree survey schedules  
for detail on existing  
trees

- 1 no. blue badge parking space
- 2 no. P&D parking spaces
- 2 no. CA-G parking permit space
- Existing stepped access to basement
- 6 no. CA-G parking permit spaces
- Existing footway with concrete flags
- Granite setts road surface
- Existing brick wall and railings
- 3 no. CA-G parking permit spaces
- Existing brick wall and railings
- Area of shrub planting
- Vehicular access under building to car park below deck and ground floor of existing Rothay block

- Dropped kerb
- Existing barrier
- Concrete ramp to raised deck
- Concrete deck
- Existing area of lawn
- Existing building line
- Existing railings with locked gate
- Existing railings
- Existing amenity grassland

East  
Architecture landscape  
urban design  
  
Unit 8  
49-59 Old Street  
London EC1V 9HX  
T 020 7490 3190  
E mail@east.uk.com  
www.east.uk.com

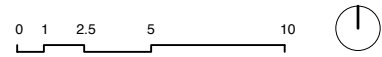

PROJECT  
**Regent's Park Estate**

CLIENT  
LB Camden

DRAWING STATUS  
Planning

DATE  
May 2015

SCALE  
1:200

SIZE  
A2

REV  
.

DRAWING TITLE  
Existing site plan  
Site 05 / Dick Collins  
Hall

DRAWING NR  
114 RPE S05 001