

**SAFETY, HEALTH AND ENVIRONMENTAL INFORMATION**

In addition to the hazards / risks normally associated with the types of work detailed on this drawing, note the following :

**CONSTRUCTION**  
Drawings to be read in conjunction with the Design Risk Assessment - Refer to Doc No.

**MAINTENANCE/CLEANING**  
Drawings to be read in conjunction with the Design Risk Assessment - Refer to Doc No.

**DECOMMISSIONING / DEMOLITION**  
Drawings to be read in conjunction with the Design Risk Assessment - Refer to Doc No.

It is assumed that all works will be carried out by a competent contractor working, where appropriate, to an approved method statement

**NOTE:**  
Do not scale from this drawing. Contractor to take and check all dimensions on site before work commences. Discrepancies to be reported to the architect. Subcontractor to verify all dimensions on site before making a shop drawing or commencing manufacture. This drawing is copyright.

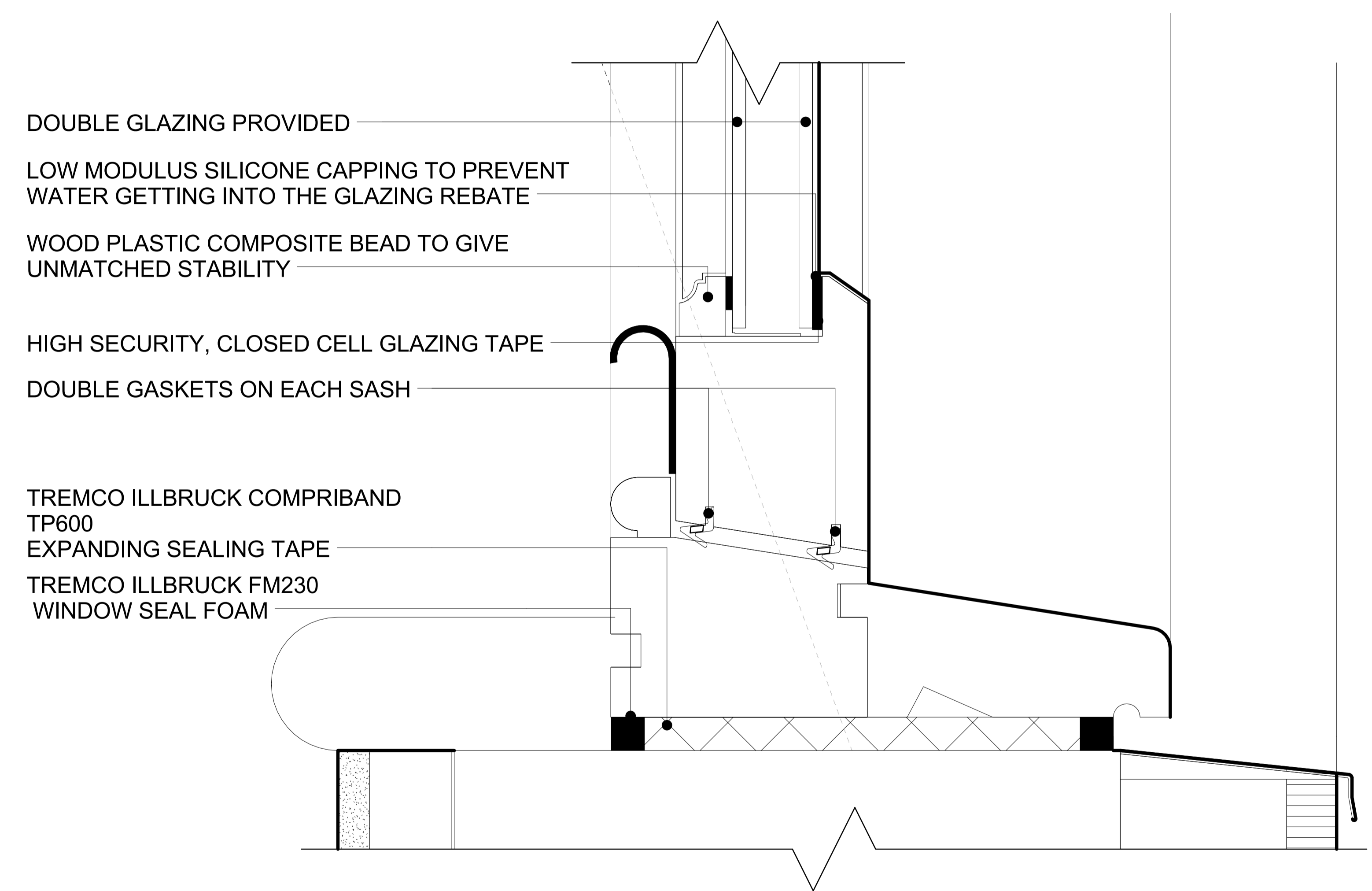

- DOUBLE GLAZING PROVIDED
- LOW MODULUS SILICONE CAPPING TO PREVENT WATER GETTING INTO THE GLAZING REBATE
- WOOD PLASTIC COMPOSITE BEAD TO GIVE UNMATCHED STABILITY
- HIGH SECURITY, CLOSED CELL GLAZING TAPE
- DOUBLE GASKETS ON EACH SASH
- TREMCO ILLBRUCK COMPRIBAND TP600 EXPANDING SEALING TAPE
- TREMCO ILLBRUCK FM230 WINDOW SEAL FOAM

**RECURSION DESIGN LTD**  
100 Kensington Park Rd, London W11 2PL  
0 2045 01 237 7755 5245  
info@recursiondesign.com

Client  
**LITTLE VENICE DEVELOPMENTS**  
Project Number: 1007-2014-000001  
**1007 - BRITANNIA STREET**  
2 Britannia Street, London WC1X 9JE

Title  
**PLANNING CONDITION 2**  
**WINDOW W03-06 & W03-08 CILL DETAIL**  
Scale  
**1 : 1**  
**A1**  
Issue Date  
**27/05/15**

Drawn By FI	Checked By GS	Approved By BD	Project Stage STAGE E	Reason for Issue PLANNING
----------------	------------------	-------------------	--------------------------	------------------------------

Drawing No: **RD-1007-PC-209**

27/05/15 14:30:22