

SAFETY, HEALTH AND ENVIRONMENTAL INFORMATION

In addition to the hazards / risks normally associated with the types of work detailed on this drawing, note the following :

CONSTRUCTION
Drawings to be read in conjunction with the Design Risk Assessment - Refer to Doc No.

MAINTENANCE/CLEANING
Drawings to be read in conjunction with the Design Risk Assessment - Refer to Doc No.

DECOMMISSIONING / DEMOLITION
Drawings to be read in conjunction with the Design Risk Assessment - Refer to Doc No.

It is assumed that all works will be carried out by a competent contractor working, where appropriate, to an approved method statement

NOTE:
Do not scale from this drawing. Contractor to take and check all dimensions on site before work commences. Discrepancies to be reported to the architect. Subcontractor to verify all dimensions on site before making a shop drawing or commencing manufacture. This drawing is copyright.

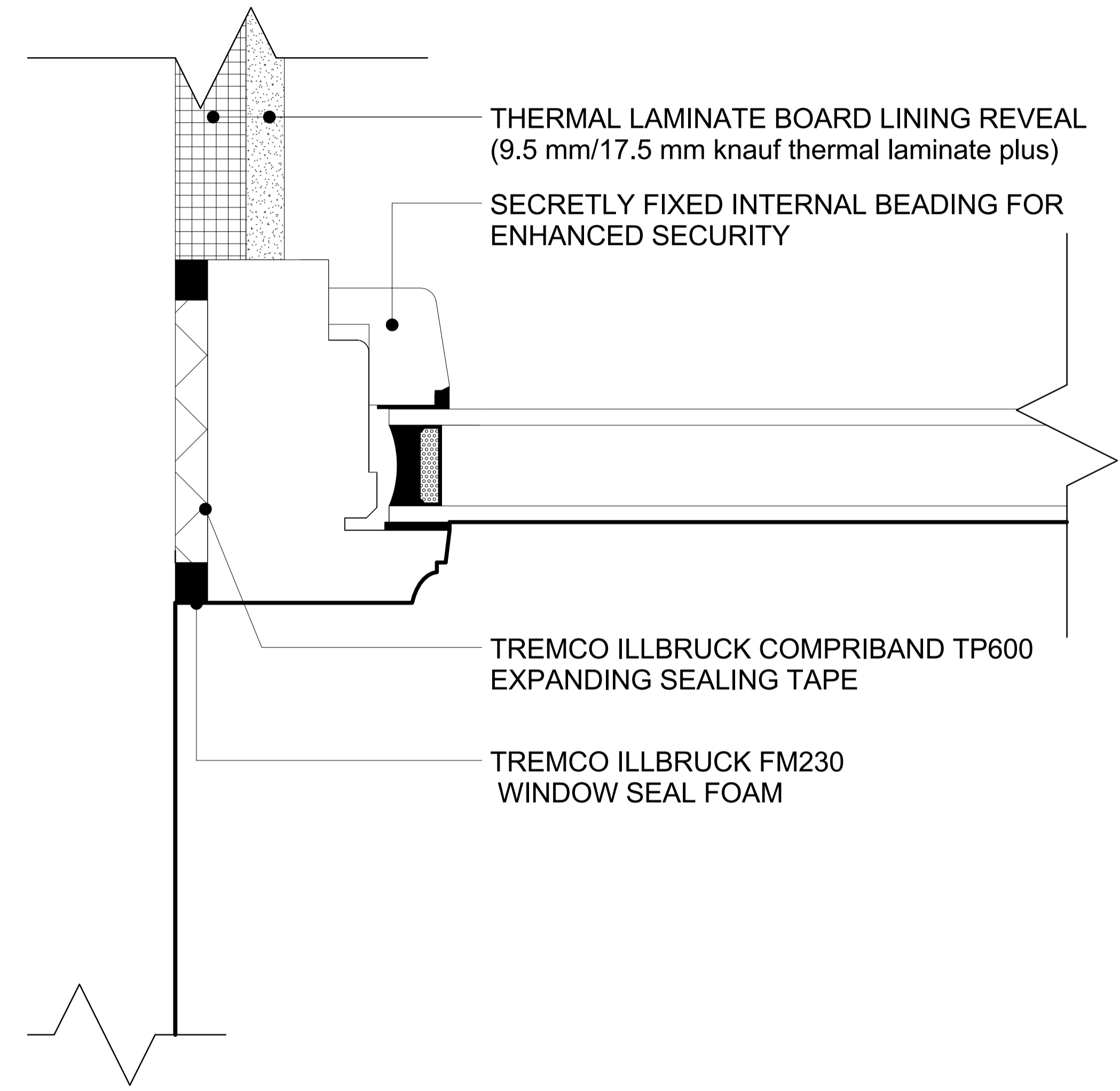

THERMAL LAMINATE BOARD LINING REVEAL
(9.5 mm/17.5 mm knauf thermal laminate plus)

SECRETLY FIXED INTERNAL BEADING FOR
ENHANCED SECURITY

TREMCO ILLBRUCK COMPRIBAND TP600
EXPANDING SEALING TAPE

TREMCO ILLBRUCK FM230
WINDOW SEAL FOAM

RECURSION DESIGN LTD
104 Kensington Park Rd, London W11 2PL
02045 0123 7755 5245
info@recursiondesign.com

Client
LITTLE VENICE DEVELOPMENTS
Project Number: 1007-201-000001
1007 - BRITANNIA STREET
2 Britannia Street, London WC1X 9JE

Title
PLANNING CONDITION 2
WINDOW WB1-06 - JAMB DETAIL
Scale: 1 : 1
@ A1
Issue Date: 27/05/15

Drawn By: FI	Checked By: QS	Approved By: BD	Project Stage: STAGE E	Reason for Issue: PLANNING
--------------	----------------	-----------------	------------------------	----------------------------

Drawing No: RD-1007-PC-201

P:\15\15-202052\Z