

TYPE:	1, Sliding Sash
Location:	Elevation 1
Window nos.	GW:01, GW:04
Glazing:	Clear glass
Ironmongery:	Angel ventlock, window restrictors
No. Req:	2

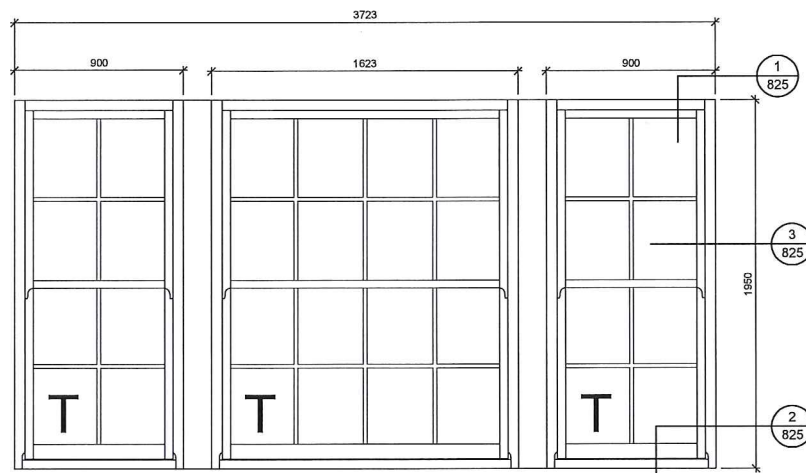

TYPE:	2, Sliding Sash
Elevation no:	1
Window nos.	1W:01, 1W:05
Glazing:	Clear glass
Ironmongery:	Angel ventlock, window restrictors
No. Req:	2

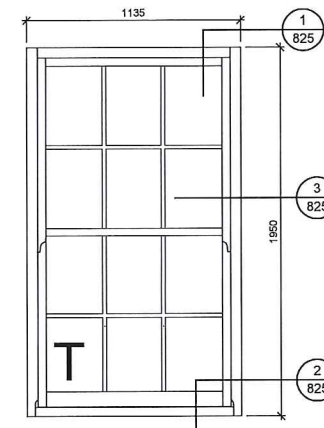

TYPE:	3, Sliding Sash
Elevation no:	1, 5, 6
Window nos.	GW:02, GW:03, GW:27, 1W:02, 1W:04, 1W:24
Glazing:	Clear glass
Ironmongery:	Angel ventlock, window restrictors
No. Req:	6

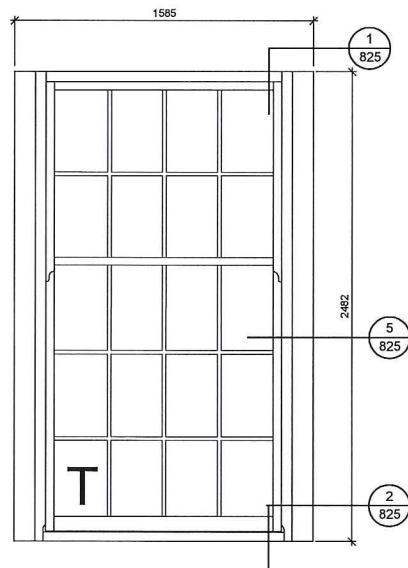

TYPE:	4, Sliding Sash (SASH BOX)
Elevation no:	1
Window nos.	1W:03
Glazing:	Clear glass
Ironmongery:	Angel ventlock, window restrictors
No. Req:	1

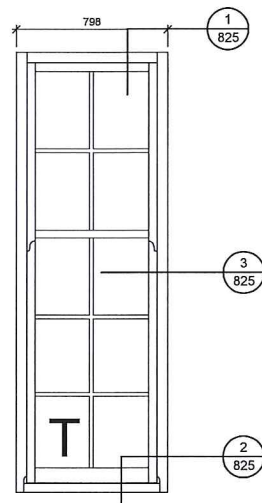

TYPE:	5, Sliding Sash
Elevation no:	1, 2, 3
Window nos.	GW:05, GW:06, GW:07, GW:08, GW:09, GW:13, GW:14, GW:15, GW:16, GW:17
Glazing:	Clear glass
Ironmongery:	Angel ventlock, window restrictors
No. Req:	10

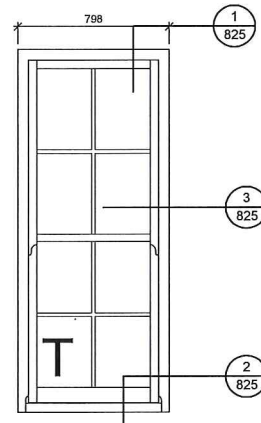

TYPE:	6, Sliding Sash
Elevation no:	1, 2, 3
Window nos.	BW:04, BW:05, BW:06, BW:07, BW:08, 1W:06, 1W:07, 1W:08, 1W:09, 1W:10, 1W:14, 1W:15, 1W:16, 1W:17, 1W:18, 2W:06, 2W:07, 2W:08, 2W:09, 2W:10, 2W:14, 2W:15
Glazing:	Clear glass
Ironmongery:	Angel ventlock, window restrictors
No. Req:	22

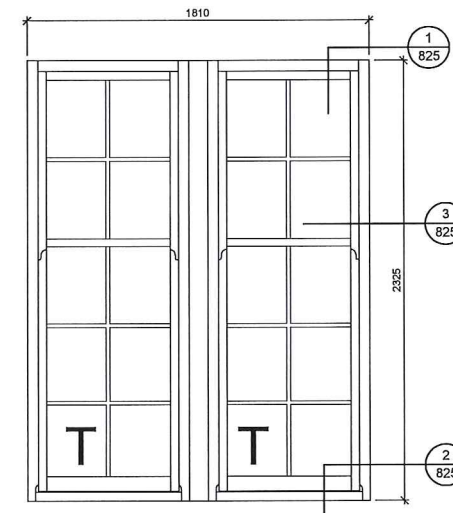

TYPE:	7, Sliding Sash
Elevation no:	1, 2, 3
Window nos.	GW:10, GW:11, GW:12, GW:19
Glazing:	Clear glass
Ironmongery:	Angel ventlock, window restrictors
No. Req:	4

Note:

- All opening, accessible windows must be secure to: BS PAS 24-2012 with BS EN356:2000 P1a laminated glass fitted.
- All windows must achieve a U-Value of at least 0.9
- Acoustic glazing system to provide at least 37db sound insulation.
- Acoustic trickle ventilators to provide at least 42db sound insulation in open position.
- T - Denotes toughened glass\*

**TENDER ISSUE  
DRAWING**

DATE	REVISION	NO.
THIS DRAWING IS NOT TO BE SCALED, ONLY FIGURED DIMENSIONS ARE TO BE FOLLOWED (UNLESS THE DRAWING IS PART OF A PLANNING APPLICATION). CONTRACTORS ARE TO CHECK ALL DIMENSIONS BEFORE WORK COMMENCES, AND REFER ANY APPARENT DISCREPANCY TO THE ARCHITECT.		
THIS DRAWING IS THE SOLE PROPERTY OF M.R PARTNERSHIP LIMITED, AND MAY NOT BE COPIED OR REPRODUCED IN ANY MANNER WHATSOEVER WITHOUT THE OWNERS WRITTEN CONSENT. (c) COPYRIGHT.		
PROJECT	38 HEATH DRIVE LONDON NW3	
DRAWING	WINDOW SCHEDULE 1	
DATE:	FEB 15	<b>M•R PARTNERSHIP</b> ARCHITECTS & INTERIOR DESIGNERS 41 FOLEY STREET TEL: (020) 7631 5405 LONDON W1W 7TS FAX: (020) 7631 5186
DRAWN:	CAD	
SCALE:	1:100A3	
DWG FILE:	DRAWING NUMBER: 2979800	
REV. NO.		

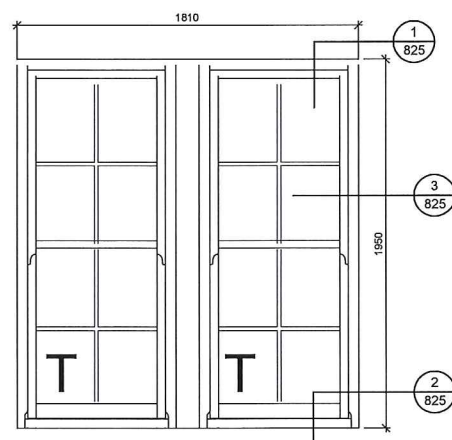

TYPE:	8, Sliding Sash
Elevation no:	1, 2, 3
Window nos.	1W:11, 1W:12, 1W:13, 1W:19, 1W:20, BW:15, 2W:22, 2W:23
Glazing:	Clear glass
Ironmongery:	Angel ventlock, window restrictors
No. Req:	11

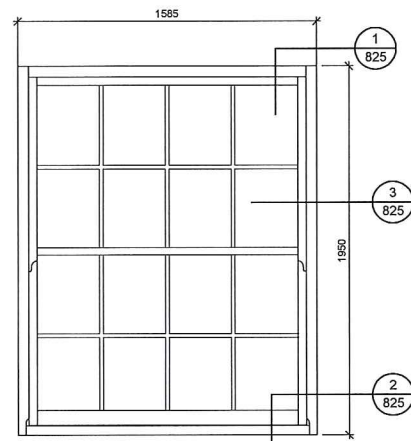

TYPE:	9, Sliding Sash
Elevation no:	2
Window nos.	2W:11, 2W:12, 2W:13
Glazing:	Clear glass
Ironmongery:	Angel ventlock, window restrictors
No. Req:	2

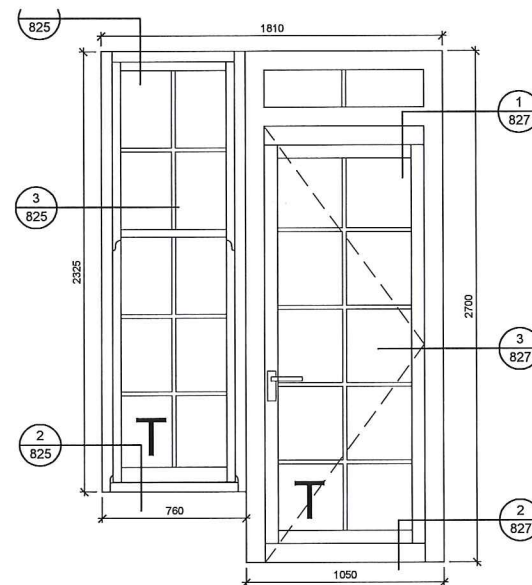

TYPE:	10, Sliding Sash + inward opening door
Elevation no:	3
Window nos.	GW:18
Glazing:	Clear glass
Ironmongery:	1 pair stainless steel lever handles Angel ventlock, window restrictors
No. Req:	1

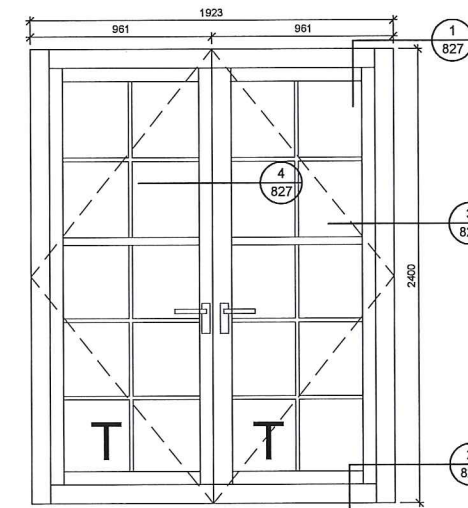

TYPE:	11, inward opening french doors
Elevation no:	4, 5
Window nos.	BW:09, BW:10, BW:11, BW:12, BW:13, BW:14, GW:20, GW:21, GW:22, GW:24, GW:25, GW:26, 1W:21, 1W:22, 1W:23, 1W:27, BW:01, BW:02, BW:03
Glazing:	Clear glass
Ironmongery:	2 pair stainless steel lever handles
No. Req:	16

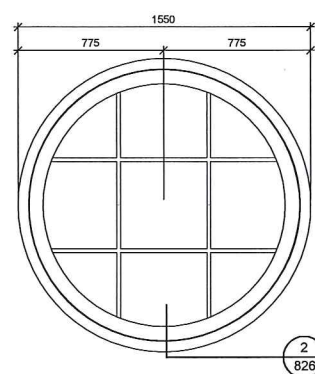

TYPE:	12, centre pivot, opening casement
Elevation no:	5
Window nos.	2W:25
Glazing:	Clear glass
Ironmongery:	Angel ventlock, window restrictors
No. Req:	1

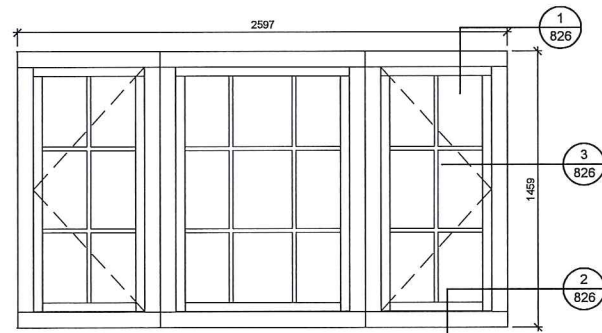

TYPE:	13, outward opening casement
Elevation no:	1
Window nos.	2W:03
Glazing:	Clear glass
Ironmongery:	-
No. Req:	1

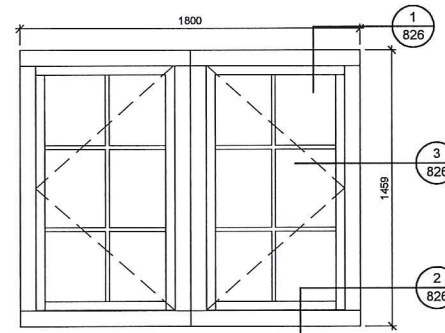

TYPE:	14, outward opening casement
Elevation no:	1, 2, 4, 5,
Window nos.	2W:01, 2W:02, 2W:04, 2W:05, 3W:01, 3W:02, 3W:03, 3W:04, 3W:05, 3W:06, 3W:07, 3W:11, 3W:12, 4W:01, 4W:02, 4W:03, 4W:04, 4W:07, 4W:08, 4W:09, 4W:10
Glazing:	Clear glass
Ironmongery:	-
No. Req:	21

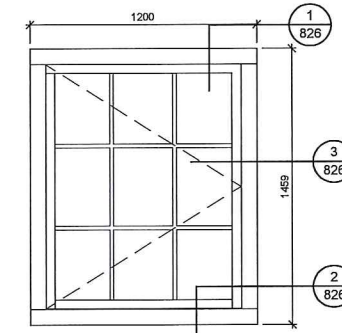

TYPE:	15, outward opening casement
Elevation no:	5, 6
Window nos.	2W:26,
Glazing:	Clear glass
Ironmongery:	-
No. Req:	2

Note:

- All opening, accessible windows must be secure to:BS PAS 24-2012 with BS EN356;2000 P1a laminated glass fitted.
- All windows must achieve a U-Value of at least 0.9
- Acoustic glazing system to provide at least 37db sound insulation.
- Acoustic trickle ventilators to provide at least 42db sound insulation in open position.
- T - Denotes toughened glass\*

**TENDER ISSUE  
DRAWING**

DATE	REVISION	NO.
THIS DRAWING IS NOT TO BE SCALED. ONLY FIGURED DIMENSIONS ARE TO BE FOLLOWED (UNLESS THE DRAWING IS PART OF A PLANNING APPLICATION). CONTRACTORS ARE TO CHECK ALL DIMENSIONS BEFORE WORK COMMENCES, AND REFER ANY APPARENT DISCREPANCY TO THE ARCHITECT.		
THIS DRAWING IS THE SOLE PROPERTY OF M.R PARTNERSHIP LIMITED, AND MAY NOT BE COPIED OR REPRODUCED IN ANY MANNER WHATSOEVER WITHOUT THE OWNERS WRITTEN CONSENT. (c) COPYRIGHT.		
PROJECT	38 HEATH DRIVE LONDON NW3	
DRAWING	WINDOW SCHEDULE 2	
DATE:	FEB 15	
DRAWN:	CAD	
SCALE:	1:10@A3	
DWG FILE:	DRAWING NUMBER: 2979801	REV. NO. <input type="checkbox"/>

**M·R PARTNERSHIP**  
ARCHITECTS & INTERIOR DESIGNERS

41 FOLEY STREET TEL: (020) 7631 5405  
LONDON W1W 7TS FAX: (020) 7631 5186



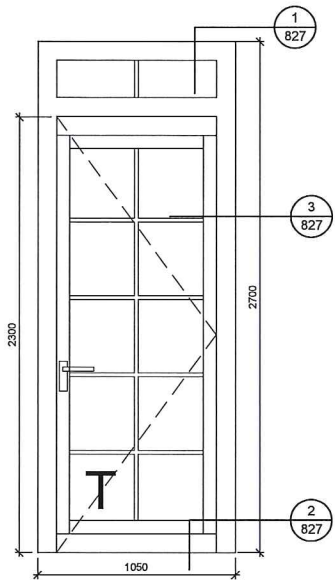

TYPE:	16, outward opening glazed door
Elevation no:	1, 6
Window nos.	GW:28, GW:29, GW:30
Glazing:	Clear glass
Ironmongery:	1 pair stainless steel lever handles
No. Req:	3

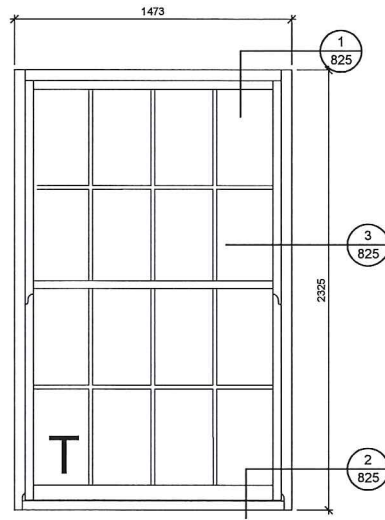

TYPE:	17, Sliding sash
Elevation no:	5
Window nos.	1W:25, 1W:26
Glazing:	Clear glass
Ironmongery:	Angel ventlock, window restrictors
No. Req:	2

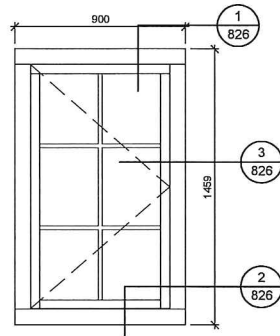

TYPE:	18, outward opening casement
Elevation no:	2
Window nos.	3W:04, 3W:08
Glazing:	Clear glass
Ironmongery:	-
No. Req:	2

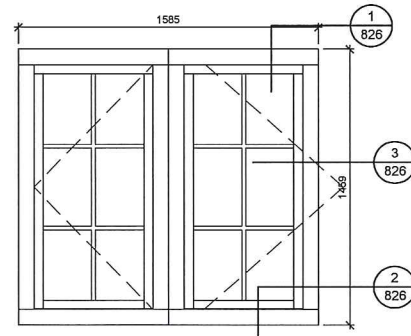

TYPE:	19, outward opening casement
Elevation no:	1, 2, 4, 5,
Window nos.	2W:01, 2W:02, 2W:04, 2W:05, 3W:01, 3W:02, 3W:03, 3W:04, 3W:05, 3W:06, 3W:07, 3W:11, 3W:12, 4W:01, 4W:02, 4W:03, 4W:04, 4W:07, 4W:08, 4W:09, 4W:10
Glazing:	Clear glass
Ironmongery:	-
No. Req:	21

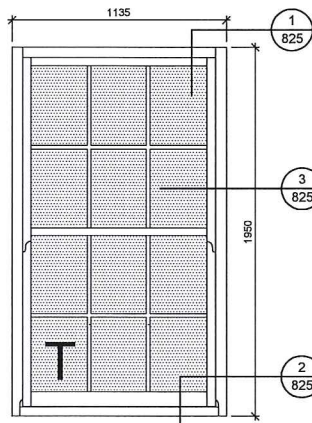

TYPE:	20, Fixed shut sash
Location:	Elevation 6
Window nos.	1W:28, 1W:29, 1W:30
Glazing:	Obscure glass
Ironmongery:	-
No. Req:	3

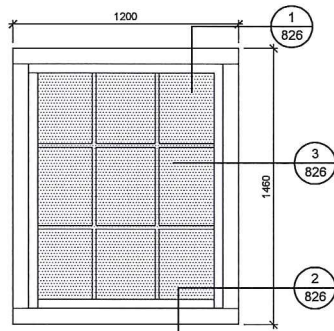

TYPE:	21, Fixed shut casement
Elevation no:	6
Window nos.	2W:27, 3W:16
Glazing:	Obscure glass
Ironmongery:	-
No. Req:	2

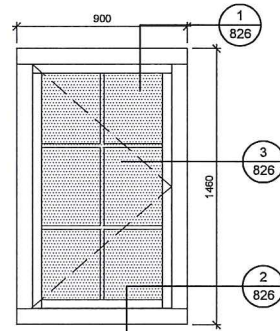

TYPE:	22, Fixed shut casement
Elevation no:	6
Window nos.	2W:28, 2W:29
Glazing:	Obscure glass
Ironmongery:	-
No. Req:	2

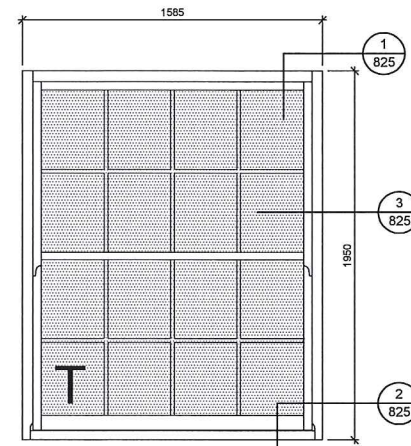

TYPE:	23, Fixed shut sash
Elevation no:	3
Window nos.	2W:19, 2W:20
Glazing:	Obscure glass
Ironmongery:	-
No. Req:	2

Note:

- All opening, accessible windows must be secure to:BS PAS 24-2012 with BS EN356;2000 P1a laminated glass fitted.
- All windows must achieve a U-Value of at least 0.9
- Acoustic glazing system to provide at least 37db sound insulation.
- Acoustic trickle ventilators to provide at least 42db sound insulation in open position.
- T - Denotes toughened glass\*

**TENDER ISSUE  
DRAWING**

DATE	REVISION	NO.
<small>THIS DRAWING IS NOT TO BE SCALED, ONLY FIGURED DIMENSIONS ARE TO BE FOLLOWED (UNLESS THE DRAWING IS PART OF A PLANNING APPLICATION). CONTRACTORS ARE TO CHECK ALL DIMENSIONS BEFORE WORK COMMENCES, AND REFER ANY APPARENT DISCREPANCY TO THE ARCHITECT. THIS DRAWING IS THE SOLE PROPERTY OF M.R PARTNERSHIP LIMITED, AND MAY NOT BE COPIED OR REPRODUCED IN ANY MANNER WHATSOEVER WITHOUT THE OWNERS WRITTEN CONSENT. (c) COPYRIGHT.</small>		
<b>PROJECT</b> 38 HEATH DRIVE LONDON NW3		
<b>DRAWING</b> WINDOW SCHEDULE 3		
DATE: FEB 15 DRAWN: CAD SCALE: 1:100A3	<b>M·R PARTNERSHIP</b> ARCHITECTS & INTERIOR DESIGNERS 41 FOLEY STREET TEL: (020) 7631 5405 LONDON W1W 7TS FAX: (020) 7631 5186	
DWG FILE:	DRAWING NUMBER: 2079802	REV. NO. <input type="checkbox"/>

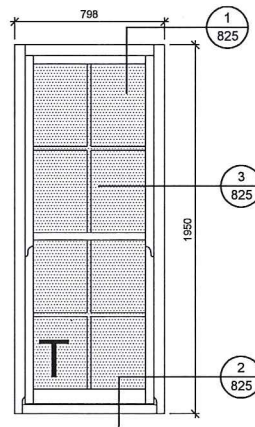

TYPE:	24, Fixed shut sash
Elevation no:	3
Window nos.	2W:16, 2W:17, 2W:28
Glazing:	Obscure glass
Ironmongery:	-
No. Req:	3

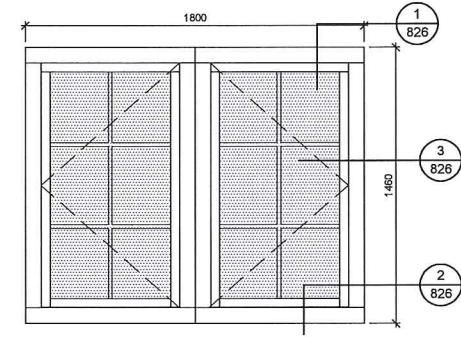

TYPE:	25, fixed shut casement
Elevation no:	3
Window nos.	3W:09, 3W:10, 4W:05, 4W:06
Glazing:	Obscure glass
Ironmongery:	-
No. Req:	4

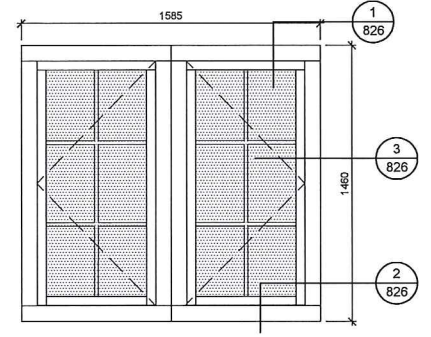

TYPE:	26, fixed shut casement
Elevation no:	1, 2, 4, 5,
Window nos.	2W:01, 2W:02, 2W:04, 2W:05, 3W:01, 3W:02, 3W:03, 3W:04, 3W:05, 3W:06, 3W:07, 3W:11, 3W:12, 4W:01, 4W:02, 4W:03, 4W:04, 4W:07, 4W:08, 4W:09, 4W:10
Glazing:	Obscure glass
Ironmongery:	-
No. Req:	21

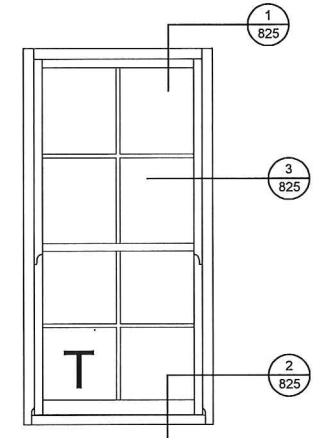

TYPE:	27, fixed shut sash
Elevation no:	5
Window nos.	2W:24
Glazing:	Clear glass
Ironmongery:	-
No. Req:	1

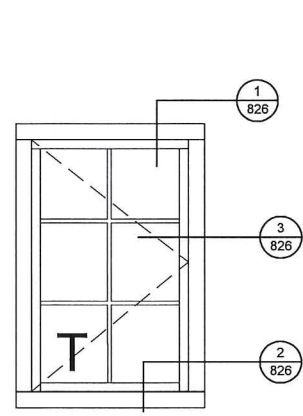

TYPE:	28, fixed shut casement
Elevation no:	4
Window nos.	3W:14
Glazing:	Clear glass
Ironmongery:	-
No. Req:	1

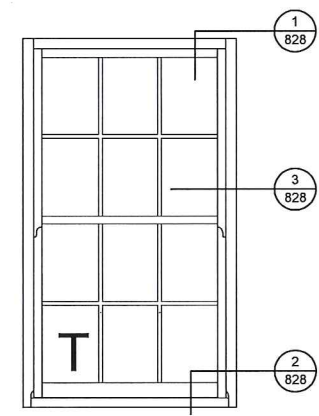

TYPE:	29, fixed shut casement with fire resistant secondary glazing
	screen internally
Fire rated:	30 minutes integrity glass & insulation
Elevation no:	5
Window nos.	GW:23
Glazing:	Clear glass
Ironmongery:	-
No. Req:	1

- Note:
- All opening, accessible windows must be secure to: BS PAS 24-2012 with BS EN356;2000 P1a laminated glass fitted.
  - All windows must achieve a U-Value of at least 0.9
  - Acoustic glazing system to provide at least 37db sound insulation.
  - Acoustic trickle ventilators to provide at least 42db sound insulation in open position.
  - T - Denotes toughened glass\*

## TENDER ISSUE DRAWING

<small>DATE</small>	<small>REVISION</small>	<small>NO.</small>
<small>THIS DRAWING IS NOT TO BE SCALED, ONLY FIGURED DIMENSIONS ARE TO BE FOLLOWED (UNLESS THE DRAWING IS PART OF A PLANNING APPLICATION). CONTRACTORS ARE TO CHECK ALL DIMENSIONS BEFORE WORK COMMENCES, AND REFER ANY APPARENT DISCREPANCY TO THE ARCHITECT.</small>		
<small>THIS DRAWING IS THE SOLE PROPERTY OF M.R PARTNERSHIP LIMITED, AND MAY NOT BE COPIED OR REPRODUCED IN ANY MANNER WHATSOEVER WITHOUT THE OWNERS WRITTEN CONSENT. (c) COPYRIGHT.</small>		
<b>PROJECT</b> 38 HEATH DRIVE LONDON NW3		
<b>DRAWING</b> WINDOW SCHEDULE 4		
<small>DATE:</small> FEB 15	 41 FOLEY STREET TEL: (020) 7631 5405 LONDON W1W 7TS FAX: (020) 7631 5186	
<small>DRAWN:</small> CAD		
<small>SCALE:</small> 1:10@A3		
<small>DWG FILE:</small>		
<small>DRAWING NUMBER:</small>	2979803	<small>REV. NO.</small> □



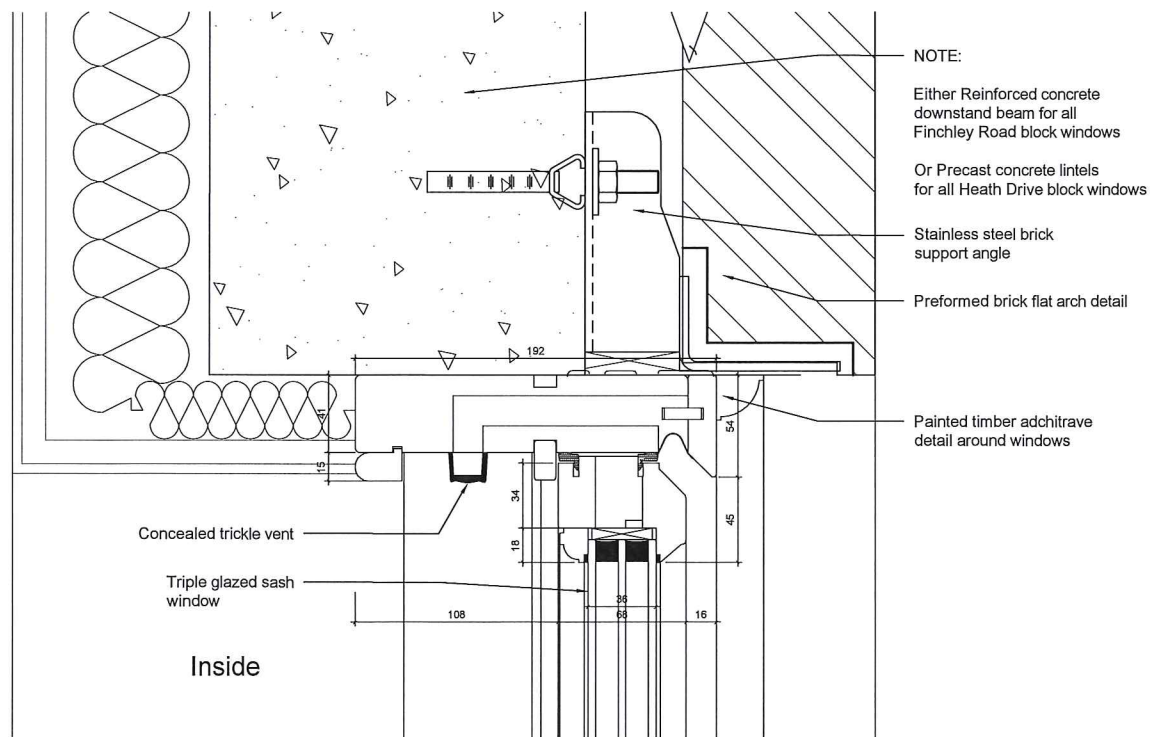

1 Sash Typical Head Detail  
 Scale: 1:2@A1

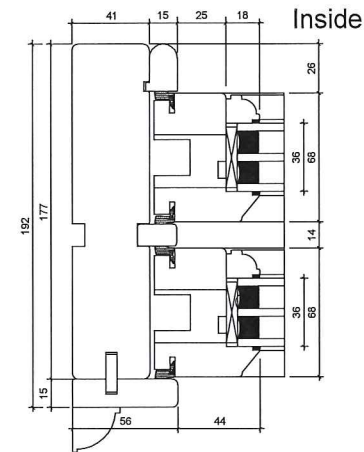
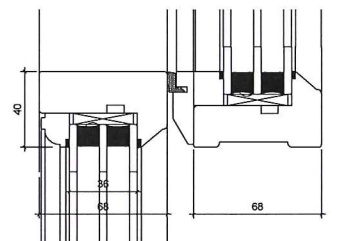

3 Sash Typical Jamb Detail  
 Scale: 1:2@A1

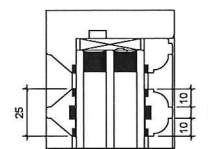

4 Sash Glazing Bar Detail  
 Scale: 1:2@A1

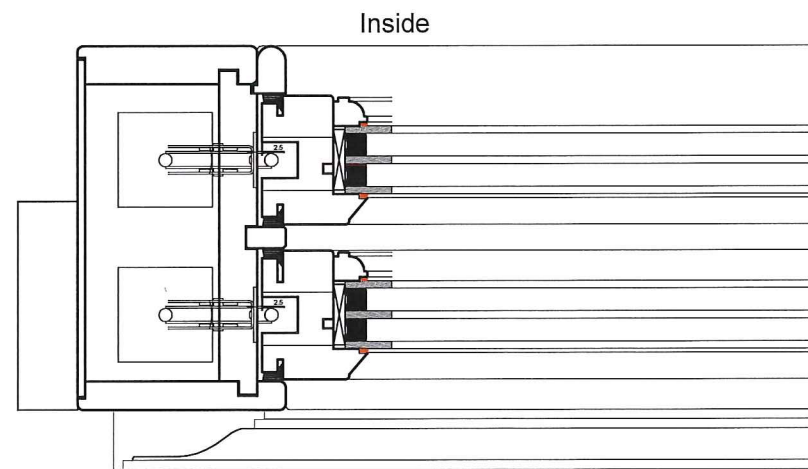

5 Sash Box Detail  
 Scale: 1:2@A1

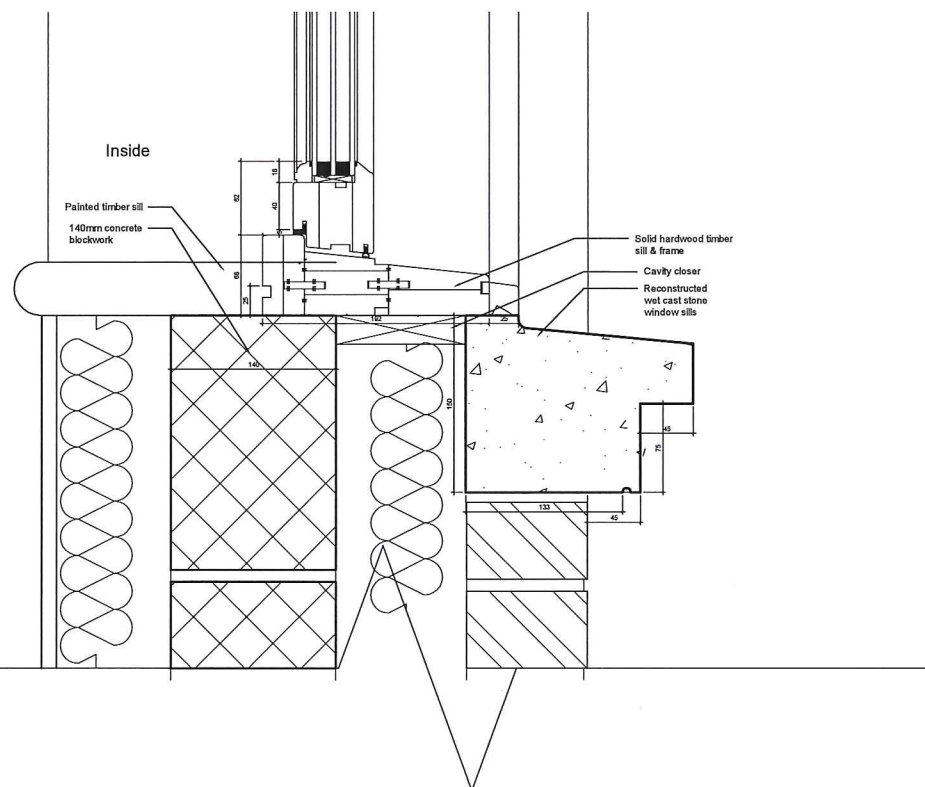

2 Sash Typical Cill Detail  
 Scale: 1:2@A1

Note:

- All opening, accessible windows must be secure to: BS PAS 24-2012 with BS EN356;2000 P1a laminated glass fitted.
- All windows must achieve a U-Value of at least 0.9

TENDER ISSUE  
 DRAWING

DATE	REVISION	NO.
THIS DRAWING IS NOT TO BE SCALED, ONLY FIGURED DIMENSIONS ARE TO BE FOLLOWED (UNLESS THE DRAWING IS PART OF A PLANNING APPLICATION). CONTRACTORS ARE TO CHECK ALL DIMENSIONS BEFORE WORK COMMENCES, AND REFER ANY APPARENT DISCREPANCY TO THE ARCHITECT.		
THIS DRAWING IS THE SOLE PROPERTY OF M.R PARTNERSHIP LIMITED, AND MAY NOT BE COPIED OR REPRODUCED IN ANY MANNER WHATSOEVER WITHOUT THE OWNERS WRITTEN CONSENT. (c) COPYRIGHT.		
PROJECT 38 HEATH DRIVE LONDON NW3		
DRAWING TYPICAL SASH WINDOW DETAILS		
DATE: FEB 15	<b>M·R PARTNERSHIP</b> ARCHITECTS & INTERIOR DESIGNERS 41 FOLEY STREET TEL: (020) 7631 5405 LONDON W1W 7TS FAX: (020) 7631 5186	
DRAWN: CAD		
SCALE: 1:2@A3		
DWG FILE:		
DRAWING NUMBER: 2079825		REV. NO. <input type="checkbox"/>

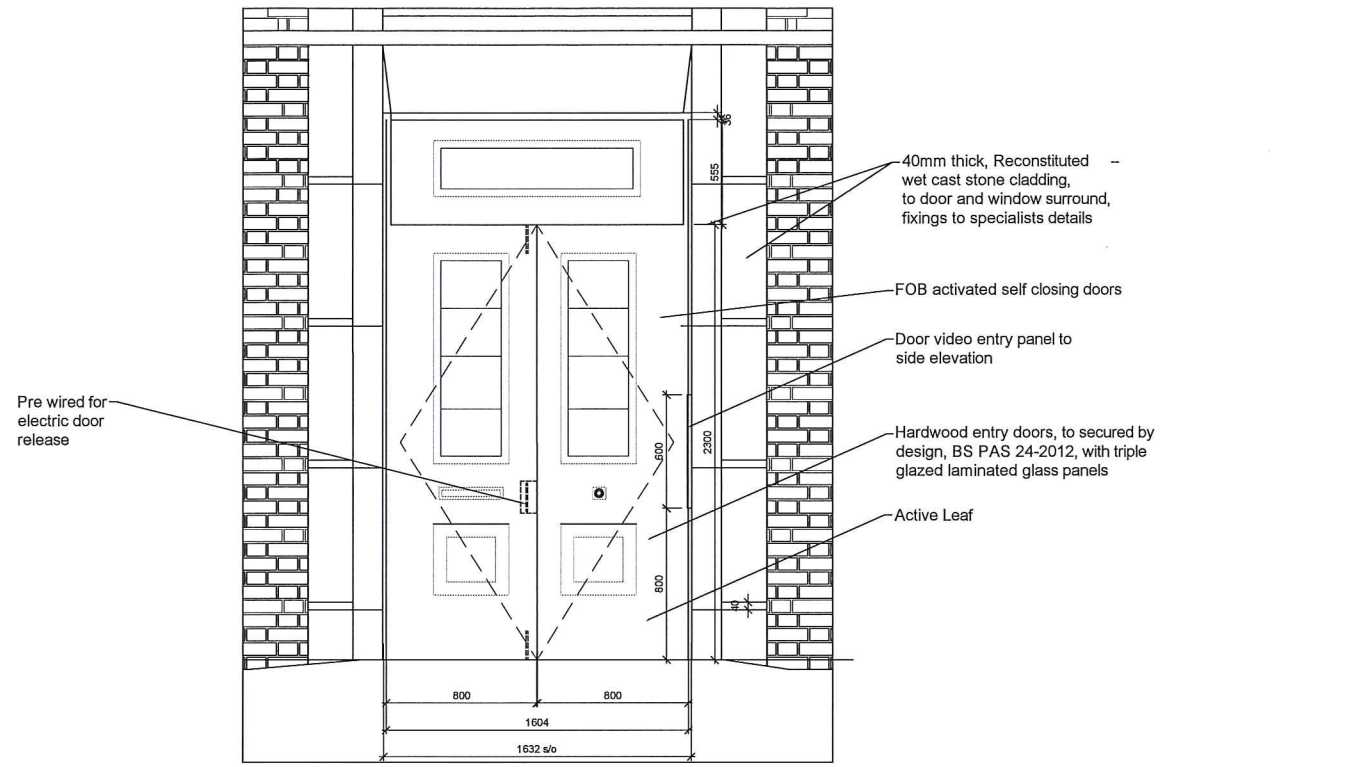

TYPE:	1
Location:	Front entrance, Elevation 1
Door nos.	GD:01
Glazing:	Tripple glazed, clear
Ironmongery:	Letterbox, handle, electric lock
No. Req:	1

1 Front door elevation  
Scale: 1:20@A1

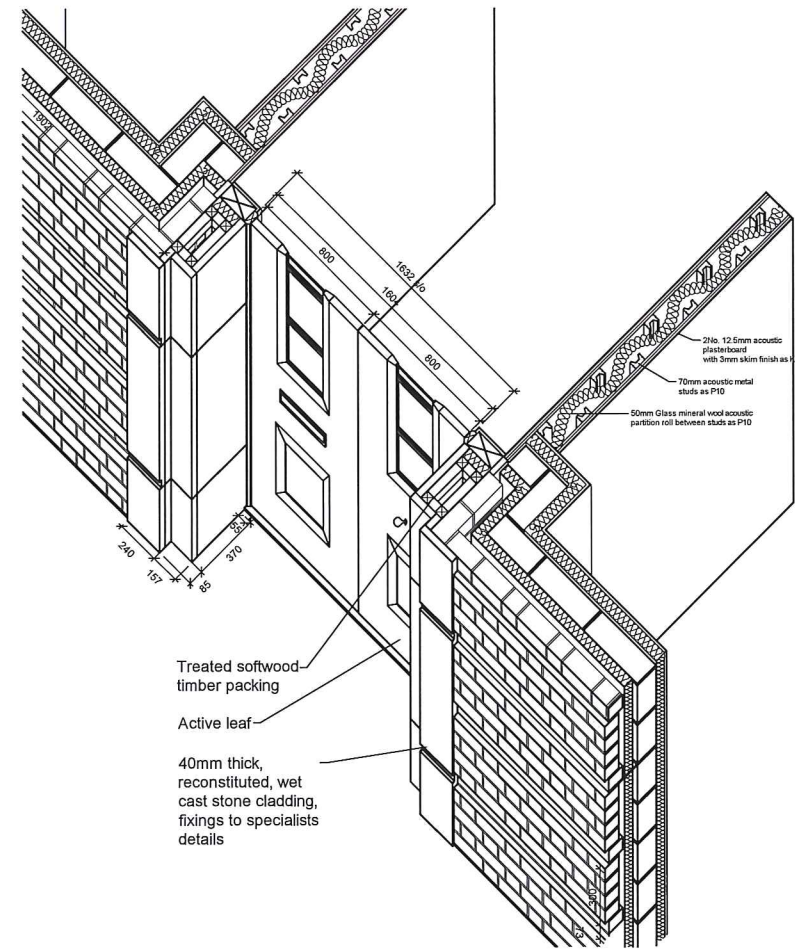

2 Main entrance axonometric detail  
Scale: 1:20@A1

Note:

- All doors must be secure to: BS PAS 24-2012 with BS EN356;2000 P1a laminated glass fitted.
- Doors must achieve a U-Value of at least 0.9

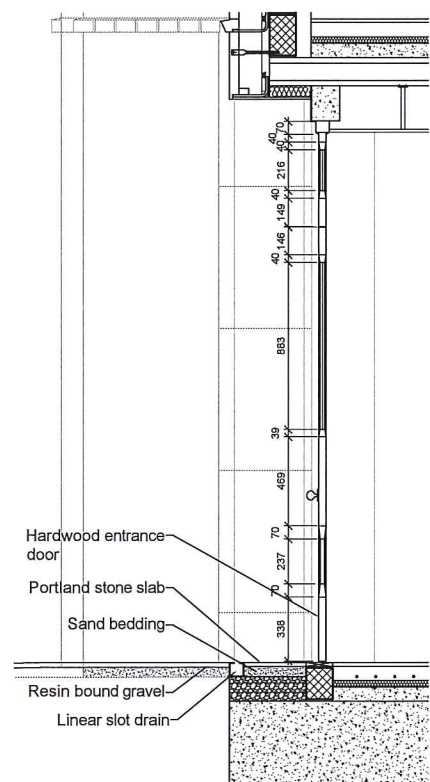

3 Front door detail section  
Scale: 1:20@A1

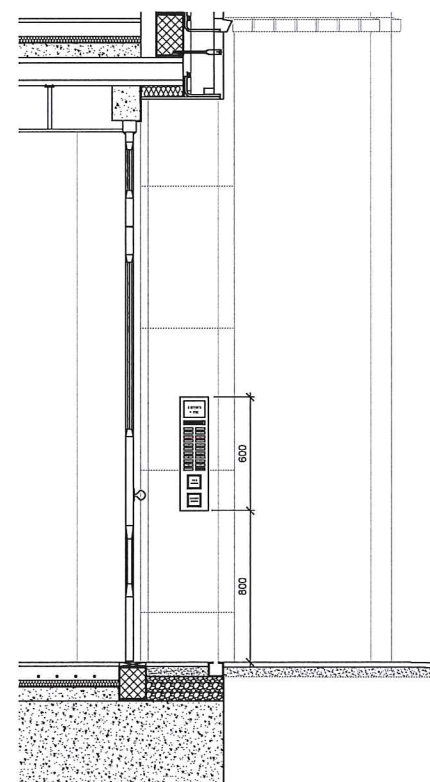

4 Front door detail section  
Scale: 1:20@A1

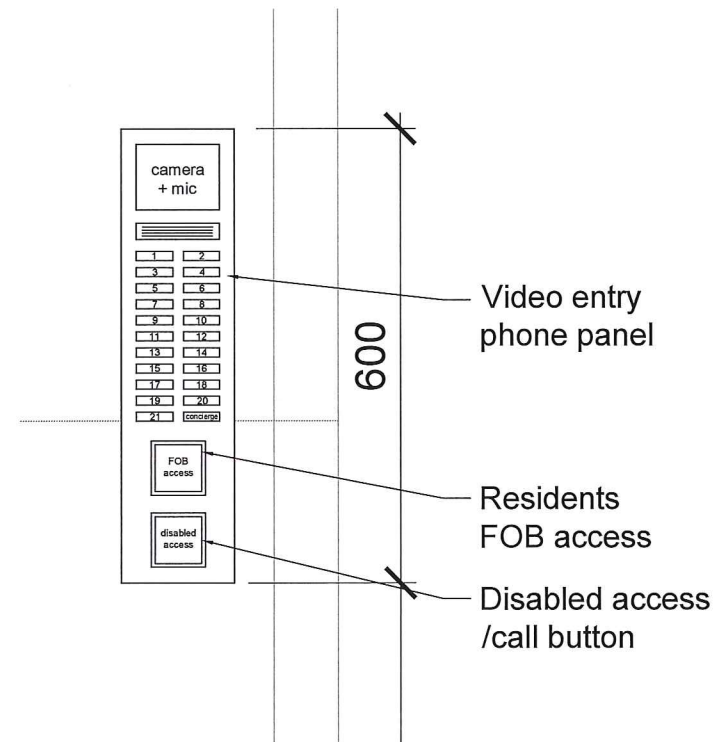

4 Video entry panel  
Scale: 1:5@A1

**TENDER ISSUE DRAWING**

DATE	REVISION	NO.
THIS DRAWING IS NOT TO BE SCALED, ONLY FIGURED DIMENSIONS ARE TO BE FOLLOWED (UNLESS THE DRAWING IS PART OF A PLANNING APPLICATION). CONTRACTORS ARE TO CHECK ALL DIMENSIONS BEFORE WORK COMMENCES, AND REFER ANY APPARENT DISCREPANCY TO THE ARCHITECT.		
THIS DRAWING IS THE SOLE PROPERTY OF M.R PARTNERSHIP LIMITED, AND MAY NOT BE COPIED OR REPRODUCED IN ANY MANNER WHATSOEVER WITHOUT THE OWNERS WRITTEN CONSENT. (c) COPYRIGHT.		
PROJECT <b>38 HEATH DRIVE LONDON NW3</b>		
DRAWING <b>EXTERNAL MAIN ENTRANCE DOOR DETAILS</b>		
DATE:	<b>M.R PARTNERSHIP ARCHITECTS &amp; INTERIOR DESIGNERS</b>	
FEB 15	41 FOLEY STREET TEL: (020) 7631 5405	
DRAWN:	LONDON W1W 7TS FAX: (020) 7631 5186	
CAD		
SCALE:		
1:20@A1		
DWG FILE:	DRAWING NUMBER: <b>2979850</b>	REV. NO. <input type="checkbox"/>