

General notes:

1. Shading indicates new construction.
2. All existing bathroom, kitchen and sanitaryware fittings to be removed.
3. Original joinery to be recorded and set aside for reuse where removal necessary.
4. No original door survived throughout the house. New door details to follow those of DIA drawings.
5. Fireplaces and hearth surrounds to be retained unless noted otherwise. Existing chimney flues to be unblocked and lined.
6. Existing services and drains removed and replaced throughout.
7. Overhaul and repair all windows/shutters and mouldings, including paneled aprons (except where stated as new items).
8. All rooms to be fitted with smoke/heat detectors and sounders at ceiling level with air sampling detection system in fire rooms
9. Repair floor joists as necessary. Consult with Architect and Structural Engineer. Strengthen existing joists as necessary.
10. Provide new appropriately detailed and sized cornices of traditional design throughout to replace existing modern cornices.
11. All services and pipe routes to follow existing routes where possible to avoid additional notching of joists or removal of existing fabric.
12. All new doors to be timber 4 panelled doors of traditional Georgian detailing.

Notes on Ground Floor:

- Internal doors: S/F new traditionally detailed timber door and architraves throughout except where indicated otherwise.

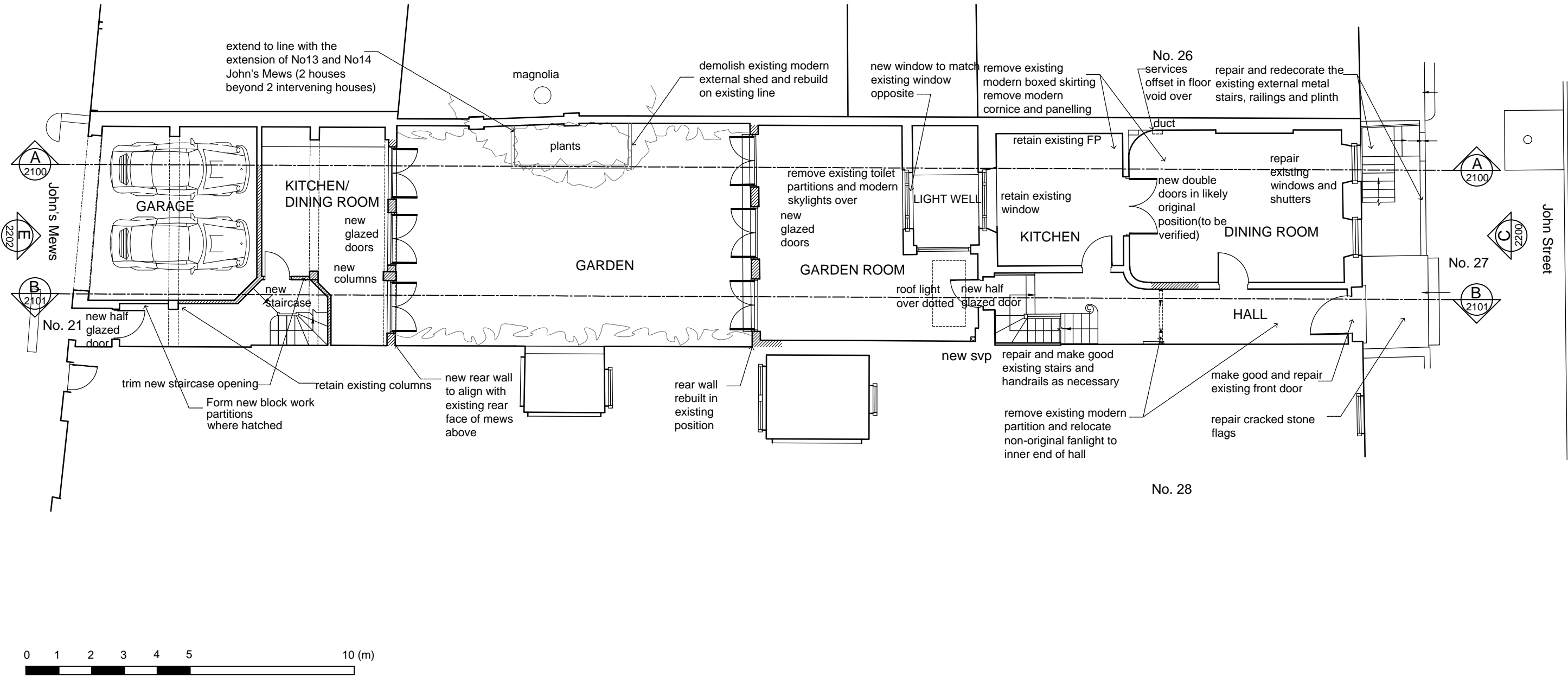
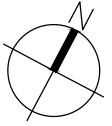

| No. | NOTES (STATUS: F. FEASIBILITY S. SKETCH DESIGN P. PLANNING B. BUILDING CONTROL D. DESIGN DEV / PRELIM M. MEASUREMENT T. TENDER C. CONSTRUCTION R. RECORD) | Rev | Date | Dwn | Auth | REVISIONS |
|-----|---|-----|------------|-----|------|---|
| 1 | For construction use only if status 'C' and checked against current revision | F | 24/03/2014 | TJB | ACS | General notes added |
| 2 | All dimensions to be checked on site by contractor | E | 10/03/2014 | SZP | ACS | Ground floor Mews rear wall aligned with Mews walls above. |
| 3 | Do not scale from this drawing | D | 17/02/2014 | JXA | ACS | Re-submission of planning issue |
| 4 | Unless otherwise indicated all dimensions are in millimetres | C | 05/09/2013 | JXA | ACS | Reinstatement of existing light well, reduction in size of Mews extension |
| | | B | 05/09/2013 | JXA | ACS | Planning Issue |
| | | A | 29/08/2013 | JXA | ACS | Adding Notes and alterations to layout |
| H | 12/03/15 ERH ACS Basement extension removed | - | 30/07/2013 | JXA | ACS | Initial Issue |
| G | 25/06/14 TJB ACS Car stacker removed | | | | | |

DONALD INSALL ASSOCIATES LIMITED

CHARTERED ARCHITECTS
PLANNING CONSULTANTS

12 Devonshire Street London W1G 7AB Tel: 020 7245 9888 Email: london@insall-architects.co.uk

Job 27 John Street & 21 John's Mews

Title Proposed Ground Floor Plan

| | | | | |
|------------|---------|--------|---|---|
| Job | JS27.02 | Status | P | |
| No | 2001 | Rev | H | |
| Scale (A3) | 1: | 1 | 2 | 5 |