

This drawing is prepared for the purposes of a planning application and to show design intent only. The information contained herein must not be used for costing, construction, engineering or any other purposes without agreement in writing from Waugh Thistleton Architects Ltd.

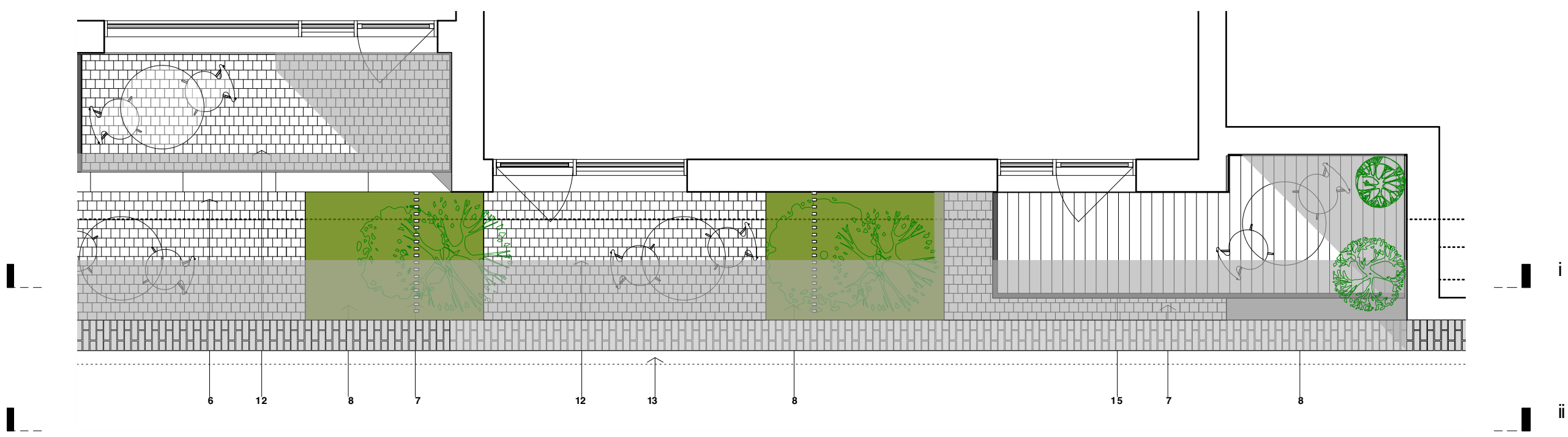

EXTRACT (ii) FROM WEST ELEVATION - FACING BIRKENHEAD ESTATE (READ WITH DRAWING No 1505)



EXTRACT FROM FLOOR PLAN

- NOTES:
- Proposed new facing brick TYPE 1. Stock brick in running bond with flush mortar joints generally. Standard size, colour and type to be agreed.
 - Proposed new facing brick TYPE 2. Stock brick in running bond with flush mortar joints generally. Standard size, colour and type to be agreed.
 - Anodised aluminium thermally broken double glazed windows and doors
 - Anodised aluminium cladding
 - Concrete fascia / canopy
 - Concrete capping stone
 - Hit and Miss Brickwork
 - Raised planting beds.
 - Bio-Diverse green roof
 - Paving TYPE 1 - Individual Entrance
 - Paving TYPE 2 - Communal Entrance
 - Paving TYPE 3 - Open Space
 - Re-used, reclaimed brick from the existing building.
 - New boundary wall to BH Estate rebuilt using reclaimed bricks. Height varies.
 - Timber decking

NOTES

Material Notes



Integrated Soil Landscaping Throughout. Bio-Diverse Sedum roofs. Areas of relief in the brickwork and changes in bond & colour

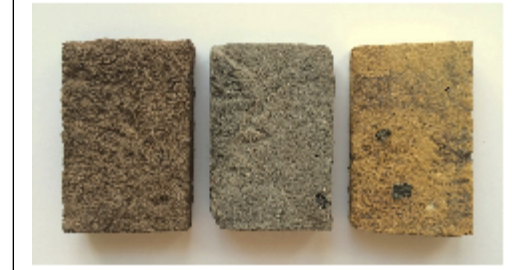

New facing brick in complementary tone and texture utilised with localised areas of re-used London stock brick.

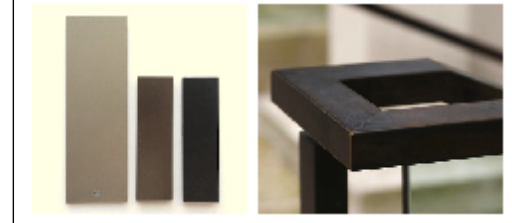

Metallic finishes used in contrast to the brick texture. Anodised Aluminium windows. Darker tonal colours to complement the brick.



Individual & shared residential entrances differentiated. Brick & Buff sandstone paving.



Open space and commercial entrances. Mid & warm grey granite paving.

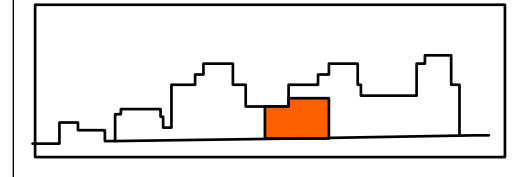

REV	Comments	DATE	PP	CHK
B	Height Amended	10/02/15	PP	CHK

STATUS

PLANNING

Job 277a Grays Inn Road

Title Elevation Detail West
Elevation Extract (ii)

Date February 2015

Scale 1:50 @ A2

Drawn PP

126-1506