

Rev.	Date	Description	By
1	07/01/15	Planning App Draft	JR
2	13/02/15	Planning App Draft	LM
3	20/02/15	Planning App Draft	LM
4	25/02/15	Planning Application	LM
5	24/04/15	Planning App Review 2	LM

Notes

- Boundary line above ground
- Boundary line below ground
- Facade line above

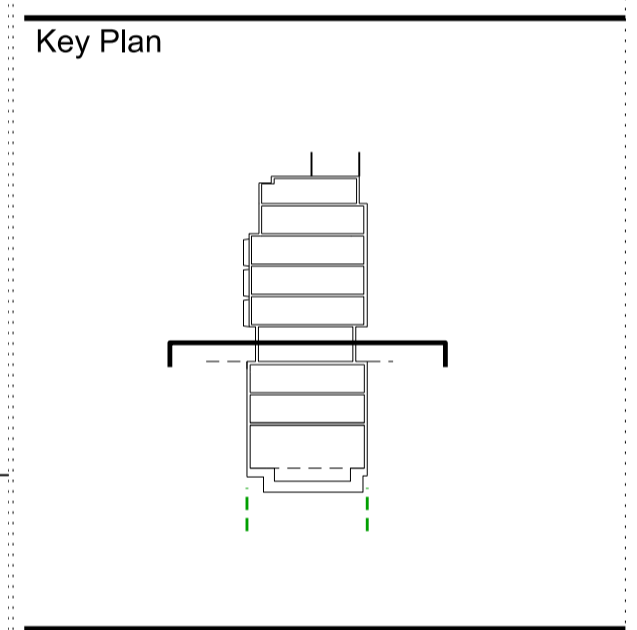

ARCHITECTS
STEFFIAN BRADLEY

sha
STEFFIAN BRADLEY

45 Gee Street
5th Floor
London
EC1V 3RS
T (020) 7549 4050
www.steffian.com

Pilbrow & Partners

t: +44 (0) 20 3696 7000
e: info@pilbrowandpartners.com
www.pilbrowandpartners.com

Project Number 8219.0000 Scale 1:350 @ A1

Client **UCLH**

Project **Phase 5 Project**

Title **Proposed Urban Plan**

Drawing No _____ Revisions _____

SBA-DRW-A1102-REV06

Date	Drawn	Checked	Approved
24/04/15	LM	PT	PT



- Key**
- 1 Phase 5 building footprint at ground level
 - 2 Site boundary (in red)
 - 3 Proposed new main entrance along Huntley Street
 - 4 Retained entrance / Facade along Capper Street
 - 5 Secondary entrance to Shropshire Place linked to Queens Yard
 - 6 Staff Entrance
 - 7 FM entrance to FM zone within the building footprint
 - 8 Fire escape to Huntley Street
 - 9 New pedestrian Urban realm / pavement zones created around the site
 - 10 Roof lights and vent intakes / extracts to basement zones
 - 11 Primary core linked to main reception
 - 12 Main Entrance Reception / Education / Cafe
 - 13 Huntley Street
 - 14 Shropshire Place
 - 15 Capper Street
 - 16 Queens Yard - linked to Tottenham Court Road - FAAP
 - 17 Phase 3 - Cancer Centre
 - 18 Exit road from 170 TCR
 - 19 Mortimer Market Centre
 - 20 Shropshire House
 - 21 Queens Yard House
 - 22 Mullard House car park
 - 23 Gordon Mansions - No (1 to 30)
 - 24 Gordon Mansions - No (31 to 75)
 - 25 Georgian Terrace Huntley Street - No (46 to 70)
 - 26 UCLH - O'Gorman Building
 - 27 UKPN - Switchroom and Substation

URBAN PLAN

