

PLANNING ISSUE	
NOTES: All dimensions must be confirmed on site and verified with the Architect. Any discrepancies on the drawing must be reported to the Architect prior to any works being carried out on site. Do not scale off drawing. The copyright of this schedule / drawing remains with the Architect. No part of this schedule / drawing may be reproduced in any form or by any means without the written permission of Nicholas Lee Architects.	
Project: 65A Gaisford Street	
Drawing Title: Proposed Lower Ground Floor Plan	
Drawing No: 1224/AP-001	
Date: 02.04.15	Scale: 1:50 @ A3
nicholas lee architects 34A Rosslyn Hill, London NW3 1NH Tel: 020 7435 9315 www.nleearchitects.com	

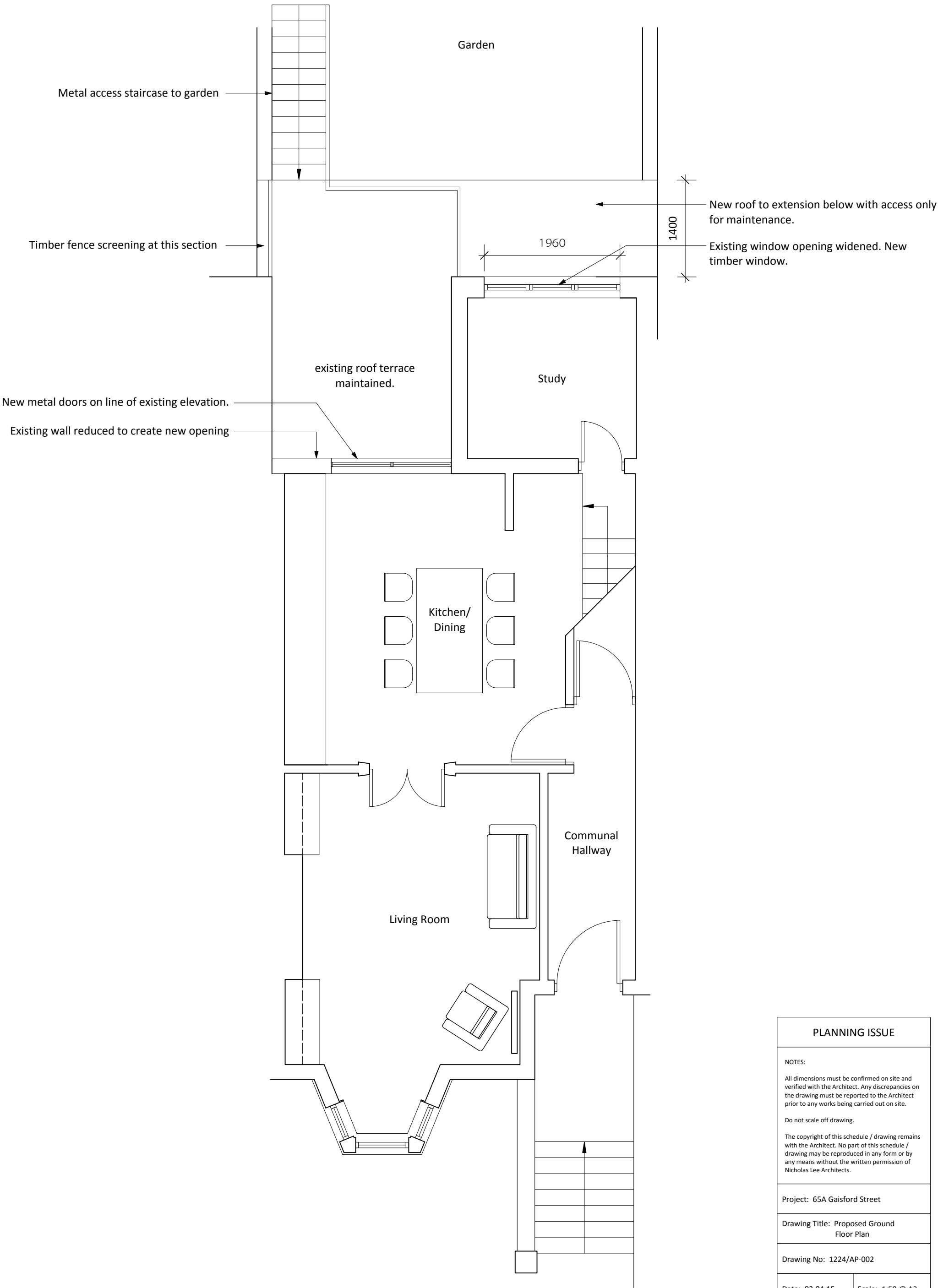

PLANNING ISSUE	
NOTES: All dimensions must be confirmed on site and verified with the Architect. Any discrepancies on the drawing must be reported to the Architect prior to any works being carried out on site. Do not scale off drawing. The copyright of this schedule / drawing remains with the Architect. No part of this schedule / drawing may be reproduced in any form or by any means without the written permission of Nicholas Lee Architects.	
Project: 65A Gaisford Street	
Drawing Title: Proposed Ground Floor Plan	
Drawing No: 1224/AP-002	
Date: 02.04.15	Scale: 1:50 @ A3
nicholas lee architects 34A Rosslyn Hill, London NW3 1NH Tel: 020 7435 9315 www.nleearchitects.com	



PLANNING ISSUE

NOTES:

All dimensions must be confirmed on site and verified with the Architect. Any discrepancies on the drawing must be reported to the Architect prior to any works being carried out on site.

Do not scale off drawing.

The copyright of this schedule / drawing remains with the Architect. No part of this schedule / drawing may be reproduced in any form or by any means without the written permission of Nicholas Lee Architects.

Project: 65A Gaisford Street

Drawing Title: Proposed Rear Facade

Drawing No: 1224/AE-001

Date: 02.04.15 Scale: 1:50 @ A3

nicholas lee architects
34A Rosslyn Hill, London NW3 1NH
Tel: 020 7435 9315 www.nleearchitects.com