

Window J

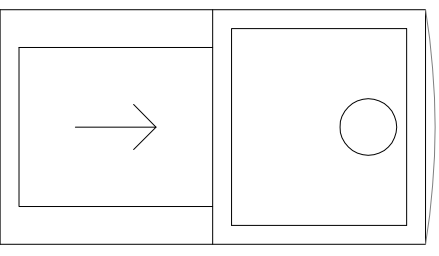

Window K

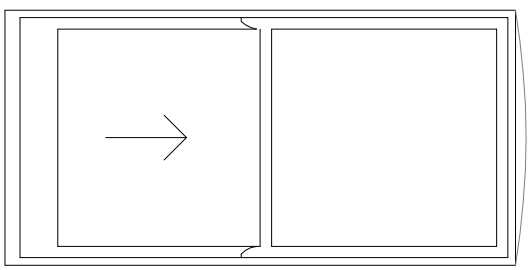

Window L

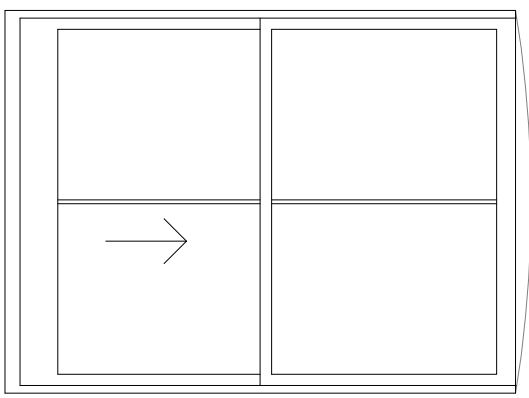

Window M

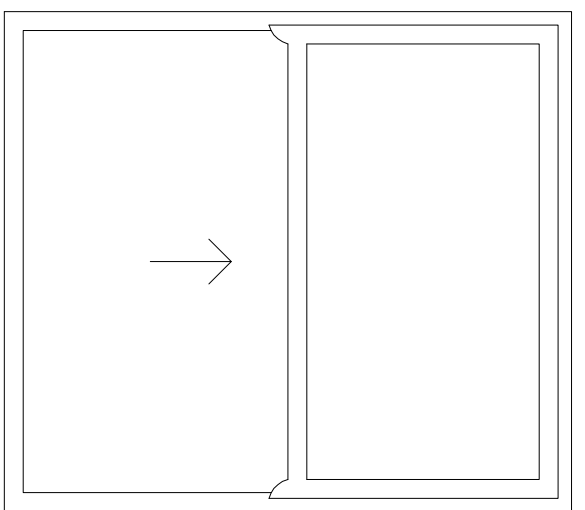

Window N

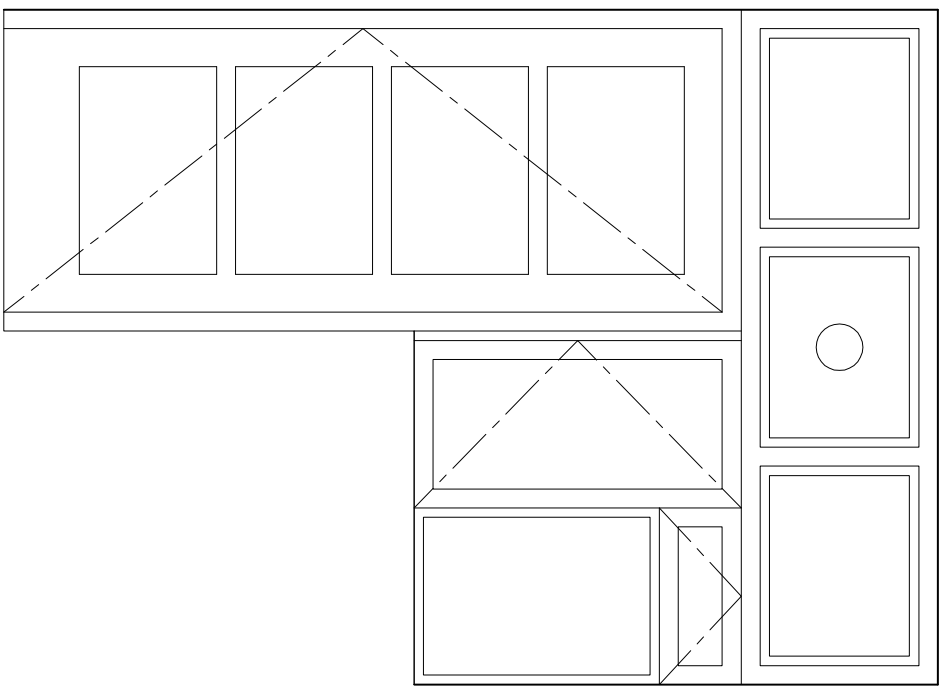

Note
 Windows drawn indicatively. Window sizes to be checked on site. All replacement windows to be PVCu to match existing styles.

The contractor is responsible to ensure that no products are to be utilised that do not comply with relevant British and/or European Standards and/or Codes of Practice, British Regulations, Construction Regulations, or which are known or suspected at the time of product selection to be in breach of any applicable laws, regulations, codes of practice, standards, specifications or in accordance with good building practices.

The contractor is responsible for checking dimensions, tolerances, levels and references. The contractor is responsible for ensuring that the drawings are in accordance with the information on site or shop drawings.

Where an item is covered by drawings to different scales, the larger scale drawing is to be worked to.

Do not scale drawings. Figure dimensions to be worked to in all cases.

This drawing and the copyrights and patents therein are the property of Baily Garner LLP and may not be used or reproduced without consent or attribution.

REVISION	D	C	DATE

A3

CLIENT: London Borough of Camden	PROJECT: 27A-B Minster Road
ADDRESS: 27A-B Minster Road Camden NW2 3SG	TITLE: Existing Window Elevations Page 2 of 2 PURPOSE OF ISSUE: Planning
SCALE: 1:20	DRAWING NO.: JDC 13
WORK NO: 26645	DATE: 10/04/2015
	REVISION:



BAILY · GARNER
 146-148 ELTHAM HILL
 LONDON, SE9 5DY
 t. 020 8294 1000
 f. 020 8294 1320
 e. general@bailygarner.co.uk