

1m 2m 3m 4m 5m 6m 7m 8m 9m 10m

1:100

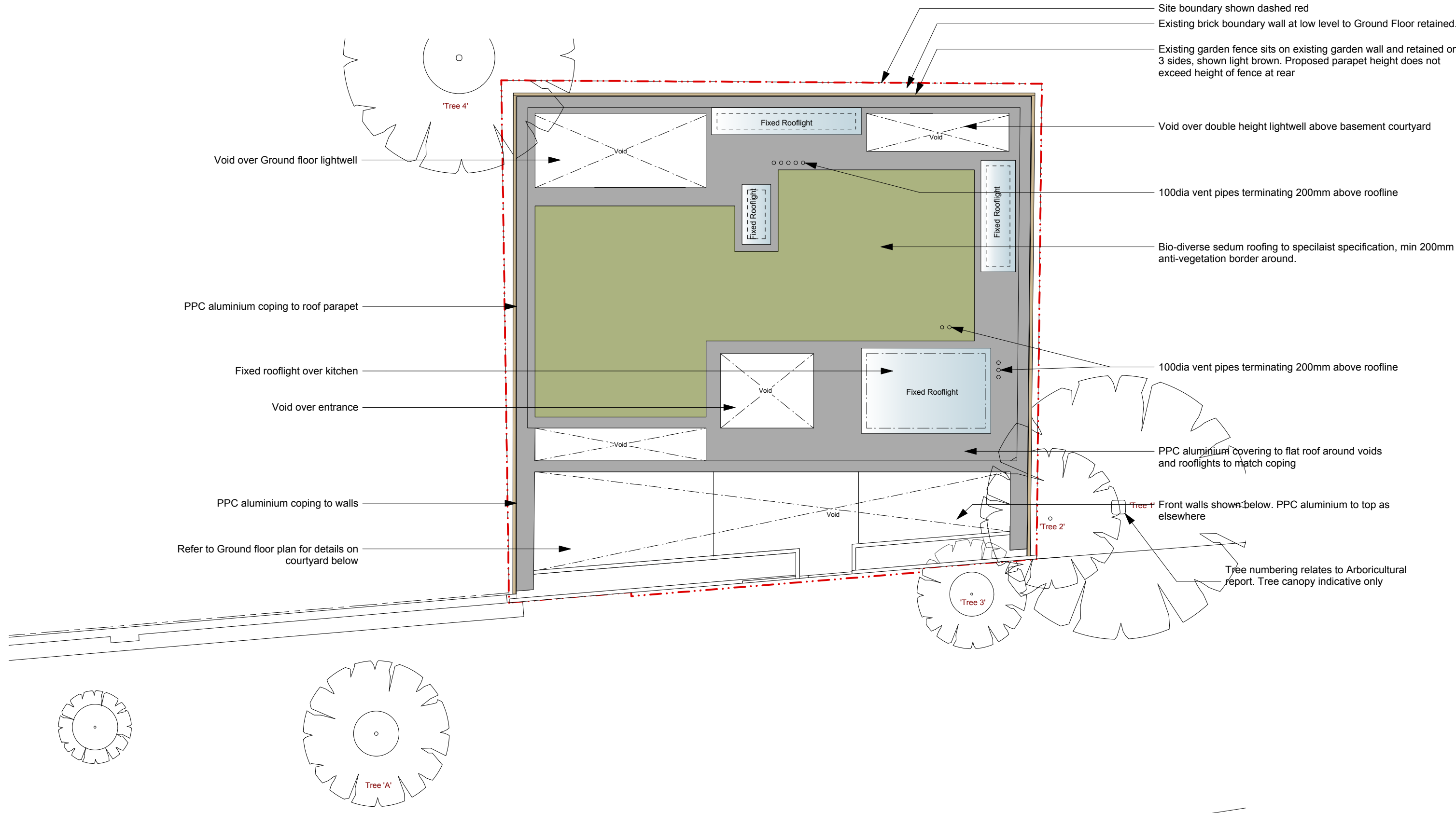

Site boundary shown dashed red

Existing brick boundary wall at low level to Ground Floor retained.

Existing garden fence sits on existing garden wall and retained on 3 sides, shown light brown. Proposed parapet height does not exceed height of fence at rear

Void over double height lightwell above basement courtyard

100dia vent pipes terminating 200mm above roofline

Bio-diverse sedum roofing to specialist specification, min 200mm anti-vegetation border around.

100dia vent pipes terminating 200mm above roofline

PPC aluminium covering to flat roof around voids and rooflights to match coping

Front walls shown below. PPC aluminium to top as elsewhere

Tree numbering relates to Arboricultural report. Tree canopy indicative only

Void over Ground floor lightwell

PPC aluminium coping to roof parapet

Fixed rooflight over kitchen

Void over entrance

PPC aluminium coping to walls

Refer to Ground floor plan for details on courtyard below

NOTES:

- DO NOT SCALE FROM THIS DRAWING.
- ALL DIMENSIONS TO BE CHECKED ON SITE.
- ALL OMISSIONS AND DISCREPANCIES TO BE REPORTED TO THE ARCHITECT IMMEDIATELY

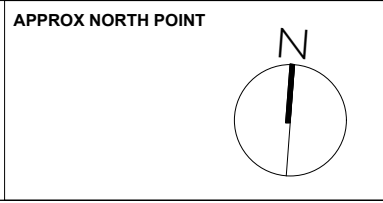

TF ARCHITECTURE

2-3 WOODSTOCK STREET
LONDON W1C 2AB

T. 020 7052 0756
F. 020 7052 0757
E. info@tfarchitecture.com

STATUS	PLANNING			
PROJECT	ST PAULS MEWS, LONDON, NW1 9TZ			
DRAWING TITLE	20.03.2015	PROPOSED ROOF PLAN		
DATE 03.2014	SCALE 1:100@A3	JOB NO. 448	DRWG NO. (00)_112	REV. B