

KEY

Site Boundary 

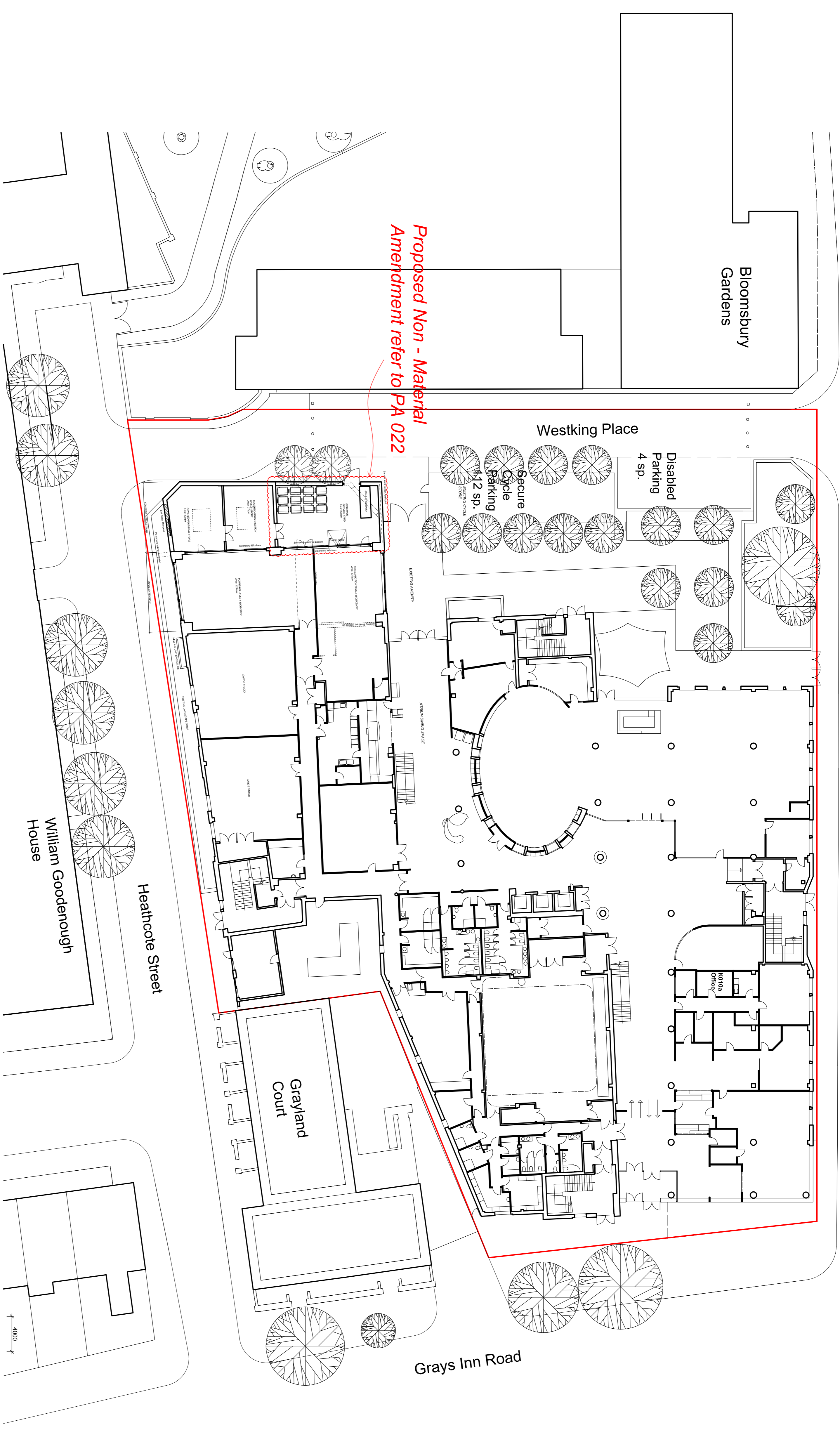

*Proposed Non - Material
Amendment refer to PA 022*

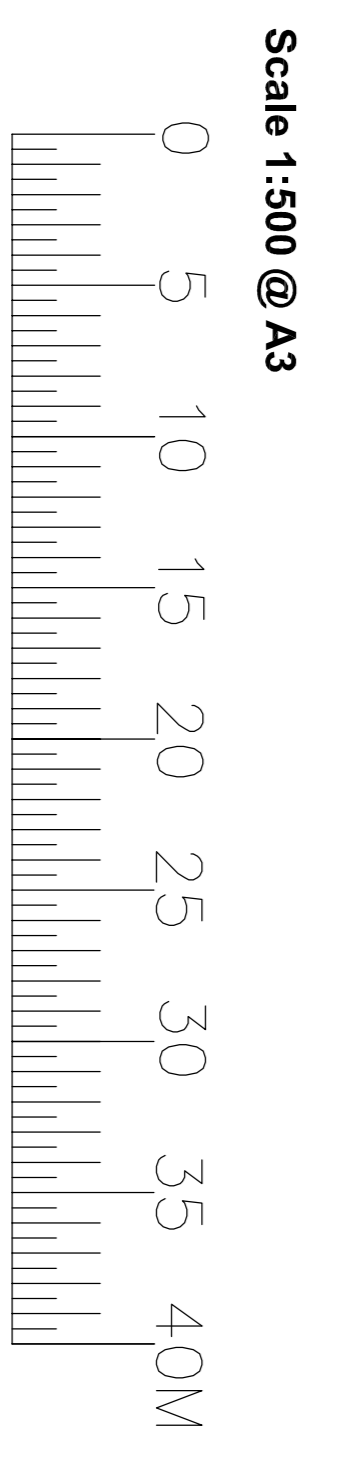

Frederick Gibberd Partnership 117-121 Curtain Road London EC2A 3AD +44(0)20 7739 3940 +44(0)20 7739 8948 studio@gibberd.com www.gibberd.com		REV P2 P3 P4	DESCRIPTION Planer and details amended Proposed Non-Material Amendment as Bubbled Roller shutter doors replaced with double doors	DATE 28.01.15 08.02.15 09.03.15	DRAWN GR GR	AUTH JF JF	REV P2 P3 P4	DESCRIPTION Planer and details amended Proposed Non-Material Amendment as Bubbled Roller shutter doors replaced with double doors	DATE 28.01.15 08.02.15 09.03.15	DRAWN GR GR	AUTH JF JF	© Copyright of the information is vested in Frederick Gibberd Partnership. For the avoidance of doubt, all dimensions are measured to wall structure and not finishes unless otherwise stated.	Gibberd ARCHITECTURE MASTER PLANNING INTERIOR DESIGN LANDSCAPE	Client: Westminster Kingsway College Project: Kings Cross Extension Title: Proposed Site Plan Project No: 2004 Drawing No: (PA) 020 Date: 09.12.14 Scale: 1:500 @ A3 Date: 09.12.14 Author: JF Status: Planning
--	--	-----------------------	--	--	-------------------	------------------	-----------------------	--	--	-------------------	------------------	--	---	--