

# Improved Towpath Access

## Strategic Approach

The new steps will provide a less steep approach to the towpath from Kentish Town Road and comply with current part M and British Standards with cycle gully to improve ease of access for cyclists. Terraced seating adjacent to the steps will provide a place to sit and enjoy the view of the canal. New paving will be provided adjacent to the scheme to match the existing towpath paving and to give the feeling of a unified surface.

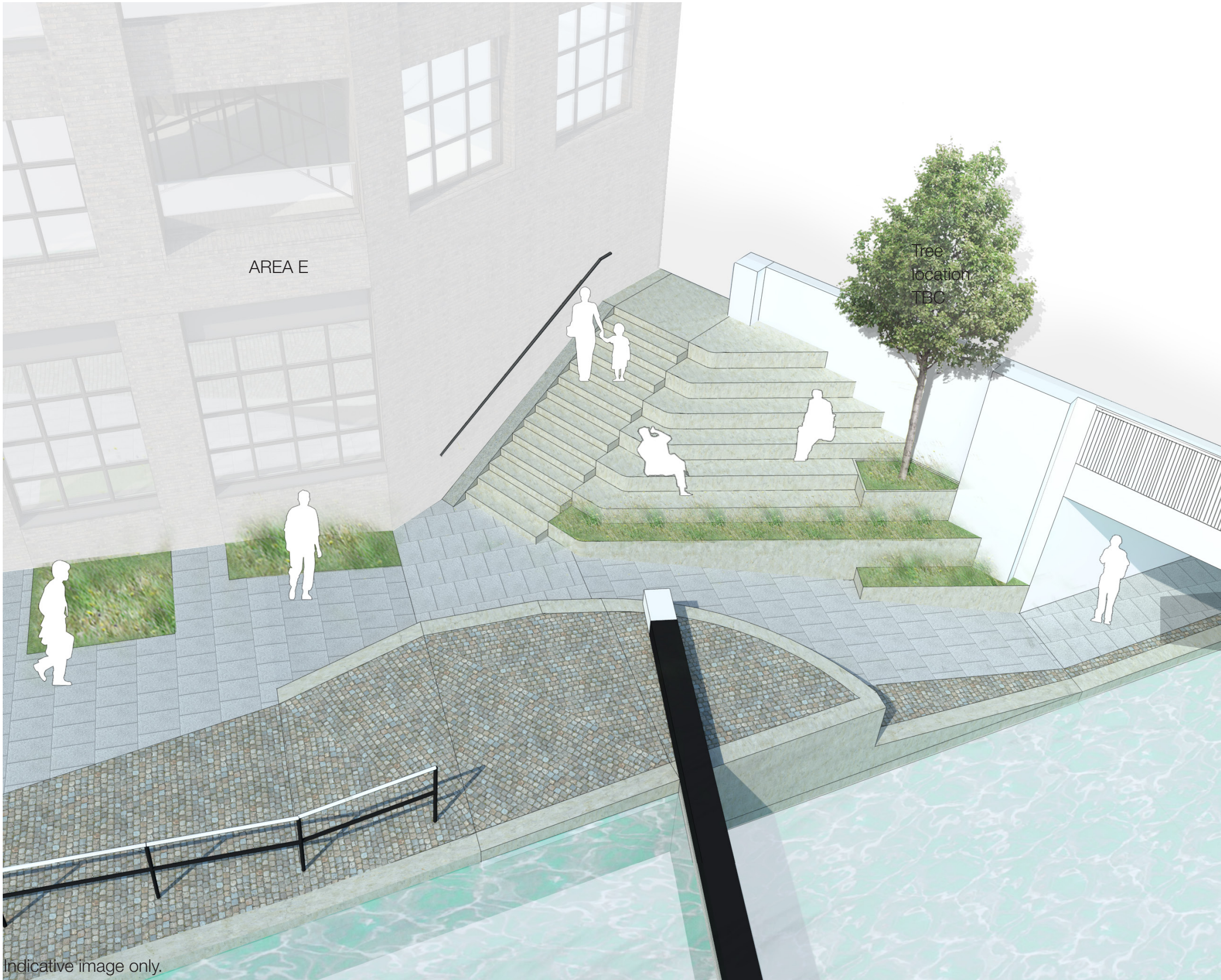

Indicative image only.



Key plan



# Improved Towpath Access

## Strategic Approach

The area adjacent to the steps would benefit from increased passive surveillance and overlooking from the proposed Area E. The proposed seating area would reduce the existing dark and unsafe corners of the towpath, removing the need for the fence. The positioning of CCTV cameras would be reviewed in detail with a crime prevention officer and owner. Lighting would be integrated into the steps to avoid the need for pole mounted lights in this area.



Indicative image only.



Existing condition



Key plan