

# BOLTON ROAD

Proposed Site Plan - 1:100 @ A4

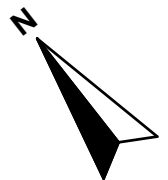
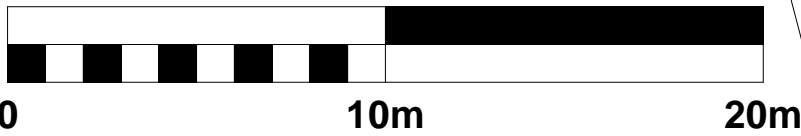
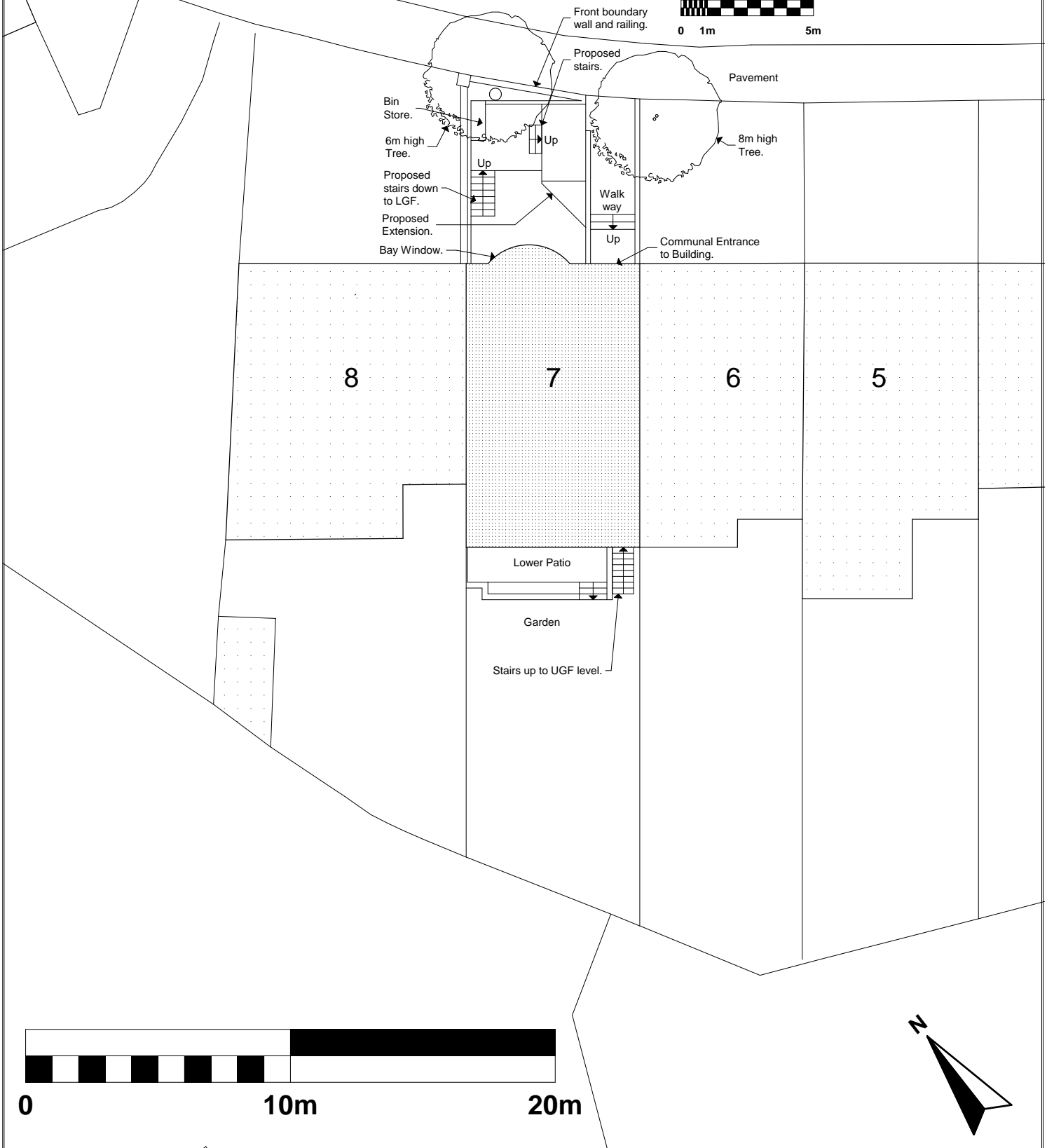

Project 7A Bolton Road		Drawing size A4	File ref: 1137AB014.pln	© Copyright	
Client Litven Limited	Date Aug 14	Scale 1:200	Preliminary Planning	Rev A	Date 10/04
			Building Regs		Design amendments.
Drawing Proposed Site Plan	Reference Number 1137-BA-114 A		Tender		
			Construction		
			As Built		

© Copyright

**DONALD SHEARER**  
 ARCHITECTS  
 CHARTERED ARCHITECTS

Scholar's House, Shottery Brook Office Park, Tel: 01789 294 560  
 Timothy's Bridge Road, Stratford-upon-Avon, Warwickshire, CV37 9NR donald@ds-architects.demon.co.uk