

# **Drawings**



PANEL ABOVE

NOTES:

ALL IN SOFTWOOD PAINTED FINISH.

DIMENSIONS & PROFILES OF EXISTING  
MOULDINGS TO BE OBTAINED FROM THE SITE.

SEE ALSO DWG. N° 9004. 20

TO LINE

FACE OF  
PLASTER

PLINTH BLOCK

DADO  
RAIL

PLASTER  
FACE

ARCHITRAVE TO MATCH  
EXISTING

DOORS TO  
BE HUNG ON  
EXTENDED  
HINGES TO OPEN  
RIGHT BACK.

F.S. SECTION

F.S. PLAN  
OF JAMB

HB9070140

LONDON BOROUGH OF CROYDON  
PLANNING AND TRANSPORT  
DEPARTMENT  
10 SEP 1990  
RECEIVED

ARCHITRAVE TO MATCH  
EXISTING

END OF DADO  
RAIL RETURNED  
ON ITSELF

PLINTH  
BLOCK

PLINTH  
BLOCK

FULL SIZE ELEVATION OF HEAD

48 44 & 45 BEDFORD SQUARE  
LONDON W.C.1  
TENANTS OCCUPATION

Dwg. Title  
N° 44 GROUND FLOOR - NEW  
DOORS BETWEEN FRONT  
& REAR ROOMS

Date 15.8.90 Scale Full Size Dwg. No. J.G.

LONDON BOROUGH OF CROYDON  
PLANNING AND TRANSPORT  
DEPARTMENT  
25 SEP 1990  
RECEIVED

EC&G  
Chartered Architects

Ellis Clarke and Gallannaugh  
822 Portland Place, London, W1N 3DH  
Tel: 01-323 6516 Fax: 01-323 4653

Dwg. No.  
9004.21



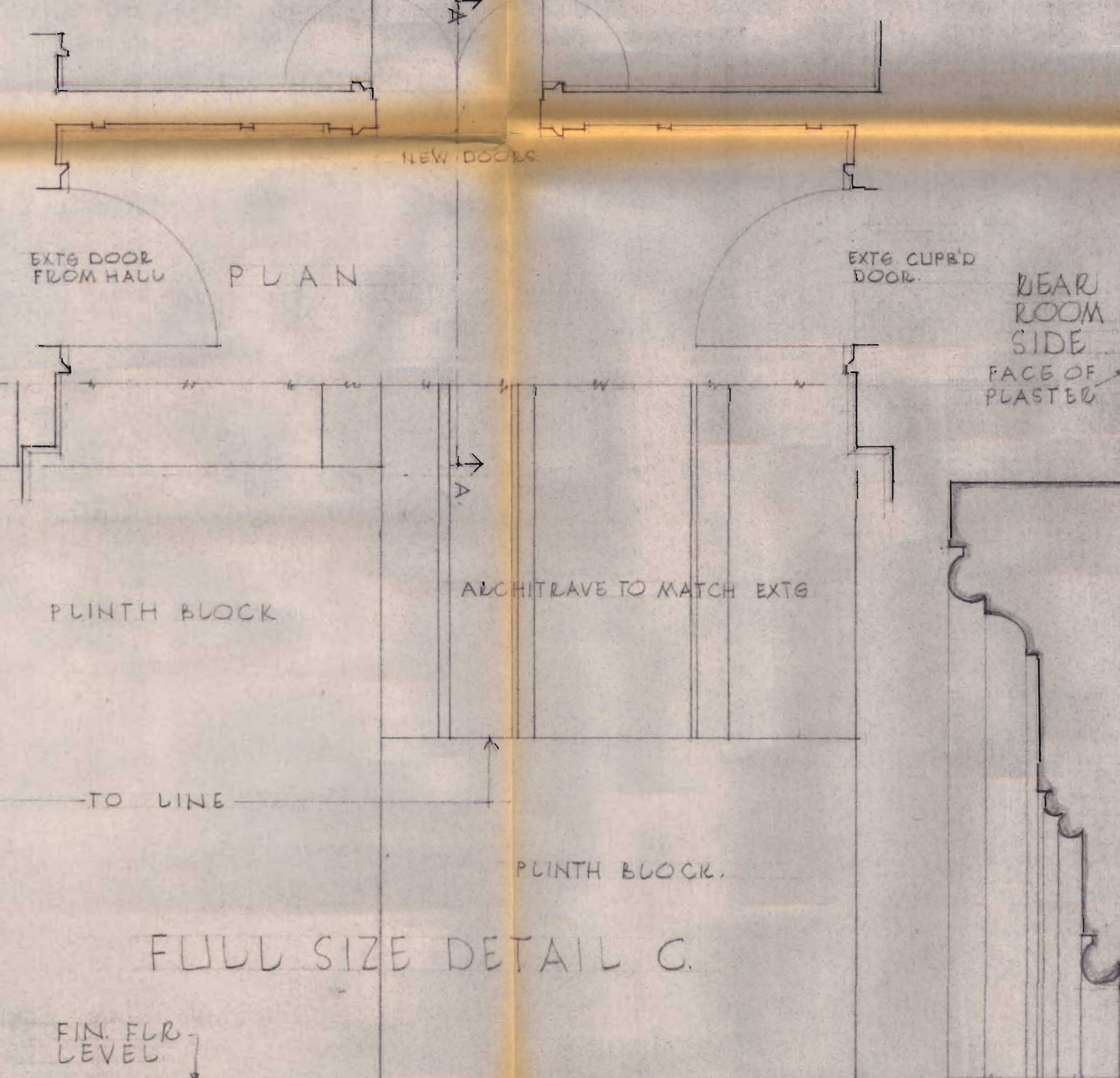
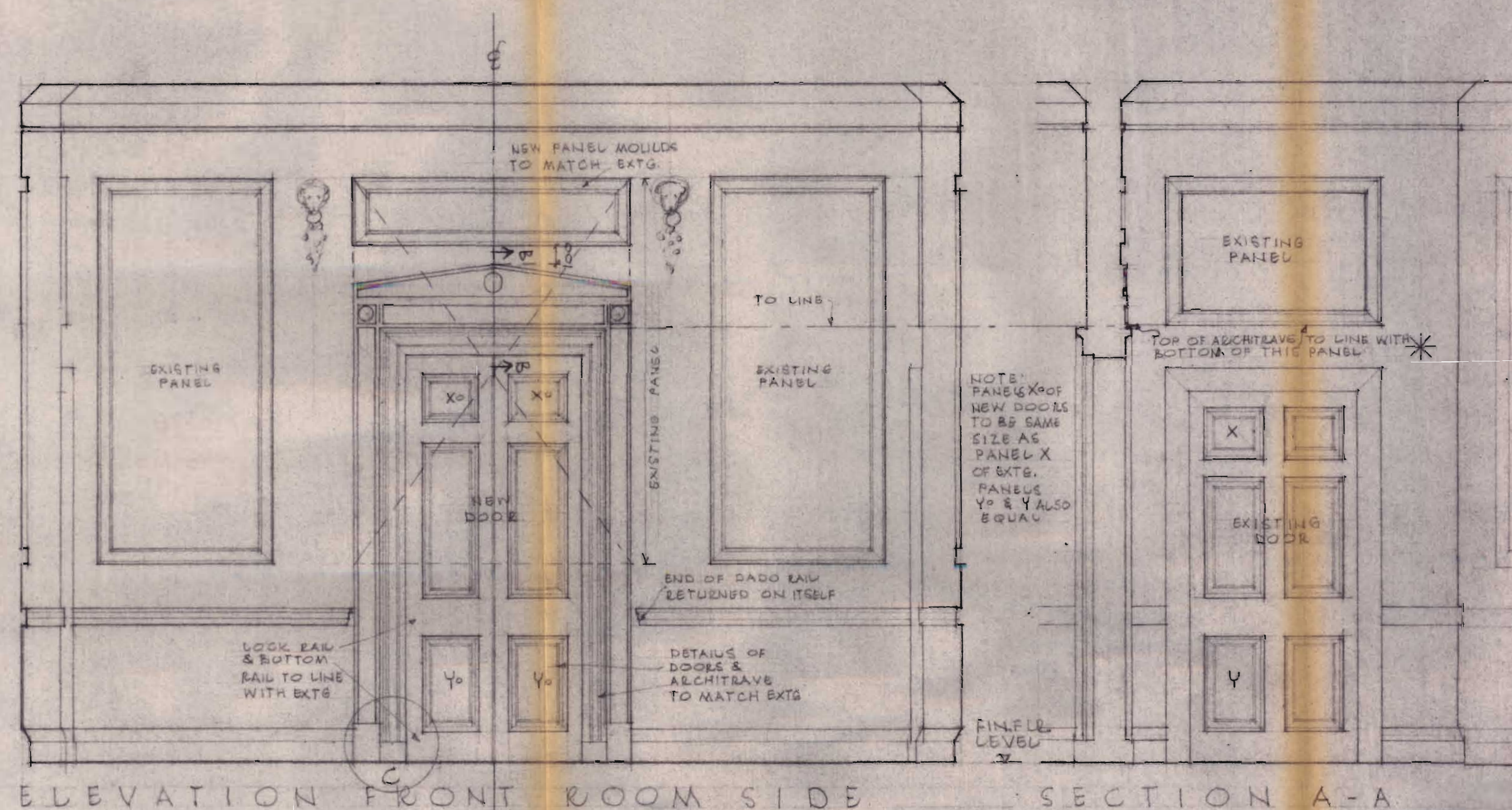

NOTES:

ALL IN SOFTWOOD PAINTED FINISH.

DIMENSIONS & PROFILES OF EXISTING MOULDINGS TO BE OBTAINED FROM THE SITE.

SEE ALSO DWG. N° 9004.21

FOR HEIGHT OF NEW DOORS SEE \* SECTION A-A

FULL SIZE SECTION B-B.

FRONT ROOM SIDE

HB9070140

LONDON BOROUGH OF CAMDEN  
PLANNING AND TRANSPORT  
DEPARTMENT  
10 SEP 1990  
RECEIVED

LONDON BOROUGH OF CAMDEN  
TOWN AND COUNTRY PLANNING  
26 OCT 1990  
PLANS APPROVED  
ON BEHALF OF THE COUNCIL

43 44 & 45 BEDFORD SQUARE  
LONDON WC1  
TENANTS OCCUPATION

EC&G

Ellis Clarke and Galpin  
1122 Portland Place, London, W1N 3D4  
Tel: 01-223 6566 Fax: 01-223 4653

Dwg. Title  
N° 44 GROUND FLOOR - NEW  
DOORS BETWEEN FRONT  
& REAR ROOMS

Date: 15.8.90 Scale: 1:20 Dwg. No. 9004.20



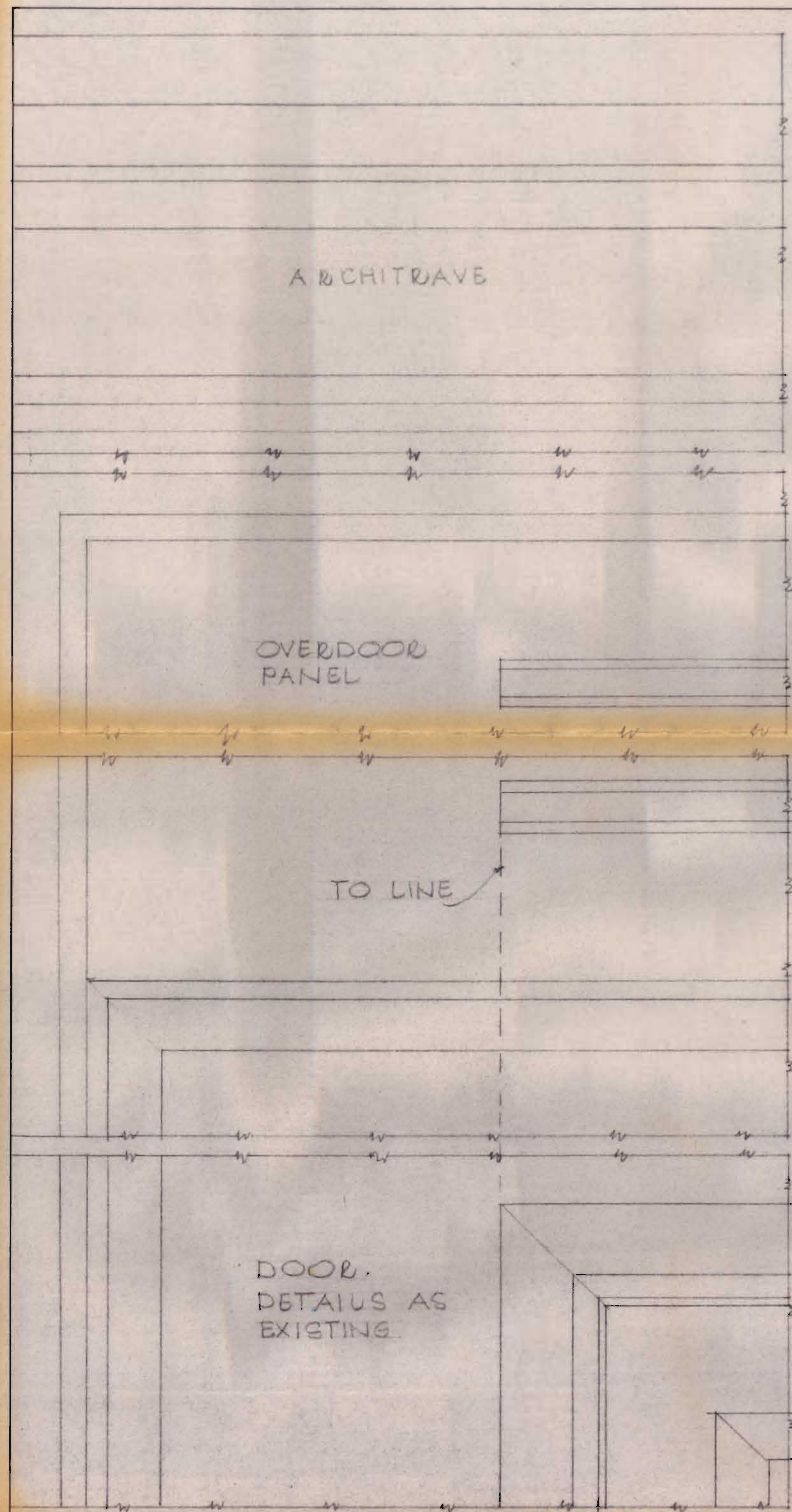

# FULL SIZE ELEVATION OF TOP OF DOOR ROOM G8 [N° 44 SIDE]

## NOTES:

ALL IN SOFTWOOD PAINTED FINISH.

COLOURS & FINISHES TO MATCH EXISTING.

FOR STRUCTURAL DETAILS & SPECIFICATION SEE ENGINEERS DWG. N° 8146/1.

PROFILES OF EXISTING MOULDINGS TO BE OBTAINED FROM THE SITE.

SEE ALSO DWGS N° 9004/15 & 18

ROOM G8  
N° 44

ROOM G7  
N° 45

DADO RAIL

FINGER GRIP

CENTRE PIVOT

FIBROUS PLASTER SURROUND

PLASTER

R.C LINTOL

SOFTWOOD LINTOL

HEAD

DOOR

SKIRTING

CENTRE PIVOT

CARPET

OAK THRESHOLD

## FULL SIZE SECTION

M 3070140

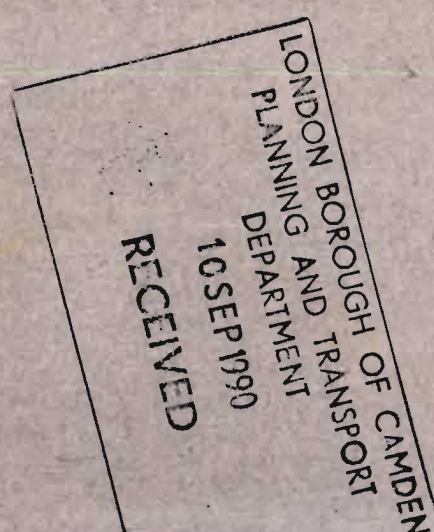
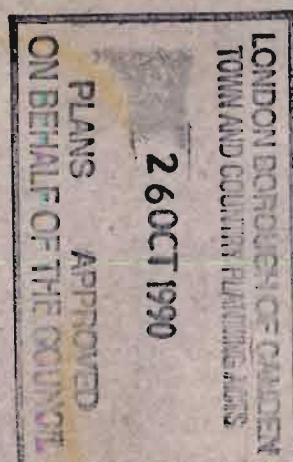

Job  
43 44 845 BEDFORD SQUARE  
LONDON  
TENANT OCCUPATION  
W.C.I.  
Dwg Title  
J18 DOOR IN PARTY WALL  
GROUND FLOOR N° 44 & 45  
Date  
8-8-90  
Scale  
Full Size  
Drawn by  
JG

EC&G  
82 Portland Place, London, W1N 3DH  
Tel: 01-323 6565  
Fax: 01-323 4655  
Dwg No  
9004-19



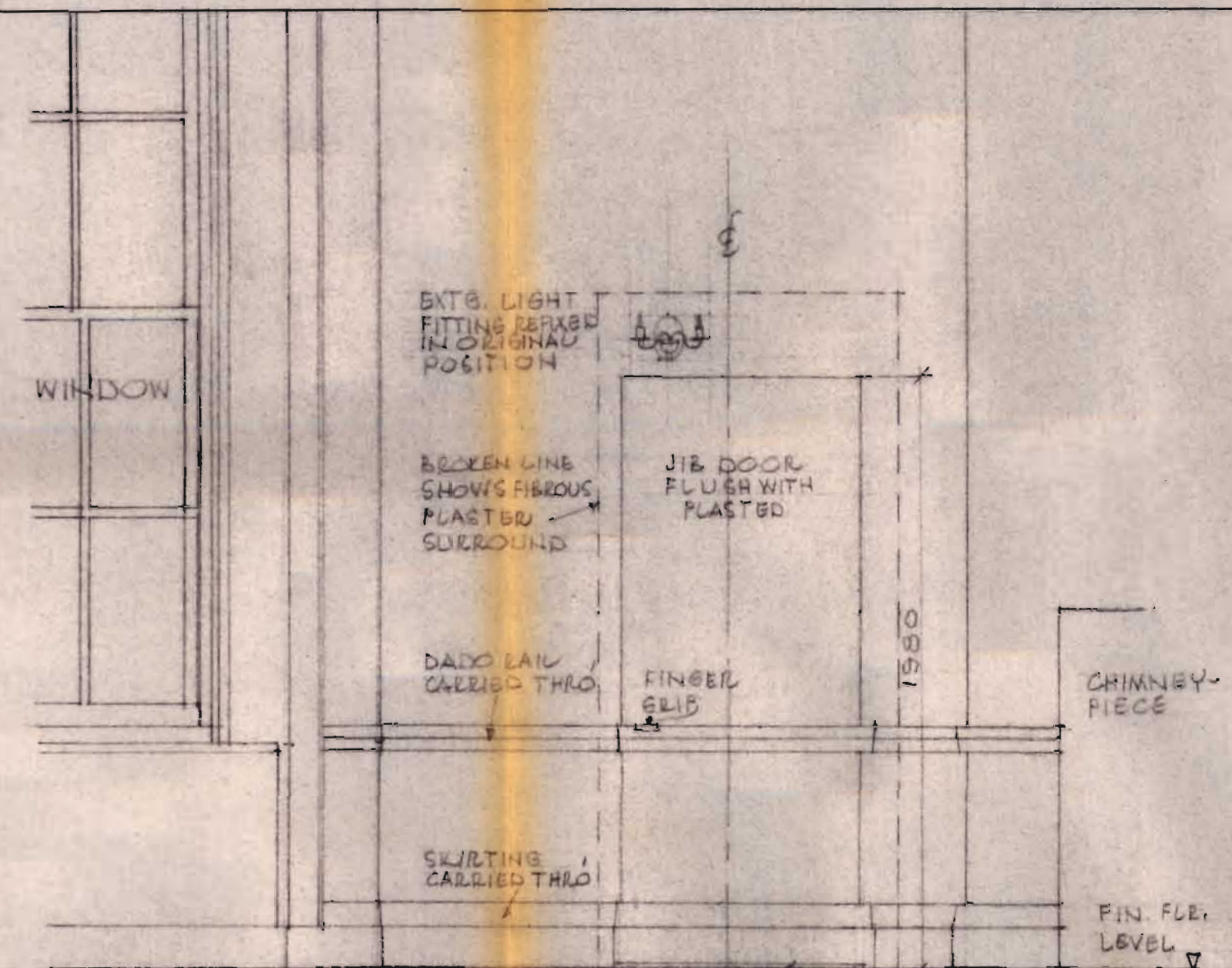

ELEVATION TO ROOM G7

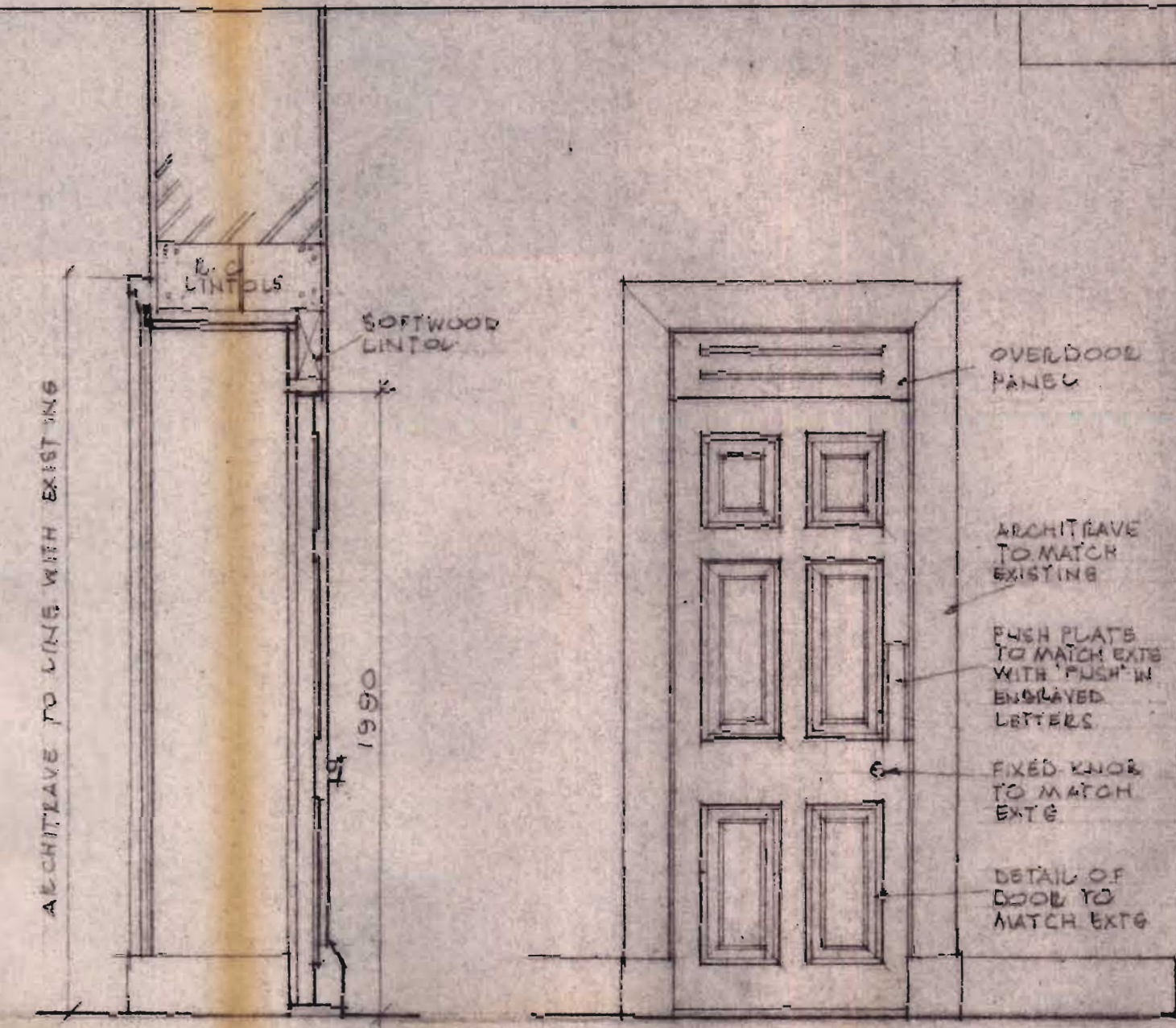

SECTION ELEVATION TO ROOM G8

NOTES:  
 ALL IN SOFTWOOD PAINTED FINISH.  
 COLOURS & FINISHES TO MATCH EXISTING.  
 FOR STRUCTURAL DETAILS & SPECIFICATION SEE ENGINEERS DWG. N° 846/1.  
 PROFILES OF EXISTING MOULDINGS TO BE OBTAINED FROM THE SITE.  
 SEE ALSO DWGS. N° 9004/15 & 19

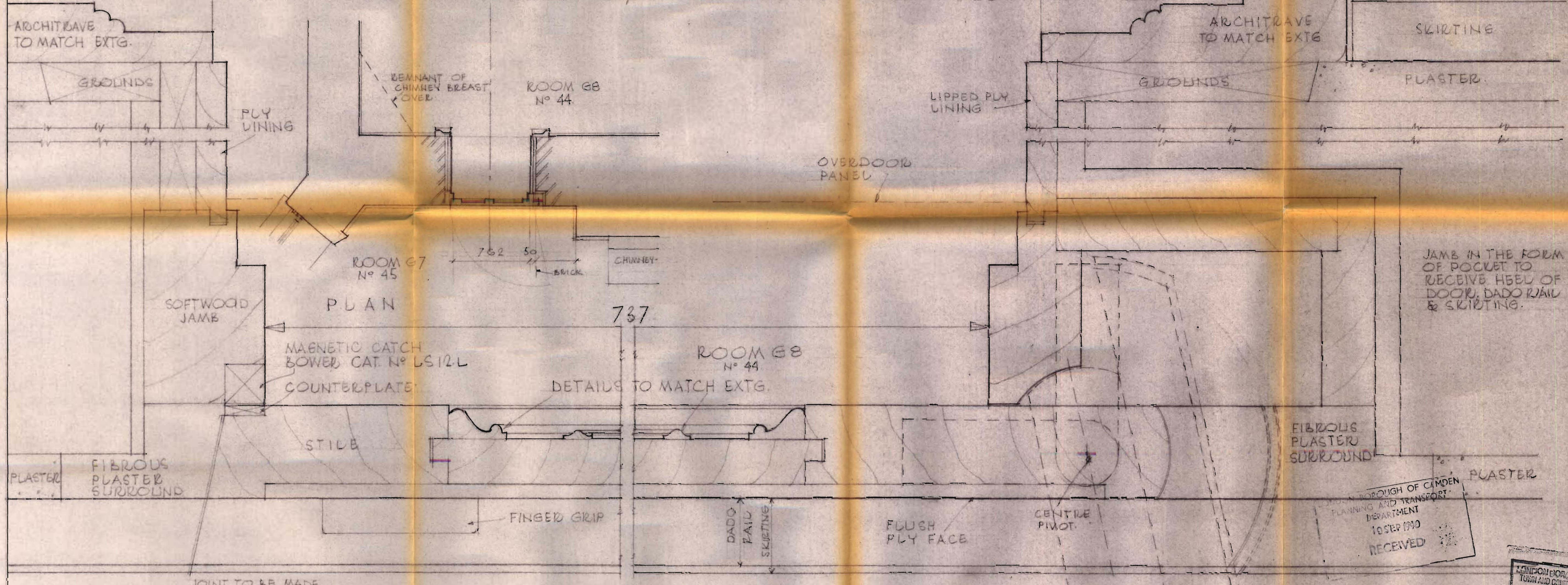

FULL SIZE PLAN.

LONDON BOROUGH OF CAMDEN  
 PLANNING AND TRANSPORT  
 DEPARTMENT  
 10 SEP 1990  
 RECEIVED

LONDON BOROUGH OF CAMDEN  
 TOWN AND COUNTRY PLANNING ACT  
 26 OCT 1990  
 PLANS  
 SUBMITTED

Job  
 43 44 & 45 BEDFORD SQUARE  
 LONDON WOI  
 TENANTS OCCUPATION

**EC&G**  
 Chartered Architects

Dwg. Title  
 JIB DOOR IN PARTY WALL  
 GROUND FLOOR N° 44 & 45

Ellis Clarke and Gallanaugh  
 82a Portland Place, London, W1N 3QH  
 Tel: 01-323 6566 Fax: 01-323 4653

Date 8.3.90 Scale 1:20 & PS Drawn by JG

Dwg. No.  
 9004-18



ARCHITRAVE

OVERDOOR  
PANEL

TO LINE

DOOR.  
DETAILS AS  
EXISTING

FULL SIZE ELEVATION  
OF TOP OF DOOR.  
ROOM 16 [N° 44 SIDE]

ROOM 16  
N° 44

NOTES:

ALL IN SOFTWOOD PAINTED  
FINISH.

COLOURS & FINISHES TO MATCH  
EXISTING.

FOR STRUCTURAL DETAILS &  
SPECIFICATION SEE ENGINEERS  
DWG. N° 8146/1.

PROFILES OF EXISTING MOULDINGS  
TO BE OBTAINED FROM THE SITE.

SEE ALSO DWGS. N° 9004/15 & 16

ARCHITRAVE  
TO MATCH EXISTING

TOP OF  
ARCHITRAVE  
TO LINE WITH  
EXISTING

SCULPTURE

B.C. LINTOL

PLASTER

SOFTWOOD  
LINTOL

OVERDOOR  
PANEL

FIBROUS PLASTER  
SUBROUND

HEAD

CENTRE  
PIVOT

DOOR

FINGER  
GRIP

ROOM 15  
N° 45

DADO  
RAIL

SKIRTING

CENTRE  
PIVOT

CARPET

OAK THRESHOLD

FULL SIZE  
SECTION

H B9070140

LONDON BOROUGH OF CAMDEN  
PLANNING AND TRANSPORT  
DEPARTMENT  
10 SEPTEMBER  
RECEIVED

LONDON BOROUGH OF CAMDEN  
PLANNING AND TRANSPORT  
DEPARTMENT  
26 OCT 1990  
APPROVED  
ON BEHALF OF THE COUNCIL

Job  
48 44 & 45 BEDFORD SQUARE  
LONDON  
TENANTS OCCUPATION  
J16 DOOR IN PARTY WALL  
N° 44 & 45 FIRST FLOOR  
Date  
8.1.90  
Scale  
Full size  
Drawn by  
J16  
26 OCT 1990  
E.C. & G.  
822 Bedford Place, London, W1N 9DH  
Tel: 01-223 0666  
Fax: 01-223 4053



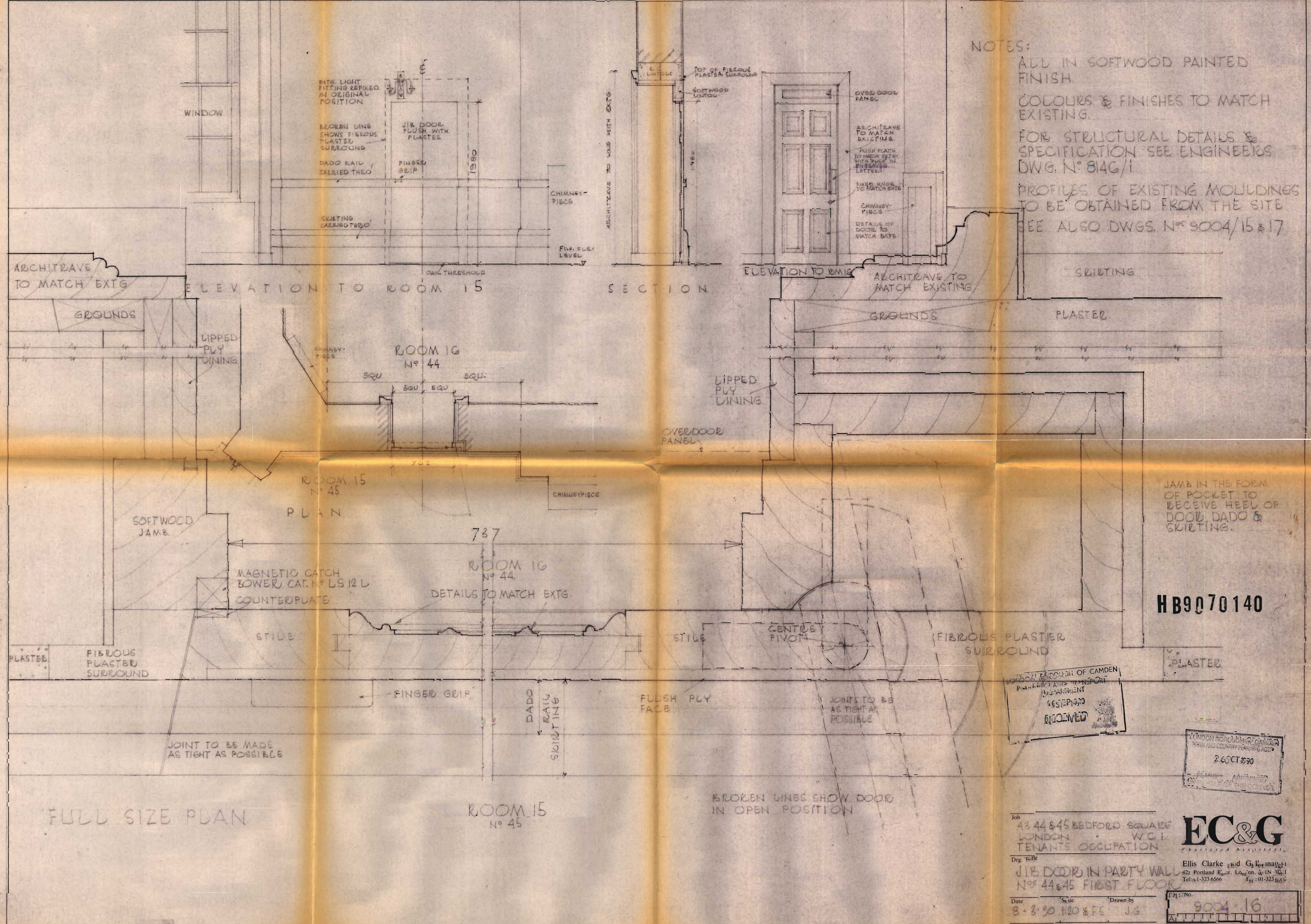

NOTES:  
ALL IN SOFTWOOD PAINTED FINISH.  
COLOURS & FINISHES TO MATCH EXISTING.  
FOR STRUCTURAL DETAILS & SPECIFICATION SEE ENGINEERS DWG. N° 814G/1.  
PROFILES OF EXISTING MOULDINGS TO BE OBTAINED FROM THE SITE  
SEE ALSO DWGS. N° 9004/15 & 17

JAMB IN THE FORM OF POCKET TO RECEIVE HEEL OF DOOR, DADO & SKIRTING.

HB9070140

LONDON BOROUGH OF CAMDEN  
PLANNING AND TRANSPORT  
DEPARTMENT  
16 SEP 1990  
RECEIVED

LONDON BOROUGH OF CAMDEN  
PLANNING AND TRANSPORT  
DEPARTMENT  
26 OCT 1990  
APPROVED  
FOR THE COUNCIL

Job  
43 44 & 45 BEDFORD SQUARE  
LONDON W.C.1  
TENANTS OCCUPATION

EC&G  
Chartered Architects

Ellis Clarke and G. L. Marshall  
822 Portland Road, London W.1N 3B, 1  
Tel: 01-323 6566 Fax: 01-323 6653

Plg. No.  
9004-16

Date  
8-3-90

Scale  
1:20 & 1:5

Drawn by  
J.G.