

1. This drawing is a technical drawing and is not to be construed as a contract. Any discrepancy shall be resolved by the architect. The contractor is responsible for ensuring that the work is carried out in accordance with the contract and the relevant building regulations. The contractor is also responsible for ensuring that the work is carried out in a safe and sound manner. The architect is not responsible for any damage or loss of any kind resulting from the execution of the work.

2. The contractor shall be responsible for ensuring that the work is carried out in accordance with the contract and the relevant building regulations. The contractor is also responsible for ensuring that the work is carried out in a safe and sound manner. The architect is not responsible for any damage or loss of any kind resulting from the execution of the work.

3. The contractor shall be responsible for ensuring that the work is carried out in accordance with the contract and the relevant building regulations. The contractor is also responsible for ensuring that the work is carried out in a safe and sound manner. The architect is not responsible for any damage or loss of any kind resulting from the execution of the work.

4. The contractor shall be responsible for ensuring that the work is carried out in accordance with the contract and the relevant building regulations. The contractor is also responsible for ensuring that the work is carried out in a safe and sound manner. The architect is not responsible for any damage or loss of any kind resulting from the execution of the work.

5. The contractor shall be responsible for ensuring that the work is carried out in accordance with the contract and the relevant building regulations. The contractor is also responsible for ensuring that the work is carried out in a safe and sound manner. The architect is not responsible for any damage or loss of any kind resulting from the execution of the work.

6. The contractor shall be responsible for ensuring that the work is carried out in accordance with the contract and the relevant building regulations. The contractor is also responsible for ensuring that the work is carried out in a safe and sound manner. The architect is not responsible for any damage or loss of any kind resulting from the execution of the work.

7. The contractor shall be responsible for ensuring that the work is carried out in accordance with the contract and the relevant building regulations. The contractor is also responsible for ensuring that the work is carried out in a safe and sound manner. The architect is not responsible for any damage or loss of any kind resulting from the execution of the work.

8. The contractor shall be responsible for ensuring that the work is carried out in accordance with the contract and the relevant building regulations. The contractor is also responsible for ensuring that the work is carried out in a safe and sound manner. The architect is not responsible for any damage or loss of any kind resulting from the execution of the work.

9. The contractor shall be responsible for ensuring that the work is carried out in accordance with the contract and the relevant building regulations. The contractor is also responsible for ensuring that the work is carried out in a safe and sound manner. The architect is not responsible for any damage or loss of any kind resulting from the execution of the work.

10. The contractor shall be responsible for ensuring that the work is carried out in accordance with the contract and the relevant building regulations. The contractor is also responsible for ensuring that the work is carried out in a safe and sound manner. The architect is not responsible for any damage or loss of any kind resulting from the execution of the work.

REVISION NOTES:

1. 2020.10.14

2. 2020.10.14

3. 2020.10.14

4. 2020.10.14

5. 2020.10.14

6. 2020.10.14

7. 2020.10.14

8. 2020.10.14

9. 2020.10.14

10. 2020.10.14

11. 2020.10.14

12. 2020.10.14

13. 2020.10.14

14. 2020.10.14

15. 2020.10.14

16. 2020.10.14

17. 2020.10.14

18. 2020.10.14

19. 2020.10.14

20. 2020.10.14

21. 2020.10.14

22. 2020.10.14

23. 2020.10.14

24. 2020.10.14

25. 2020.10.14

26. 2020.10.14

27. 2020.10.14

28. 2020.10.14

29. 2020.10.14

30. 2020.10.14

31. 2020.10.14

32. 2020.10.14

33. 2020.10.14

34. 2020.10.14

35. 2020.10.14

36. 2020.10.14

37. 2020.10.14

38. 2020.10.14

39. 2020.10.14

40. 2020.10.14

41. 2020.10.14

42. 2020.10.14

Shop Stallriser Section - 1:5 @ A1

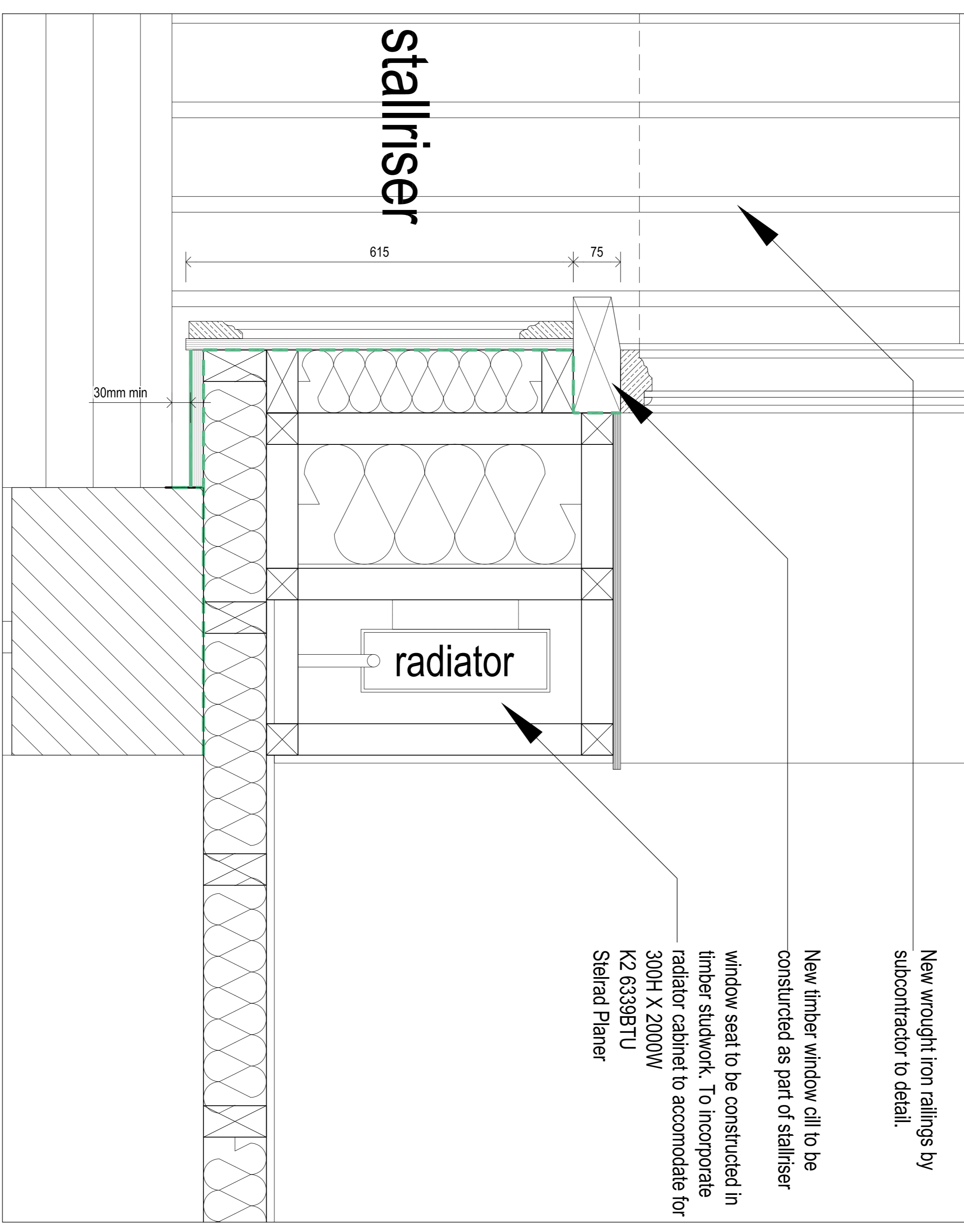

New wrought iron railings by subcontractor to detail.

New timber window cill to be constructed as part of stallriser

Window seat to be constructed in timber studwork. To incorporate radiator cabinet to accommodate for 300H X 2000W K2 6339BTU Stelrad Planer

Lead flashing to cover timber coping. Lead to be have minimum 75mm upstand and rolled into brickwork.

100mm X 50mm timber stud to make up shopfront fascia. Must be in line with stallriser. All dimensions to be checked on site.

timber coping to be sourced with similar if not same profile as shown. Proportions must be kept correct.

**fascia**

Shopfront by sub contractor to be constructed after fascia, stallriser and surrounds are in place.

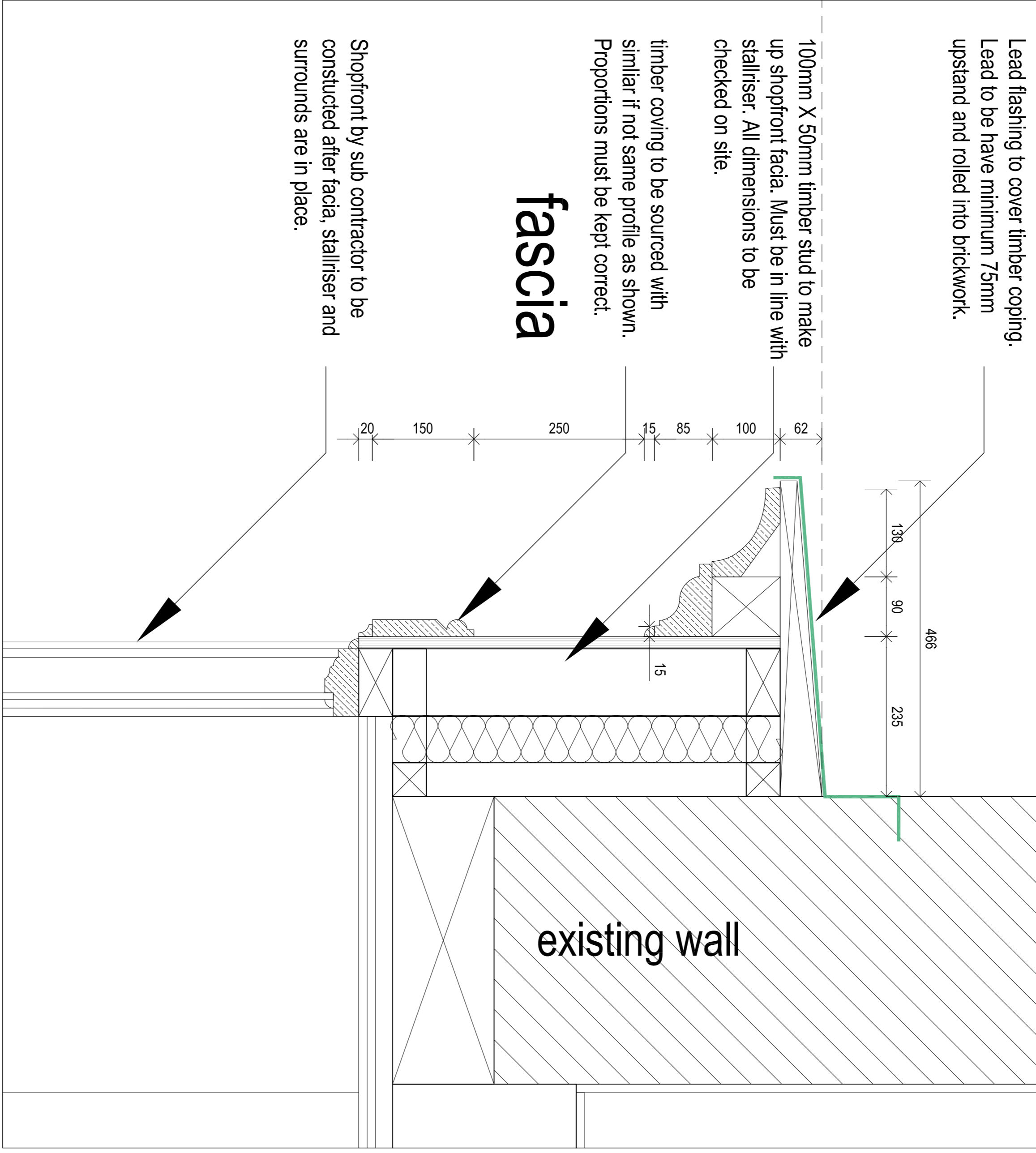

Shop Fascia Section - 1:5 @ A1

PLANNING

client: Mr & Mrs Rowe Parr

project: 108 St. Pancras Way

title: Shopfront Fada Stallriser

scale: 1:5 @ A1

drawn by: WL

start date: October 2014

checked by: JRP

drawing number: SPW\_797\_243

revision no: P2

JRP

797

JOHN ROWE - PARR

A R C H I T E C T S

101 Red Lion Square, London, EC1M 6RT

Tel: +44 (0)20 7799 3333

Fax: +44 (0)20 7799 3334

www.johnrowe-parr.co.uk