

1 Ground Floor - Escape Stairs Plan
1 : 20

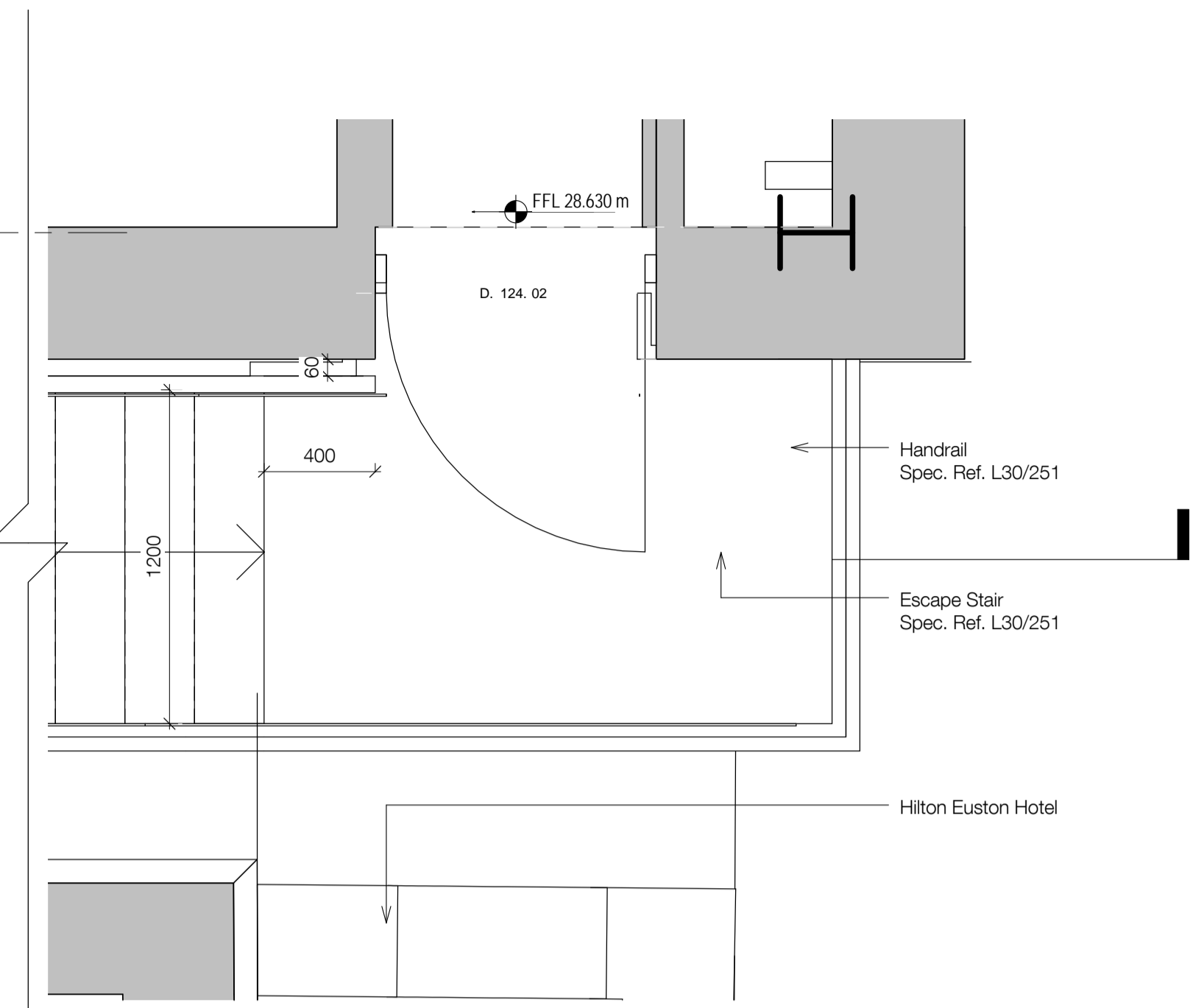

2 First Floor - Escape stairs Plan
1 : 20

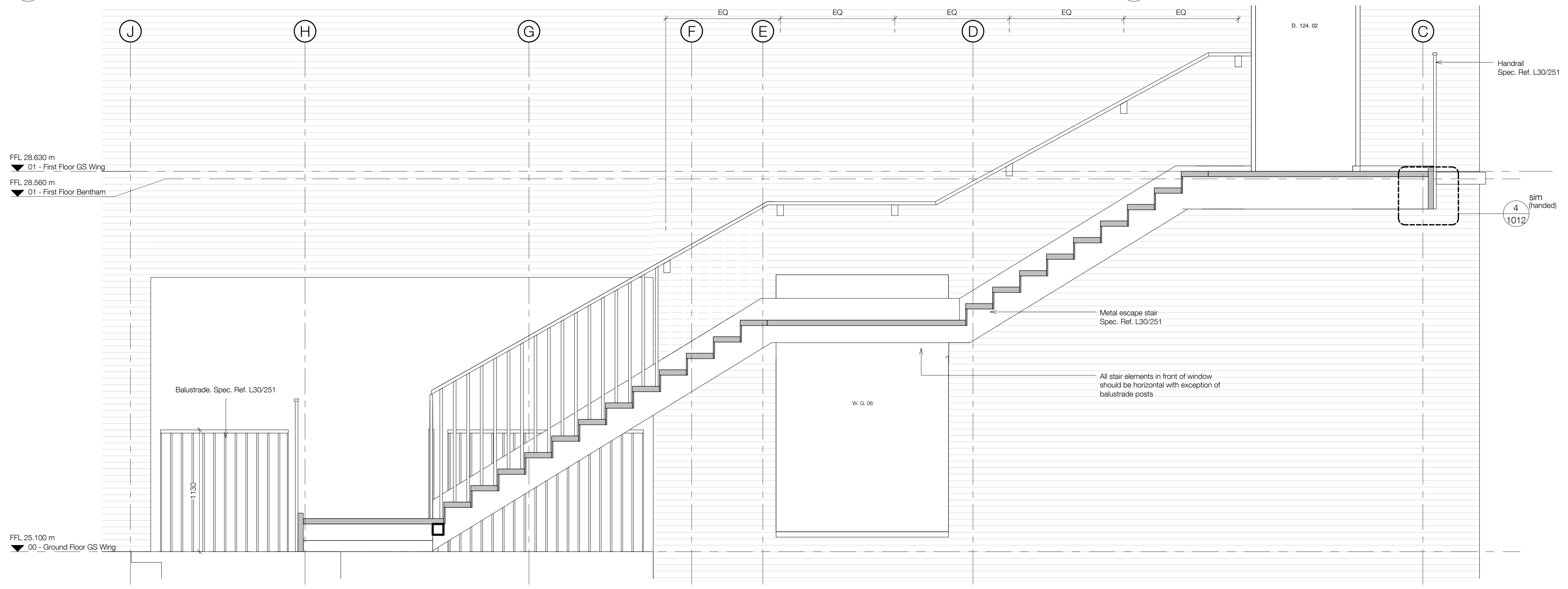

3 First Floor - Escape stair section
1 : 20

UCL LAWS Bentham House

standard notes

1. Do not scale this drawing.
2. All dimensions must be checked on site and any discrepancies verified with the architect.
3. Unless shown otherwise, all dimensions are to structural surfaces.

THIS IS NOT A CONSTRUCTION DRAWING. IT IS UNSUITABLE FOR THE PURPOSE OF CONSTRUCTION AND MUST ON NO ACCOUNT BE USED AS SUCH.

drawing notes

DESIGN INTENT: These are design intent drawings and do not show full construction information. The Contractor must develop the details, without changing the visual, spatial or other performances, to provide a fully developed scheme including all concealed components such as wind posts, vapour barriers and cavity barriers. All dimensions on this drawing are taken to finished surfaces unless specifically indicated on the dimensions itself.

KEY: Existing building (assumed)
 Proposed building

Stairs location is dependant on Plant Layout
Refer to Spec. Ref. L30/251

revisions

P1	27.02.15	Issued for Pre-Tender Estimate
T1	25.03.15	Issued for Tender
P2	31.03.15	Planning Conditions Issue

date	11/19/14	client	UCL
scale	As indicated	drawing	External Escape Stairs
drawn	AF	checked	TG
drawing number	3000 · A · 1017	rev	P2

C:\Revit Local\Project Path\3000_UCL Laws_CENTRAL_jonathan.mann.rvt

Levitt Bernstein
 1 Kingsland Passage
 London
 E8 2BB

t: 020 7275 7676
 f: 020 7275 9348
 w: levittbernstein.co.uk
 e: post@levittbernstein.co.uk

Levitt Bernstein