

1 Side wall at new roof
1 : 10

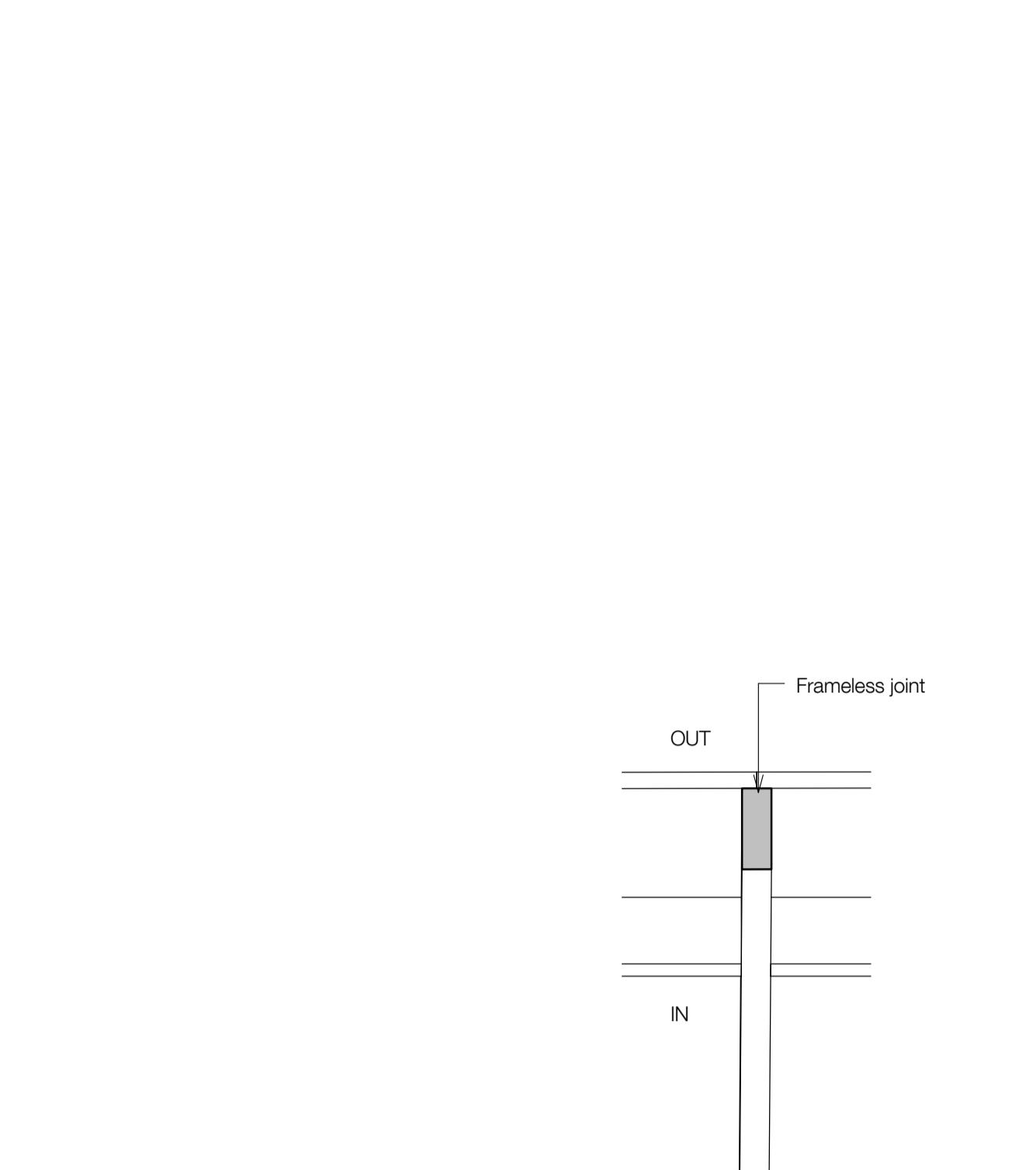

3 Side wall at Bentham House
1 : 10

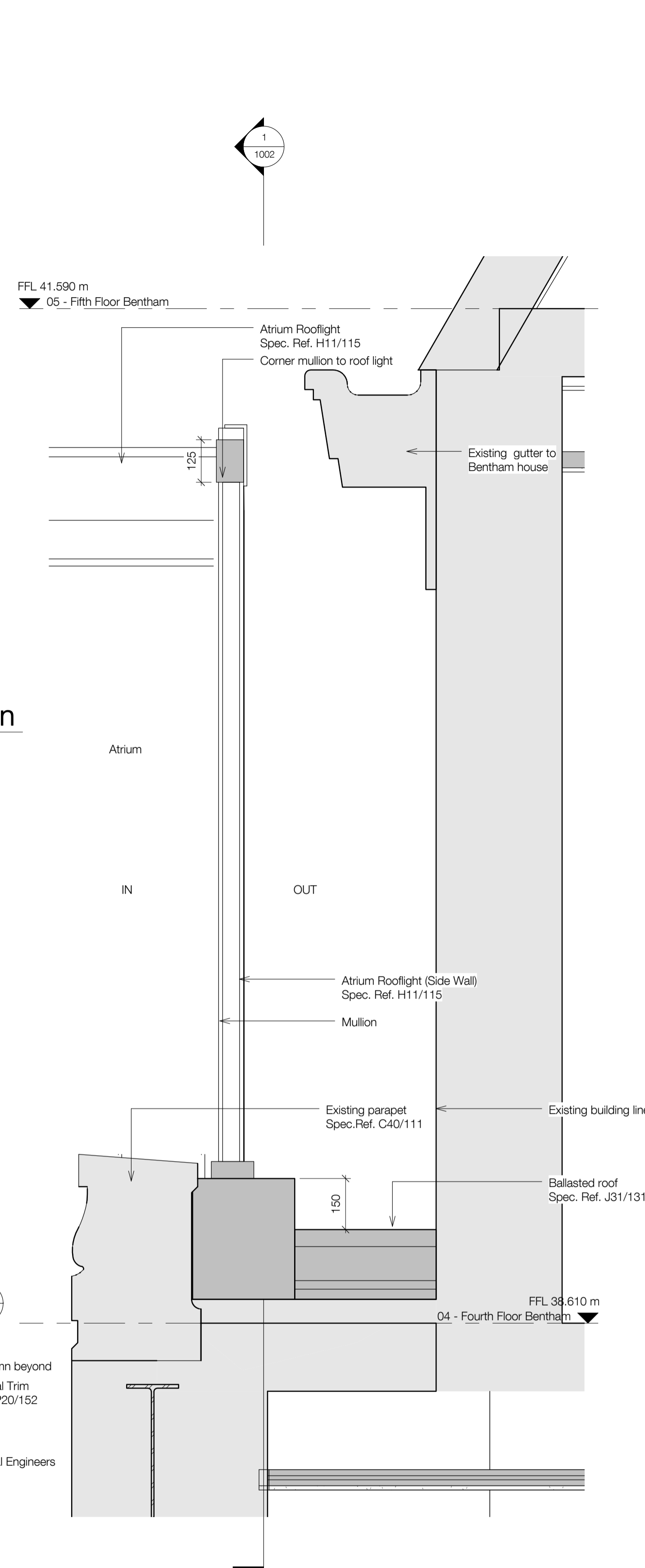

2 Atrium rooflight - Typical mullion
1 : 10

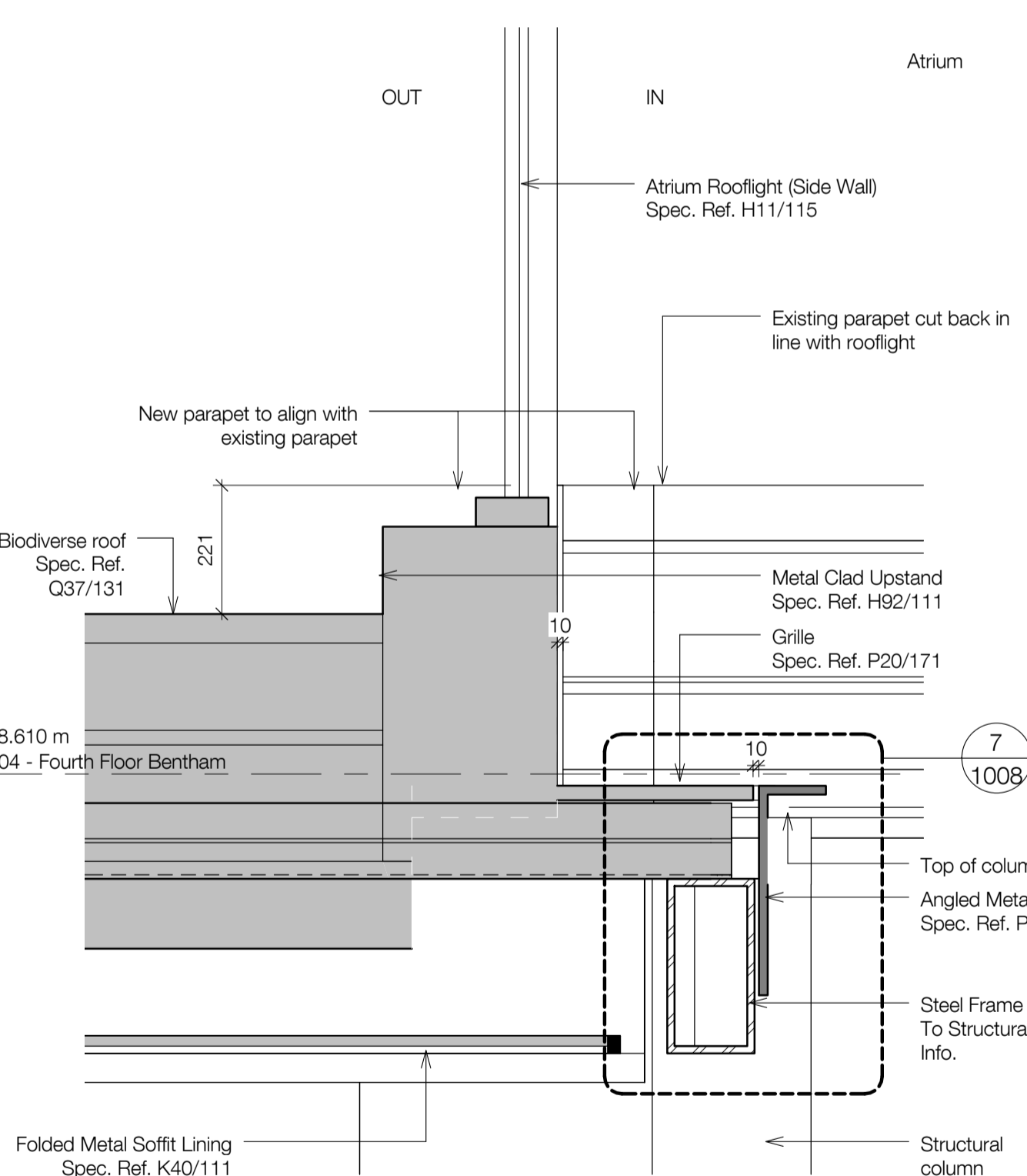

4 Atrium rooflight - Top detail
1 : 10

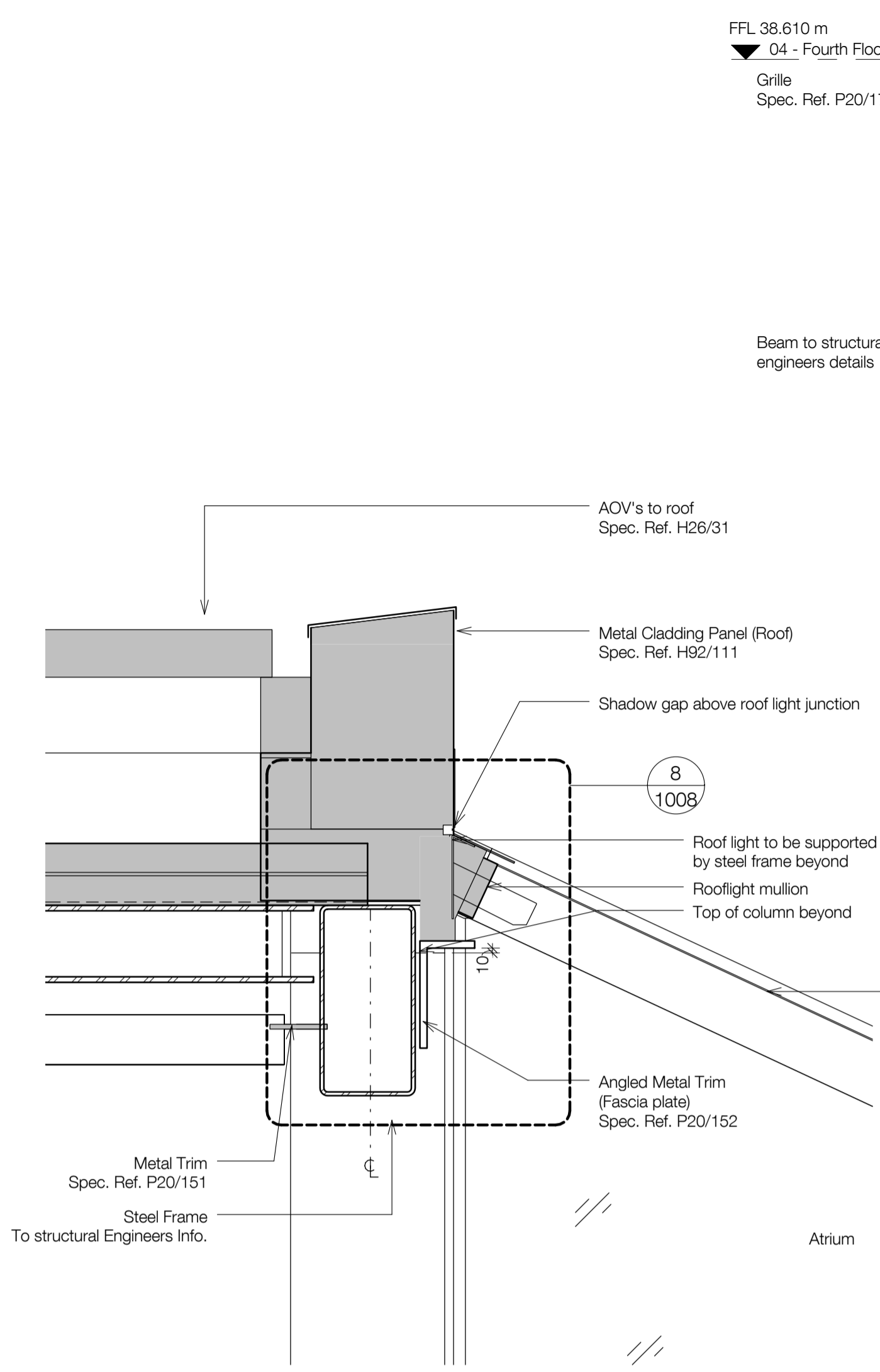

5 Atrium rooflight - Mid rail detail
1 : 10

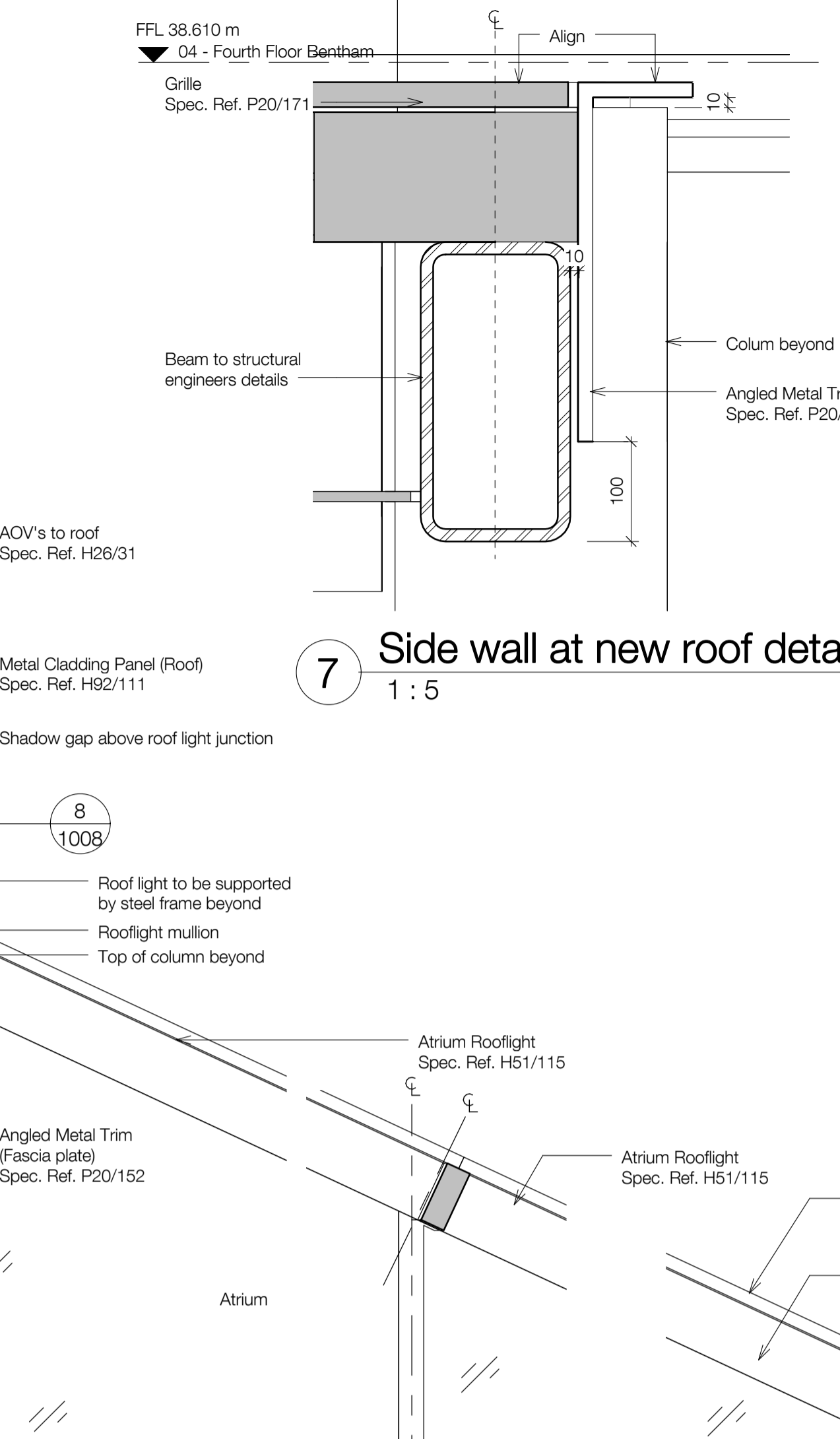

6 Atrium rooflight - parapet at base of slope
1 : 10

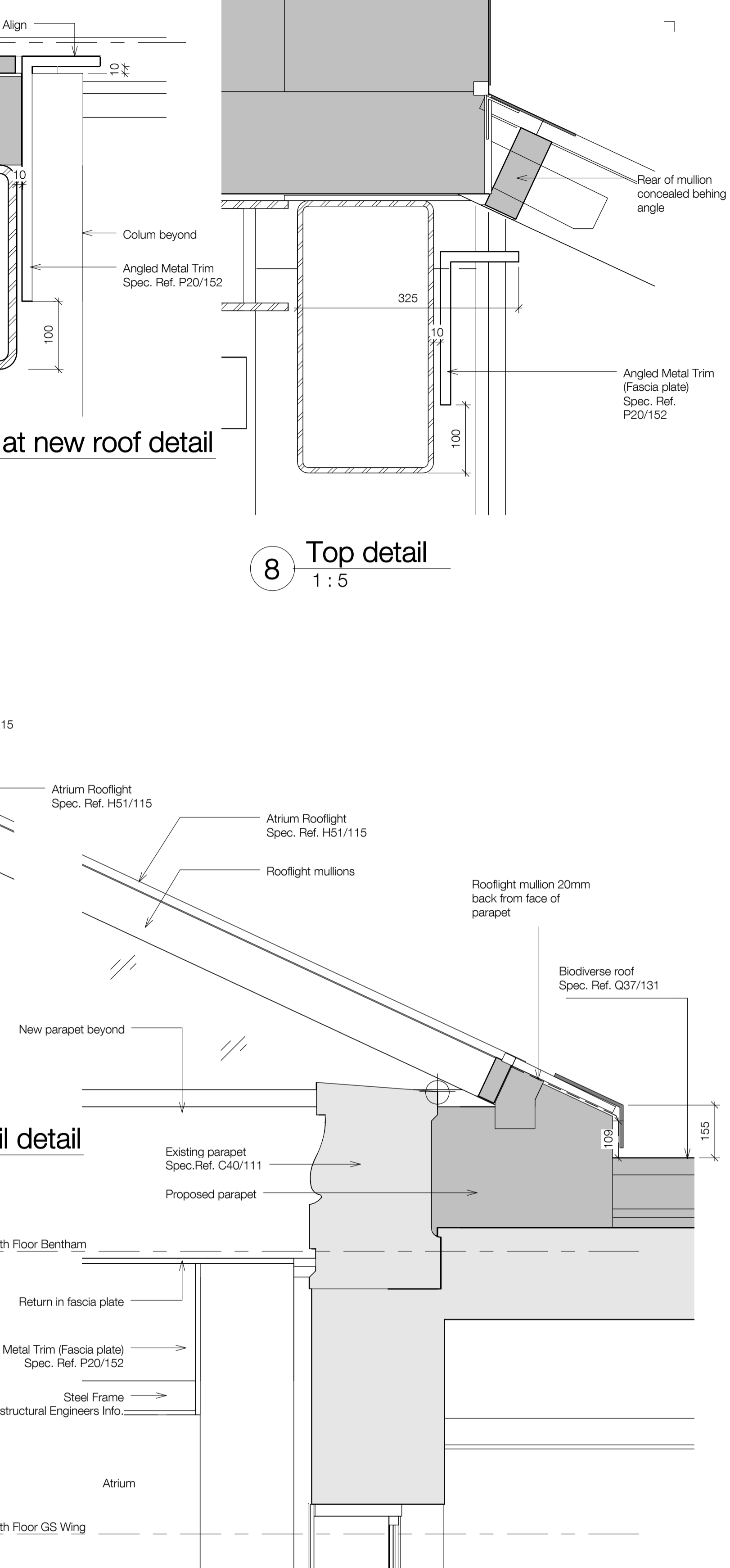

7 Side wall at new roof detail
1 : 5

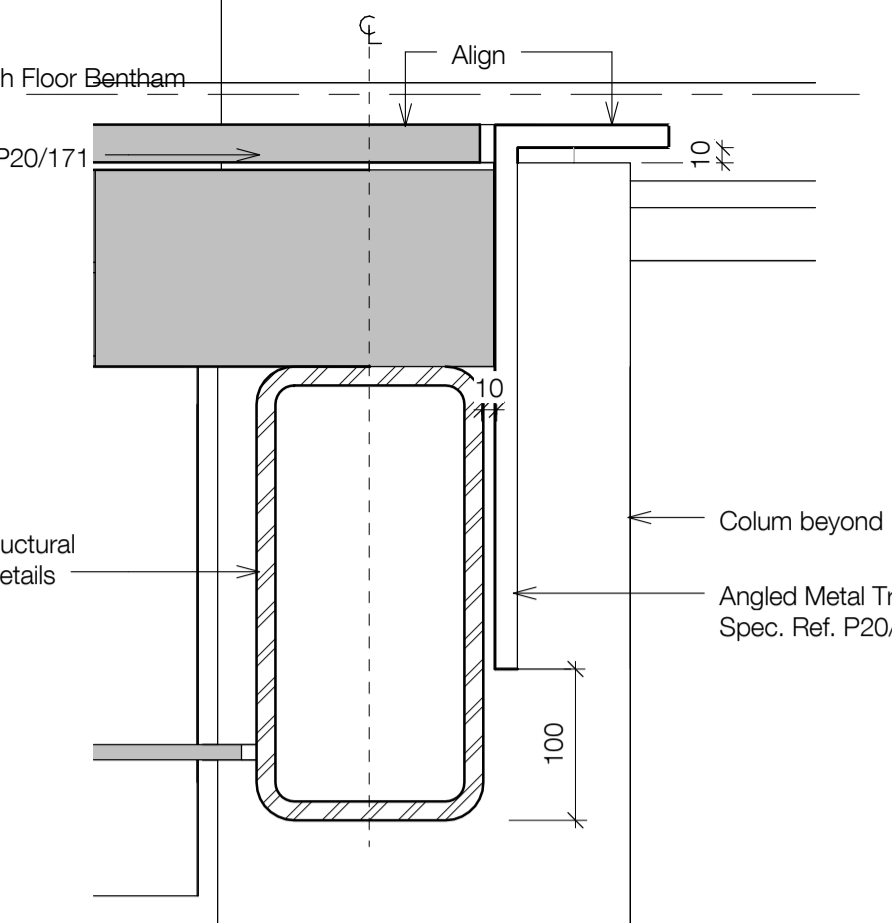

8 Top detail
1 : 5

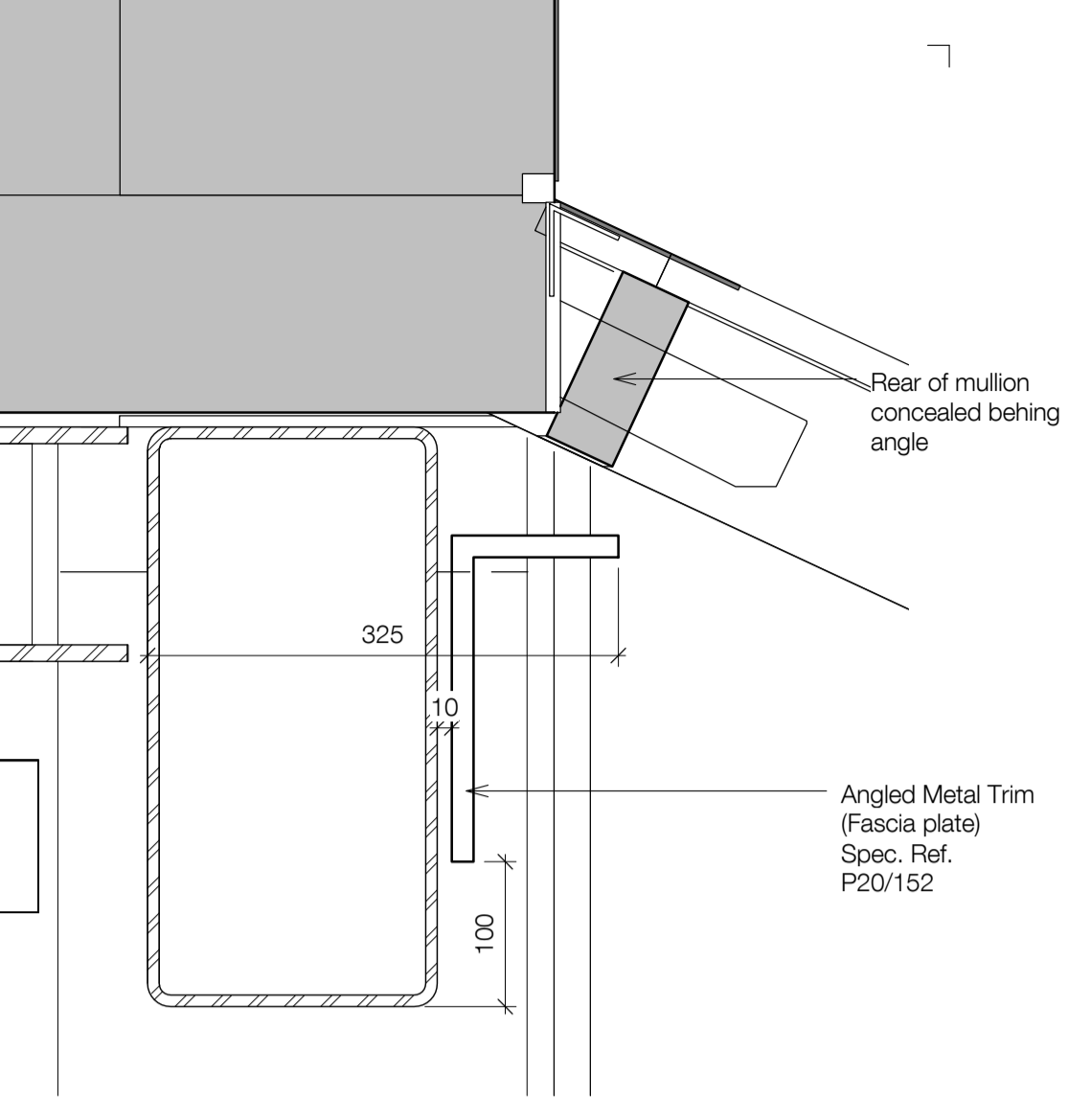

standard notes

1. Do not scale this drawing.
2. All dimensions must be checked on site and any discrepancies verified with the architect.
3. Unless shown otherwise, all dimensions are to structural surfaces.

THIS IS NOT A CONSTRUCTION DRAWING. IT IS UNSUITABLE FOR THE PURPOSE OF CONSTRUCTION AND MUST ON NO ACCOUNT BE USED AS SUCH.

drawing notes

DESIGN INTENT: These are design intent drawings and do not show full construction information. The Contractor must develop the details, without changing the visual, spatial or other performances, to provide a fully developed scheme including all concealed components such as wind posts, vapour barriers and cavity barriers. All dimensions on this drawing are taken to finished surfaces unless specifically indicated on the dimensions itself.

KEY: Existing building (assumed)
 Proposed building

revisions		
P1	27.02.15	Issued for Pre-Tender Estimate
T1	25.03.15	Issued for Tender
P2	31.03.15	Planning Conditions Issue

UCL LAWS

Bentham House

date 06.08.14	client UCL	Levitt Bernstein 1 Kingsland Passage London E8 2BB
scale As indicated	drawing Roof Light at atrium head	t: 020 7275 7676 f: 020 7275 9348 w: levittberstein.co.uk e: post@levittberstein.co.uk
drawn AF	checked TG	drawing number 3000-A-1008
		rev P2

C:\Revit Local\Project Path\3000_UCL Laws_CENTRAL_jonathan.mann.rvt