

1 Office Window - Plan Detail  
1 : 10

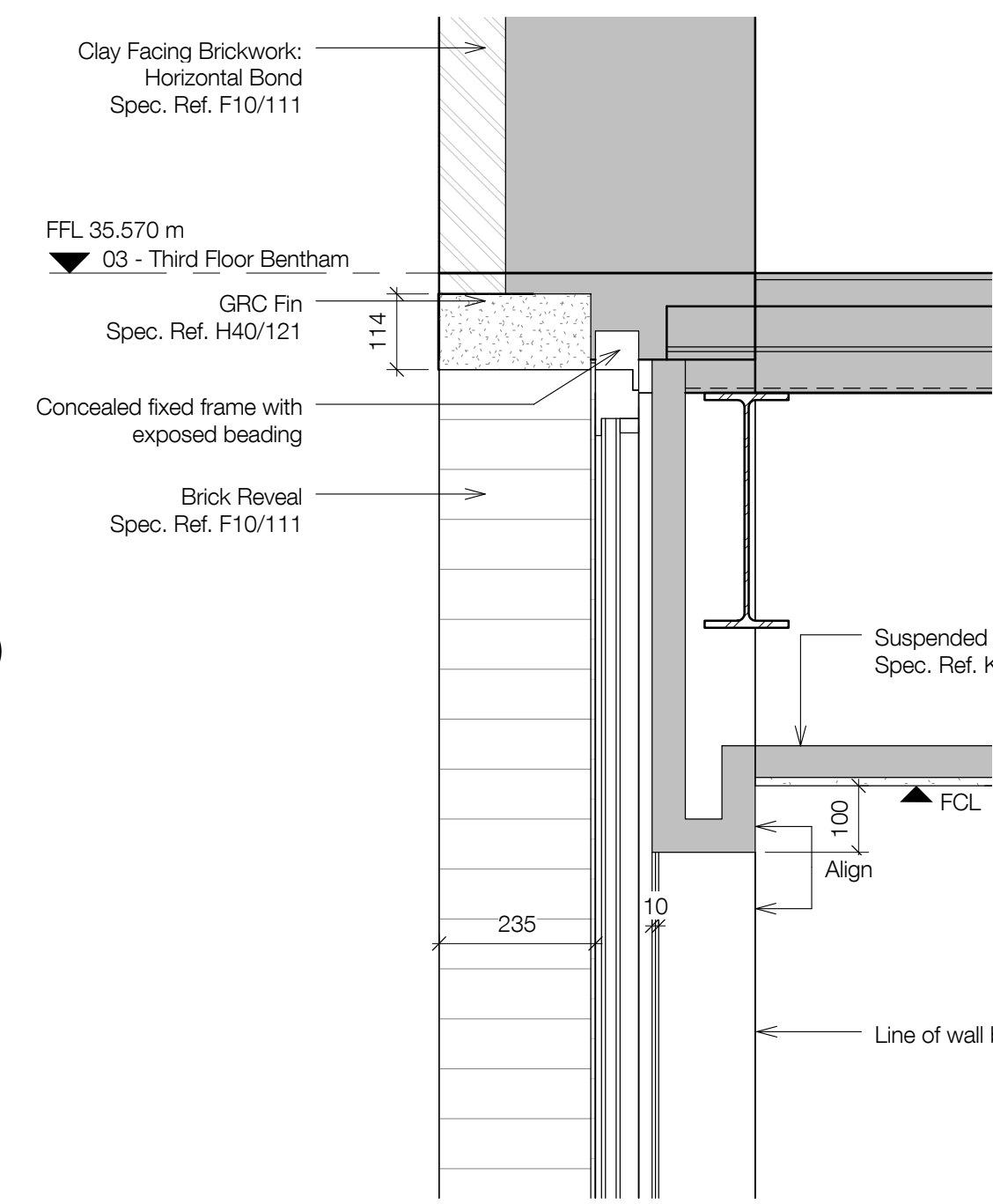

3 Window Type D2 - Head Detail  
1 : 10

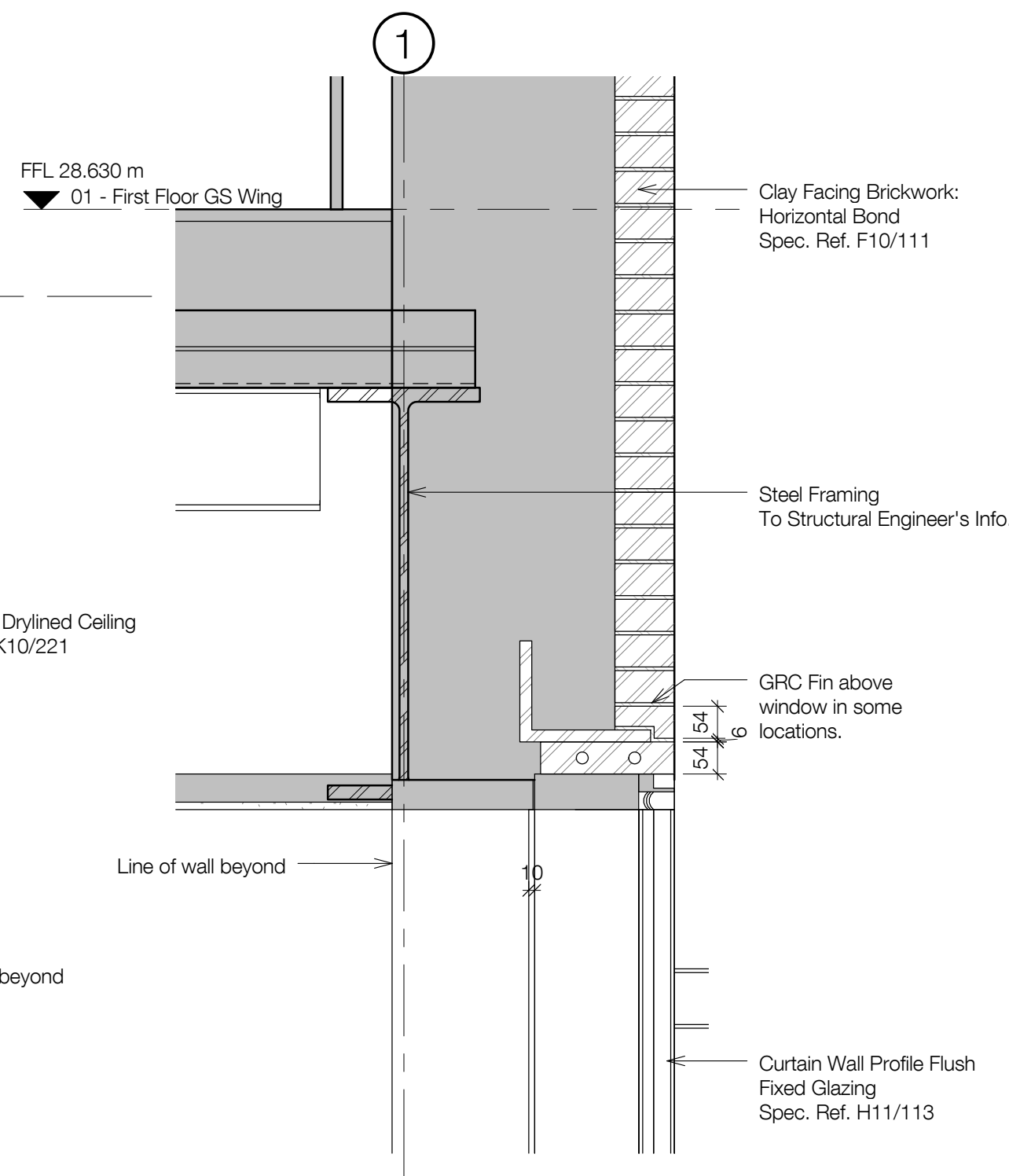

5 Window Type E1 - Head Detail  
1 : 10

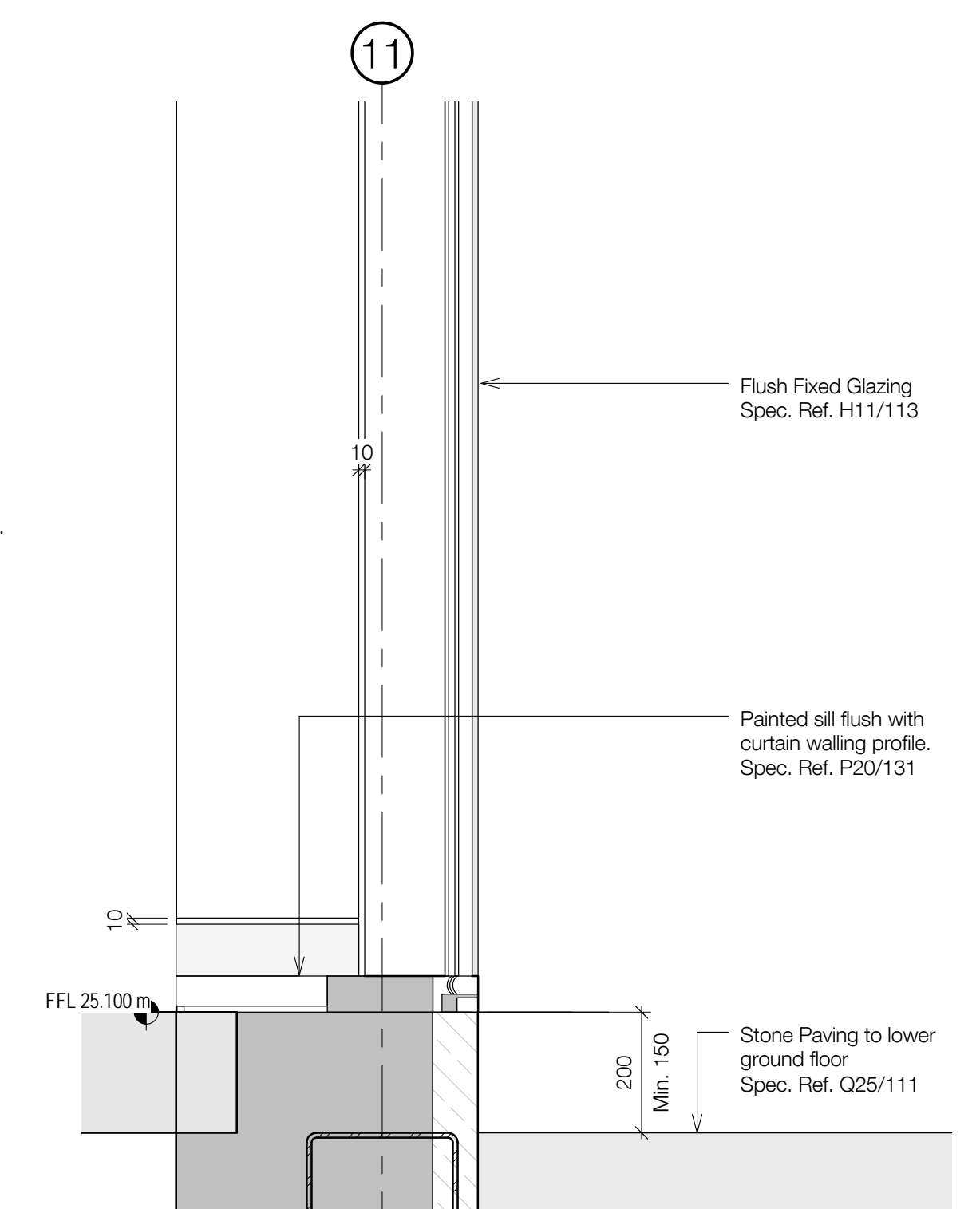

7 Lightwell - Sill Detail  
1 : 10

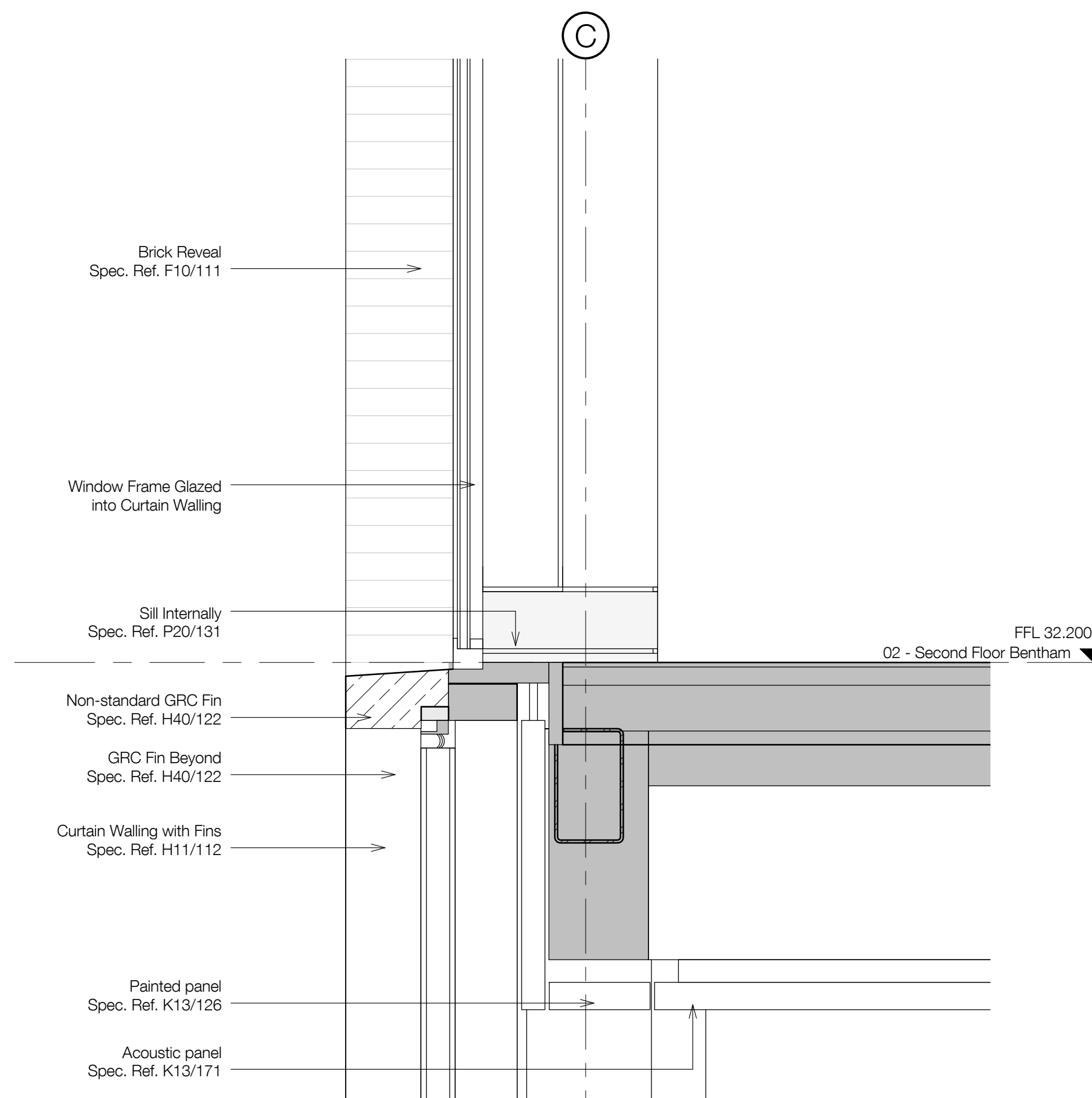

2 Window Type D1 - Sill Detail  
1 : 10

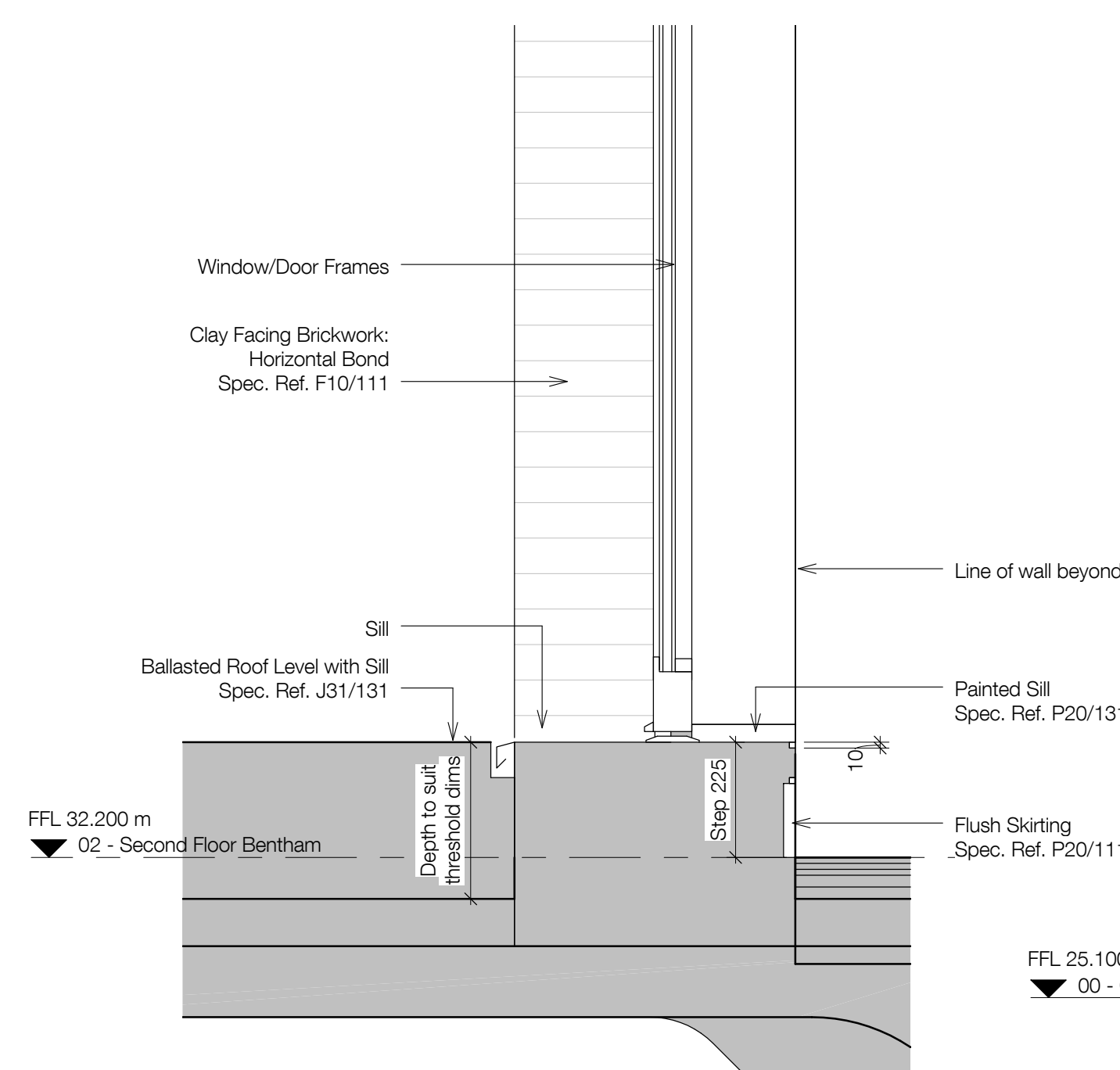

4 Window Type D2 - Sill Detail  
1 : 10

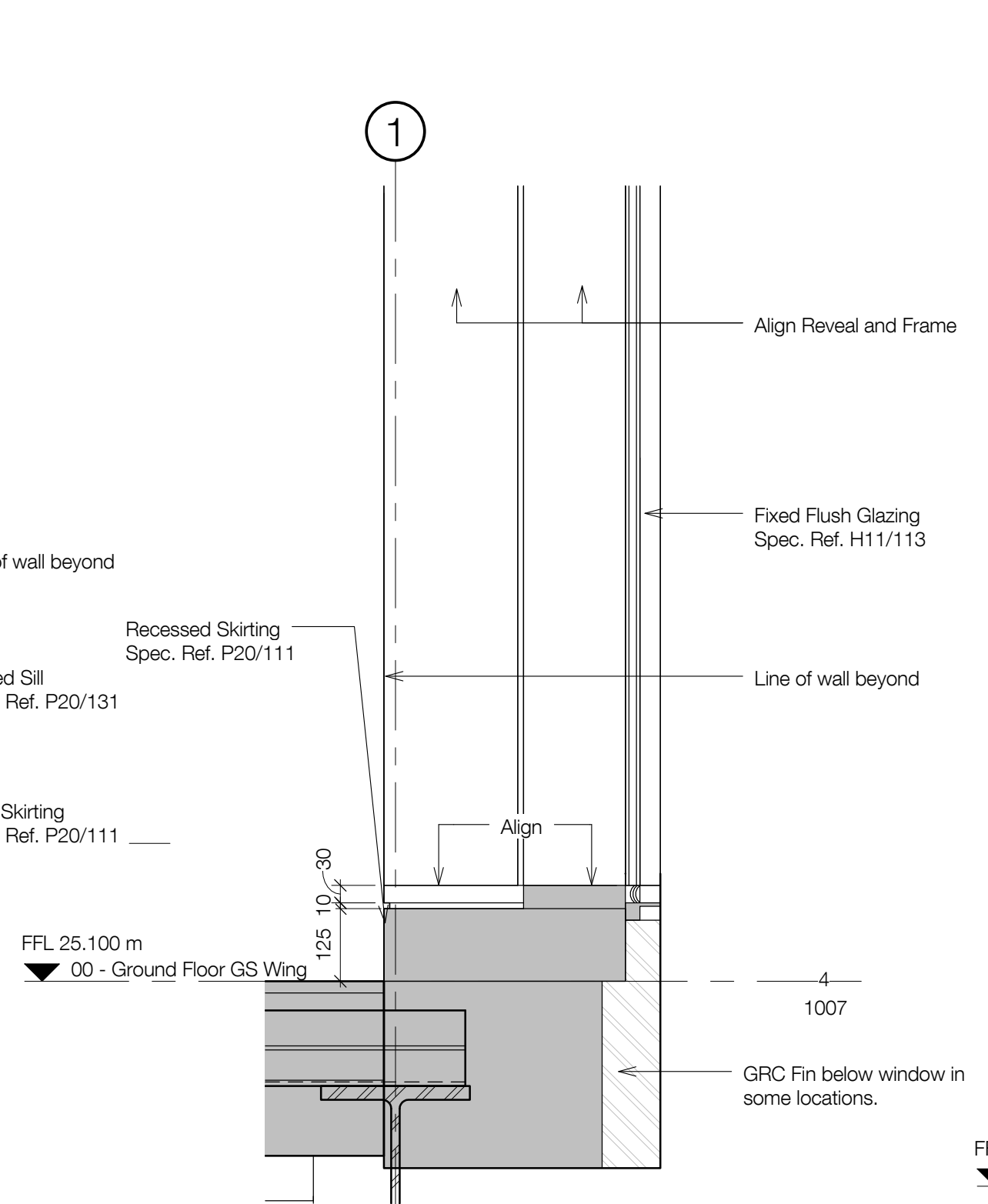

6 Window Type E1 - Sill Detail  
1 : 10

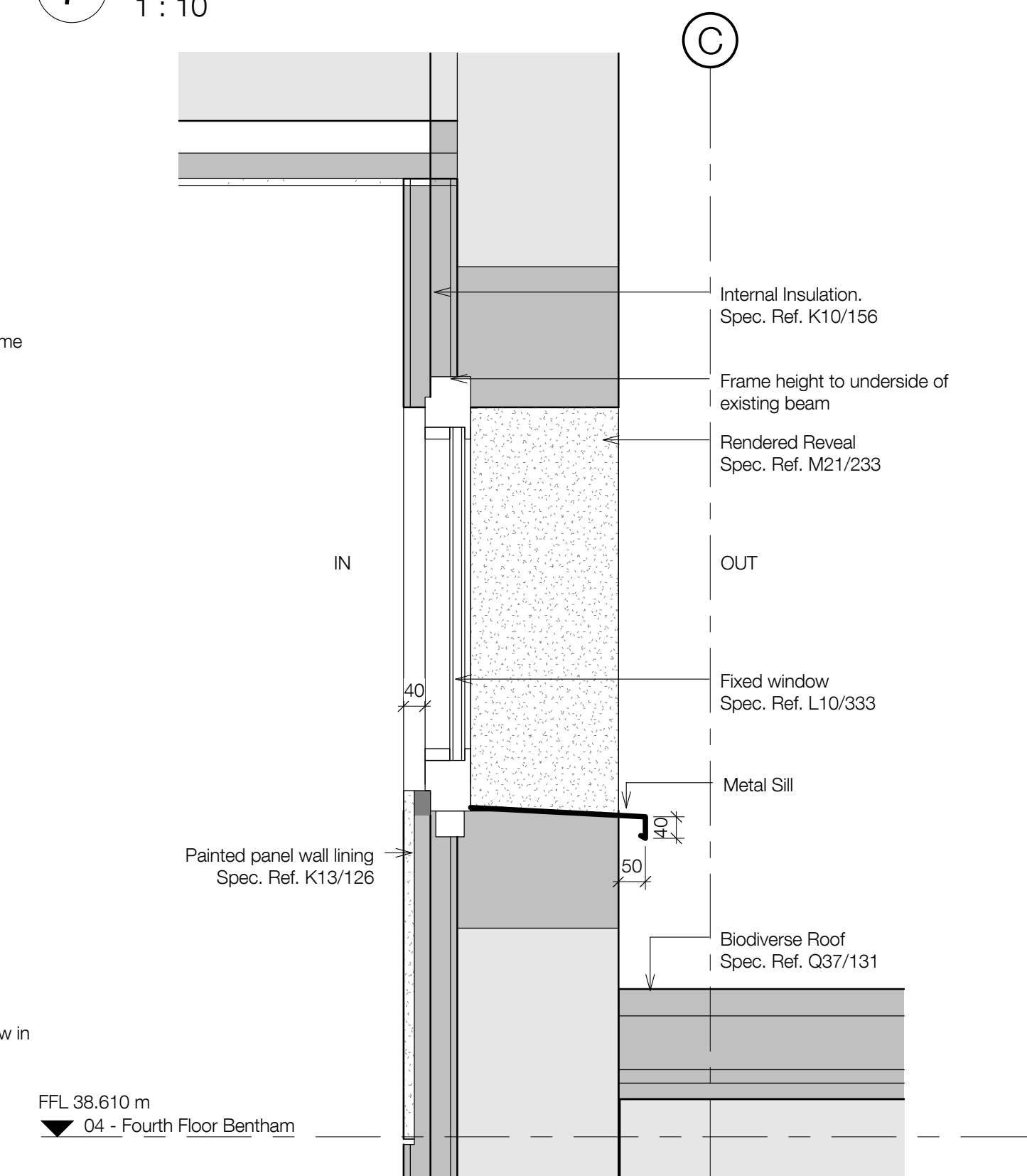

8 Staffroom Section Detail  
1 : 10

**standard notes**

1. Do not scale this drawing.
2. All dimensions must be checked on site and any discrepancies verified with the architect.
3. Unless shown otherwise, all dimensions are to structural surfaces.

THIS IS NOT A CONSTRUCTION DRAWING. IT IS UNSUITABLE FOR THE PURPOSE OF CONSTRUCTION AND MUST ON NO ACCOUNT BE USED AS SUCH.

**drawing notes**

DESIGN INTENT: These are design intent drawings and do not show full construction information. The Contractor must develop the details, without changing the visual, spatial or other performances, to provide a fully developed scheme including all concealed components such as wind posts, vapour barriers and cavity barriers. All dimensions on this drawing are taken to finished surfaces unless specifically indicated on the dimensions itself.

KEY:  Existing building (assumed)  
 Proposed building

1. Bird protection wire to all windows. Spec Ref. N16/341

**revisions**

T1	25.03.15	Issued for Tender
P1	31.03.15	Planning Conditions Issue

**UCL LAWS**  
Bentham House

**date** 03/04/15  
**client** UCL  
**scale** As indicated  
**drawing** Window Details - Sheet 1  
**drawn** TN  
**checked** JM  
**drawing number** 3000-A-1005  
**rev** P1

Levitt Bernstein  
1 Kingsland Passage  
London  
E8 2BB

t: 020 7275 7676  
f: 020 7275 9348  
w: levittberstein.co.uk  
e: post@levittberstein.co.uk

Levitt Bernstein

C:\Revit Local\Project Path\3000\_UCL Laws\_CENTRAL\_\jonathan.mann.rvt