

14042-D312\_B.pdf

14042-D313\_A.pdf

14042-D090\_A.pdf

14042-D100\_B.pdf

14042-D110\_A.pdf

14042-D120\_A.pdf

14042-D130\_A.pdf

14042-D310\_B.pdf

14042-D311\_B.pdf



1 Demolition - Rear (SW) Elevation

1 : 50



General notes:  
This drawing is copyright of KSR architects. This drawing must be read in conjunction with the Designer's Risk Assessment, specification and all other relevant documentation and drawings. KSR architects accept no liability for any expense, loss or damage of whatsoever nature and however arising from any variation made to this drawing or in the execution of the work to which it relates which has not been referred to them and their approval obtained.  
Do not scale from this drawing or the digital data, only figured dimensions are to be used. For Planning refer to lineal scale. Check all dimensions on site prior to carrying out any works – advise any discrepancy

Notes/Legends

- DEMOLITION OF INTERNAL WALLS & FITTINGS
- DEMOLITION OF EXTERNAL ENVELOPE ELEMENTS
- MAKE GOOD / REPLACE LIKE FOR LIKE / INFILL TO MATCH EXISTING

B	Planning Application	02/04/2015	RM
A	Planning Application	02/04/2015	RM
Rev	Description	Date	Chd

© KSR architects

Stamp

PLANNING

Key Plan

**KSR**ARCHITECTS

KSR Architects LLP  
14 Greenland Street  
London NW1 0ND

mail@ksrarchitects.com  
t: +44 (0)20 7692 5000  
www.ksrarchitects.com

Project:

4 Greenaway Gardens

Title:

Demolition Rear (SW)Elevation

Date	04/02/15	Drawn By	AT	Checked	RM
Scale	1:50	Sheet	A1	Status	Information

Project Ref.	Drawing No.	Revision
14042	14042-D312	B

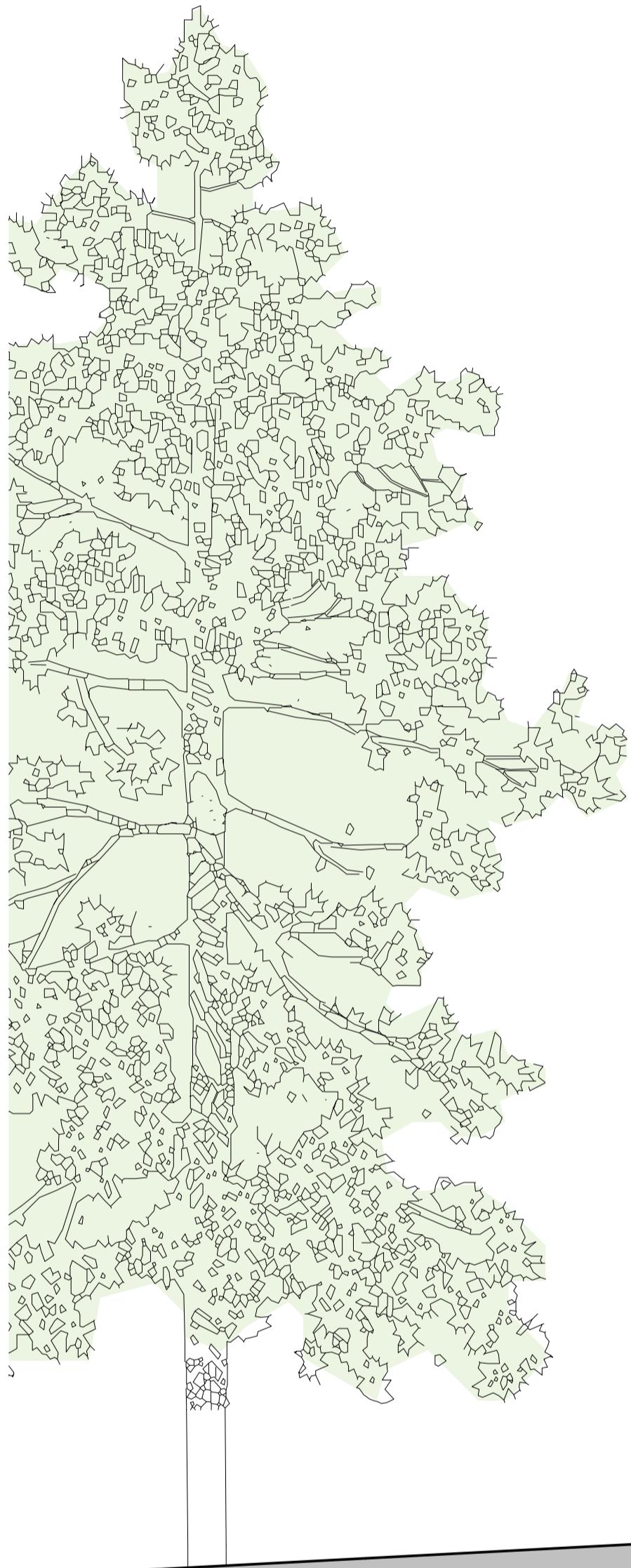

FRONT GARDEN

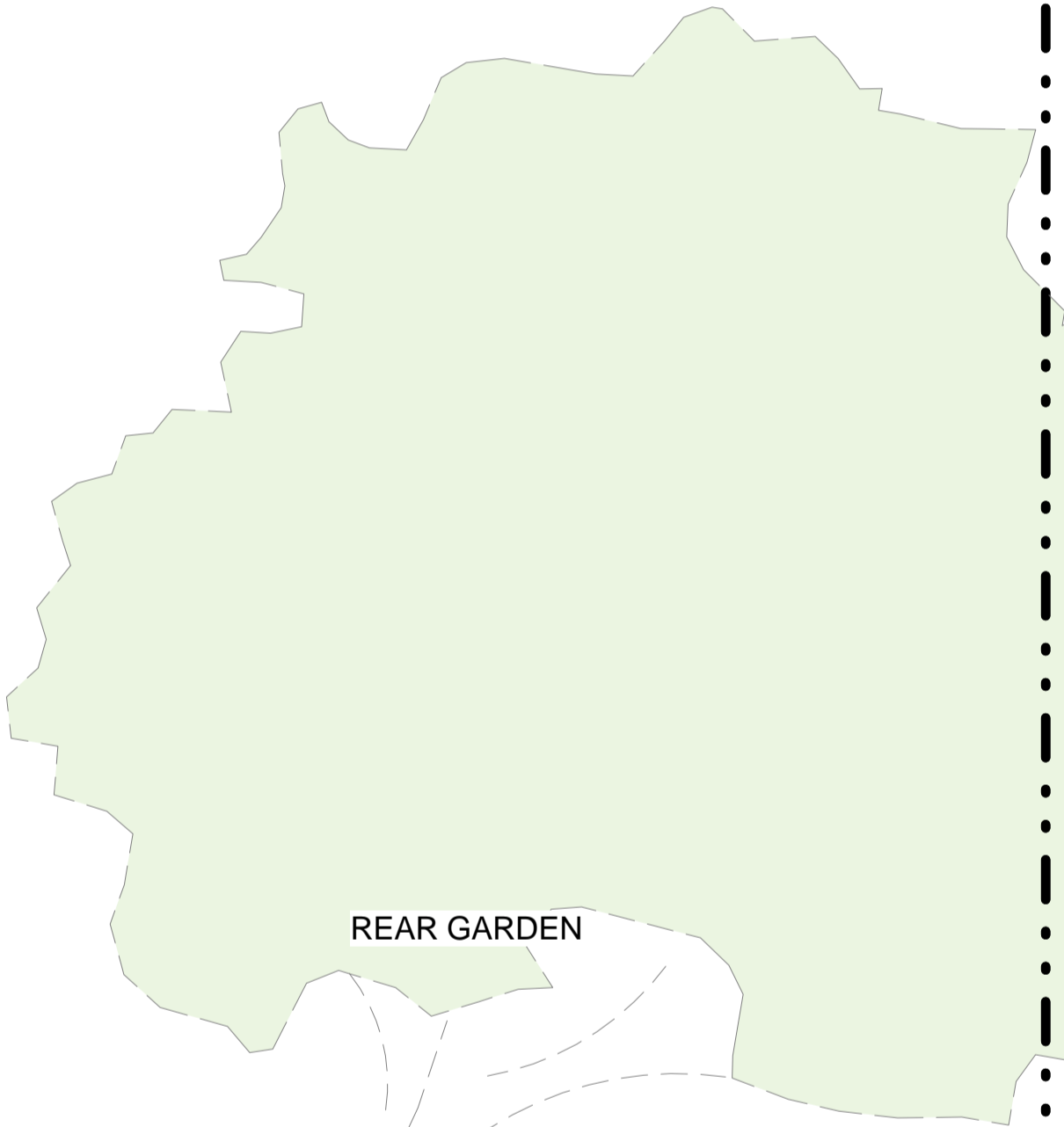
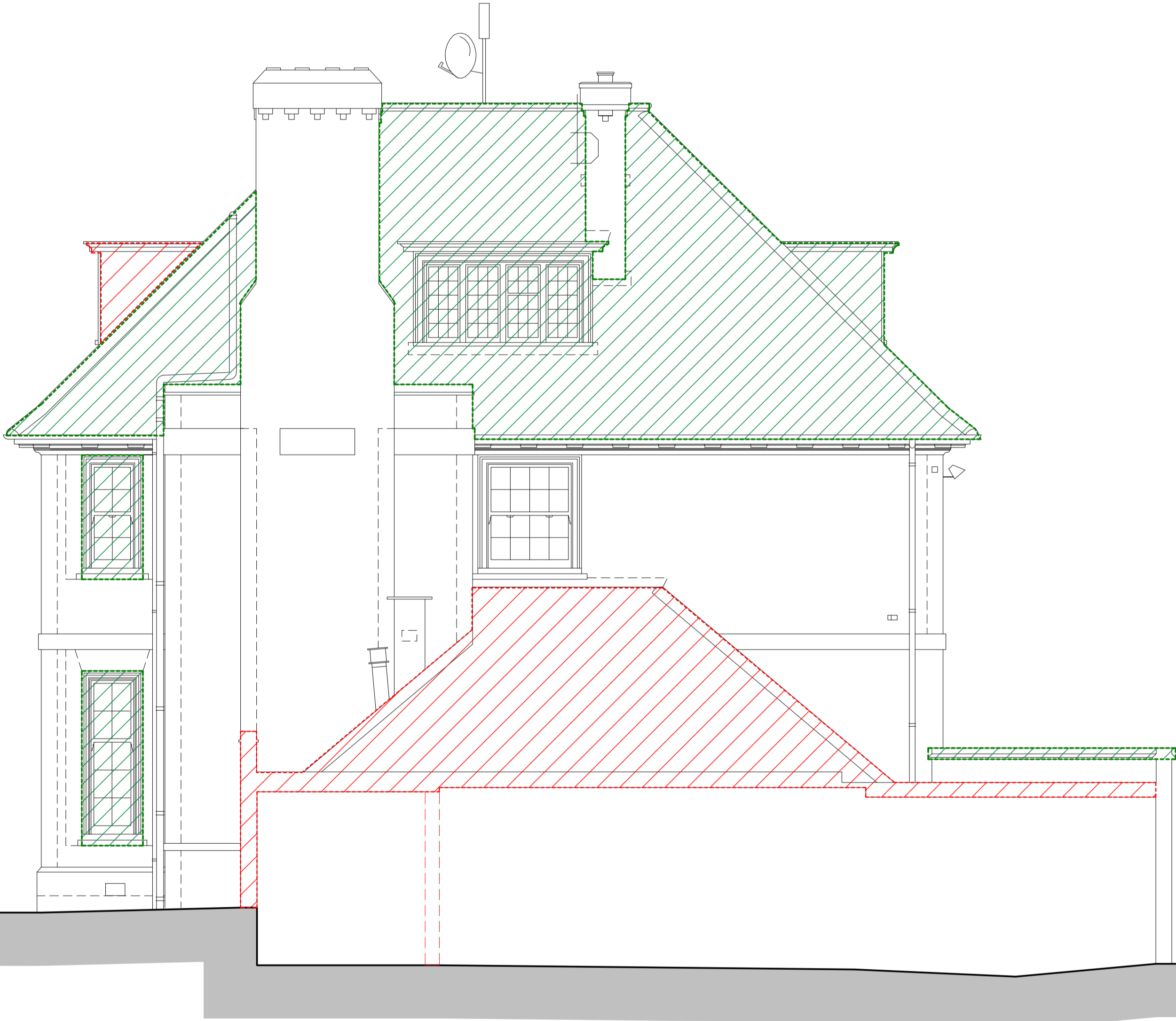

REAR GARDEN

BOUNDARY LINE

NO 4 GREENAWAY GARDENS

1 Demolition - Side (SE) Elevation

1 : 50

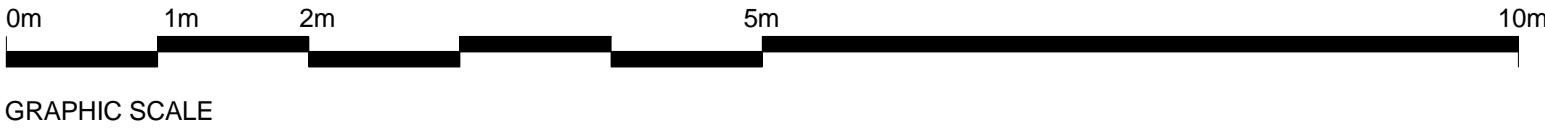

General notes:  
This drawing is copyright of KSR architects. This drawing must be read in conjunction with the Designer's Risk Assessment, specification and all other relevant documentation and drawings. KSR architects accept no liability for any expense, loss or damage of whatsoever nature and however arising from any variation made to this drawing or in the execution of the work to which it relates which has not been referred to them and their approval obtained.  
Do not scale from this drawing or the digital data, only figured dimensions are to be used. For Planning refer to lineal scale. Check all dimensions on site prior to carrying out any works – advise any discrepancy

Notes/Legends

- DEMOLITION OF INTERNAL WALLS & FITTINGS
- DEMOLITION OF EXTERNAL ENVELOPE ELEMENTS
- MAKE GOOD / REPLACE LIKE FOR LIKE / INFILL TO MATCH EXISTING

A	Planning Application	02/04/2015	RM
Rev	Description	Date	Chkd

© KSR architects

Stamp

PLANNING

Key Plan

**KSR**ARCHITECTS

KSR Architects LLP  
14 Greenland Street  
London NW1 0ND

mail@ksrarchitects.com  
t: +44 (0)20 7692 5000  
www.ksrarchitects.com

Project:

4 Greenaway Gardens

Title:

Demolition Side (SE)Elevation

Date	04/02/15	Drawn By:	AT	Checked:	RM
Scale:	1:50	Sheet:	A1	Status:	Information

Project Ref:	Drawing No:	Revision:
14042	14042-D313	A

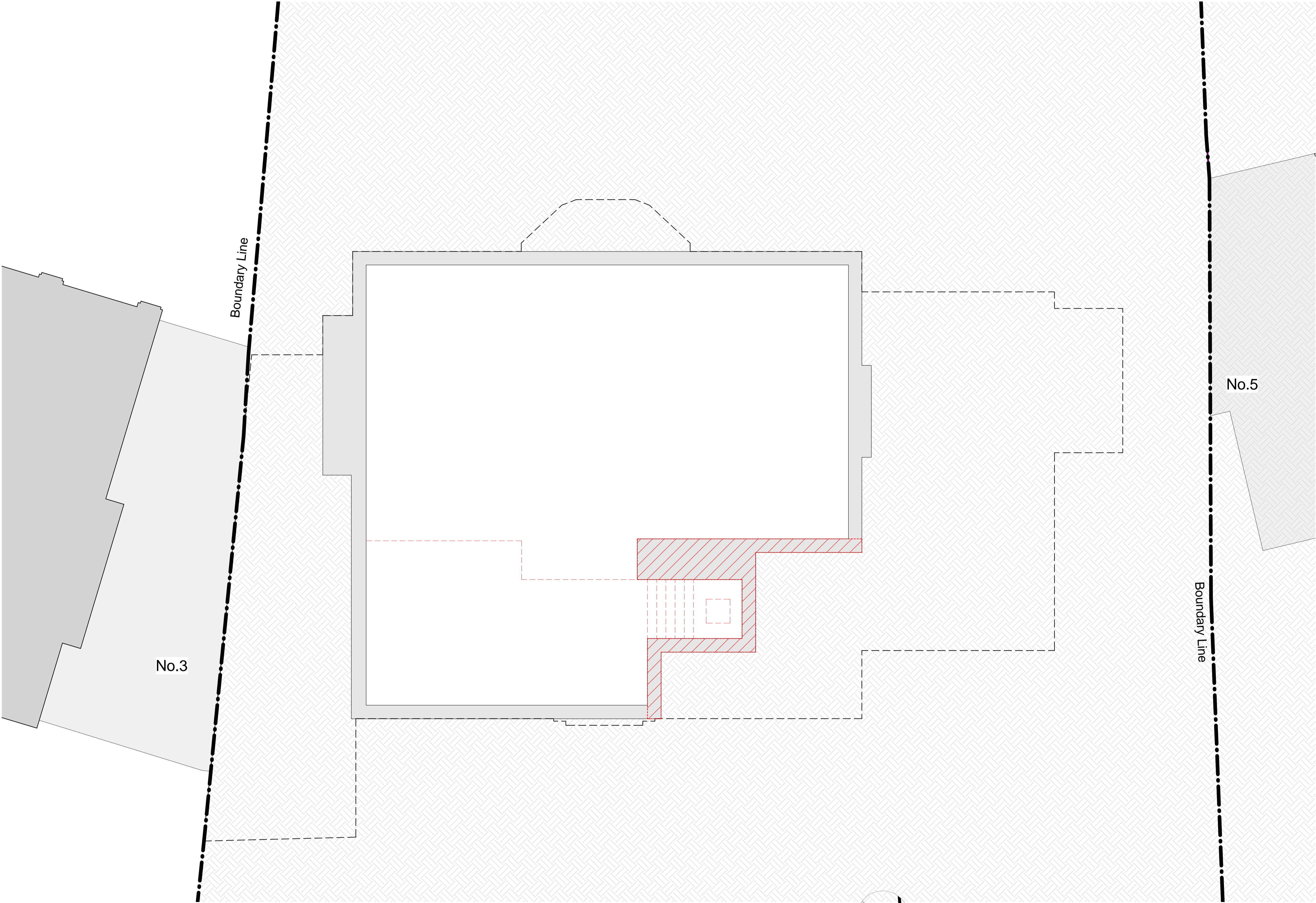

1 Demolition Basement Floor Plan  
1 : 50

General notes:  
This drawing is copyright of KSR architects. This drawing must be read in conjunction with the Designer's Risk Assessment, specification and all other relevant documentation and drawings. KSR architects accept no liability for any expense, loss or damage of whatsoever nature and however arising from any variation made to this drawing or in the execution of the work to which it relates which has not been referred to them and their approval obtained.  
Do not scale from this drawing or the digital data, only figured dimensions are to be used. For Planning refer to linear scale. Check all dimensions on site prior to carrying out any works – advise any discrepancy

Notes/Legends

- DEMOLITION OF INTERNAL WALLS & FITTINGS
- DEMOLITION OF EXTERNAL ENVELOPE ELEMENTS
- MAKE GOOD / REPLACE LIKE FOR LIKE / INFILL TO MATCH EXISTING

A Planning Application		02/04/2015		RM
Rev	Description	Date	Chkd	

© KSR architects

Stamp

PLANNING

Key Plan

**KSR**ARCHITECTS  
KSR Architects LLP  
14 Greenland Street  
London W1M 0ND

mail@ksrarchitects.com  
t: +44 (0)20 7692 5000  
www.ksrarchitects.com

Project:

4 Greenaway Gardens

Title:

Basement Demolition Plan

Date:	01/04/2015	Drawn By:	AT	Checked:	RM
Scale:	1:50	Sheet:	A1	Status:	Information

Project Ref:	Drawing No:	Revision:
14042	14042-D090	A

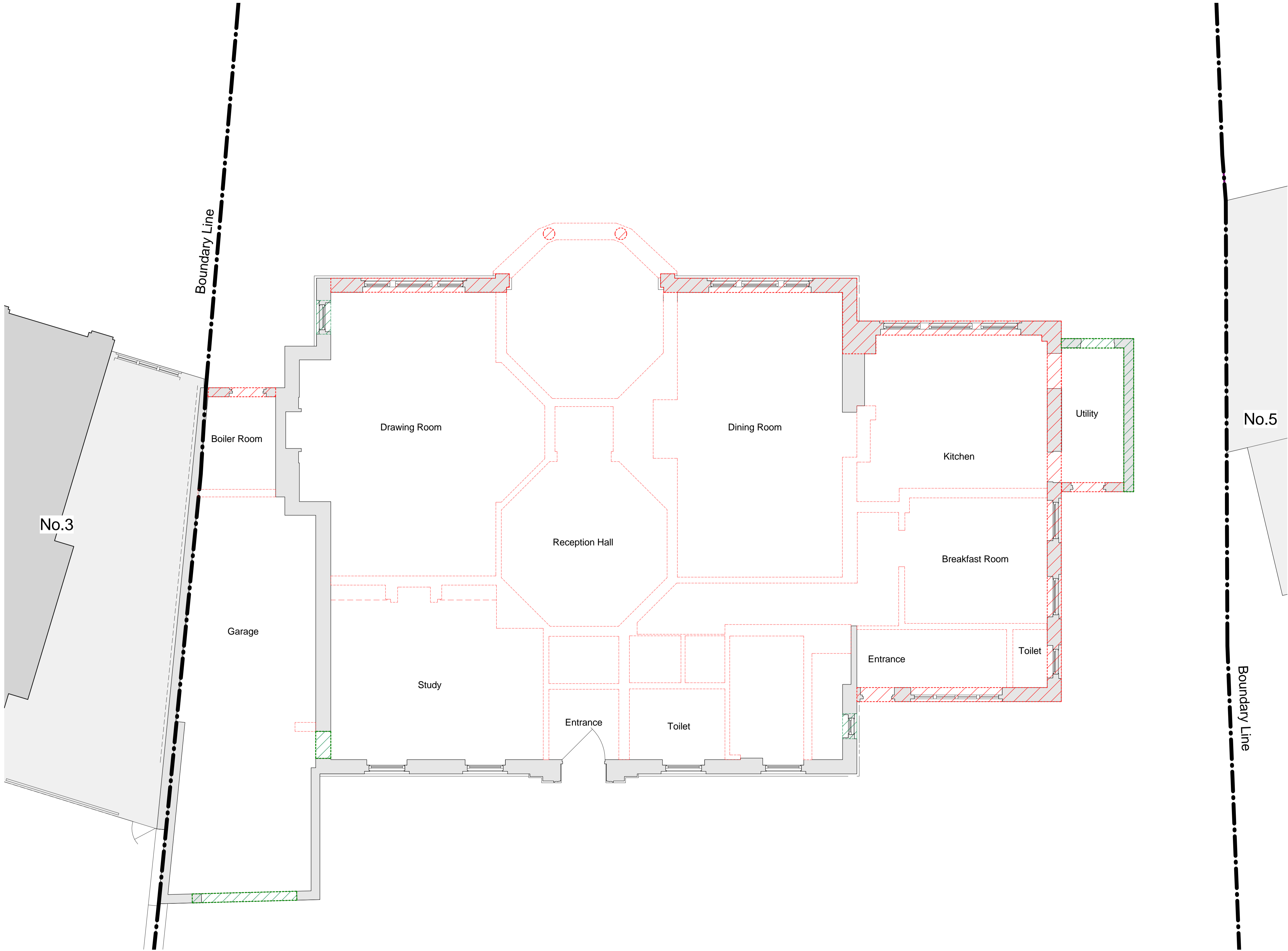

General notes:  
This drawing is copyright of KSR architects. This drawing must be read in conjunction with the Designer's Risk Assessment, specification and all other relevant documentation and drawings. KSR architects accept no liability for any expense, loss or damage of whatsoever nature and however arising from any variation made to this drawing or in the execution of the work to which it relates which has not been referred to them and their approval obtained.  
Do not scale from this drawing or the digital data, only figured dimensions are to be used. For Planning refer to lineal scale. Check all dimensions on site prior to carrying out any works – advise any discrepancy

Notes/Legends

- DEMOLITION OF INTERNAL WALLS & FITTINGS
- DEMOLITION OF EXTERNAL ENVELOPE ELEMENTS
- MAKE GOOD / REPLACE LIKE FOR LIKE / INFILL TO MATCH EXISTING

B	Planning Application	02/04/2015	RM
A	Planning Application	02/04/2015	RM
Rev	Description	Date	Chd

© KSR architects

Stamp

PLANNING

Key Plan

KSRARCHITECTS

KSR Architects LLP  
14 Greenland Street  
London NW1 0ND

mail@ksrarchitects.com  
t: +44 (0)20 7692 5000  
www.ksrarchitects.com

Project:

4 Greenaway Gardens

Title:

Ground Floor Demolition Plan

Date:	01/04/2015	Drawn By:	AT	Checked:	RM
Scale:	1:50	Sheet:	A1	Status:	Information

Project Ref:	Drawing No:	Revision:
14042	14042-D100	B

1

Demolition Ground Floor Plan

1 : 50

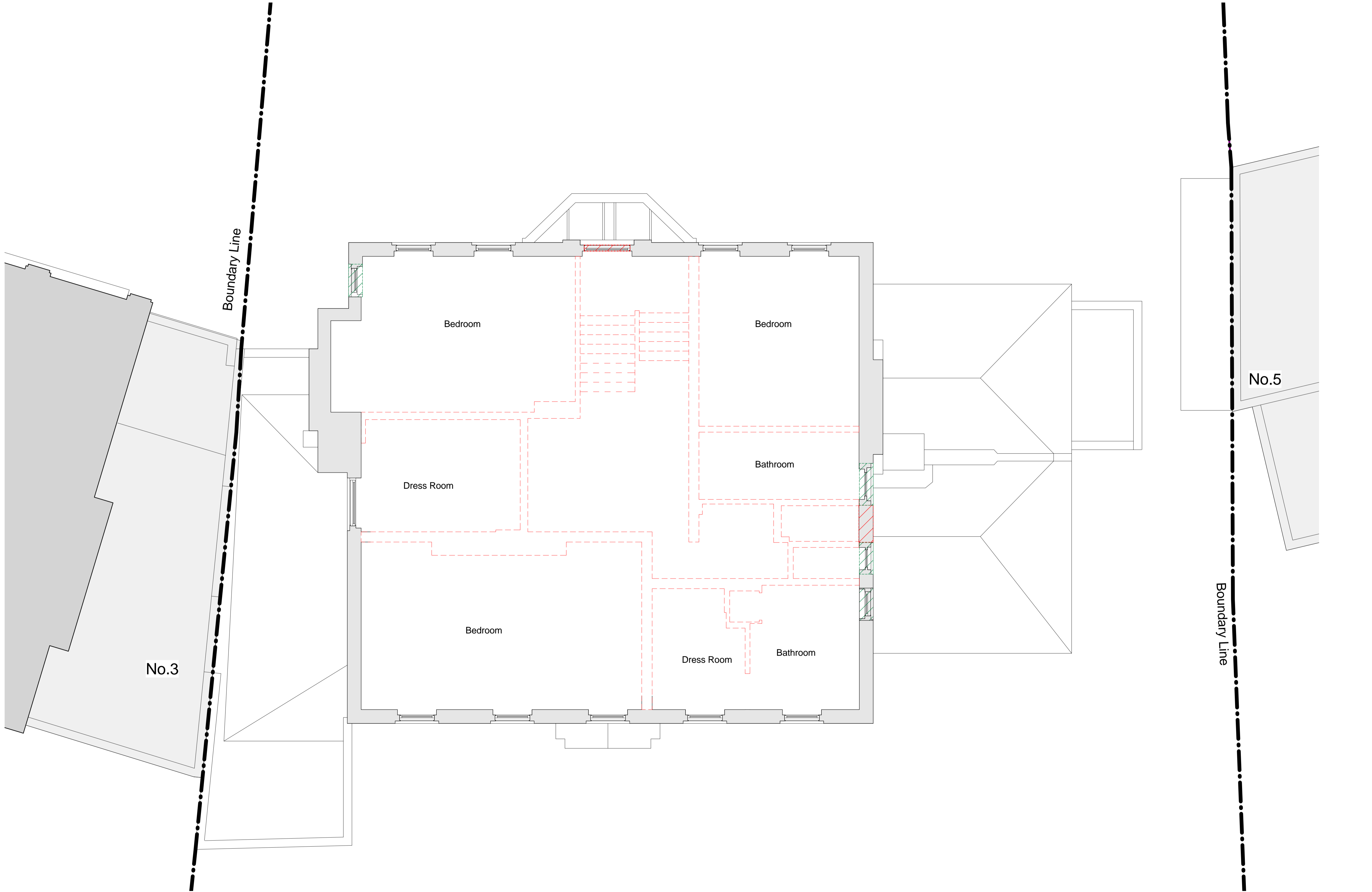

General notes:  
This drawing is copyright of KSR architects. This drawing must be read in conjunction with the Designer's Risk Assessment, specification and all other relevant documentation and drawings. KSR architects accept no liability for any expense, loss or damage of whatsoever nature and however arising from any variation made to this drawing or in the execution of the work to which it relates which has not been referred to them and their approval obtained.  
Do not scale from this drawing or the digital data, only figured dimensions are to be used. For Planning refer to lines' scale. Check all dimensions on site prior to carrying out any works – advise any discrepancy

Notes/Legends

- DEMOLITION OF INTERNAL WALLS & FITTINGS
- DEMOLITION OF EXTERNAL ENVELOPE ELEMENTS
- MAKE GOOD / REPLACE LIKE FOR LIKE / INFILL TO MATCH EXISTING

A	Planning Application	02/04/2015	RM
Rev	Description	Date	Chkd

© KSR architects

Stamp:

PLANNING

Key Plan

KSRARCHITECTS

KSR Architects LLP  
14 Greenleaf Street  
London NW1 0ND

mail@ksrarchitects.com  
t: +44 (0)20 7692 5000  
www.ksrarchitects.com

Project:

4 Greenaway Gardens

Title:

First Floor Demolition Plan

Date:	01/04/2015	Drawn By:	AT	Checked:	RM
Scale:	1:50	Sheet:	A1	Status:	Information

Project Ref:	Drawing No:	Revision:
14042	14042-D110	A

1

Demolition First Floor Plan

1 : 50

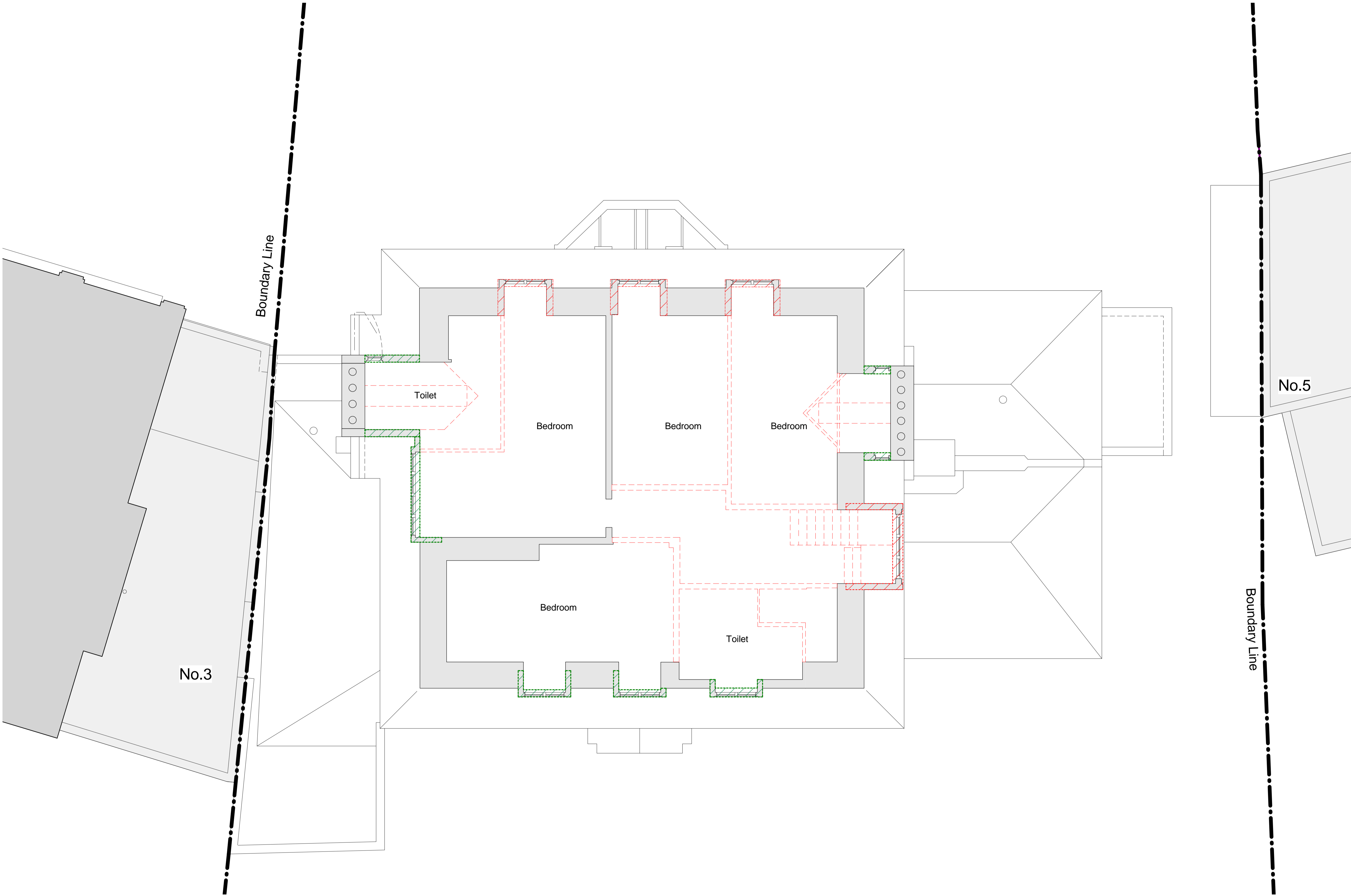

General notes:  
This drawing is copyright of KSR architects. This drawing must be read in conjunction with the Designer's Risk Assessment, specification and all other relevant documentation and drawings. KSR architects accept no liability for any expense, loss or damage of whatsoever nature and however arising from any variation made to this drawing or in the execution of the work to which it relates which has not been referred to them and their approval obtained.  
Do not scale from this drawing or the digital data, only figured dimensions are to be used. For Planning refer to linear scale. Check all dimensions on site prior to carrying out any works – advise any discrepancy

Notes/Legends

- DEMOLITION OF INTERNAL WALLS & FITTINGS
- DEMOLITION OF EXTERNAL ENVELOPE ELEMENTS
- MAKE GOOD / REPLACE LIKE FOR LIKE / INFILL TO MATCH EXISTING

A	Planning Application	02/04/2015	RM
Rev	Description	Date	Chkd

© KSR architects

Stamp

PLANNING

Key Plan

**KSR**ARCHITECTS

KSR Architects LLP  
14 Greenland Street  
London NW1 0ND

mail@ksrarchitects.com  
t: +44 (0)20 7692 5000  
www.ksrarchitects.com

Project:  
4 Greenaway Gardens

Title:  
Second Floor Demolition Plan

Date:	01/04/2015	Drawn By:	AT	Checked:	RM
-------	------------	-----------	----	----------	----

Scale: 1:50

Sheet: A1

Status: Information

Revision:

14042

14042-D120

A

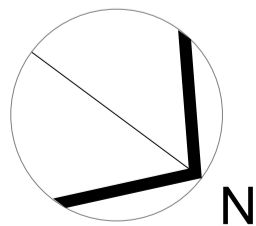

GRAPHIC SCALE

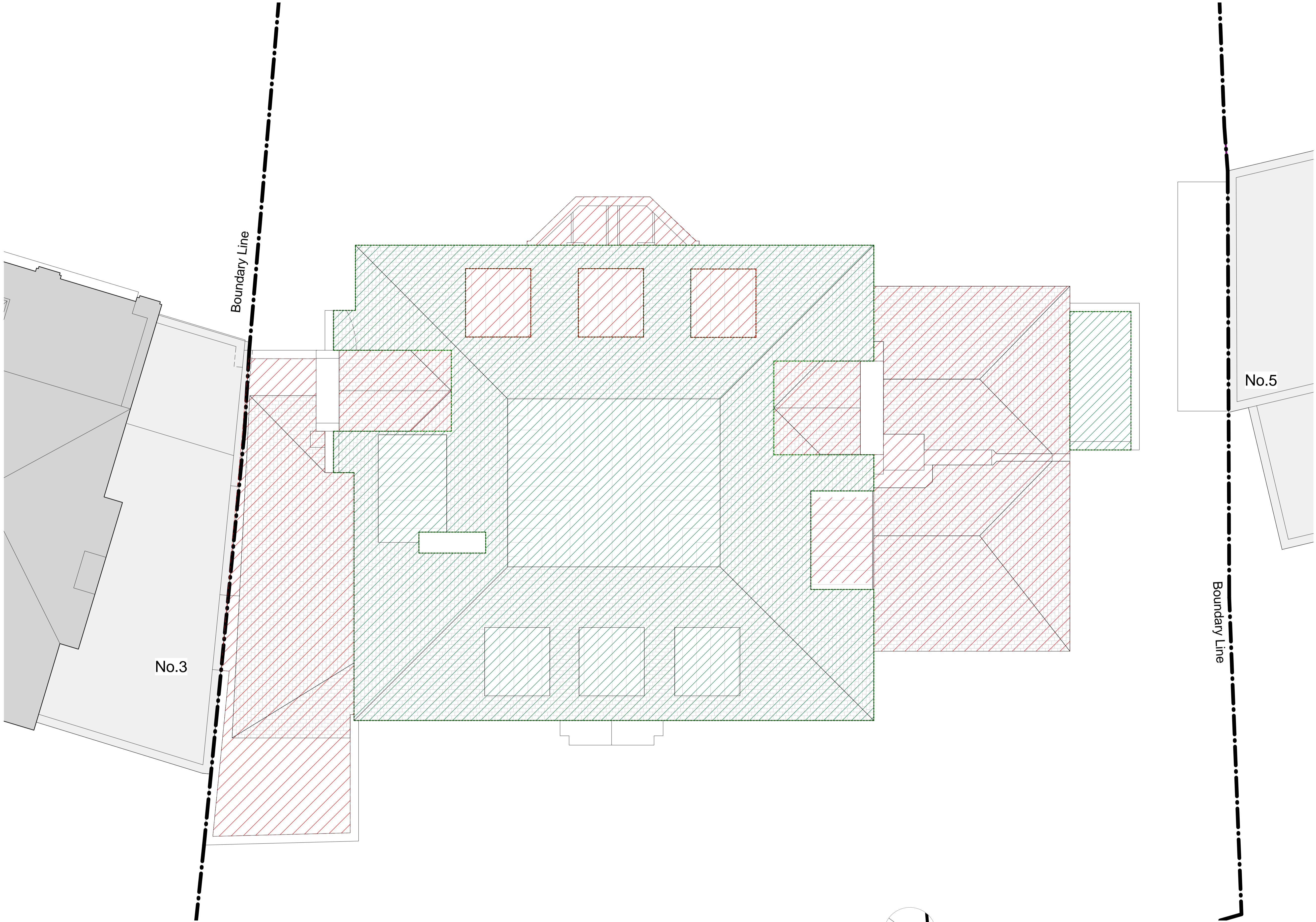

General notes:  
This drawing is copyright of KSR architects. This drawing must be read in conjunction with the Designer's Risk Assessment, specification and all other relevant documentation and drawings. KSR architects accept no liability for any expense, loss or damage of whatsoever nature and however arising from any variation made to this drawing or in the execution of the work to which it relates which has not been referred to them and their approval obtained.  
Do not scale from this drawing or the digital data, only figured dimensions are to be used. For Planning refer to linear scale. Check all dimensions on site prior to carrying out any works – advise any discrepancy

Notes/Legends

- DEMOLITION OF INTERNAL WALLS & FITTINGS
- DEMOLITION OF EXTERNAL ENVELOPE ELEMENTS
- MAKE GOOD / REPLACE LIKE FOR LIKE / INFILL TO MATCH EXISTING

A Planning Application 02/04/2015 RM

Rev Description Date Chd

© KSR architects

Stamp

PLANNING

Key Plan

**KSR**ARCHITECTS

KSR Architects LLP mail@ksrarchitects.com  
14 Greenland Street t: +44 (0)20 7692 5000  
London NW1 0ND www.ksrarchitects.com

Project:

4 Greenaway Gardens

Title:

Roof Demolition Plan

Date: 01/04/2015 Drawn By: AT Checked: RM

Scale: 1:50 Sheet: A1 Status: Information

Project Ref: 14042 Drawing No: 14042-D130 Revision: A

1

Demolition Roof Plan

1 : 50

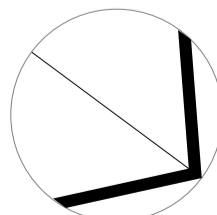

0m 1m 2m 5m 10m

GRAPHIC SCALE



General notes:  
This drawing is copyright of KSR architects. This drawing must be read in conjunction with the Designer's Risk Assessment, specification and all other relevant documentation and drawings. KSR architects accept no liability for any expense, loss or damage of whatsoever nature and however arising from any variation made to this drawing or in the execution of the work to which it relates which has not been referred to them and their approval obtained.  
Do not scale from this drawing or the digital data, only figured dimensions are to be used. For Planning refer to lineal scale. Check all dimensions on site prior to carrying out any works – advise any discrepancy

Notes/Legends

- DEMOLITION OF INTERNAL WALLS & FITTINGS
- DEMOLITION OF EXTERNAL ENVELOPE ELEMENTS
- MAKE GOOD / REPLACE LIKE FOR LIKE / INFILL TO MATCH EXISTING

B	Planning Application	02/04/2015	RM
A	Planning Application	02/04/2015	RM

Rev	Description	Date	Chkd
-----	-------------	------	------

© KSR architects

Stamp

PLANNING

Key Plan

**KSR**ARCHITECTS  
KSR Architects LLP  
14 Greenland Street  
London NW1 0ND  
mail@ksrarchitects.com  
t: +44 (0)20 7692 5000  
www.ksrarchitects.com

Project:  
4 Greenaway Gardens

Title:  
Demolition Front (NE) Elevation

Date:	04/02/15	Drawn By:	AT	Checked:	RM
-------	----------	-----------	----	----------	----

Scale:	1:50	Sheet:	A1	Status:	Information
--------	------	--------	----	---------	-------------

Project Ref.	Drawing No.	Revision
14042	14042-D310	B

1 Demolition - Front (NE) Elevation

1 : 50

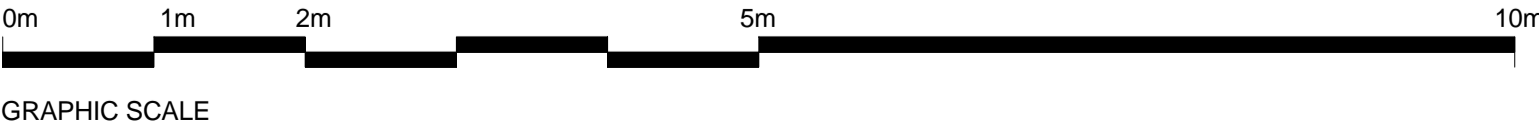

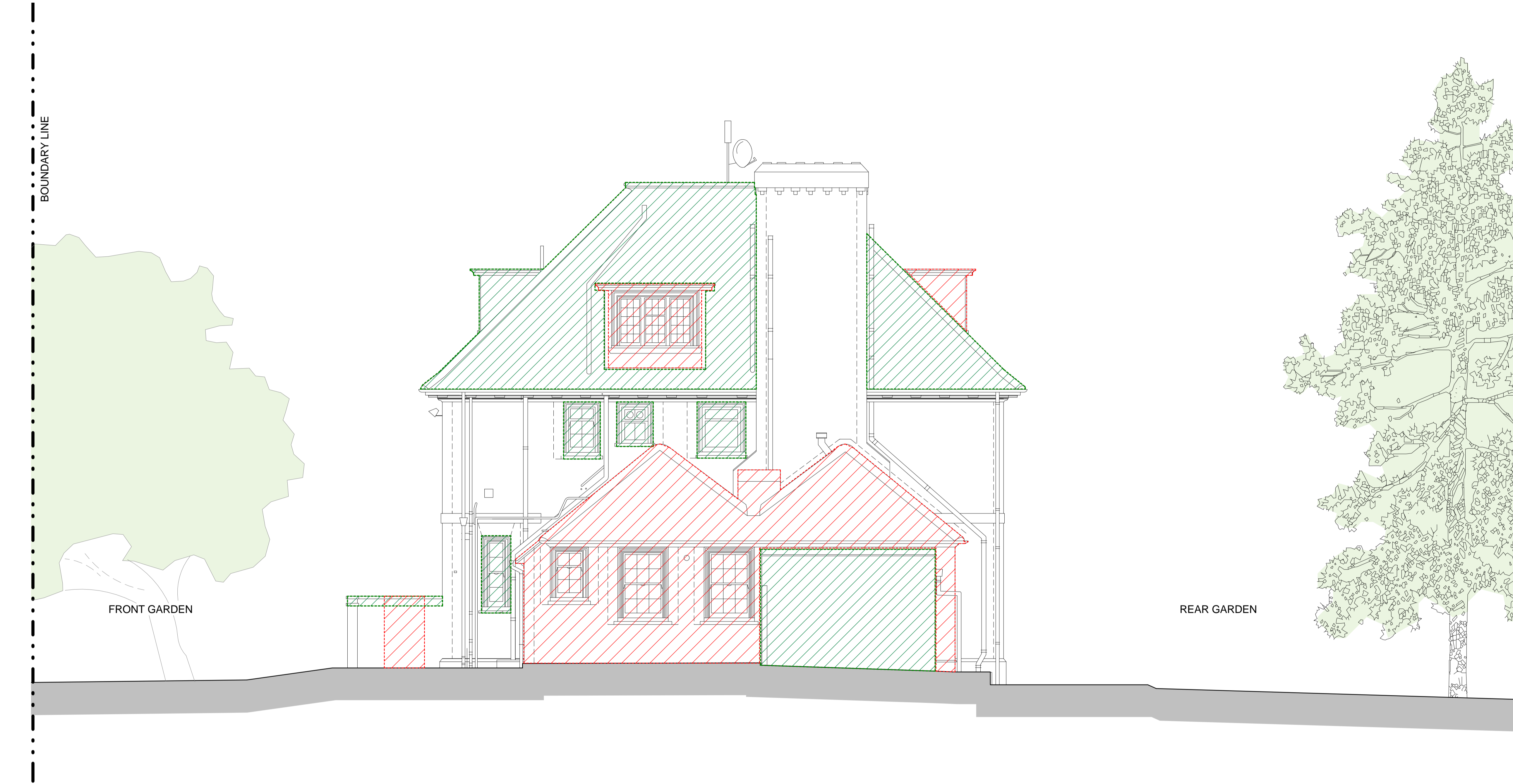

1 Demolition - Side (NW) Elevation  
1 : 50

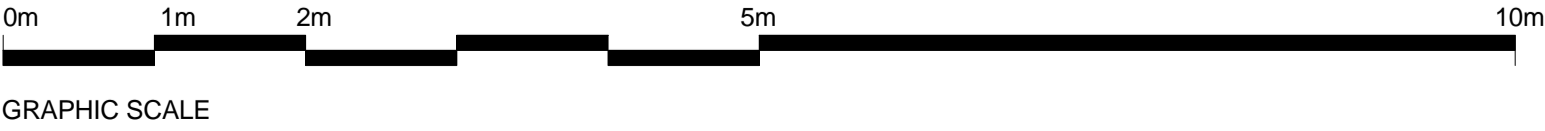

General notes:  
This drawing is copyright of KSR architects. This drawing must be read in conjunction with the Designer's Risk Assessment, specification and all other relevant documentation and drawings. KSR architects accept no liability for any expense, loss or damage of whatsoever nature and however arising from any variation made to this drawing or in the execution of the work to which it relates which has not been referred to them and their approval obtained.  
Do not scale from this drawing or the digital data, only figured dimensions are to be used. For Planning refer to lineal scale. Check all dimensions on site prior to carrying out any works – advise any discrepancy

Notes/Legends

- DEMOLITION OF INTERNAL WALLS & FITTINGS
- DEMOLITION OF EXTERNAL ENVELOPE ELEMENTS
- MAKE GOOD / REPLACE LIKE FOR LIKE / INFILL TO MATCH EXISTING

B	Planning Application	02/04/2015	RM
A	Planning Application	02/04/2015	RM
Rev	Description	Date	Chkd

© KSR architects

Stamp

PLANNING

Key Plan

**KSR**ARCHITECTS

KSR Architects LLP  
14 Greenland Street  
London NW1 0ND

mail@ksrarchitects.com  
t: +44 (0)20 7692 5000  
www.ksrarchitects.com

Project:

4 Greenaway Gardens

Title:

Demolition Side (NW) Elevation

Date:	04/02/15	Drawn By:	AT	Checked:	RM
Scale:	1:50	Sheet:	A1	Status:	Information

Project Ref:	Drawing No:	Revision:
14042	14042-D311	B