

Note:
- for Window refurbishment and alterations
to windows read in conjunction with
Window Schedule P_200 and DWGs P_201/202

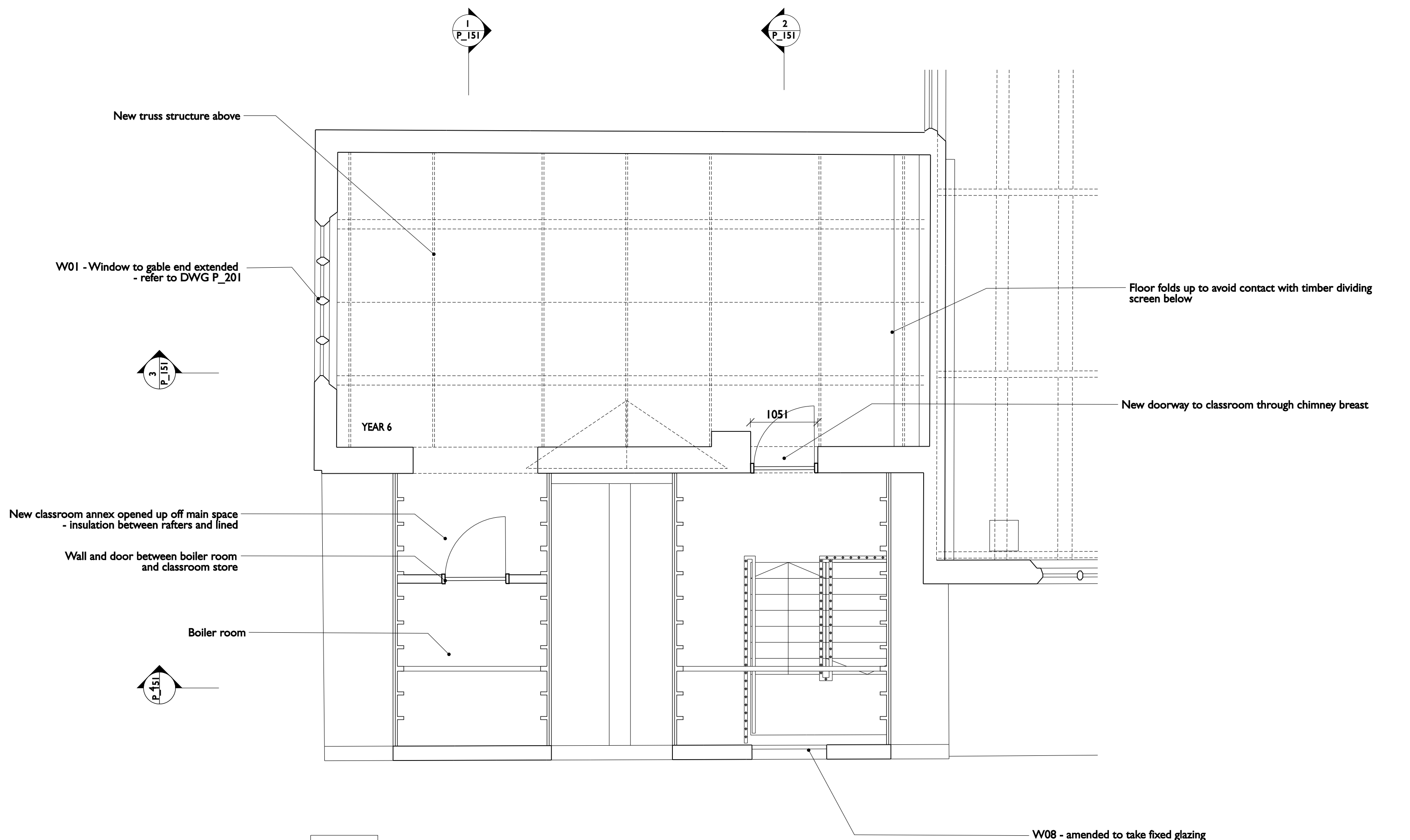

I	Ground Floor Plan
P_150	Scale 1:50

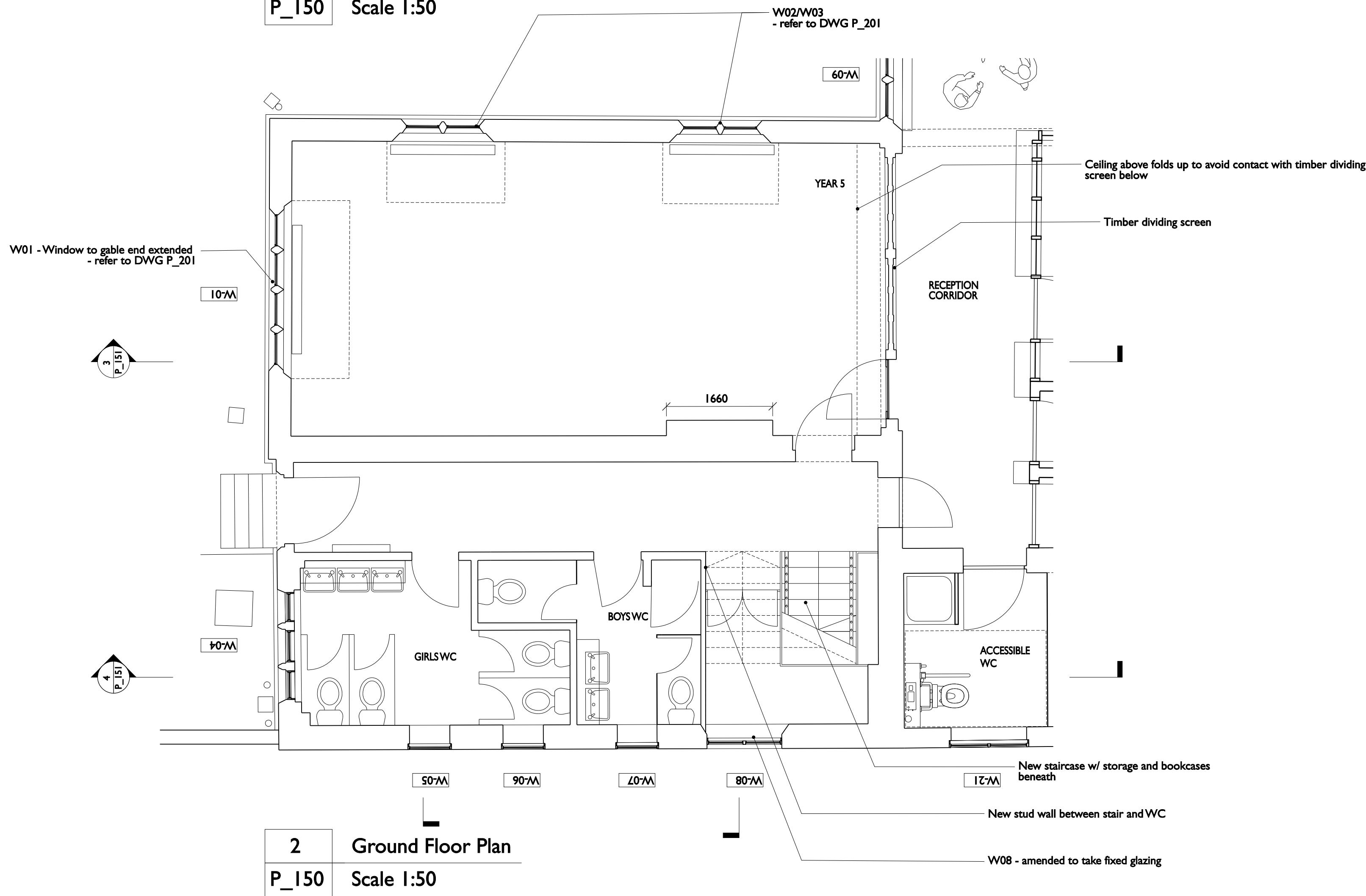

2	Ground Floor Plan
P_150	Scale 1:50

Project
CHRIST CHURCH PRIMARY SCHOOL
Christchurch Hill, London NW3 1JH

Drawing Title

South Wing Plans - Proposed

Project Number

Drawing Number

Scale @ A1/A3

Scale @ A1/A3 Status

1 : 50 Planning

Revisio

Date **09.10.14**

Revision Notes

C: New step detail between mezzanine structure and rear wall thereby remaining independent of timber screen and allowing it to be visible in its entirety from lower classroom

Stone steps to yard

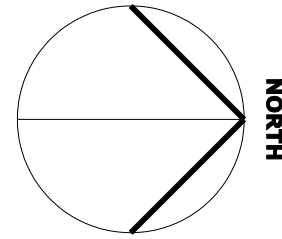

STUDIO ULLIN AND UCK ARCHITECTS TD.© 25 Hatton Garden
London EC1N 8BQ
UK
t: +44 (0) 20 7033 8788
e: team@scabal.net

All dimensions to be checked on site prior to commencement of work

Discrepancies between drawings and information to be referred to CA without delay