

Note:
- for details of Demolition works refer to DWG 500/510
- refer to Refurbishment Schedule for details of scope individual room refurb
- read in conjunction with Floor Finishes DWGs 1250/1260
- read in conjunction with M+E Info / SE Info
- read in conjunction with Door and Window Schedule
- specialist stone contractor to provide method statement for alterations to stone window surrounds w/ tender return

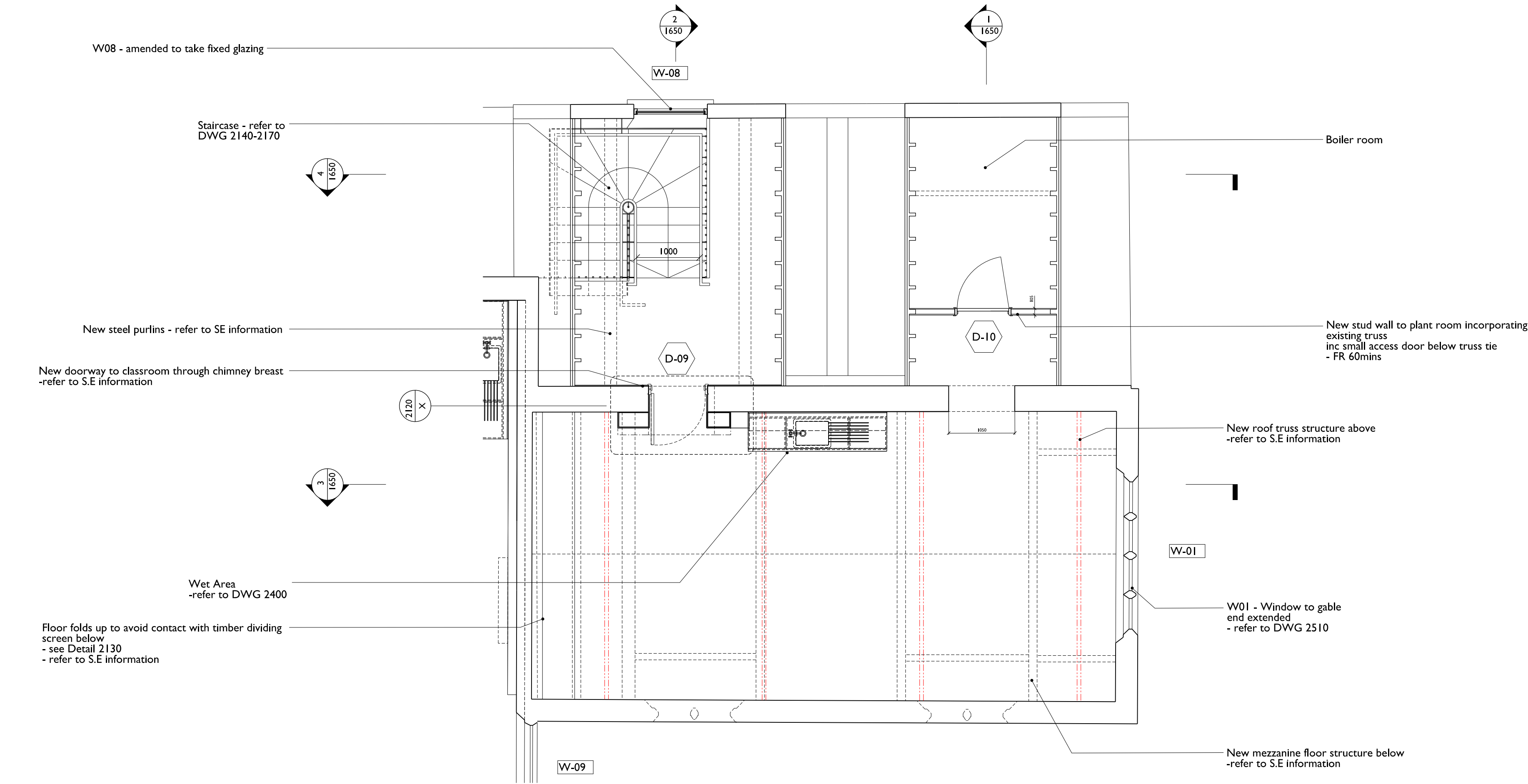

I	First Floor Plan
1600	Scale 1:50/100

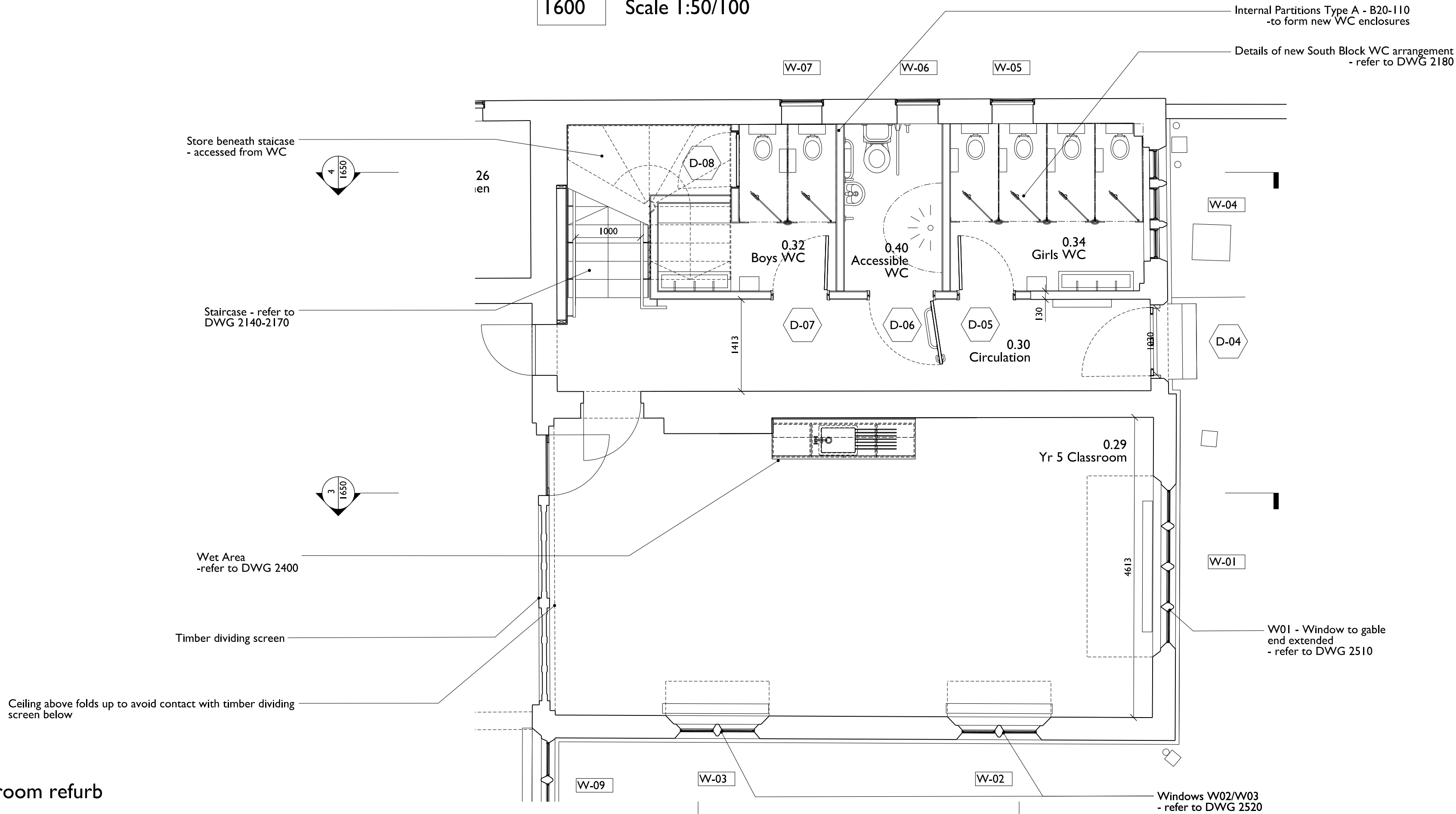

2	Ground Floor Plan
1600	Scale 1:50/100

Project
CHRIST CHURCH PRIMARY SCHOOL
Christchurch Hill, London NW3 1JH

Drawing Title

South Wing Plans - Proposed

Project Number

537

Drawing Number

1600

Status

Billing

Revision

C

Date

20.02.15

Revision Notes

Copyright ©
All dimensions to be checked on site prior to commencement of work
Discrepancies between drawings and information to be referred to CA without delay

SCABAL
TUDIO CULLINAN AND ARCHITECTS LTD. ©
25 Hutton Garden
London EC1N 8BQ
UK
t: +44 (0) 20 7033 8788
e: team@scabal.net