



|   |   |
|---|---|
| 1 | For the design of the structural members see structural engineers design and details                    |
| 2 | Denotes spam of existing 1st Floor  |
| 3 | All the timber sash windows to be replaced with new double glazed timber sash windows to match existing |

 Demolition  
 New Structure

NOTES:  
 DO NOT SCALE THIS DRAWING FIGURED DIMENSIONS ONLY TO BE WORKED TO. REPORT ANY DISCREPANCIES  
 THIS DRAWING TO BE READ IN CONJUNCTION WITH STRUCTURAL DRAWINGS

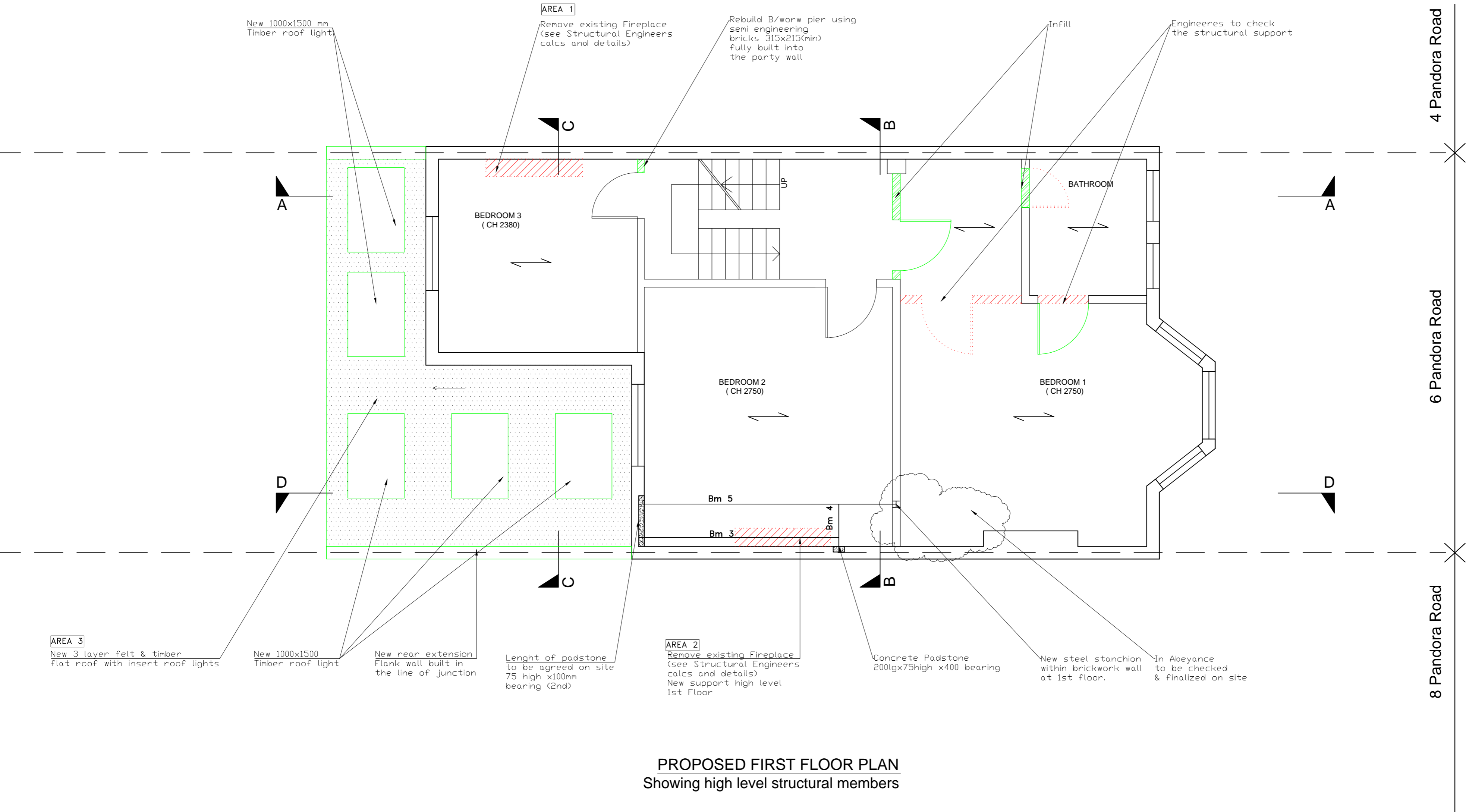

**PROPOSED FIRST FLOOR PLAN**  
 Showing high level structural members

**ISSUED FOR LOCAL AUTHORITY PLANNING APPROVAL**

Client  
 Mr & Mrs Symonds

Project  
 6 Pandora Road, West Hampstead  
 London NW6 1TT

Title  
 Proposed First Floor Plan

| Rev | Date | Made by | Amendments |
|-----|------|---------|------------|
| -   | -    | -       | -          |

|                  |              |              |
|------------------|--------------|--------------|
| Date<br>MAR 15   | Drawn<br>DGI | Ckd<br>SLS   |
| Scale<br>1:50@A2 | Job No.      | Dwg N.<br>14 |
|                  |              | Rev.<br>-    |