



## **TABLES**



**Table 1 – Laboratory Testing Schedule**

Sample ID	Sample Depth (m bgl)	Liquid/ Plastic Limits	Moisture Content	EPS Geotechnical Suite	EPS Mini Suite	Inert WAC
WS1 (soil)	0.1-0.3	-	-	-	1	-
WS1 (soil)	1.0-1.5	-	-	1	-	1
WS1 (soil)	1.8-2.0	1	1	-	-	-
WS1 (soil)	2.8-3.0	1	1	-	-	-
WS1 (soil)	4.8-5.0	-	-	1	-	-
WS2 (soil)	1.0-1.2	1	1	-	-	-
WS2 (soil)	2.0-2.2	-	-	1	-	-
WS2 (soil)	5.0-5.1	1	1	-	-	-

**Notes:**

m bgl	meters below ground level
EPS Geotechnical Suite	Include Total Sulphate, Total Sulphur, Water Soluble Sulphate and pH
EPS Mini Suite	Comprises pH, Sulphate, Cyanide, Heavy Metals, Polycyclic Aromatic Hydrocarbons, Phenols and Asbestos
Inert WAC	Inert Waste Acceptance Criteria
1	Sample Taken
-	Sample Not Analysed



## **APPENDICES**



## **APPENDIX A**

### **Selected Site Photographs**



Key:  
① Approximate Photo Location  
— Approximate Site Boundary

Crown Copyright. All rights reserved.  
Licence Number: 100054115



**Title:** Photograph Location Plan

**Project:** 15a Parliament Hill,  
London, NW3 2SY

**Client:** Gyoury Self Partnership

**Appendix: A**

Scale: NTS

Drawn By: KH | Approved By: WE

Job No: UK14.1639

Dwg No: GyourySelf/ParliamentHill/0914/A

Date: September 2014

Photo 1: View looking approximately west at the front of the existing residential property.



Photo 2: View looking approximately north at the front of the existing property and the locations of WS1/ TP1.



Photo 3: View looking approximately north at the location of TP1.



Photo 4: View looking within the excavation TP1.



Photo 5: View looking at the location of TP2.



Photo 6: View looking within the excavation TP2.





## **APPENDIX B**

### **Proposed Development Plan**

24.01.2012  
prints @ A3 to 1:200 scale

Woollacott Gilmartin Architects  
48(b) Netherhall Gardens London  
NW3 5RG

woollacottgilmartin.com  
wgarchitects@mac.com  
0207 431 9983  
07891 264 889

# P/1:200-000

## Proposed Site Plan 15a Parliament Hill

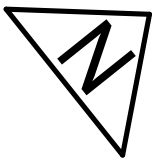
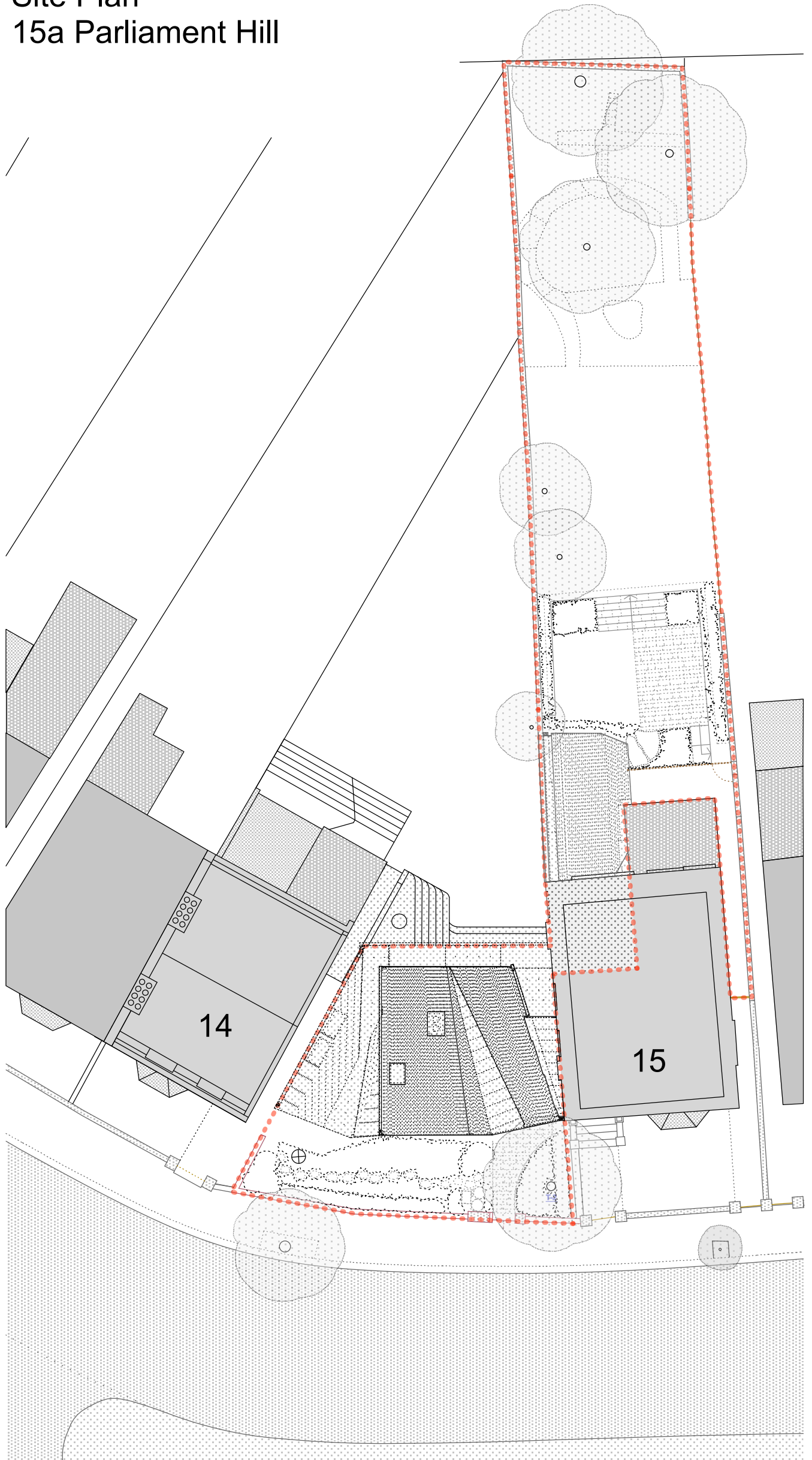

0 5 10





## **APPENDIX C**

### **Surrounding Land Use**



### General

- Specified Site
- Specified Buffer(s)
- Bearing Reference Point
- Map ID
- Several of Type at Location

### Agency and Hydrological

- Contaminated Land Register Entry or Notice (Location)
- Contaminated Land Register Entry or Notice
- Discharge Consent
- Enforcement or Prohibition Notice
- Integrated Pollution Control
- Integrated Pollution Prevention Control
- Local Authority Integrated Pollution Prevention and Control
- Local Authority Pollution Prevention and Control
- Local Authority Pollution Prevention and Control Enforcement
- Pollution Incident to Controlled Waters
- Prosecution Relating to Authorised Processes
- Prosecution Relating to Controlled Waters
- Registered Radioactive Substance
- River Network or Water Feature
- River Quality Sampling Point
- Substantiated Pollution Incident Register
- Water Abstraction
- Water Industry Act Referral

### Waste

- BGS Recorded Landfill Site (Location)
- BGS Recorded Landfill Site
- EA Historic Landfill (Buffered Point)
- EA Historic Landfill (Polygon)
- Integrated Pollution Control Registered Waste Site
- Licensed Waste Management Facility (Landfill Boundary)
- Licensed Waste Management Facility (Location)
- Local Authority Recorded Landfill Site (Location)
- Local Authority Recorded Landfill Site
- Registered Landfill Site
- Registered Landfill Site (Location)
- Registered Landfill Site (Point Buffered to 100m)
- Registered Landfill Site (Point Buffered to 250m)
- Registered Waste Transfer Site (Location)
- Registered Waste Transfer Site
- Registered Waste Treatment or Disposal Site (Location)
- Registered Waste Treatment or Disposal Site

### Geological

- BGS Recorded Mineral Site

### Industrial Land Use

- Contemporary Trade Directory Entry
- Fuel Station Entry
- COMAH Site
- Explosive Site
- NIHHS Site
- Planning Hazardous Substance Consent
- Planning Hazardous Substance Enforcement

### Site Sensitivity Map - Segment A13



### Order Details

Order Number: 59147264\_1\_1  
 Customer Ref: UK14.1639  
 National Grid Reference: 527380, 185770  
 Slice: A  
 Site Area (Ha): 0.05

### Site Details

15a, Parliament Hill, London, NW3 2SY



Tel: 0844 844 9952  
 Fax: 0844 844 9951  
 Web: www.envirocheck.co.uk

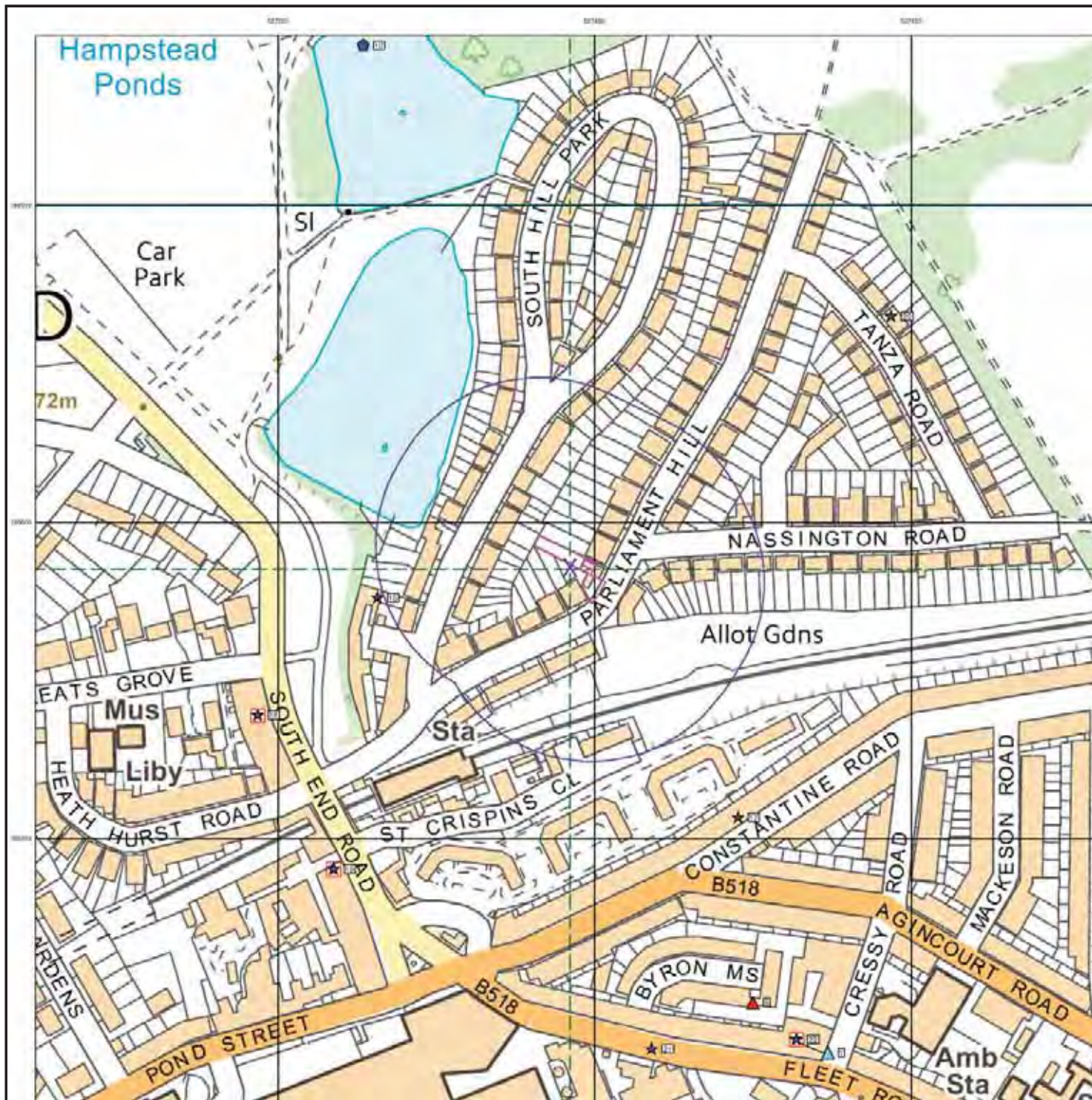



### General

- Specified Site
- Specified Buffer(s)
- Bearing Reference Point
- Map ID
- Several of Type at Location

### Agency and Hydrological

- Contaminated Land Register Entry or Notice (Location)
- Contaminated Land Register Entry or Notice
- Discharge Consent
- Enforcement or Prohibition Notice
- Integrated Pollution Control
- Integrated Pollution Prevention Control
- Local Authority Integrated Pollution Prevention and Control
- Local Authority Pollution Prevention and Control
- Local Authority Pollution Prevention and Control Enforcement
- Pollution Incident to Controlled Waters
- Prosecution Relating to Authorised Processes
- Prosecution Relating to Controlled Waters
- Registered Radioactive Substance
- River Network or Water Feature
- River Quality Sampling Point
- Substantiated Pollution Incident Register
- Water Abstraction
- Water Industry Act Referral

### Waste

- BGS Recorded Landfill Site (Location)
- BGS Recorded Landfill Site
- EA Historic Landfill (Buffered Point)
- EA Historic Landfill (Polygon)
- Integrated Pollution Control Registered Waste Site
- Licensed Waste Management Facility (Landfill Boundary)
- Licensed Waste Management Facility (Location)
- Local Authority Recorded Landfill Site (Location)
- Local Authority Recorded Landfill Site
- Registered Landfill Site (Location)
- Registered Landfill Site (Point Buffered to 100m)
- Registered Landfill Site (Point Buffered to 250m)
- Registered Waste Transfer Site (Location)
- Registered Waste Transfer Site
- Registered Waste Treatment or Disposal Site (Location)
- Registered Waste Treatment or Disposal Site

### Geological

- BGS Recorded Mineral Site
- COMAH Site
- Explosive Site

### Industrial Land Use

- Contemporary Trade Directory Entry
- Fuel Station Entry
- NHHS Site
- Planning Hazardous Substance Consent
- Planning Hazardous Substance Enforcement

### Site Sensitivity Map - Slice A



### Order Details

Order Number: 59147264\_1\_1  
 Customer Ref: UK14.1639  
 National Grid Reference: 527380, 185770  
 Slice: A  
 Site Area (Ha): 0.05  
 Search Buffer (m): 1000

### Site Details

15a, Parliament Hill, London, NW3 2SY



Tel: 0844 844 9952  
 Fax: 0844 844 9951  
 Web: www.envirocheck.co.uk