

**Proposed Non - Material
Amendment refer to PA 022**

Scale: 1:100 @ A1 & 1:200 @ A3

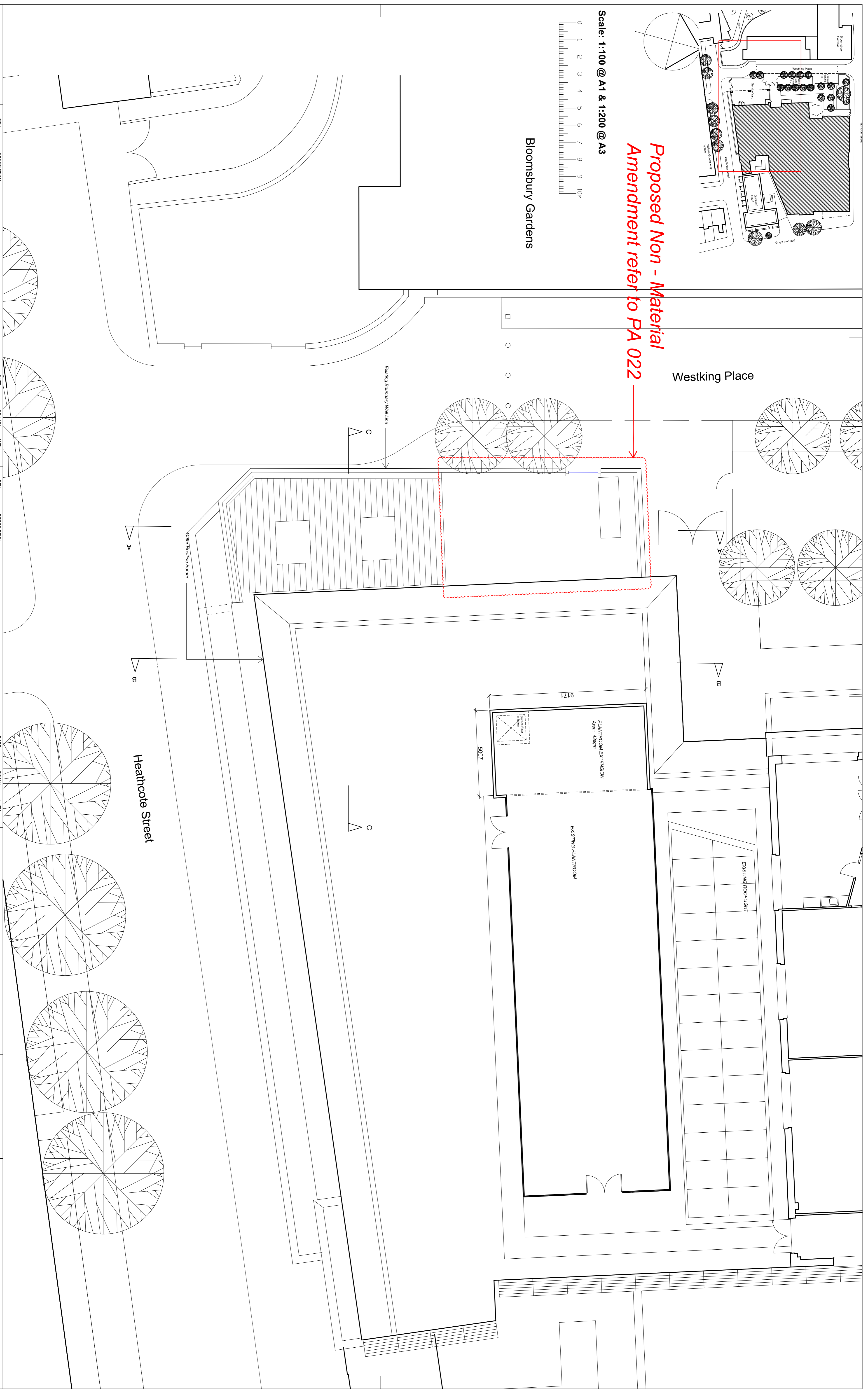

Bloomsbury Gardens



**Frederick Gibberd
Partnership**

117-121 Curtain Road
London EC2A 3AD
+44(0)20 7739 3400
+44(0)20 7739 3948
studio@gibberd.com
www.gibberd.com

REV	DESCRIPTION	DATE	DRAWN	AUTH
F2	Printer and callings amended	28.01.15	GR	IF
F3	Proposed Non-Material Amendments as Billed	03.03.15	EC	IF

REV	DESCRIPTION	DATE	DRAWN	AUTH

REV	DESCRIPTION	DATE	DRAWN	AUTH

© Copyright of the information is vested in Frederick Gibberd Partnership. For the avoidance of doubt, all dimensions are measured to wall structure and not finishes unless otherwise stated.

Gibberd
ARCHITECTURE
MASTER PLANNING
INTERIOR DESIGN
LANDSCAPE

Client: Westminster Kingsway College
Project: Kings Cross Extension

Title: Proposed Fourth Floor Plan

Project No: 2004	Date: 09.12.14	Scale: 1:100@A1 & 1:200@A3	Rev: P3
Drawing No: (PA) 024		Series: Planning	

Drawn: GR	Auth: IF	Stage: Planning
-----------	----------	-----------------