

Scale: 1:100 @ A1 & 1:200 @ A3

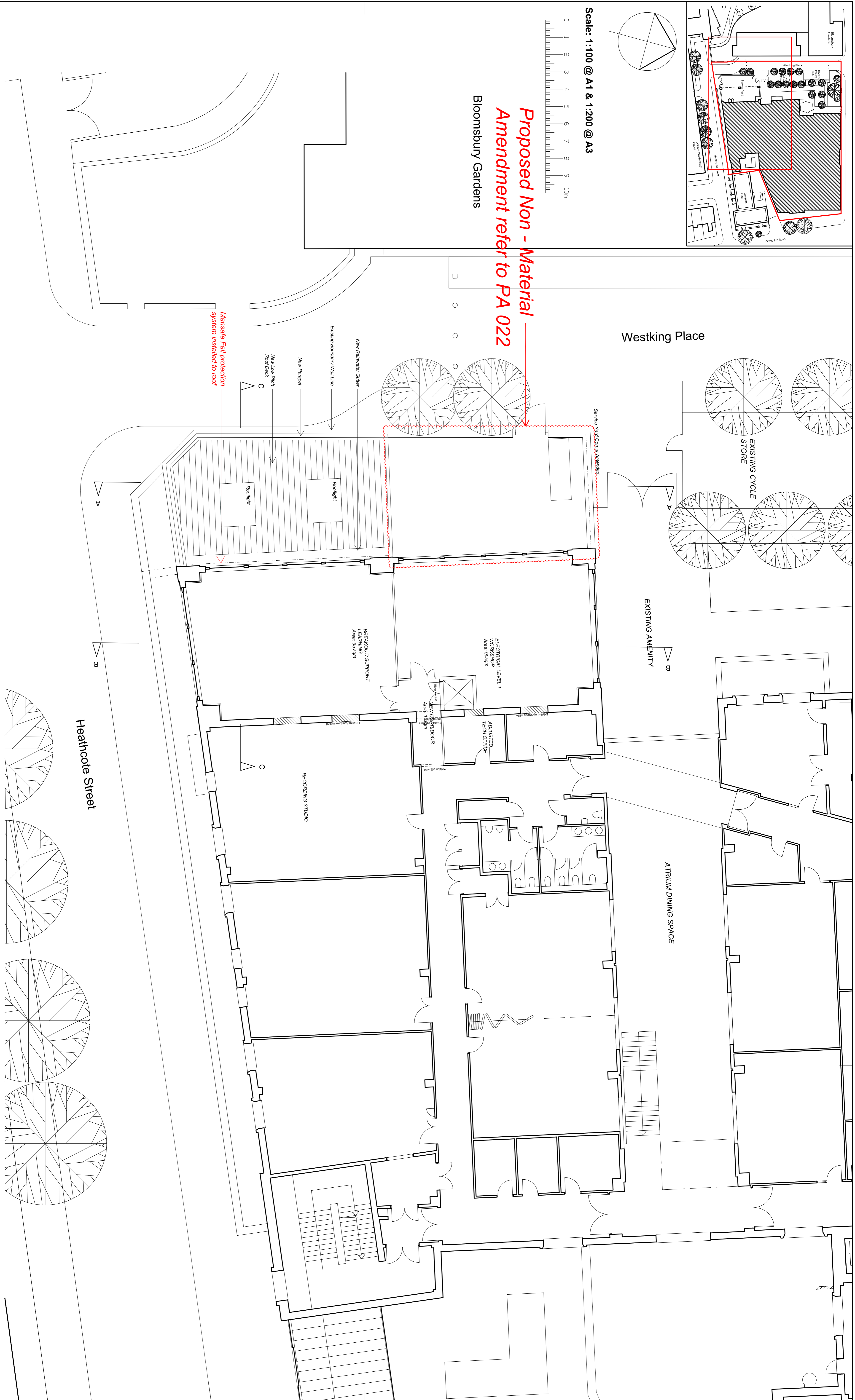

**Proposed Non - Material  
Amendment refer to PA 022**  
Bloomsbury Gardens



<b>Frederick Gibberd Partnership</b> 117-121 Curtain Road London EC2A 3AD +44(0)20 7739 3400 +44(0)20 7739 3948 studio@gibberd.com www.gibberd.com		REV: P2 DESCRIPTION: Plan and details amended DATE: 28.01.15 DRAWN: GR AUTH: F	REV: P3 DESCRIPTION: Proposed Non-Material Amendments as Billed DATE: 09.03.15 DRAWN: EC AUTH: F	© Copyright of the information is vested in Frederick Gibberd Partnership. For the avoidance of doubt, all dimensions are measured to wall structure and not finishes, unless otherwise stated.	<b>Gibberd</b> ARCHITECTURE MASTER PLANNING INTERIOR DESIGN LANDSCAPE	Client: Westminster Kingsway College Project: Kings Cross Extension Title: Proposed First Floor Plan Project No: 2004 Date: 09.12.14 Scale: 1:100@A1 & 1:200@A3 Drawing No: (PA) 023 Scale: 1:100@A1 & 1:200@A3 Rec: P3 Drawn: GR Auth: IF Status: Planning
--	--	--	--	---	---	--