

KEY  
Site Boundary

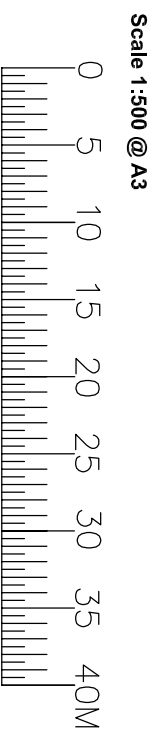
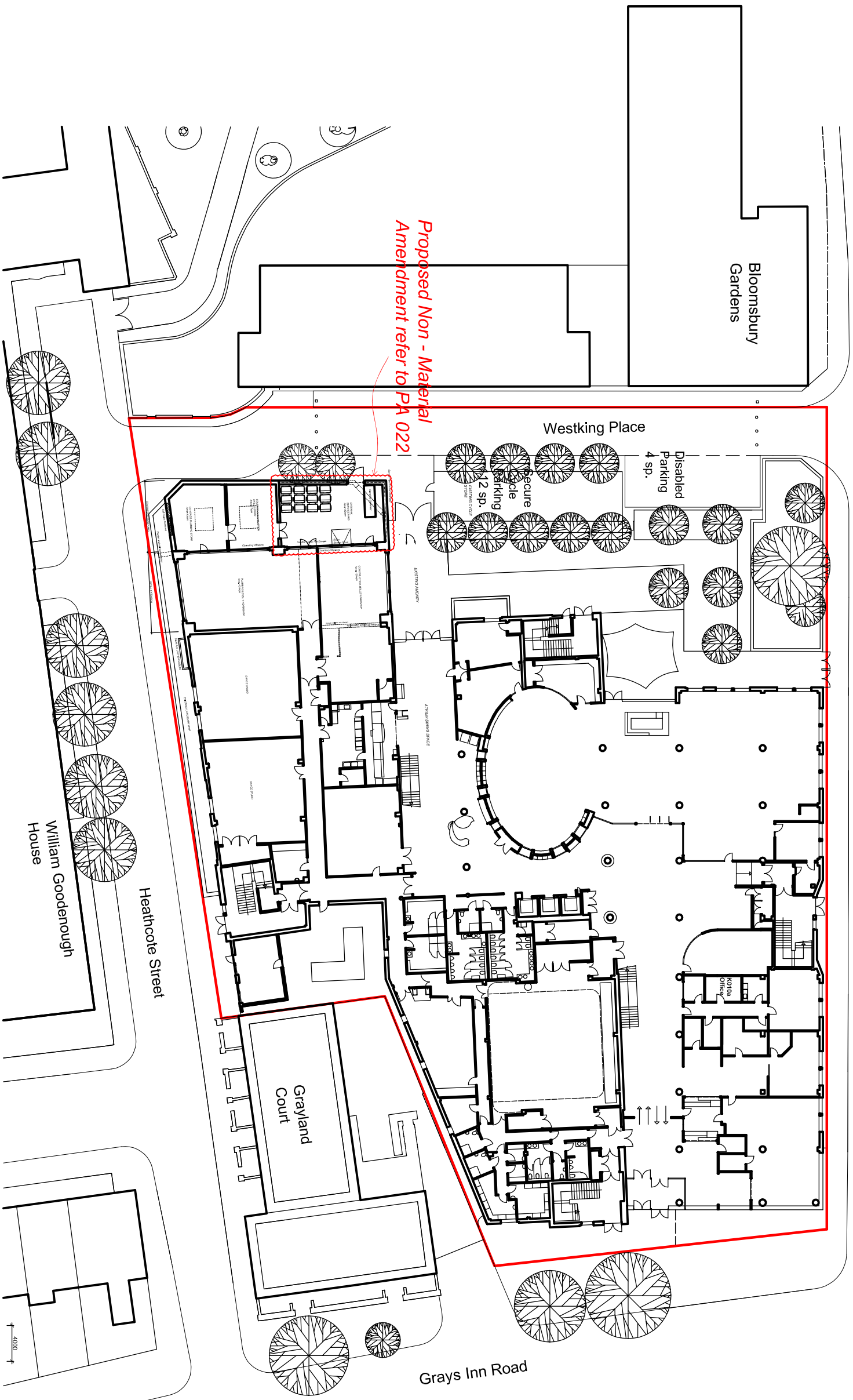

<b>Frederick Gibberd Partnership</b> 117-121 Ordain Road London EC2A 3AD +44(0)20 7739 3400 +44(0)20 7739 8948 studio@gibberd.com www.gibberd.com		REV: P2 P3 DESCRIPTION: Planes and fillings amended Proposed Non-Material Amendments as Bubbled	DATE: 28.01.15 09.03.15	DRAWN: GR ETC	AUTH: IF	REV: P2 P3 DESCRIPTION: Planes and fillings amended Proposed Non-Material Amendments as Bubbled	DATE: 28.01.15 09.03.15	DRAWN: GR ETC	AUTH: IF	© Copyright of the information is vested in Frederick Gibberd Partnership. For the avoidance of doubt, all dimensions are measured to wall structure and not finishes unless otherwise stated.	<b>Gibberd</b> ARCHITECTURE MASTER PLANNING INTERIOR DESIGN CONSERVATION LANDSCAPE	client: Westminster Kingsway College Project: Kings Cross Extension Title: Proposed Site Plan Project No: 2004 Date: 09.12.14 Drawing No: (PA) 020 Date: GR Author: IF	Scale: 1:500 @ A3 Series: Planning Rev: P3 Status: Planning
---	--	--	----------------------------	------------------	----------	--	----------------------------	------------------	----------	--	---	---	--