

GENERAL NOTES

NOTES

REFRIGERATION PIPEWORK

THE INDOOR AND OUTDOOR UNITS WILL BE INTERCONNECTED WITH REFRIGERATION QUALITY PIPEWORK FULLY ANNEALED AND INTERNALLY DEGREASED AND CLEANED TOGETHER WITH SILVER SOLDER FITTINGS.

THE INSTALLATION WILL ALSO BE FIXED TO CONTAINMENT TRAY WORK OR SYSTEM WITH RESILIENT CLIPS TO PREVENT VIBRATION TRANSMISSION AND TO ALLOW MOVEMENT OF PIPELINES.

PIPEWORK INSULATION

ALL PIPEWORK (SUCTION, DISCHARGE AND LIQUID) TO BE INSULATED WITH SLIP ON CLOSE CELL ELASTOMERIC PIPE INSULATION (AS MANUFACTURED BY ARMAFLEX OR EQUAL AND APPROVED), WITH A FIRE PERFORMANCE CLASS 'O' OF THE BUILDING REGULATIONS 1985, WITH A WALL OF THICKNESS OF NOT LESS THAN 13mm. INSULATION MUST BE PROTECTED WHEN EXPOSED TO ATMOSPHERE BY SPECIAL PAINT OR COVERED BY AN ENCLOSURE.

ALL INSULATION JOINTS, AFTER PRESSURE AND LEAK TESTING, ARE TO BE PROPERLY GLUED AND OR TAPED TO PROVIDE A COMPLETE SEAL TO PREVENT ANY CONDENSATION, AND SHOULD BE CLEARLY MARKED (YELLOW TAPE) FOR EASE OF IDENTIFICATION.

PIPEWORK PRESSURE TESTING AND REFRIGERANT CHARGING

AFTER INSTALLATION OF PIPEWORK, PRIOR TO CONNECTION TO THE CONDENSING UNITS, SEALING OF INSULATION JOINTS AND STARTING OF EQUIPMENT THE SYSTEM WILL BE PRESSURE TESTED USING OXYGEN FREE DRY NITROGEN FOR 24 HOURS AND CHECKED FOR LEAKS. CONDENSING UNITS WILL THEN BE CONNECTED AND THE SYSTEM VACUUMED/DEHYDRATED AND HELD AT THAT SETTING FOR 1 HOUR (MINIMUM) TO 4 HOURS DEPENDING ON PIPE LENGTH. ALL OF THE ABOVE WORKS WILL BE CARRIED OUT BEFORE ELECTRICAL CONNECTION IS MADE TO THE UNITS.

CONDENSATE DRAINAGE SYSTEM

A PIPEWORK SYSTEM FOR CONDENSATE REMOVAL FROM INTERNAL EVAPORATOR UNITS WILL BE PUMPED AND ROUTED TO CONNECT INTO THE NEAREST AVAILABLE COMMON CONDENSATE SYSTEM AND DISCHARGED BY GRAVITY TO THE NEAREST SVP VIA TRAP AND TUNDISH.

CONDENSATE PIPEWORK AND FITTINGS WILL BE COPPER PIPEWORK TO BS 2871 TABLE X.

B	15.01.15	REVISED OUTDOOR UNIT LOCATION	KHS
A	01.08.14	ISSUED FOR CONSTRUCTION	M.J.H
Rev	Date	Description	By

**ARTHUR MCKAY**  
ELECTRICAL | MECHANICAL | FM | NETWORKS  
BUILDING SUPPORT SERVICES GROUP

42, Dryden Road,  
Bilston Industrial Estate,  
Loanhead,  
Midlothian, EH20 9LZ.  
Tel : 0131 440 6000.  
Fax : 0131 440 6001.  
www.arthur-mckay.com.

Office Locations  
Edinburgh, London & Glasgow.

Client  
**LLOYDS BANKING GROUP**

Project  
**KILBURN HIGH ROAD  
LONDON**

Title  
**THIRD FLOOR / ROOF  
HEATING AND COOLING  
PROPOSED LAYOUT**

Drawing Status  
**CONSTRUCTION**

Designed by	M.J.H.	Date	JUL 14	Project No.	50450661
Drawn by	M.J.H.	Scales @ A1	1:50		

Drawing Number	50450661-ML01-03-2001	Rev	<b>B</b>
----------------	-----------------------	-----	----------

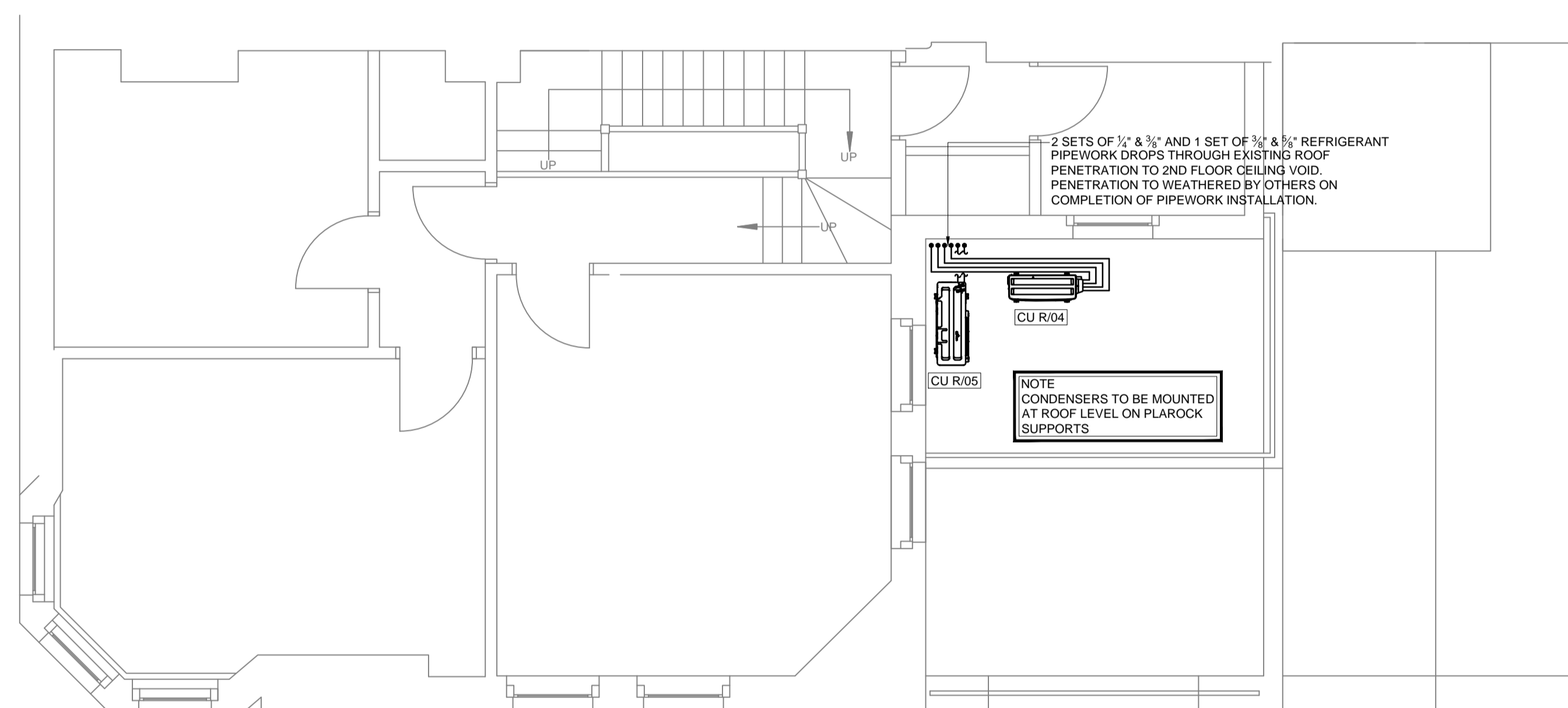

CONDENSER UNIT REF	CU R/04	
MANUFACTURER	DAIKIN	
CONNECTED INDOOR UNIT REF	FCU 1/01 & 02	
CONDENSER MODEL	2MXS40H	
CONNECTED INDOOR MODEL	FTXS20K	
ELECTRICAL DETAILS	POWER SUPPLY - (Ø, Hz, V)	1, 50, 230
	RUNNING CURRENT - (A)	5.20
	STARTING CURRENT - (A)	4.00
	FUSE RATING - (A)	16
UNIT DIMENSIONS	HEIGHT - (mm)	550
	WIDTH - (mm)	765
	DEPTH - (mm)	285
WEIGHT - (kg)		38
SOUND - (dBa)		47
PIPEWORK CONNS	LIQUID	2x 1/4"
	GAS	2x 3/8"
MAXIMUM LENGTH		30
MAXIMUM VERTICAL RISE		15

CONDENSER UNIT REF	CU R/05	
MANUFACTURER	DAIKIN	
CONNECTED INDOOR UNIT REF	FCU 2/01	
CONDENSER MODEL	RZQG100LBV1	
CONNECTED INDOOR MODEL	FAQ100C	
ELECTRICAL DETAILS	POWER SUPPLY - (Ø, Hz, V)	1, 50, 230
	RUNNING CURRENT - (A)	10.75
	STARTING CURRENT - (A)	4.00
	FUSE RATING - (A)	32
UNIT DIMENSIONS	HEIGHT - (mm)	1430
	WIDTH - (mm)	940
	DEPTH - (mm)	320
WEIGHT - (kg)		102
SOUND - (dBa)		50
PIPEWORK CONNS	LIQUID	3/8"
	GAS	5/8"
MAXIMUM LENGTH		75
MAXIMUM VERTICAL RISE		30