

100
0
10
Millimetres

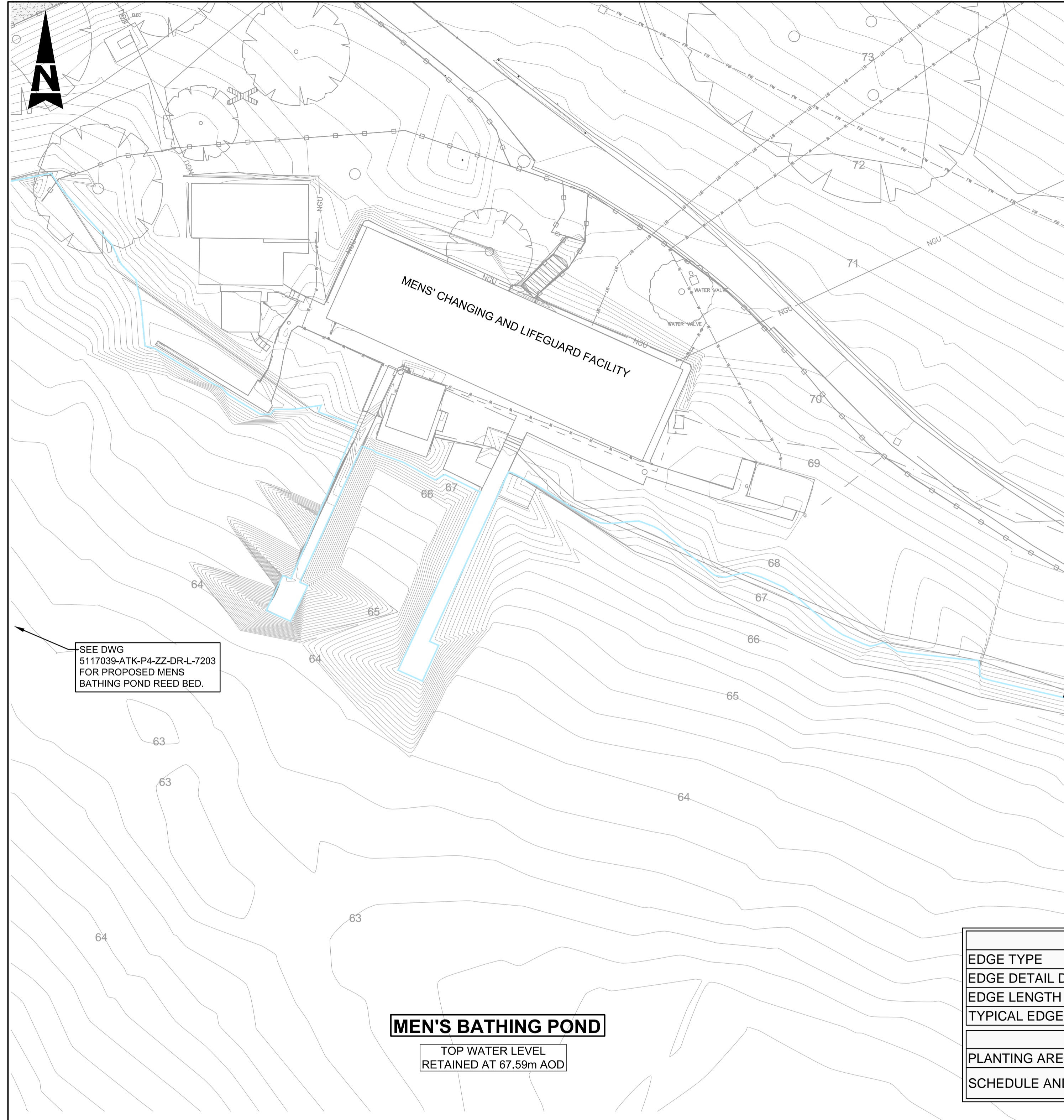

P5-4 PLANTING SCHEDULE (COIR PALLETS)

Area Code	Installation Type	Description	Species	Number of 2x1m Pallets
P5-4	SP2	Single species pallet	Carex acutiformis	10
	SP3	Single species pallet	Iris pseudacorus	4
	SP4	Single species pallet	Lythrum salicaria	2
	MP1	Mixed species pallet	Lythrum salicaria Lythrum salicaria Mentha aquatica Iris pseudacorus Caltha palustris	2
MP2	Mixed species pallet		Iris pseudacorus	2
			Lysimachia vulgaris	
			Lythrum salicaria	
			Mentha aquatica	
			Alisma plantago-aquatica	
MP3	Mixed species pallet		Lythrum salicaria	1
			Eupatorium cannabinum	
			Lysimachia vulgaris	
			Iris pseudacorus	
MP4	Mixed species pallet		Carex acutiformis	7
			Iris pseudacorus	

P5-4 COIR PALLET PLANTING ARRANGEMENT (TYPE 1 EDGE, BANK LENGTH = 28m)

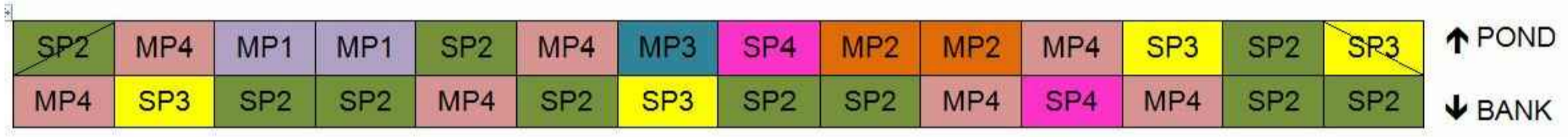

ENGINEERING DETAIL	
EDGE TYPE	TYPE 1
EDGE DETAIL DRAWING	ZZ-7250
EDGE LENGTH	16m
TYPICAL EDGE WIDTH	2m
PLANTING DETAIL	
PLANTING AREA CODE	P5-5
SCHEDULE AND ARRANGEMENT DRAWING	P5-7200

P5-5 PLANTING SCHEDULE (COIR PALLETS)

Area Code	Installation Type	Description	Species	Number of 2x1m Pallets	
P5-5	SP2	Single species pallet	Carex acutiformis	5	
	SP3	Single species pallet	Iris pseudacorus	1	
	SP4	Single species pallet	Lythrum salicaria	1	
	MP2	Mixed species pallet		Iris pseudacorus	2
				Lysimachia vulgaris	
Lythrum salicaria					
Mentha aquatica					
MP4	Mixed species pallet		Alisma plantago-aquatica	7	
			Juncus effusus		
			Carex acutiformis		
			Iris pseudacorus		

P5-5 COIR PALLET PLANTING ARRANGEMENT (TYPE 1 EDGE, BANK LENGTH = 16M)

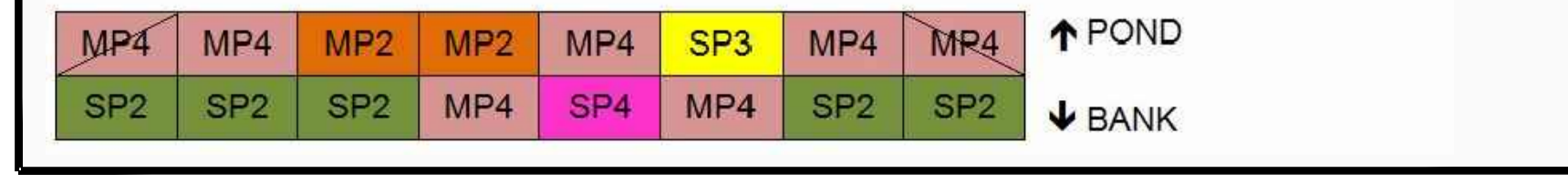

ENGINEERING DETAIL	
EDGE TYPE	TYPE 1
EDGE DETAIL DRAWING	ZZ-7250
EDGE LENGTH	28m
TYPICAL EDGE WIDTH	2m
PLANTING DETAIL	
PLANTING AREA CODE	P5-4
SCHEDULE AND ARRANGEMENT DRAWING	P5-7200

LOCATION KEY PLAN

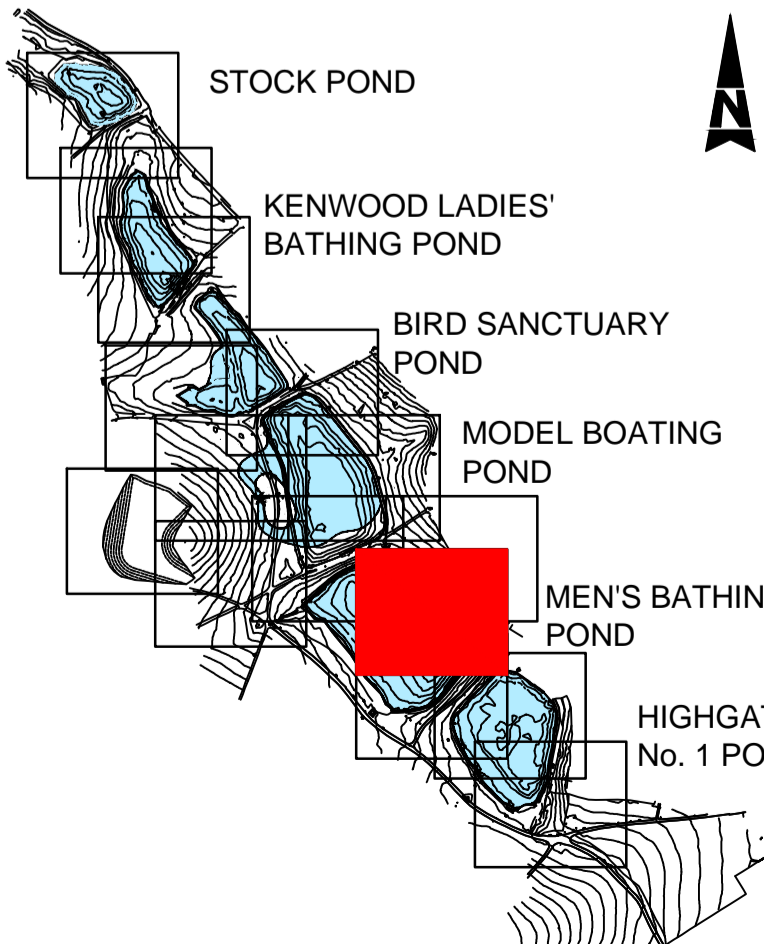

KEY:

- POND EDGE
- EXISTING POND VEGETATION
- PROPOSED POND PLANTING
- PROPOSED SHEET PILE EDGE
- 83 CONTOURS (m AOD)
- EXISTING FENCE / RAILING
- INDICATIVE LOCATION OF EXISTING TREES
- TEMPORARY WILDFOWL FENCING
- PERMANENT WETLAND FENCING
- POST AND CHESTNUT RAIL FENCE WITH MESH
- JAPANESE KNOTWEED
- GIANT HOGWEED
- HIMALAYAN BALSAM

2- DETAIL NUMBER OR ELEVATION, SECTION LETTER.
P5-7201 SHORTENED DRAWING NUMBER REFERENCE (5117039-ATK-P5-ZZ-DR-L-7201).

- NOTES:**
- ALL MEASUREMENTS IN MILLIMETRES UNLESS OTHERWISE STATED AND LEVELS IN METRES TO ABOVE ORDNANCE DATUM (AOD).
 - APPROXIMATE LOCATIONS OF JAPANESE KNOTWEED, HIMALAYAN BALSAM AND GIANT HOGWEED AS IDENTIFIED IN 2013 ARE SHOWN. FURTHER AREAS MAY BE ENCOUNTERED ON SITE.
 - TREES ON EDGE OF WORKS TO BE RETAINED AND PROTECTED IN ACCORDANCE WITH BRITISH STANDARDS (BS) 5837 WHERE SITE WORKS ALLOW.
 - THIS DRAWING IS TO BE READ IN CONJUNCTION WITH THE ARBORICULTURAL DRAWINGS, 5117039-ATK-2000 SERIES & ARBORICULTURAL METHOD STATEMENT 5117039-ATK-XZZ-SP-L-005.
 - THIS DRAWING TO BE READ IN CONJUNCTION WITH LANDSCAPE DRAWINGS 5117039-ATK 7100, 7300 & 7500 SERIES.
 - THIS DRAWING TO BE READ IN CONJUNCTION WITH M&E DRAWINGS 5117039-ATK 7000 SERIES.
 - THIS DRAWING TO BE READ IN CONJUNCTION WITH ENGINEERING DRAWINGS 5117039-ATK 0000 AND 1000 SERIES.
 - THIS DRAWING TO BE READ IN CONJUNCTION WITH BUILDING SERVICES DRAWINGS 5117039-ATK 8000 SERIES.
 - REFER TO STANDARD POND AND POND SPECIFIC DETAIL DRAWINGS 5117039-ATK 7250 SERIES.
 - POND EDGE LEVELS VARY, AS DO DEPTHS OF SEDIMENT AND DEPTHS TO SOFT AND HARD BED.
 - TYPICAL TOP WATER LEVELS ARE SHOWN ON THE DRAWINGS.
 - SEE SPECIFICATION APPENDIX ON POND RESTORATION AND PLANTING FOR FURTHER INFORMATION ON MATERIALS, DESIGN, PLANT AND PLANTING REQUIREMENT.
 - ALL PLANTING ARRANGEMENTS REFER TO 2m x 1m AREAS AS INDIVIDUAL BLOCKS. THE TOP ROW REPRESENTS THE POND WARD PLANTING, WHILST THE BOTTOM ROW REPRESENTS THE BANK EDGE PLANTING. ALL ARRANGEMENT ARE ORIENTED LOOKING FROM THE BANK INTO THE POND.
 - FENCING TO BE INSTALLED TO ENCLOSE ALL NEWLY PLANTED MARGINAL AREAS SEE DWG 5117039-ATK-ZZ-DR-L-7251. TYPE 2 FENCE VARIANT TO BE USED ON ALL TEMPORARY SPILLWAY FENCING.
 - WETLAND PLANTING SHOULD NOT BE INSTALLED DURING PERIODS WHERE LEVELS ARE RISING RAPIDLY ABOVE TOP WATER LEVEL.

SAFETY, HEALTH AND ENVIRONMENTAL INFORMATION

In addition to the hazards/risks normally associated with the types of work detailed on this drawing, note the following:

CONSTRUCTION

- POND WATER LEVEL MAY RISE RAPIDLY DURING AND AFTER RAINFALL
- WATER LEVELS MAY RISE RAPIDLY DURING OR AFTER RAINFALL IN THE EXISTING CHANNEL OR NEW REED BED DRAINING TO THE NORTH-EAST OF MEN'S BATHING POND.
- TYPE 1 PLANTING AREAS REQUIRING SILT FILL WILL BE SOFT UNDER FOOT.
- DEEP WATER >1M, COMBINED WITH SOFT POND BED SEDIMENTS, ARE LIKELY TO BE ENCOUNTERED IN PROXIMITY TO WORKING AREA REQUIRED TO CREATE THE WETLAND PLANTING FEATURES.
- NON-NATIVE INVASIVE CRAWFISH ARE KNOWN TO BE PRESENT. APPROPRIATE CHECK AND CONTROL PROCEDURES TO PREVENT THEIR SPREAD ARE REQUIRED.

MAINTENANCE/CLEANING

- TYPE 1 PLANTING AREAS MAY BE SOFT UNDER FOOT.
- CARE SHOULD BE TAKEN NOT TO DAMAGE WETLAND PLANTING WHILST UNDERTAKING ROUTINE MAINTENANCE E.G. WEEDING OF DELETERIOUS SPECIES AND LITTER REMOVAL.
- SILT DISPOSAL FROM BEHIND CHECK DAMS AND THE NEW REED BED SHOULD BE TO AREAS WHERE THE RISK OF INGRESS TO PONDS/STREAMS AND HARM TO THE LOCAL ENVIRONMENT IS REDUCED.

DECOMMISSIONING/DEMOLITION

- TYPE 1 PLANTING AREAS MAY BE SOFT UNDER FOOT.
- CARE SHOULD BE TAKEN NOT TO DAMAGE ANY PLANTS WHEN REMOVING TEMPORARY FENCING.
- OPTIONS FOR THE REUSE OF TEMPORARY FENCING MATERIALS ELSEWHERE ON SITE SHOULD BE EXPLORED.

It is assumed that all works will be carried out by a competent contractor working, where appropriate, to an approved method statement

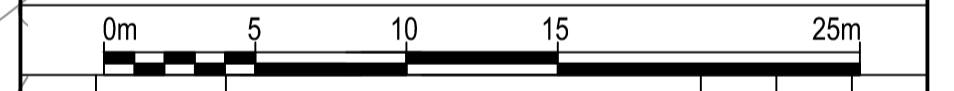

Rev.	Date	Description	By	Chk'd	App'd
C1	13/02/2014	FOR CONSTRUCTION	JK	IPM	MJV
P2	21/10/2014	FOR COSTING, ISSUED SUBJECT TO FINAL REVIEW BY PANEL ENGINEER	IF	IMMV	MW
P1	01/10/2014	FOR COSTING	IF	IMMV	MW

FOR CONSTRUCTION

ATKINS

Woodcote Grove
Ashley Road
Epsom
Surrey
KT18 5BW

Tel: +44 (0)1372 726140
Fax: +44 (0)1372 740055
www.atkinsglobal.com

Copyright © Atkins Limited (2013)

Client
City of London Corporation

Project Title
HAMPSTEAD HEATH PONDS PROJECT

Drawing Title
HIGHGATE MEN'S BATHING POND RESTORATION GENERAL ARRANGEMENT SHEET 1 OF 2

Scale	Designed	Drawn	Checked	Authorised
1:250	IM	IF	IM	MW
Original Size	Date	Date	Date	Date
A1	03/09/14	03/09/14	03/09/14	03/09/14
Drawing Number	Revision			
5117039-ATK-P5-ZZ-DR-L-7200	C1			