

100
0 10
Millimetres

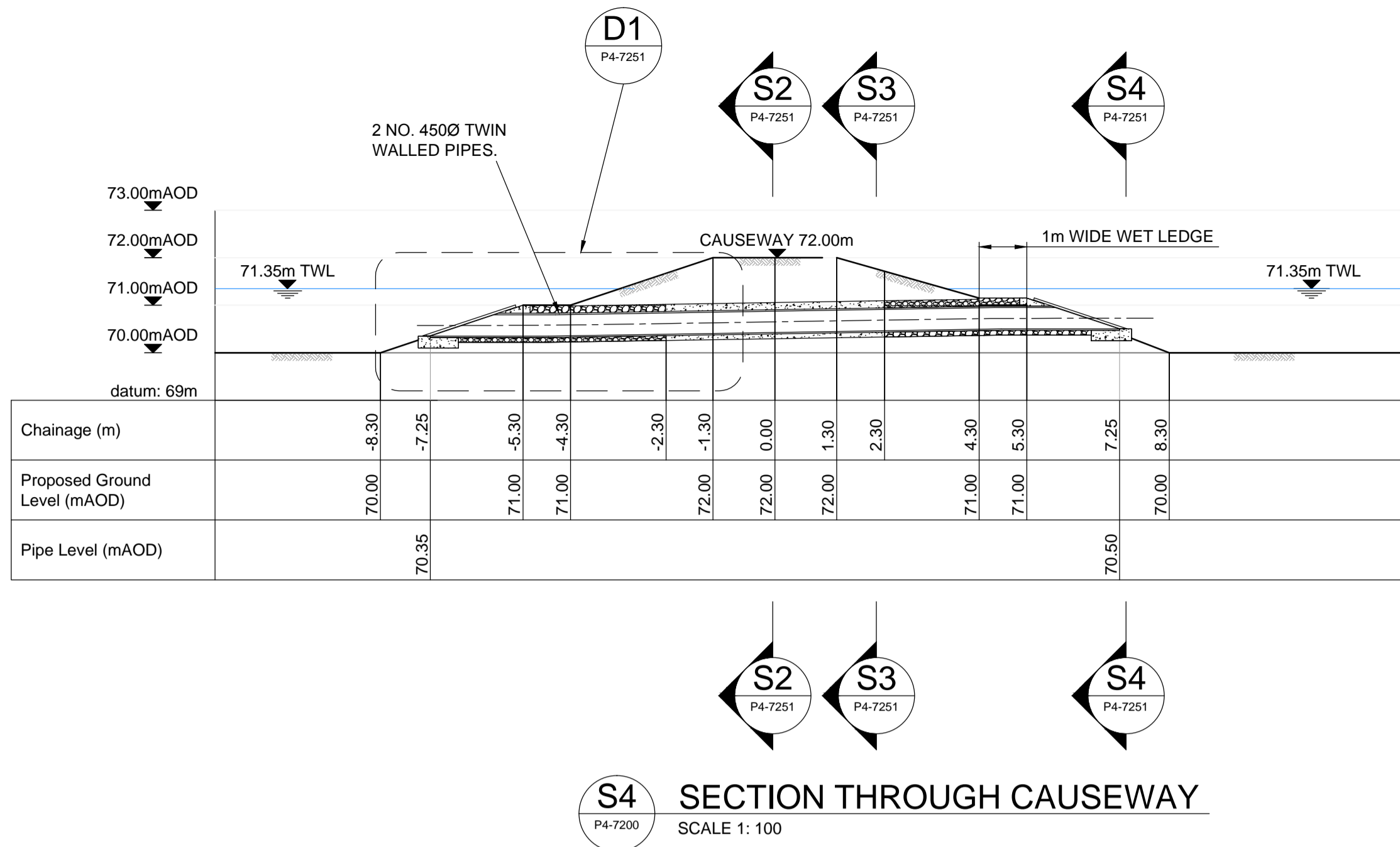

S4 SECTION THROUGH CAUSEWAY
SCALE 1: 100

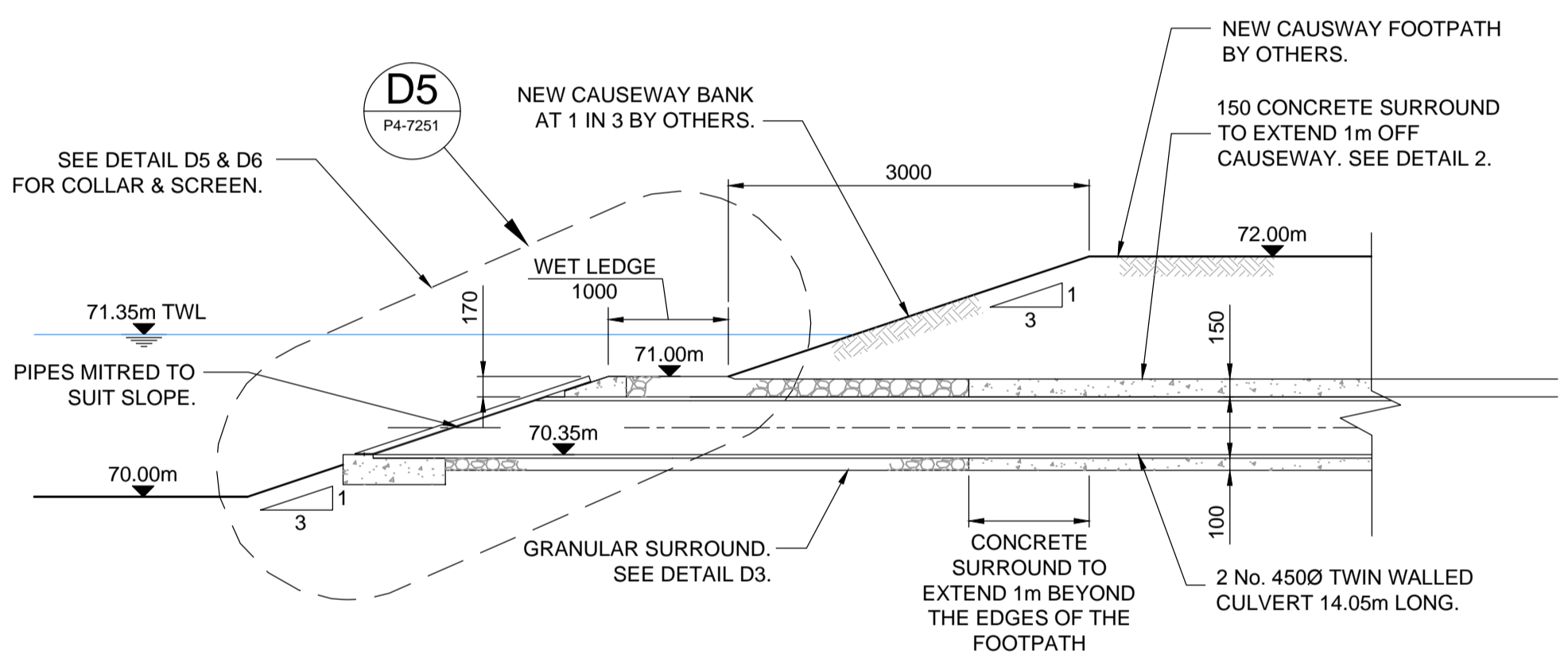

D1 DETAIL OF CULVERT
SCALE 1: 50

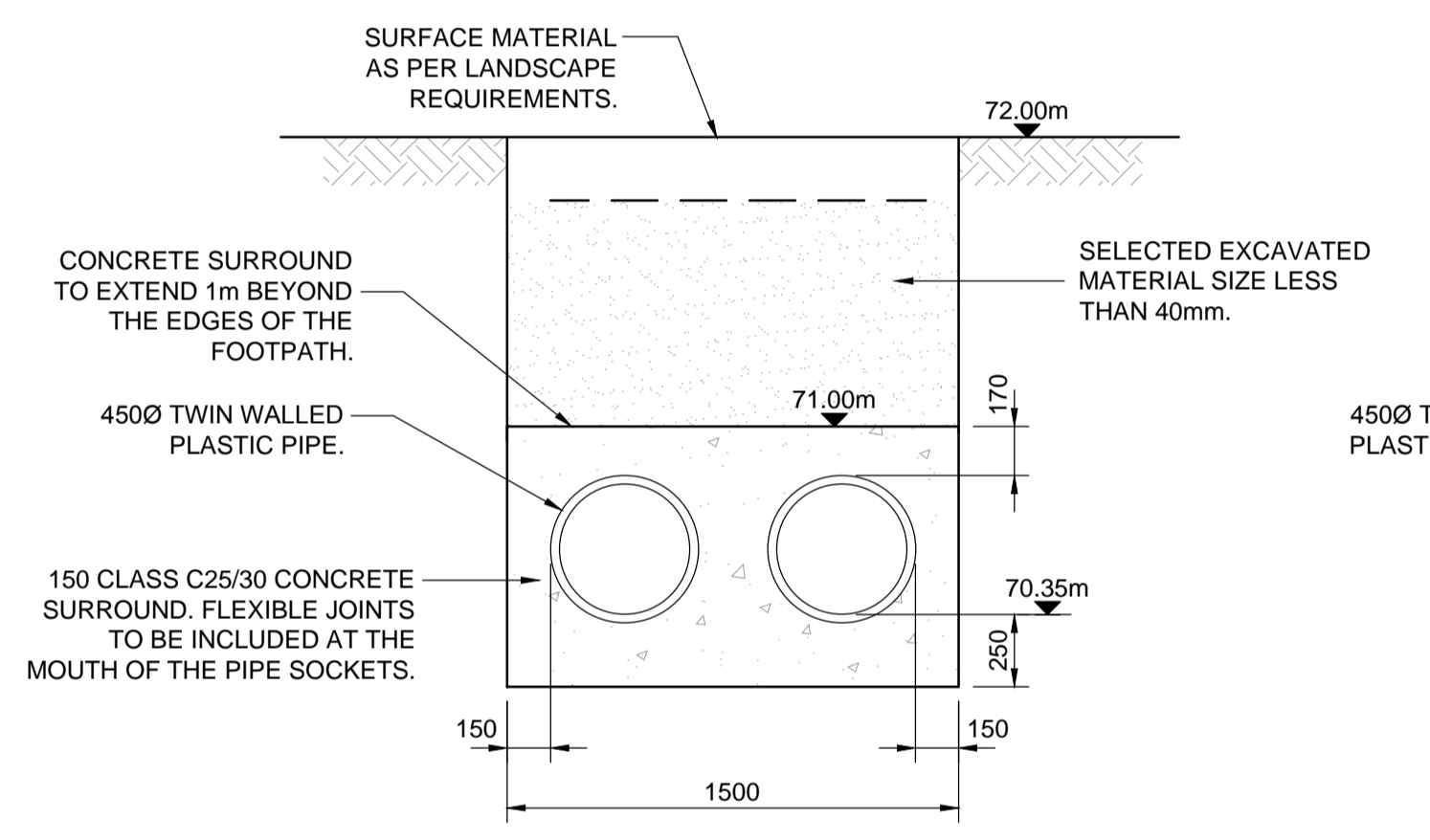

S2 SECTION THROUGH CAUSEWAY ACCESS
SCALE 1: 25

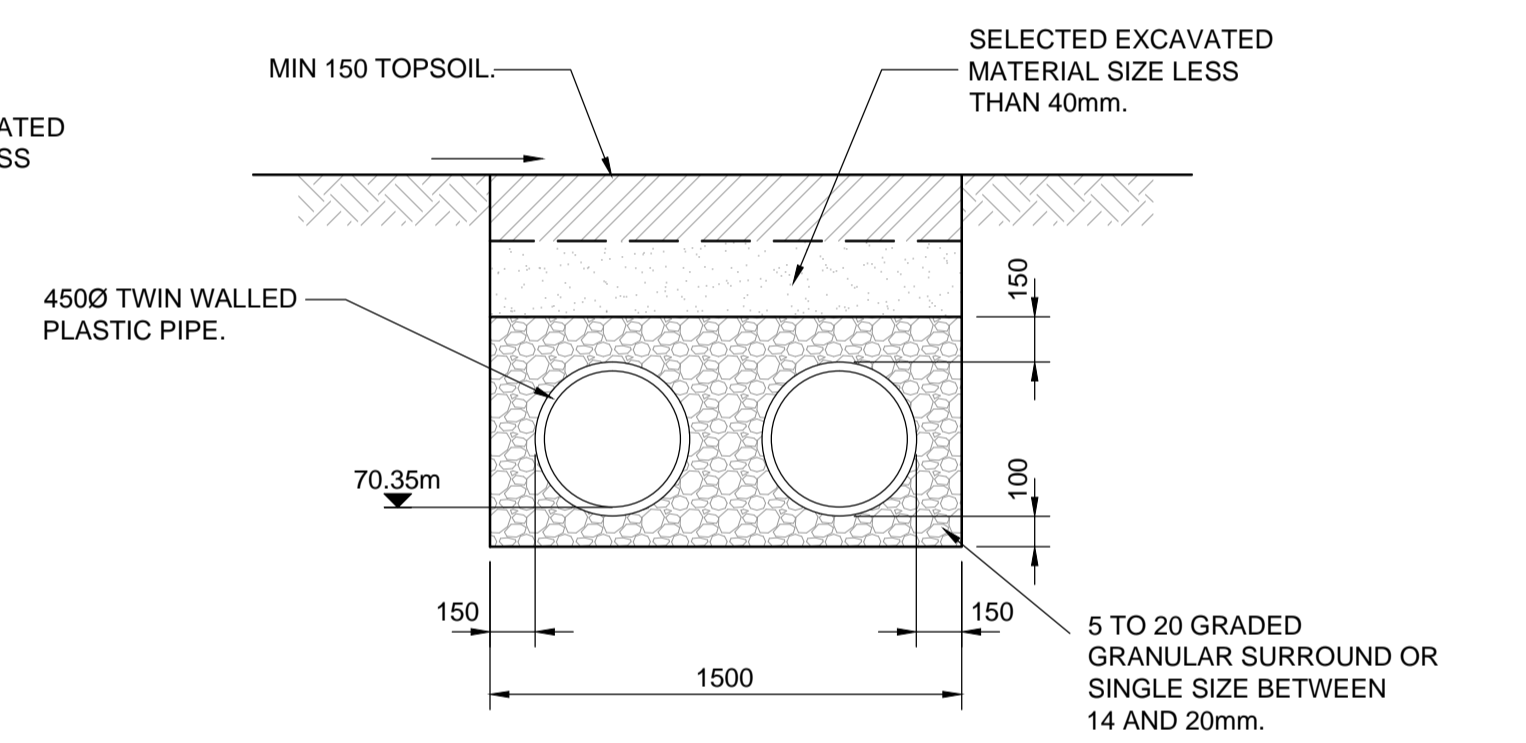

S3 SECTION THROUGH CAUSEWAY BANK
SCALE 1: 25

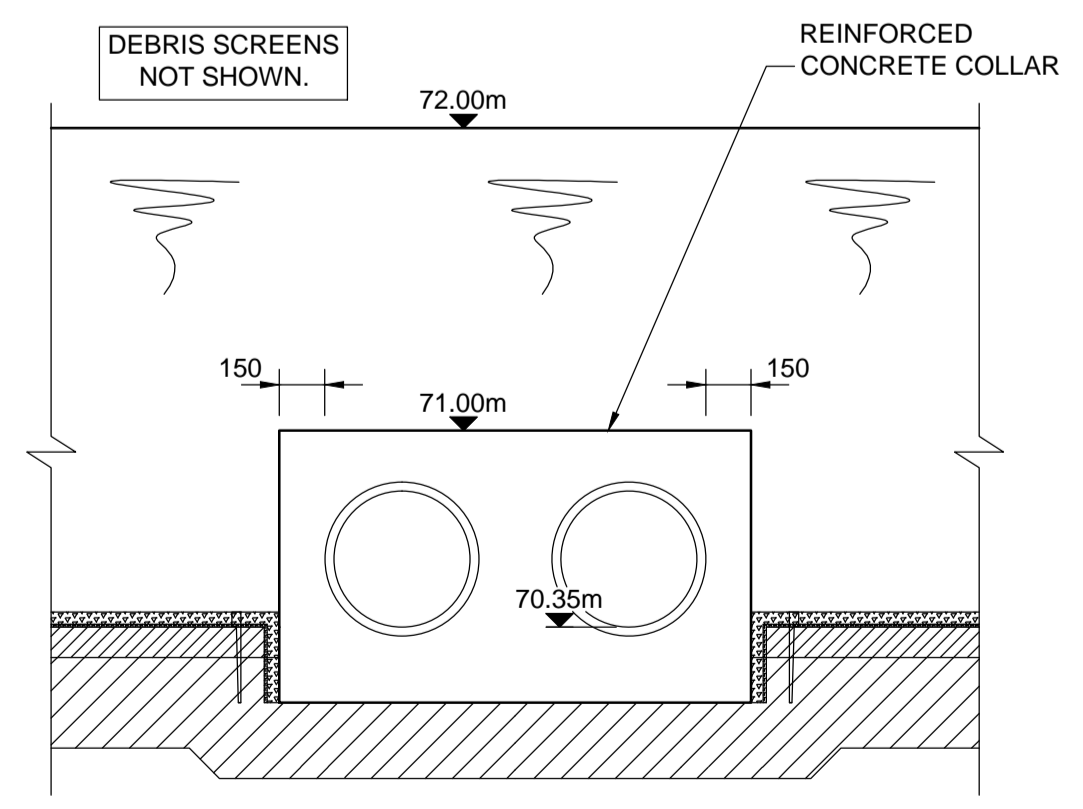

S4 SECTIONAL ELEVATION ON CAUSEWAY ACCESS
SCALE 1: 25

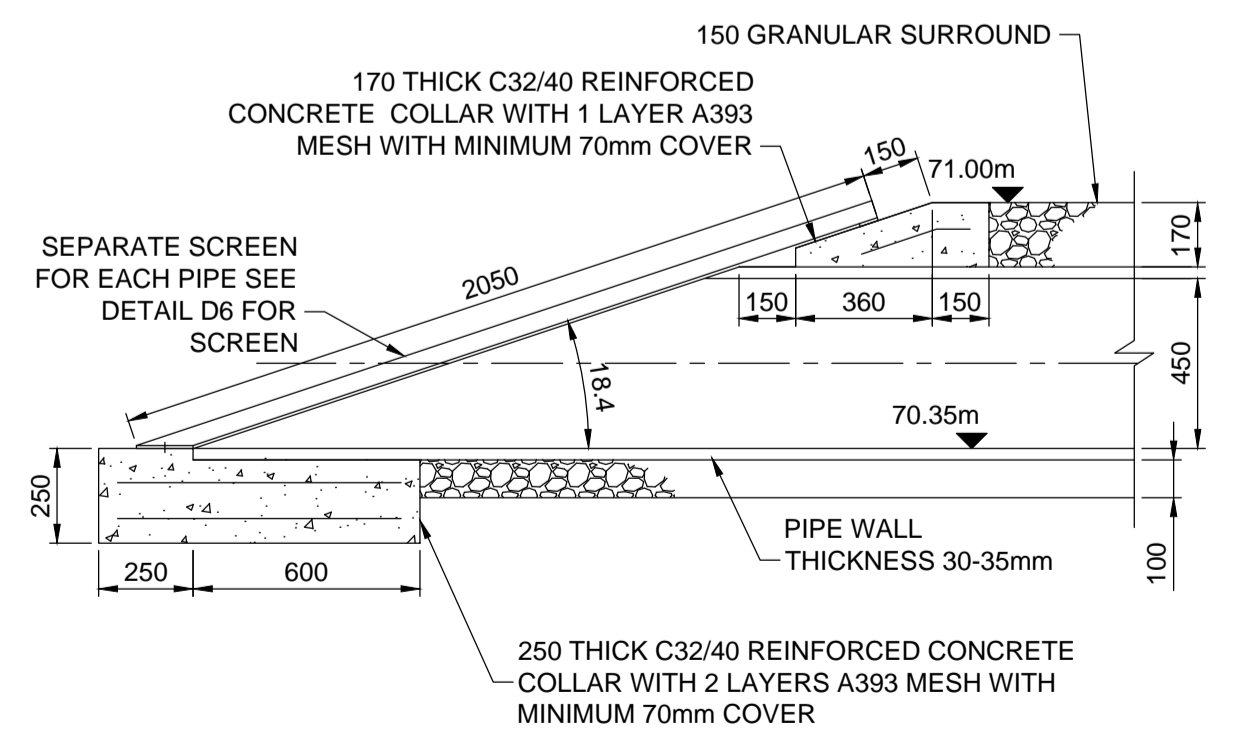

D5 DETAIL OF CONCRETE COLLAR
SCALE 1: 20

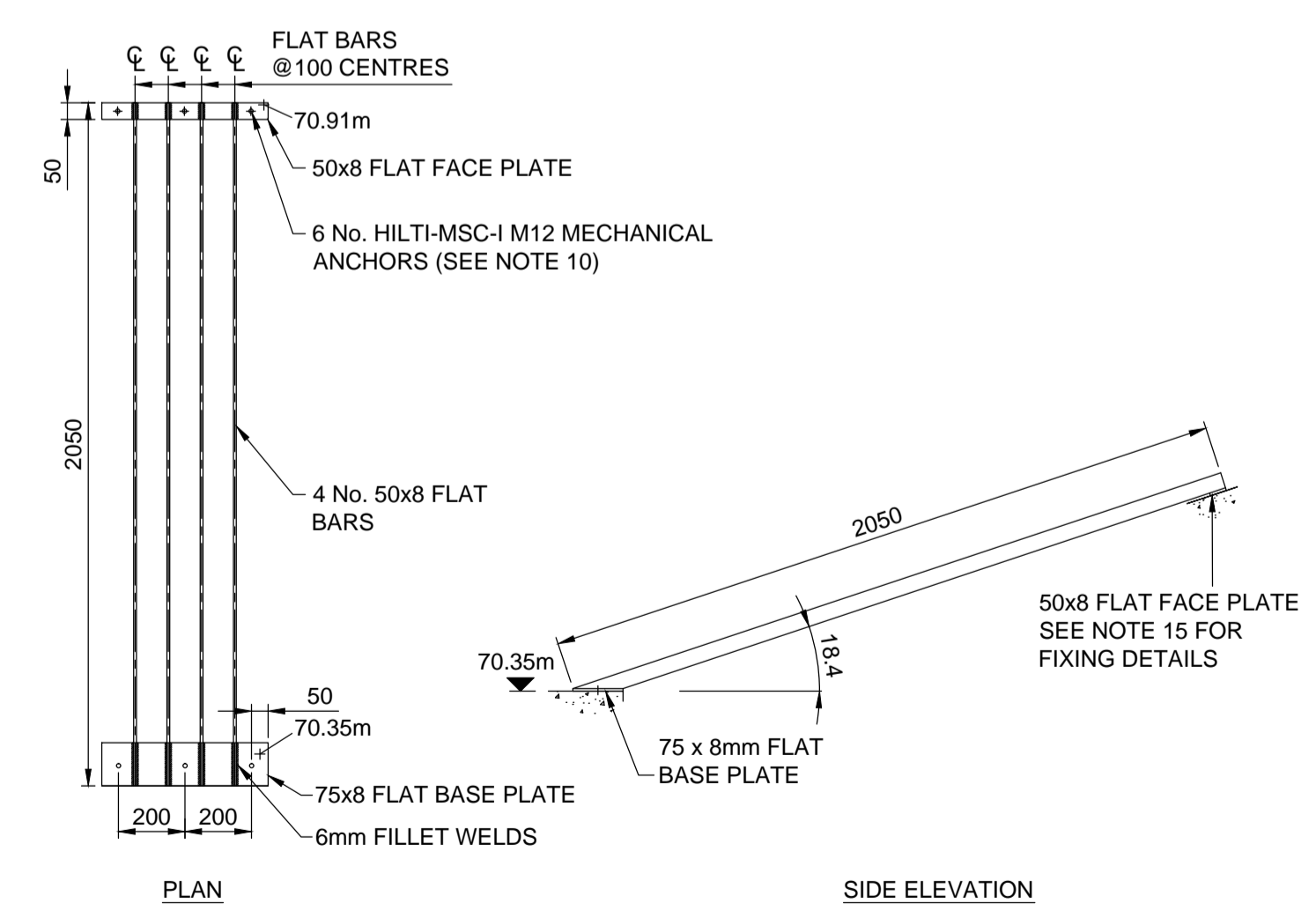

D6 DETAIL OF DEBRIS SCREEN
SCALE 1: 20

SAFETY, HEALTH AND ENVIRONMENTAL INFORMATION

In addition to the hazards/risks normally associated with the types of work detailed on this drawing, note the following:

CONSTRUCTION

MAINTENANCE/CLEANING

DECOMMISSIONING/DEMOLITION

It is assumed that all works will be carried out by a competent contractor working, where appropriate, to an approved method statement

NOTES

- ALL MEASUREMENTS IN MILLIMETRES AND LEVELS IN mAOD UNLESS OTHERWISE STATED.
- REFER TO 5117039-ATK-P3-ZZ-DR-L-7200 FOR SECTION LOCATIONS.
- REFER TO SPECIFICATION FOR DETAILS ON BIOENGINEERING PRODUCTS AND INSTALLATION APPROACHES.
- A PIPE JOINT SHALL BE PLACED AS CLOSE AS POSSIBLE (WITHIN 400mm) TO THE BACK FACE OF THE CONCRETE COLLAR & SHALL CONNECT TO A 600mm ROCKER PIPE. TO ALLOW FOR SETTLEMENT AND MOVEMENT OF PIPEWORK.
- STRUCTURAL STEELWORK SHALL BE TO GRADE S275 UNLESS STATED OTHERWISE.
- ALL STEEL FABRICATION SHALL BE CARRIED OUT TO THE TOLERANCES STATED ON THE DRAWING.
- ALL STEEL COMPONENTS SHALL BE HOT DIPPED GALVANISED MILD STEEL UNLESS STATED OTHERWISE.
- THE EDGES OF ALL HOLES, PLATES, BARS AND OTHER SECTIONS TO BE GALVANISED SHALL BE ROUNDED TO A MINIMUM RADIUS OF 2mm.
- ALL AREAS OF METAL TO METAL CONTACT SHALL BE GREASED BEFORE INSTALLATION.
- ALL WELDS SHALL BE CONTINUOUS 6mm FILLET WELDS UNLESS STATED OTHERWISE.
- ALL CONCRETE FIXINGS SHALL BE GALVANISED INTERNALLY THREADED MECHANICAL ANCHORS WITH INTERNAL THREAD. EFFECTIVE IMBEDDED DEPTH SHALL BE 60mm.
- ALL EXPOSED CONCRETE FACES SHALL HAVE CLASS A F4 FINISH.

2- DETAIL NUMBER OR ELEVATION, SECTION LETTER.
P3-7251 - SHORTENED DRAWING NUMBER REFERENCE (5117039-ATK-P3-ZZ-DR-L-7501).

C1	13/12/2014	FOR CONSTRUCTION	JEK	IPM	MJV
P2	24.10.14	FOR COSTING, ISSUED SUBJECT TO FINAL REVIEW BY PANEL ENGINEER	-	-	-
P1.1	19/9/2014	WORK IN PROGRESS	GJB	-	-

FOR CONSTRUCTION **A**

ATKINS
Woodcote Grove
Ashley Road
Epsom
Surrey
KT18 5BW
Tel: +44 (0)1372 726140
Fax: +44 (0)1372 740055
Copyright © Atkins Limited (2013) www.atkinsglobal.com

Client
City of London Corporation

Project Title
HAMPSTEAD HEATH PONDS PROJECT

Drawing Title
MODEL BOATING POND RESTORATION TYPICAL DETAILS SHEET 2 OF 2

Scale	Designed	Drawn	Checked	Authorised
AS SHOWN	MJV	JEK	IPM	MJV
Original Size	Date	Date	Date	Date
A1	13/02/15	13/02/15	13/02/15	13/02/15
Drawing Number	Revision			
5117039-ATK-P4-ZZ-DR-L-7251	C1			