

100
0 10
millimetres

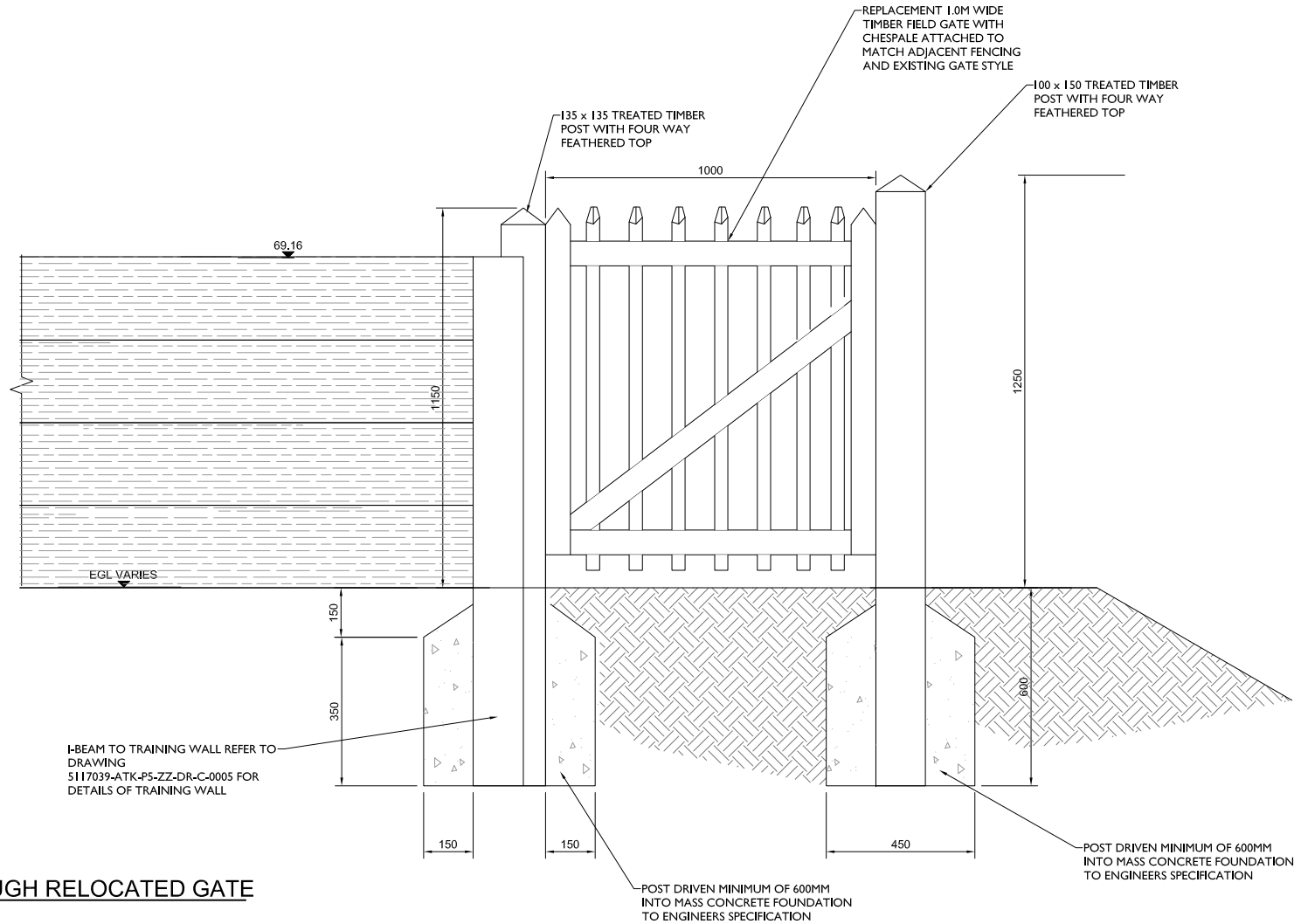

A-A SECTIONAL ELEVATION THROUGH RELOCATED GATE
SCALE 1: 10

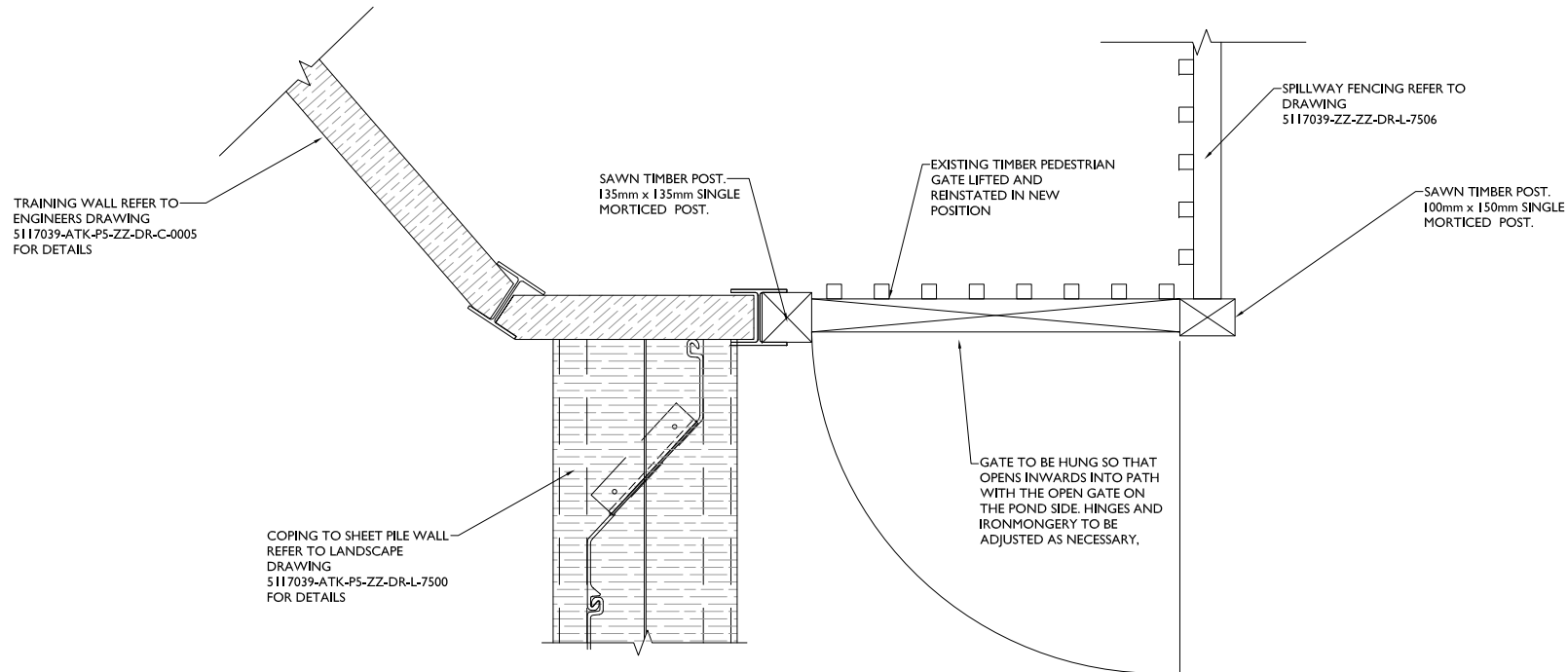

1 PLAN - RELOCATED GATE
SCALE 1: 10

SAFETY, HEALTH AND ENVIRONMENTAL INFORMATION

In addition to the hazards/risks normally associated with the types of work detailed on this drawing, note the following:

CONSTRUCTION

MAINTENANCE/CLEANING

DECOMMISSIONING/DEMOLITION

It is assumed that all works will be carried out by a competent contractor working, where appropriate, to an approved method statement

NOTES

1. ALL DIMENSIONS ARE IN MILLIMETRES.
2. EXCAVATION TO BE EXTENDED TO SOUND MATERIAL IF DIRECTED BY THE ENGINEER TO BE BACKFILLED WITH TYPE 1 SUB-BASE MATERIAL.
3. HERBICIDE SUITABLE FOR USE NEXT TO WATERWAYS TO BE APPLIED EVENLY ON FORMATION AREAS OF PAVED AREAS. IT SHALL BE NON-POISONOUS TO HUMAN BEINGS, ANIMALS AND INSECTS.
4. ALL TIMBER TO BE OAK, F.S.C CERTIFIED.
5. ALL NUTS, BOLTS AND WASHERS AND STRUCTURAL STEEL TO BE GALVANISED.

Rev.	Date	Description	By	Check'd	App'd
C1	20/02/2015	FOR CONSTRUCTION	IF	AW	LB

FOR CONSTRUCTION **A**

ATKINS Woodcote Grove
Ashley Road
Epsom
Surrey
KT18 5BW
Tel: +44 (0)1372 726140
Fax: +44 (0)1372 740055
www.atkinsglobal.com

Copyright © Atkins Limited (2013)

Client
City of London Corporation

Project Title
HAMPSTEAD HEATH PONDS PROJECT

Drawing Title
**MENS BATHING POND
LANDSCAPE AND EDGE
HARD LANDSCAPE DETAILS - GATE
SHEET 1 OF 1**

Scale	Designed	Drawn	Checked	Authorised
1:10	AW	IF	AW	LB
Original Size	Date	Date	Date	Date
A1	13/02/2015	13/02/2015	13/02/2015	13/02/2015

Drawing Number	Revision
5117039-ATK-P5-ZZ-DR-L-7501	C1