

**In addition to the hazards/risks normally associated with the use of the equipment, detail the following:**

detailed on this drawing, note the following:

It is assumed that all works will be carried out by a competent contractor working, where appropriate, to an approved method statement

1. ALL DIMENSIONS ARE IN MILLIMETRES.
2. EXCAVATION TO BE EXTENDED TO SOUND MATERIAL IF DIRECTED BY THE ENGINEER TO BE BACKFILLED WITH TYPE 3 SUPERSE MATERIAL.
3. HERBICIDE SUITABLE FOR USE NEXT TO WATERWAYS TO BE APPLIED EVENTUALLY TO FORMATION AREAS OF PAVED AREAS, IT SHALL BE NON-POISONOUS TO HUMAN BEINGS, ANIMALS AND INSECTS.
4. ALL TIMBER TO BE OAK, F.S.C CERTIFIED.
5. ALL NUTS, BOLTS AND WASHERS AND STRUCTURAL STEEL TO BE GALVANISED.

Rev.	Date	Description	By	Check	Appr.
C2	26/02/2015	FOR DISCARD OF PLANNING CONDITIONS	IF	AW	LE
C1	20/02/2015	FOR CONSTRUCTION	IF	AW	LE
P2	31/10/2014	FOR COSTING	IF	AW	LE
P1	19/09/2014	FOR COSTING	IF	AW	LE

**ATKINS**

Woodcote Grove  
Ashley Road  
Epsom  
Surrey  
KT18 5BW

Tel: +44 (0)1372 726140  
Fax: +44 (0)1372 740055  
[www.atkinsglobal.com](http://www.atkinsglobal.com)

Copyright © Atkins Limited (2013)

1

Scale	Designed	Drawn	Checked	Authorised
1:10	AW	IF	AW	LB
Original Size A1	Date 16/09/2014	Date 16/09/2014	Date 16/09/2014	Date 16/09/2014

---

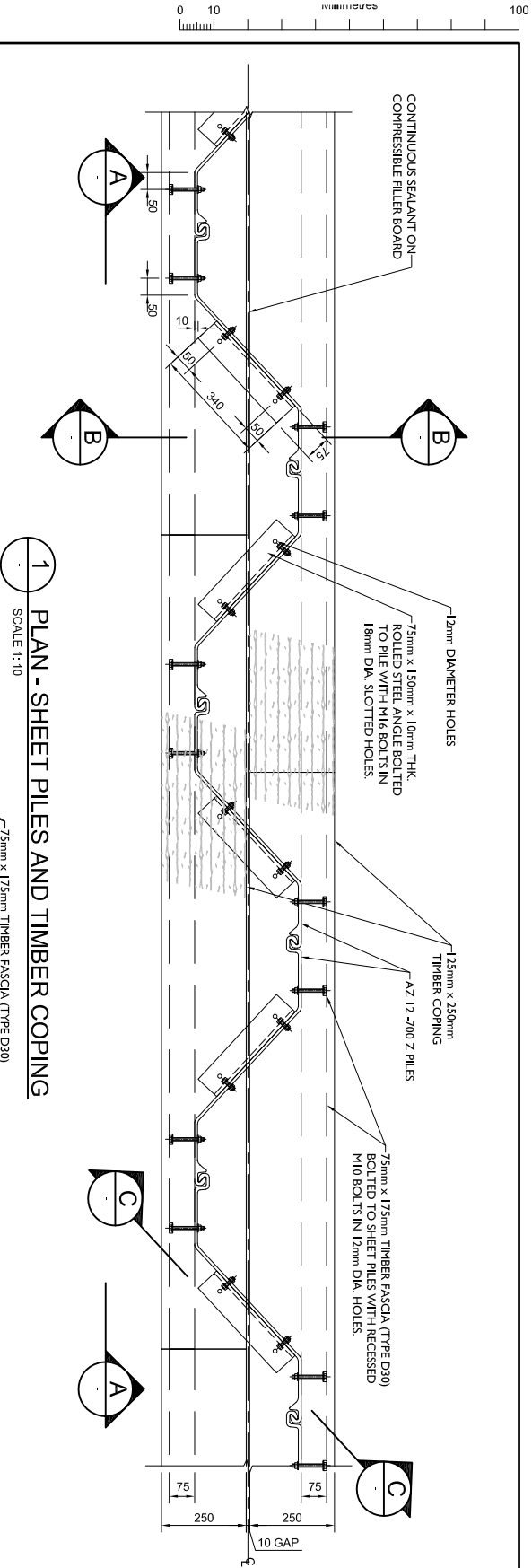
C2

1 PLAN - SHEET PILES AND TIMBER COPING  
SCALE 1:10  
75mm x 175mm TIMBER FASCIA (TYPE D30)

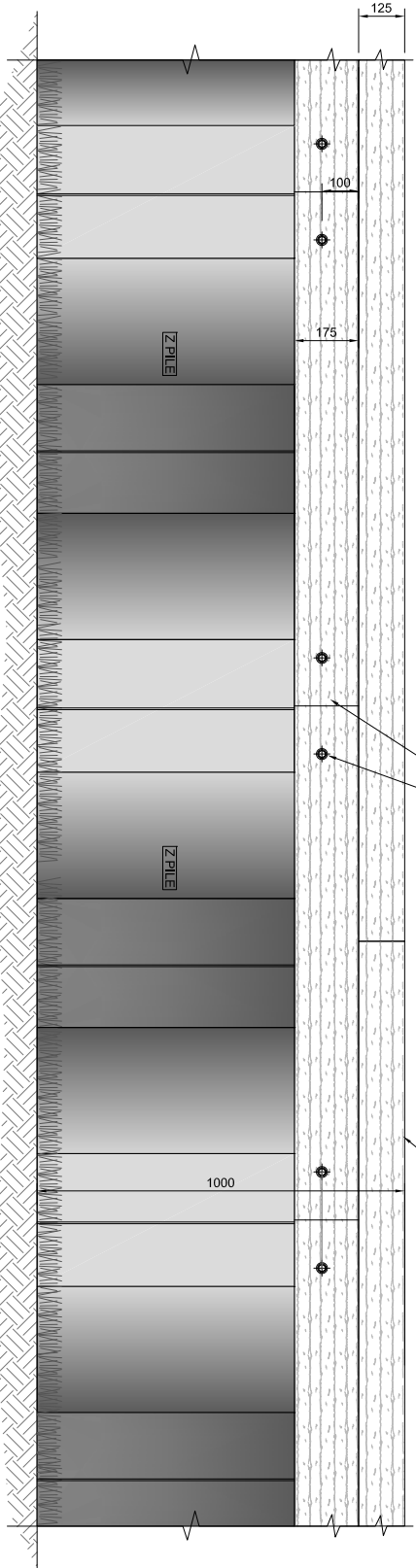

**A-A** FRONT ELEVATION  
SCALE 1:10

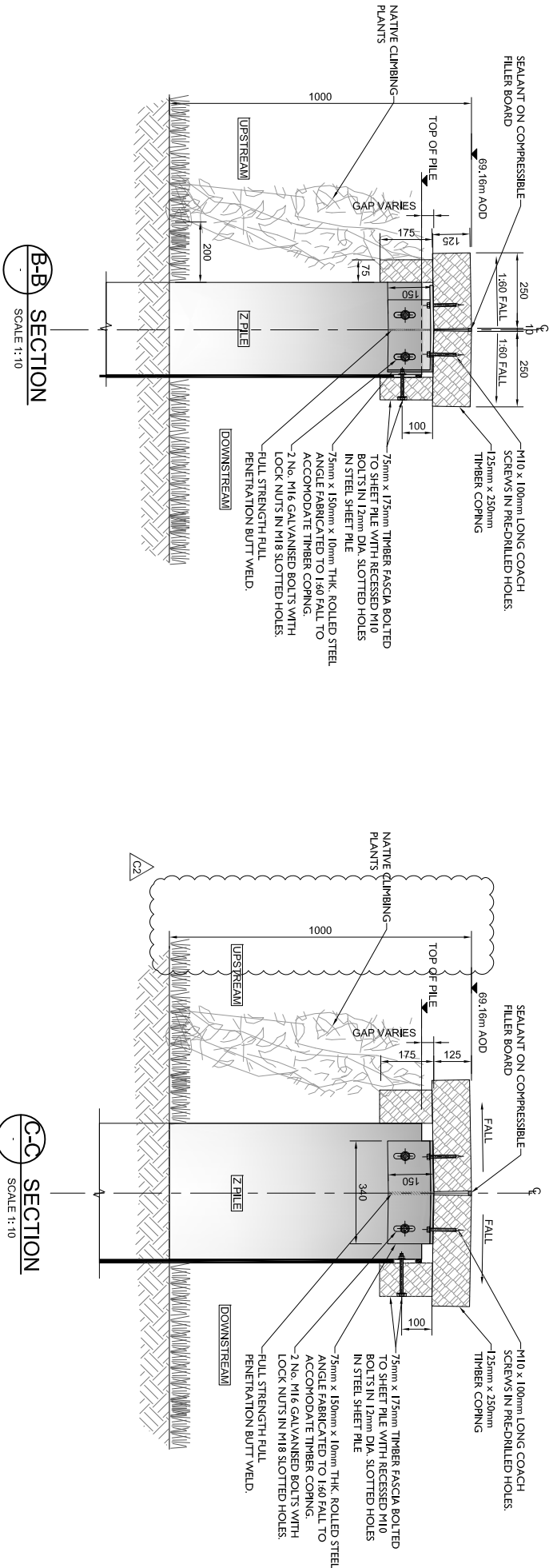

**B-B**  
**SECTION**  
SCALE 1:10

C-C  
SECTION  
SCALE 1:10